

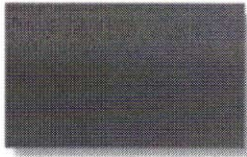

Environmentally Smart Colors — Designed Energy Efficient



TERRA COTTA



AGED COPPER

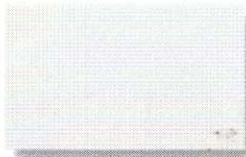

SOLAR WHITE †



SANDSTONE †

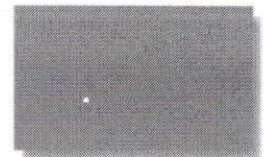

SURREY BEIGE



COLONIAL RED †



PATINA GREEN



REGAL WHITE †



ASH GRAY †



SIERRA TAN †



REGAL RED *



HEMLOCK GREEN *



STONE WHITE

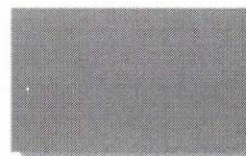

DOVE GRAY



MEDIUM BRONZE †



BURGUNDY *



HARTFORD GREEN * †

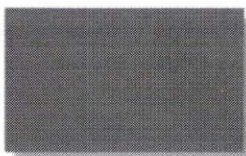

SLATE BLUE

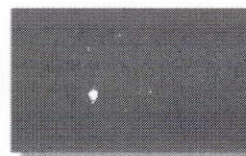

SLATE GRAY †



MANSARD BROWN †



MATTE BLACK †



EVERGREEN †



REGAL BLUE * †



CHARCOAL GRAY †



DARK BRONZE †

Metallic Colors

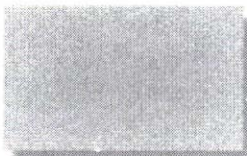

SILVER *



COPPER *



CHAMPAGNE *

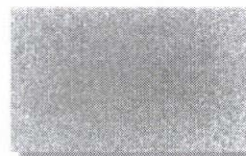

PRE-WEATHERED * GALVALUME *



ACRYLIC COATED GALVALUME *

Non-Painted

Weathered Colors



GALV-TEN™ RAW *



COPPER-TEN™ RAW *

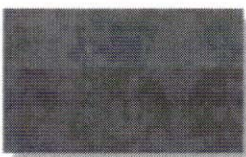

COR-TEN AZP * RAW *

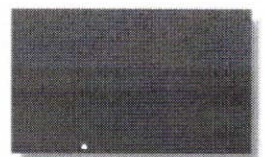

VINTAGE *

* Available at a slight price premium.

† Available in 26ga SMP

* Also available in Robust.

Colors shown are matched as accurately as possible, but may vary slightly from finished product. These rich and vibrant colors are produced with either Kynar 500® or Hylar 5000® resins, which provide superior color retention and allow Sheffield Metals to offer non-prorated coating warranties for most applications. Coating warranty varies for Regal Red, Matte Black, Copper, Champagne, Silver and Pre-Weathered Galvalume. Sheffield Metals carries a 20-year Finish Warranty. Please contact your representative for more information.



Proposal Form

1322 Ontario Dr. Lake Worth, FL 33461
 Roofing CCC1331772
 Office: 561-619-9813 Cell: 561-252-8649

*Proudly serving
 South Florida*
 Re-roofing & Repairs

PROPOSAL

PROPOSAL SUBMITTED TO: Alex Keto	PHONE 301-602-1775	DATE 12-21-2023
STREET 312 NW 2nd Street	JOB NAME Same	
CITY, STATE AND ZIP CODE Delray Beach, FL 33444	JOB LOCATION Same	
CONTACT: Alexketo@hotmail.com	CITY, STATE AND ZIP CODE	JOB PHONE

General:

Remove existing roof materials on sloped roof and flat. Re-roof to be completed in 30 from permit submittal. Remove and replace decayed decking and fascia in accordance with unit prices listed below. This contract includes the replacement (if necessary) of 5 sheets of plywood sheathing and 25 lineal feet of fascia. Painting of fascia to be by others. Additional fascia replacement will be three times the cost per liner foot and additional plywood will be \$80.00 per sheet. Removal and replacement of gutter, aluminum patio roofs, solar panels, screen enclosures, soffits, and satellite antenna are not included in this proposal unless stated otherwise.

Steep Slope Roofs:

Furnish and install self-adhering metal underlayment back nailed properly.

Furnish and install new 10" goose neck vent and new plumbing stacks.

Furnish and install new 24 Gauge 1.5" mechanical fastened standing seam panels standard color.

Low Slope:

Furnish and install base sheet tin tagged to current code.

Furnish and install two plies of glass ply IV set in hot asphalt.

Furnish and install 3x3drip edge nailed and primed.

Furnish and install modified bitumen with ceramic granules set in hot asphalt.

Draw schedule: 50% upon commencement; 40% Metal Load; 10% upon completion.

Quotation for the sum of: (Eighteen Thousand Eight Hundred Fifty Dollars) \$18,850.00

To furnish and install 3" ISO and 1/2" structodeck set in hot asphalt for an additional \$2,250.00

Initial Here: _____



Proposal Form

1322 Ontario Dr. Lake Worth, FL 33461
Roofing CCC1331772
Office: 561-619-9813 Cell: 561-252-8649

Proudly serving
South Florida
Re-roofing & Repairs

All material is guaranteed to be as specified. All work is to be completed in a workmanlike manner according to standard practices. Any alteration or deviation from the above specifications involving extra costs will be charged accordingly; any painting is not included. Not responsible for roof leaks in areas other than those worked on. Under no circumstances is Top Tier Roofing responsible for existing damages to building, its contents or roof deck. Owner to carry Fire, Tornado and other necessary insurance.

Acceptance of Proposal – The above prices, specifications and conditions are satisfactory and are hereby accepted. You are authorized to do the work as specified. Payment will be made as outlined above. Please see reverse side for terms and conditions. By signing this proposal you agree to the terms and conditions, either on the back of this page or attached to the original email. Seven year warranty.

Date of Acceptance: Dec 17 2023

Authorized Signature: *Top Tier Roofing Rep.*

Note: This proposal may be withdrawn by us if not accepted within 30 days.

Signature _____

Signature _____

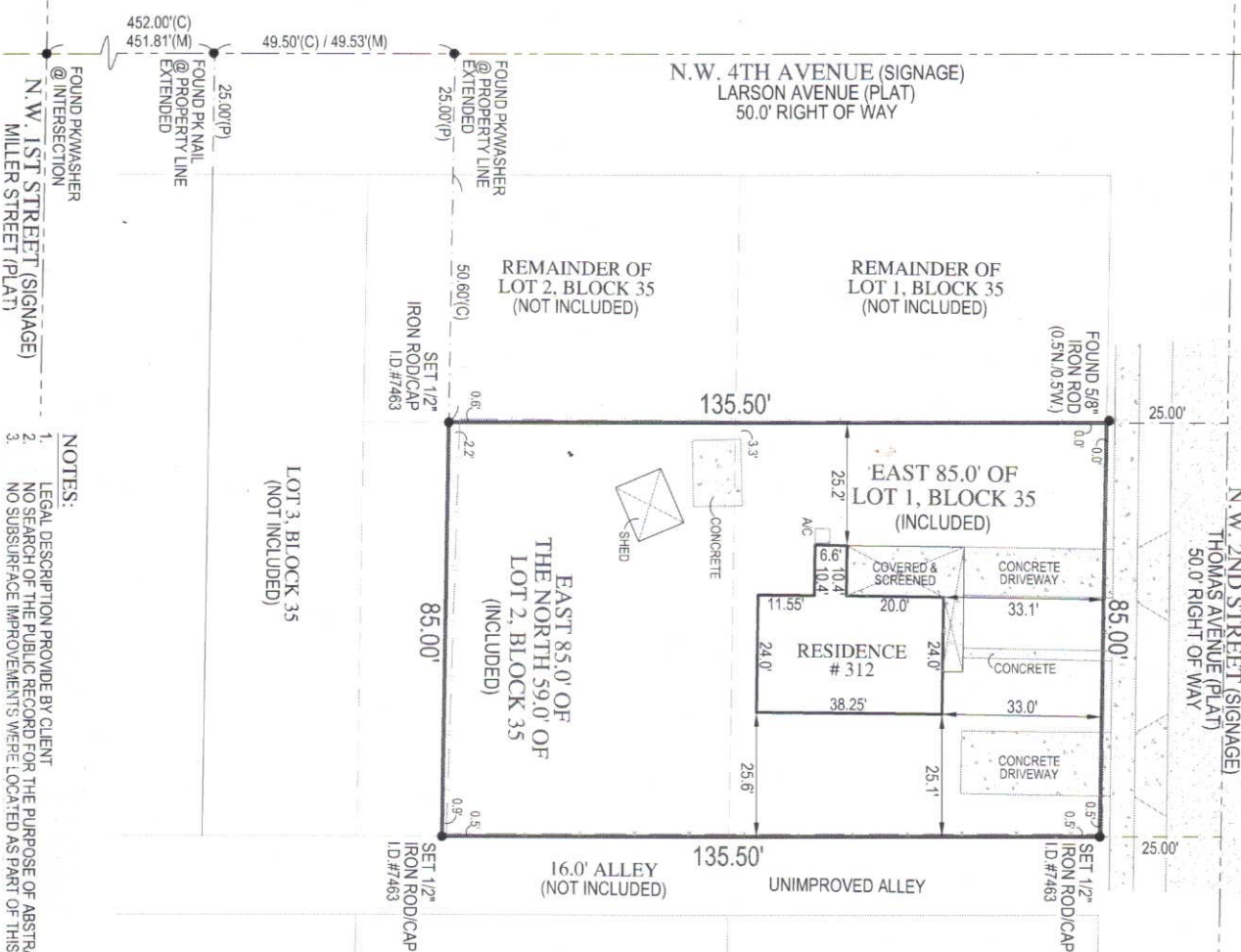

NOTES:
 1. LEGAL DESCRIPTION PROVIDED BY CLIENT
 2. NO SEARCH OF THE PUBLIC RECORD FOR THE PURPOSE OF ABSTRACTING TITLE WAS PERFORMED BY THIS OFFICE
 3. NO SUBSURFACE IMPROVEMENTS WERE LOCATED AS PART OF THIS SURVEY

LEGAL DESCRIPTION
 THE EAST 85 FEET OF LOT 1 AND THE EAST 85 FEET OF THE NORTH 59 FEET OF LOT 2, BLOCK 35, DELRAY BEACH, ACCORDING TO THE PLAT THEREOF AS RECORDED IN PLAT BOOK 1, PAGE 3, OF THE PUBLIC RECORDS OF PALM BEACH COUNTY, FLORIDA. THE TOWN OF DELRAY, FLORIDA, HAVING FORMERLY BEEN KNOWN AS THE TOWN OF LINTON.

FLOOD ZONE: X
 COMMUNITY NUMBER: 125102
 PANEL: 0004
 SUFFIX: D

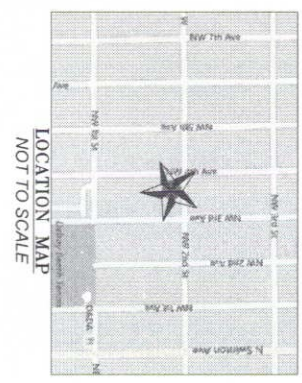

LEGEND

AC	AIR CONDITIONER
B.F.P.	BACKFLOW PREVENTER
C.M.	CONCRETE MONUMENT
CATV	CABLE RISER
C.B.S.	CONCRETE BLOCK STRUCTURE
ELEVATION	ELEVATION
E.F.	FINISHED FLOOR
F.C.M.	FOUND CONCRETE MONUMENT
F.P.K.	FOUND PARKER-KALON NAIL
F.R.	FOUND IRON ROD
F.D.	FOUND IDENTIFICATION
L.D.	LENGTH
L.B.	LICENSED BUSINESS
M.T.S.	MEASURED
N.T.S.	NOT TO SCALE
N.A.D.	NAD 83 DATUM
N.A.V.D.	NAD 1983 AMERICAN VERTICAL DATUM
N.G.V.D.	NATIONAL GEODETIC VERTICAL DATUM
O.R.B.	OFFICIAL RECORDS BOOK
P.L.A.T.	PLAT
P.S.M.	PROFESSIONAL SURVEYOR AND MAPPER
P.R.M.	PERMANENT REFERENCE MONUMENT
P.G.	PAGE
P.B.	PLAT BOOK
P.K.	PARKER-KALON NAIL
R.	RADIUS
S.I.R.	SET IRON ROD & CAP
S.S.P.K.	SET PARKER-KALON NAIL
S.S.P.	SHIP SPIKE
T.A.M.	TANGENT
T.B.M.	TEMPORARY BENCH MARK
T.P.	TRIP
U.F.	UTILITY EASEMENT
U.P.	UTILITY POLE
C.	CENTERLINE
P.L.	PROPERTY LINE
A.#	AND NUMBER
DELTA	DELTA OR CENTRAL ANGLE
CONCRETE	CONCRETE

Clyde O. McNeal PSM #2883
 THIS SURVEY IS NOT VALID WITHOUT THE SIGNATURE AND THE ORIGINAL PAPER SEAL

6250 N. MILITARY TRAIL SUITE 102
 WEST PALM BEACH, FL 33407
 www.compassurveying.net

COMPASS SURVEYING

LB. 7463 PHONE: 561.640.4800 FAX: 561.640.0576

C-13463
 10-06-2015
 1"=25'

BOUNDARY SURVEY OF
 312 N.W. 2ND STREET
 DELRAY BEACH, FL. 33444
 PREPARED FOR
 FIORELLA PERDOMO

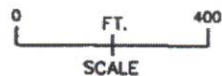
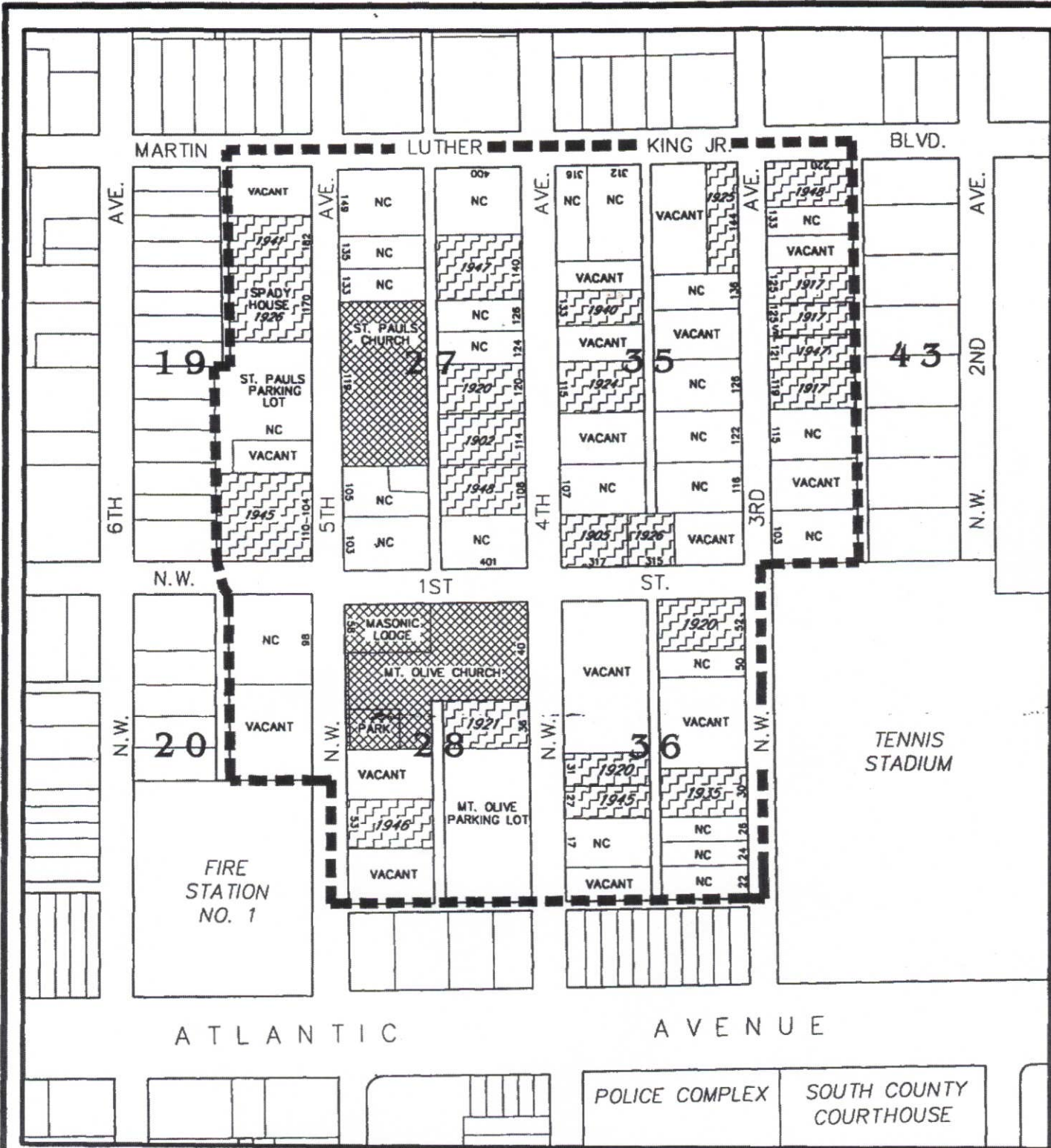

PLANNING DEPARTMENT
CITY OF DELRAY BEACH, FL
OCTOBER 1996

WEST SETTLERS HISTORIC DISTRICT

LEGEND:

100 - HOUSE NUMBER

NC - NON CONTRIBUTING
STRUCTURE

1900 - YEAR CONSTRUCTED

30

BLOCK NUMBER



HISTORIC SITE
(NON CONTRIBUTING STRUCTURE)

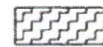

CONTRIBUTING
STRUCTURE



HISTORIC DISTRICT
BOUNDARY