

DEL-RATON PARK

IN SECTIONS 28, 29 & 32, T.46-S. R.43E
PALM BEACH COUNTY, FLA.

SCALE: 1"=100'
SHEET 2 (2 SHEETS)

DELRAY, FLORIDA

10

STATE OF FLORIDA

County of Palm Beach

This Plan was filed for record on

the 20 day of May 1924

at 10:25 A.M.

Notary Public

Approved: *(Signature)*
City Manager
for the Town of Boca Raton
this 2 day of Aug. A.D. 1925

Approved: *(Signature)*
City Clerk
for the City of Delray
this 28 day of August A.D. 1925

Approved: *(Signature)*
County Engineer
A.D. 1925

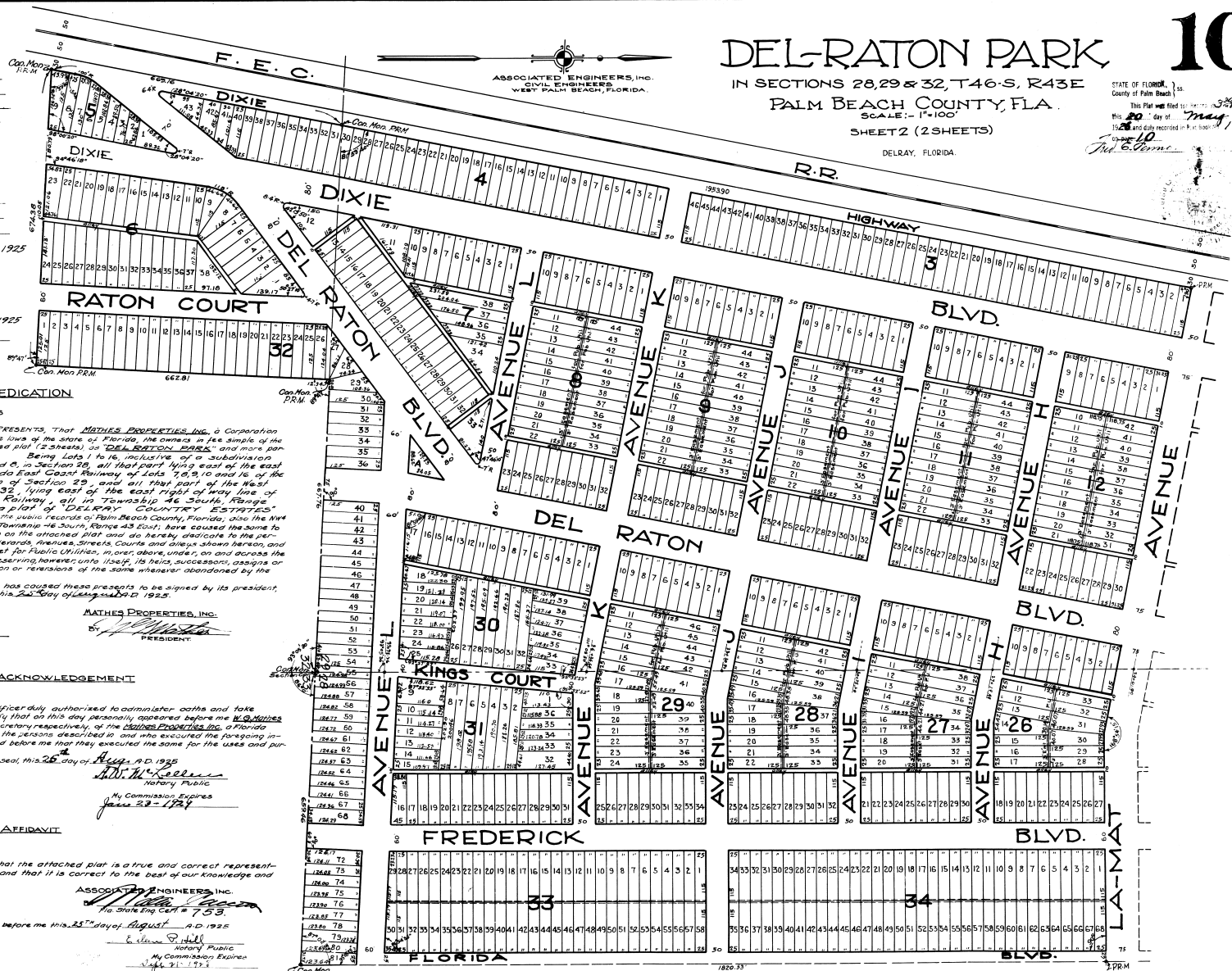

DEDICATION

STATE OF FLORIDA
COUNTY OF PALM BEACH } 55
KNOW ALL MEN BY THESE PRESENTS, that **MATHES PROPERTIES, INC.**, a Corporation organized and existing under the laws of the state of Florida, the owner in fee simple of the tract of land shown on the attached plat (2 sheets) as "DEL-RATON PARK" and more particularly described as follows: Lots 1 to 16, inclusive of a subdivision of the W 1/4 of Lots 4, 5, 6, 7 and 8, in Section 28, all that part lying east of the east right of way line of the Florida East Coast Railway of Lots 7, 8, 9, 10 and 16 of the West 1/4 and subdivision of Section 29, and all that part of the West 1/4 of Lot 8, in Section 32, lying east of the east right of way line of the Florida East Coast Railway, all in Township 46 South, Range 43 East, according to a plat of "DELRAY" COUNTY ENGINEER ESTABLISHED 43 East, recorded in Book 12 of Page 14, of the public records of Palm Beach County, Florida, and the part of the SW 1/4 of Sec. 28, Township 46 South, Range 43 East, have caused the same to be surveyed and plotted as shown on the attached plat and do hereby dedicate to the perpetual use of the public, the Boulevards, Avenues, Streets, Courts and other shown hereon, and also an easement of three (3) feet for Public Utilities, in, over, above, under, on and across the rear of the lots shown hereon, reserving, however, unto itself, its heirs, successors, assigns or legal representatives the reversion or reversions of the same whenever abandoned by the public or discontinued by law.
IN WITNESS WHEREOF, it has caused these presents to be signed by its president, and attested by its secretary this 28 day of August, A.D. 1925.

ATTEST: *(Signature)* SECRETARY
MATHES PROPERTIES, INC.
(Signature) PRESIDENT

ACKNOWLEDGEMENT

STATE OF FLORIDA
COUNTY OF PALM BEACH } 55
I, the undersigned, an officer duly authorized to administer oaths and take acknowledgments, do hereby certify that on this day personally appeared before me **W. Mathes** and **E. S. Strick**, president and secretary respectively, of the **MATHES PROPERTIES, INC.**, a Florida corporation, to me well known to be the persons described in and who executed the foregoing instrument and acknowledged to and before me that they executed the same for the uses and purposes therein expressed.
WITNESS, my hand and seal, this 26 day of Aug. A.D. 1925
(Signature)
My Commission Expires
Jan. 22 - 1924

AFFIDAVIT

STATE OF FLORIDA
COUNTY OF PALM BEACH } 55
WE HEREBY CERTIFY that the attached plat is a true and correct representation of a survey made by us and that it is correct to the best of our knowledge and belief.
ASSOCIATED ENGINEERS, INC.
(Signature)
Notary Public
Subscribed and sworn to before me this 25 day of August, A.D. 1925
(Signature)
Notary Public
My Commission Expires
Sept. 31 - 1923