

TREE DISPOSITION									
Tree Number	Botanical Name	Common Name	DBH (Inches)	Height (FT)	Canopy (FT)	Disposition	Condition	Remarks	Replacement Canopy (SQFT)
1	Veitchia arecina	Montgomery Palm	6	18	12	Remain	Fair		
2	Veitchia arecina	Montgomery Palm	6	18	12	Remain	Fair		

**MITIGATION CALCULATION (SECTION 4.6.19 E(8)(b)(i))**  
\$850.00 per 100 square feet for those trees removed with a canopy larger than 899 square feet (Ord. No. 19-17, § 1, 8-2-17)

CANOPY REMOVED TREES = 6,356 SF

MITIGATION CANOPY CREDITS = 3,000 SF  
- 300 x 6 (6 Quercus virginiana) + 300 x 2 (2 Coccoloba diversifolia)+ 300 x 4 (2 Conocarpus erectus Sericeous)+ 50 x 6 (4 Ptychosperma macarthurrii 'Schefferi')

CANOPY TO BE MITIGATED = 6,356 SF - 3,900 SF = 2,453 SF

MITIGATION FEES = 2,453 / 100 = 24.53 X \$850.00 = **\$20,850.50 IN LEU FEES TO BE PAID TO THE CITY**

PLANT SYMBOLS

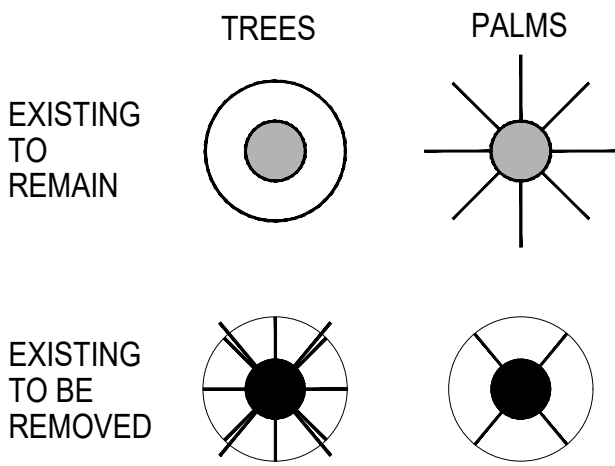



**Know what's below.  
Call before you dig.**

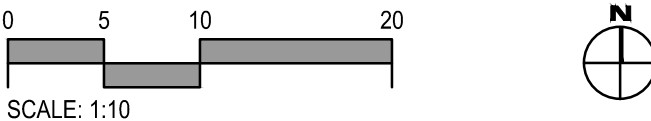

PROJECT:  
307 NE 5TH AVENUE, DELRAY BEACH, FL. 33483  
**LANDSCAPE PERMIT DRAWINGS**  
CLIENT:  
DELRAY TOWN VILLAS - TOWNHOMES

REVISIONS:		
	05/22/23	TAC COMMENTS
	07/17/23	TAC COMMENTS
No.	Date	Description

SEAL:  
LANDSCAPE ARCHITECT: Jose M Alvarez

REGISTRATION NO. RLA 6667245

SHEET TITLE:  
**TREE DISPOSITION**

Scale: 1" = 10' - 0"  
Drawn By: JMA  
Checked By: JMA  
Date: 01/25/2023  
SHEET NUMBER:  
**LP-0**



CABEZAS ALVAREZ  
LANDSCAPE ARCHITECTS, INC.  
80 NE 5TH AVENUE  
DELRAY BEACH, FL 33483  
561.596.6771 | chiscabezas@gmail.com  
www.chiscabezaslandscape.com



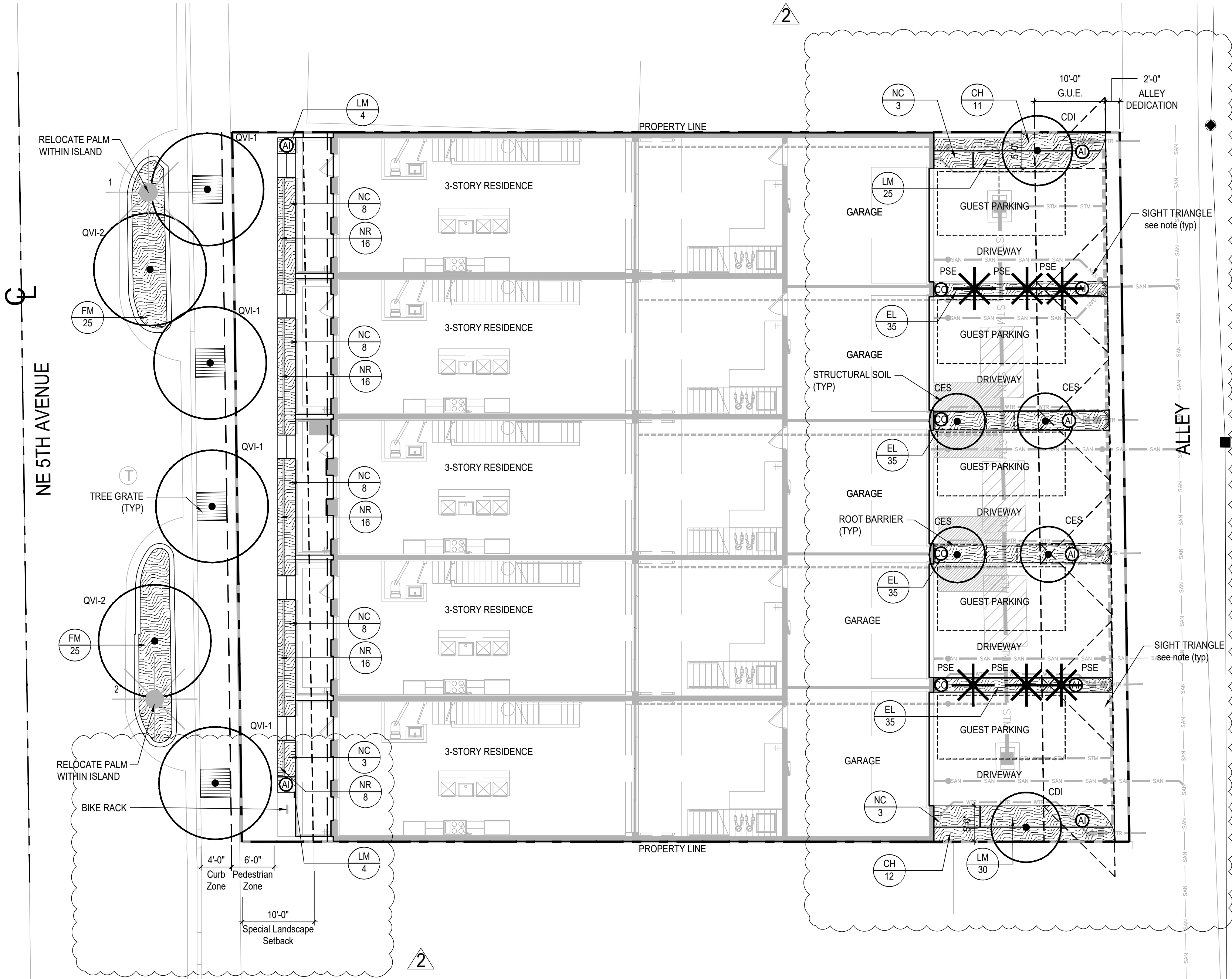

**SOIL NOTE:**  
EXISTING NATIVE SOIL WITHIN ALL LANDSCAPE ISLANDS, INTERIOR LANDSCAPE STRIPS AND PERIMETER LANDSCAPE STRIPS, ADJACENT TO VEHICULAR USE AREAS, SHALL BE EXCAVATED DOWN TO A DEPTH OF 30 INCHES BELOW EXISTING GRADE, EXCEPT FOR A 12-INCH BUFFER FROM THE INSIDE OF CURB OR PAVEMENT (SEE DIAGRAM BELOW). A SUITABLE PLANTING SOIL MIXTURE OF 50/50, 60/40 (SAND/TOPSOIL) OR AS OTHERWISE INDICATED BY THE REGISTERED LANDSCAPE ARCHITECT, SHALL EITHER BE BACKFILLED IN PLACE OF THE NATIVE SOIL OR EFFICIENTLY MIXED WITH THE NATIVE SOIL TO CREATE AN OPTIMUM ENVIRONMENT FOR SUCCESSFUL ROOT DEVELOPMENT. IF NATIVE SOIL IS TO BE MIXED, IT SHALL FIRST BE SCREENED TO REMOVE ROCKS AND DEBRIS LARGER THAN ONE-HALF INCH IN DIAMETER PRIOR TO MIXING. ALL PROPERTIES UNDER THIS SECTION SHALL BE REQUIRED TO HAVE AN OPEN LANDSCAPE BED INSPECTION PRIOR TO BACKFILLING TO INSURE THE 30-INCH DEPTH HAS BEEN MET.

**SIGHT TRIANGLE NOTE:**  
ALL TREES OR PALMS INSTALLED IN NODES WITHIN A RIGHT-OF-WAY SHALL MAINTAIN A FOUR FOOT OFFSET FROM THE FACE OF THE CURB. ALL SHRUBS AND GROUND COVERS SHALL BE MAINTAINED BELOW 36 INCHES IN HEIGHT. ALL TREE CANOPIES MUST BE MAINTAINED ABOVE EIGHT FEET IN HEIGHT.

**IRRIGATION NOTE:**  
ALL LANDSCAPE AREAS TO RECEIVE 100% COVERAGE WITH 100% OVERLAP BY IRRIGATION SYSTEM.

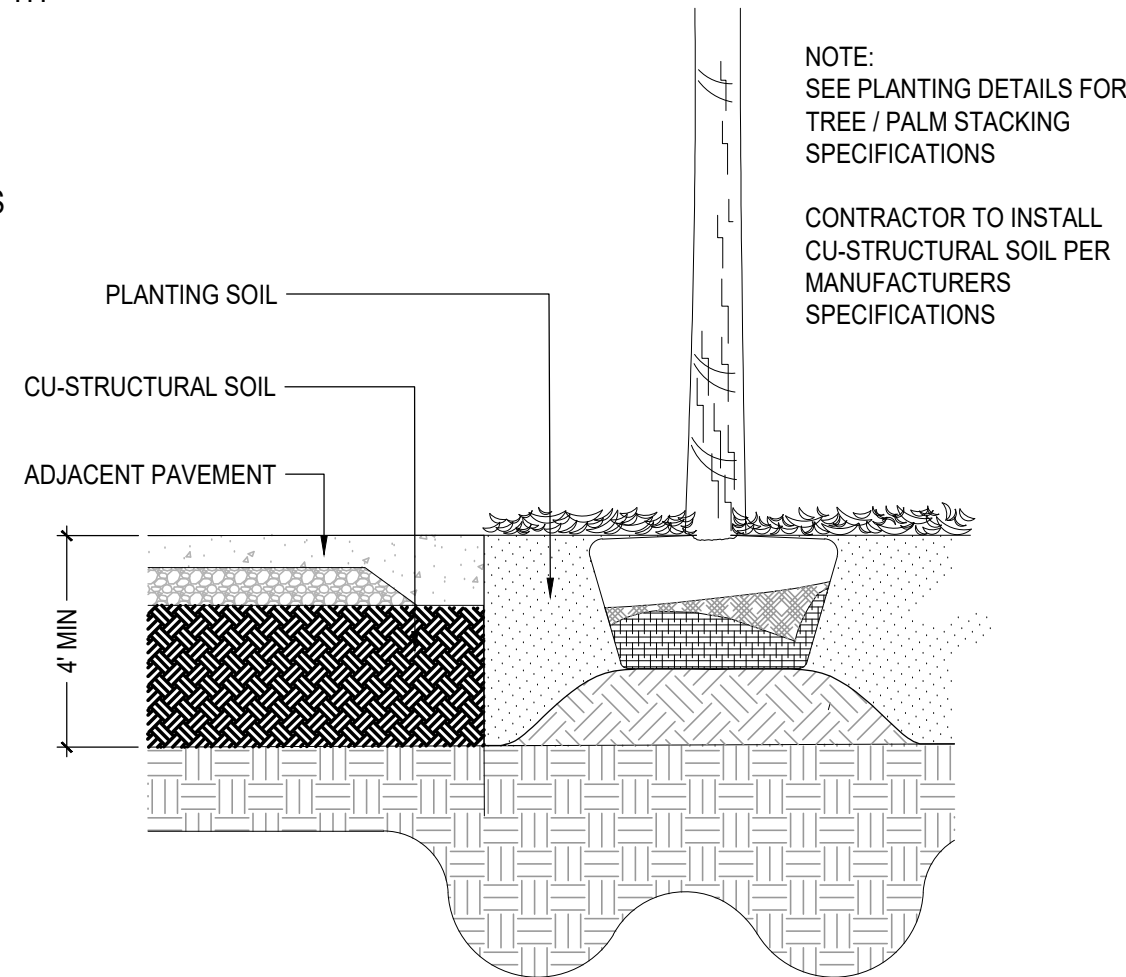

1 CU-STRUCTURAL SOIL DETAIL  
SCALE: N/A

**NOTE:**  
SEE PLANTING DETAILS FOR TREE / PALM STACKING SPECIFICATIONS  
CONTRACTOR TO INSTALL CU-STRUCTURAL SOIL PER MANUFACTURER'S SPECIFICATIONS

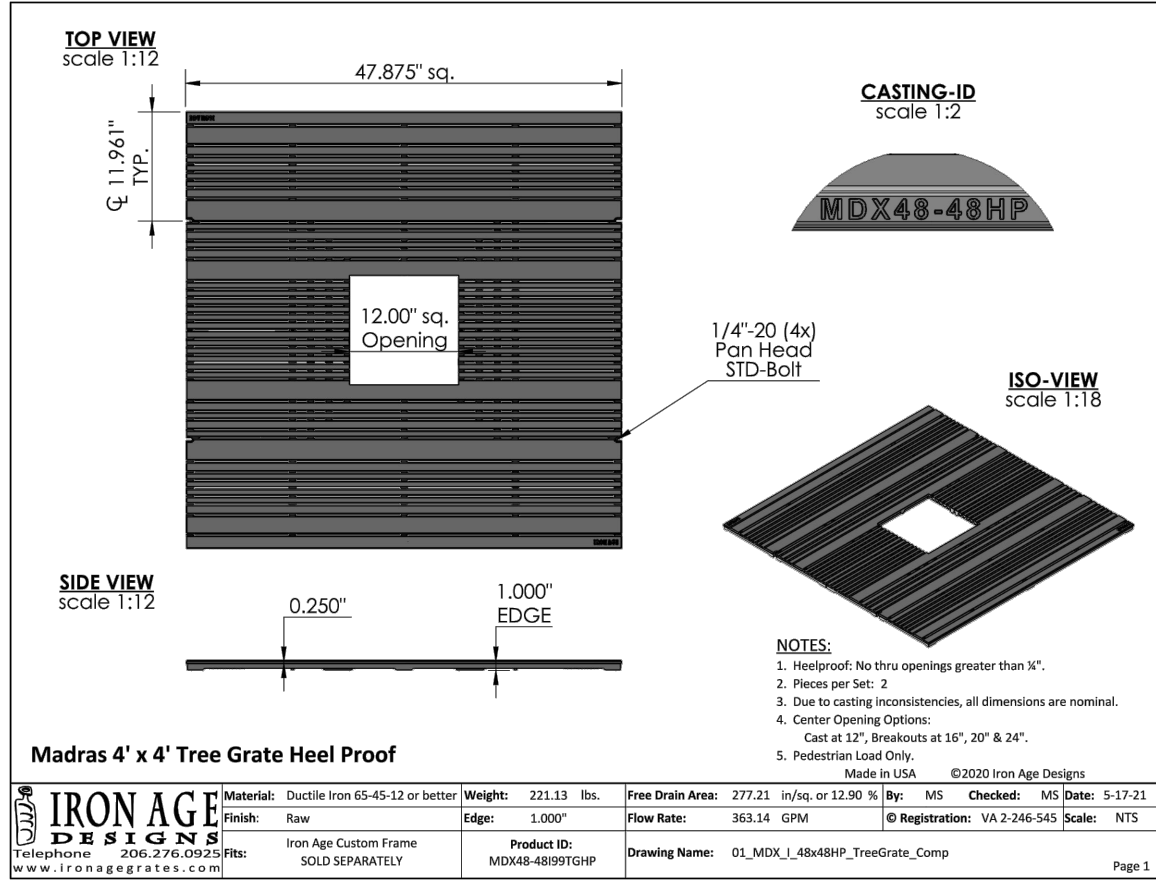

2 TREE GRATE DETAIL  
SCALE: N/A

## PLANT SCHEDULE

TREES	QTY	Scientific Name	Common Name	Specs	Native	Drought Tolerant	Notes
CDI	2	Coccoloba diversifolia	Pigeon Plum	16' HT, 4" DBH Min., 7' SPR; 8' CT	✓	✓	Standard;
CES	4	Conocarpus erectus 'Sericeous'	Silver Buttonwood	16' HT, 4" DBH Min., 7' SPR; 8' CT	✓	✓	Standard;

PALMS	QTY	Scientific Name	Common Name	Specs	Native	Drought Tolerant	Notes
PSE	6	Ptychosperma macarthurii 'Scheffer'	Scheffers Palm	16' HT		✓	

STREET TREES	QTY	Scientific Name	Common Name	Specs	Native	Drought Tolerant	Notes
QVI-1	4	Quercus virginiana	Live Oak	16' HT, 4" DBH Min., 7' SPR; 8' CT	✓	✓	Standard;

STREET ISLAND TREES	QTY	Scientific Name	Common Name	Specs	Native	Drought Tolerant	Notes
QVI-2	2	Quercus virginiana	Live Oak	16' HT, 4" DBH Min., 7' SPR; 8' CT	✓	✓	Standard;

SHRUBS	QTY	Scientific Name	Common Name	Specs	Native	Drought Tolerant	Notes
CH	23	Chrysobalanus icaco 'Horizontal'	Horizontal Cocoplum	3 Gallon, 24 HT, Full	✓	✓	24" O.C.
EL	140	Ernodea littoralis	Golden Creeper	3 Gallon, 12 HT, Full	✓	✓	12" O.C.
AI	8	Alcantarea imperialis	Imperial Bromeliad	7 Gallon, 30" HT		✓	Per Plan
CO	4	Cordyline fruticosa 'Black Magic'	Ti Plant	3 Gallon, 24 HT, Full			Per Plan
NC	41	Neomarica caerulea 'Regina'	Giant Apostle's Iris	3 Gallon, 24 HT, Full			Per Plan
FM	50	Ficus microcarpa 'Green Island'	Green Island Ficus	3 Gallon, 24 HT, Full		✓	24" O.C.

GROUND COVERS	QTY	Scientific Name	Common Name	Specs	Native	Drought Tolerant	Notes
LM	63	Liriope mascari 'Super Blue'	Lilyturf	1 Gallon, Full		✓	12" O.C.
NR	72	Liriope mascari 'Super Blue'	Lilyturf	1 Gallon, Full		✓	12" O.C.

## LANDSCAPE REQUIREMENTS (MULTI-FAMILY RESIDENTIAL)

### AREA CALCULATIONS

Lot Area	12,503 S.F.
Building	8,743 S.F.
Parking / Accessways Area	+/- 2,065 S.F.

DESCRIPTION	Required/Allowed	Provided
Street Trees (35'-40' o.c.) Total Frontage = 100'-0" (Sec. 4.6.16.H.(6))	4	4 Live Oak
Interior Landscape Area = 10% of Parking / Accessways Areas Sec. 4.6.16.(H)(3)(g)	206 SF	374 SF
1 Tree Per 125 SF of Int. Lndsp. (3 Palms = 1 Tree) Sec. 4.6.16.(H)(3)(h)	2	4 Silver Buttonwood + 6 Scheffers Palms (3 Palms = 1 Tree)
Foundation Landscaping Sec.4.4.13(3)(2)(a)(3)	10' Landscape Area	Shrubs & Groundcovers Provided
Landscape Barrier Sec. 4.6.16(H)(3)(d)	2 Trees + Continous Hedge	2 Pigeon Plum Trees + Continous Cocoplum Hedge
Special landscape regulations within CBD (Sec. 4.6.16.H.(5)(a)(3))	2 Trees	2 Live Oak Trees
Native Trees	50.0%	100%
Native Shrubs	25%	59%

**MITIGATION NOTE:**  
PROPOSED STREET TREES ARE PART OF TOTAL MITIGATION REQUIRED FOR TREES REMOVED ON SITE. SEE SHEET LP-0 FOR DETAILED MITIGATION CALCULATIONS.

## LEGEND

PROPOSED:

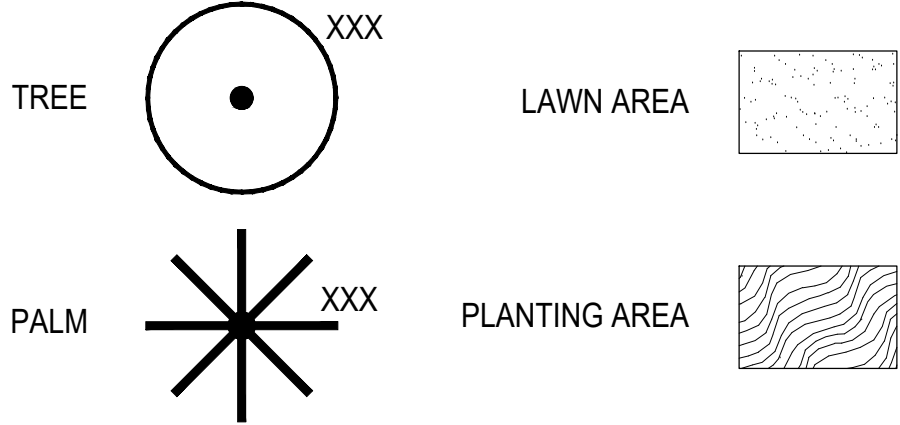

ca

CABEZAS ALVAREZ  
LANDSCAPE ARCHITECTS, INC.  
80 NE 5TH AVENUE  
DELRAY BEACH, FL 33483  
561.596.6771 | chiscabezas@gmail.com  
www.chiscabezaslandscape.com

PROJECT:  
307 NE 5TH AVENUE, DELRAY BEACH, FL. 33483  
LANDSCAPE PERMIT DRAWINGS  
CLIENT:  
DELRAY TOWN VILAS - TOWNHOMES

## REVISIONS:

05/22/23	TAC COMMENTS
07/17/23	TAC COMMENTS
No.	Date Description

SEAL:  
LANDSCAPE ARCHITECT: Jose M Alvarez



Know what's below.  
Call before you dig.

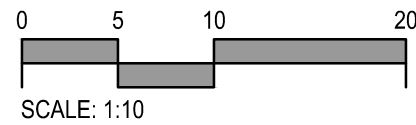

REGISTRATION NO. RLA 6967245  
SHEET TITLE:

LANDSCAPE PLAN

Scale: 1" = 10' - 0"  
Drawn By: JMA  
Checked By: JMA  
Date: 01/25/2023  
SHEET NUMBER:

LP-1



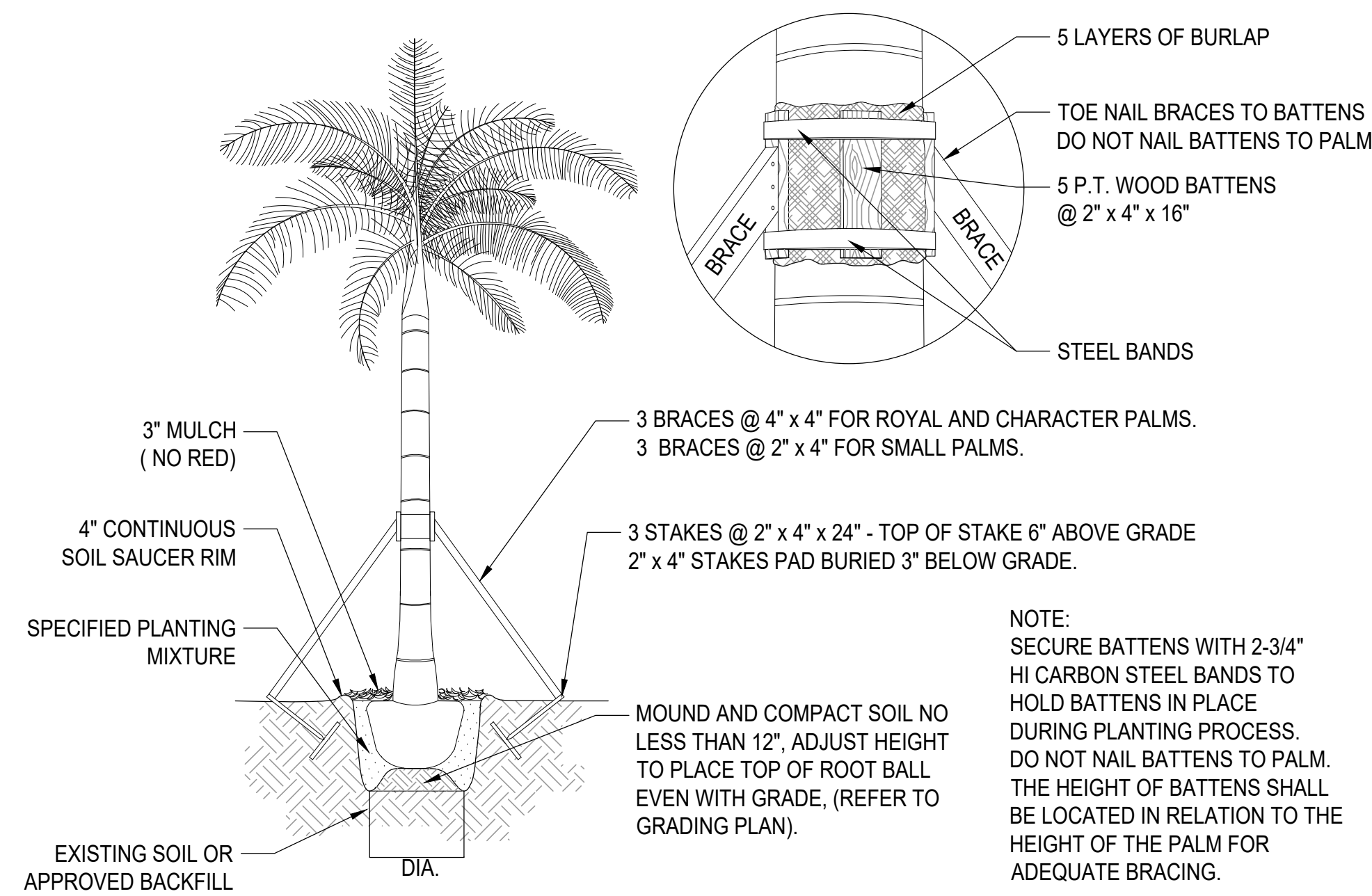

1 PALM PLANTING AND STAKING DETAIL  
SCALE: N/A

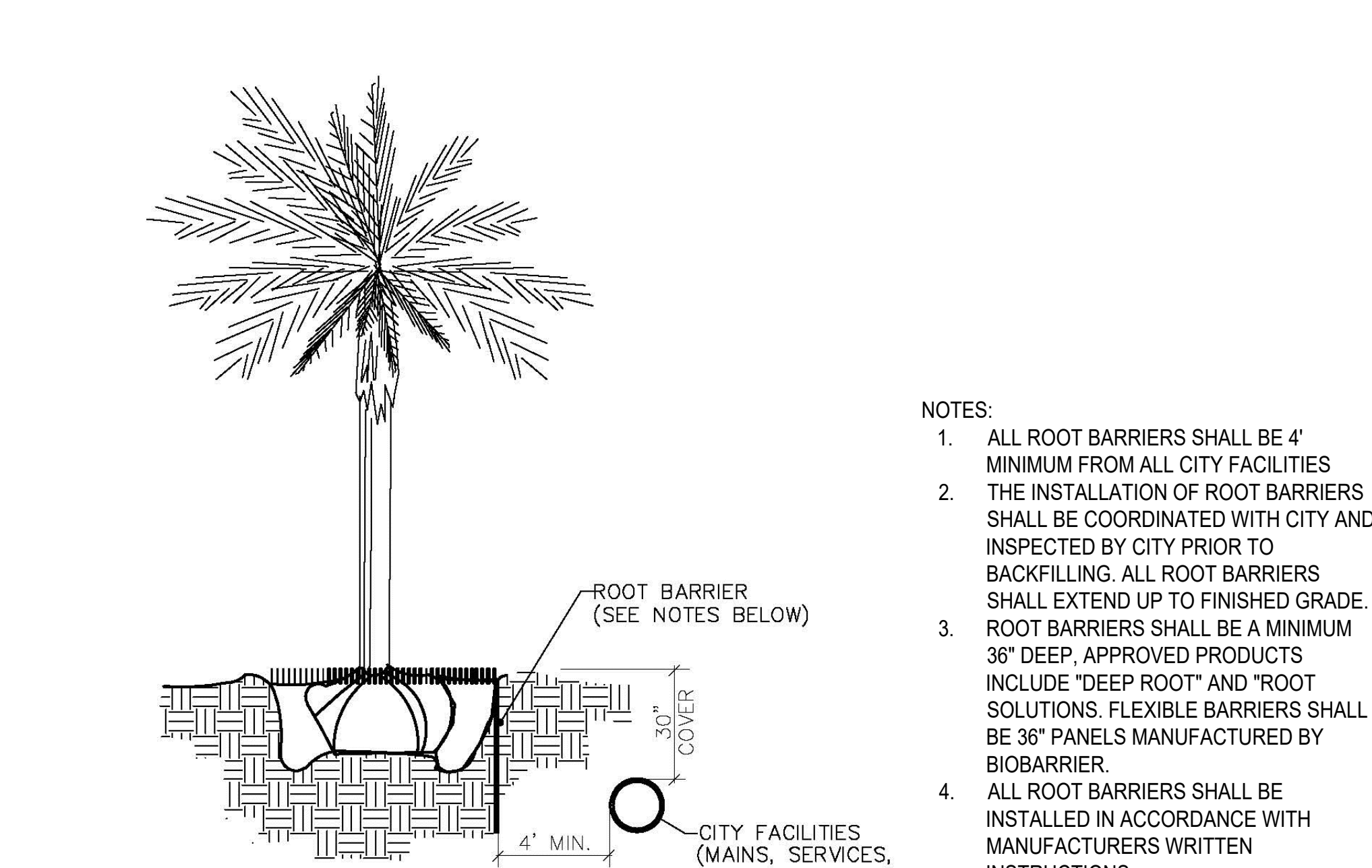

2 TYPICAL TREE WITH ROOT BARRIER (CITY OF DELRAY BEACH)  
SCALE: NTS

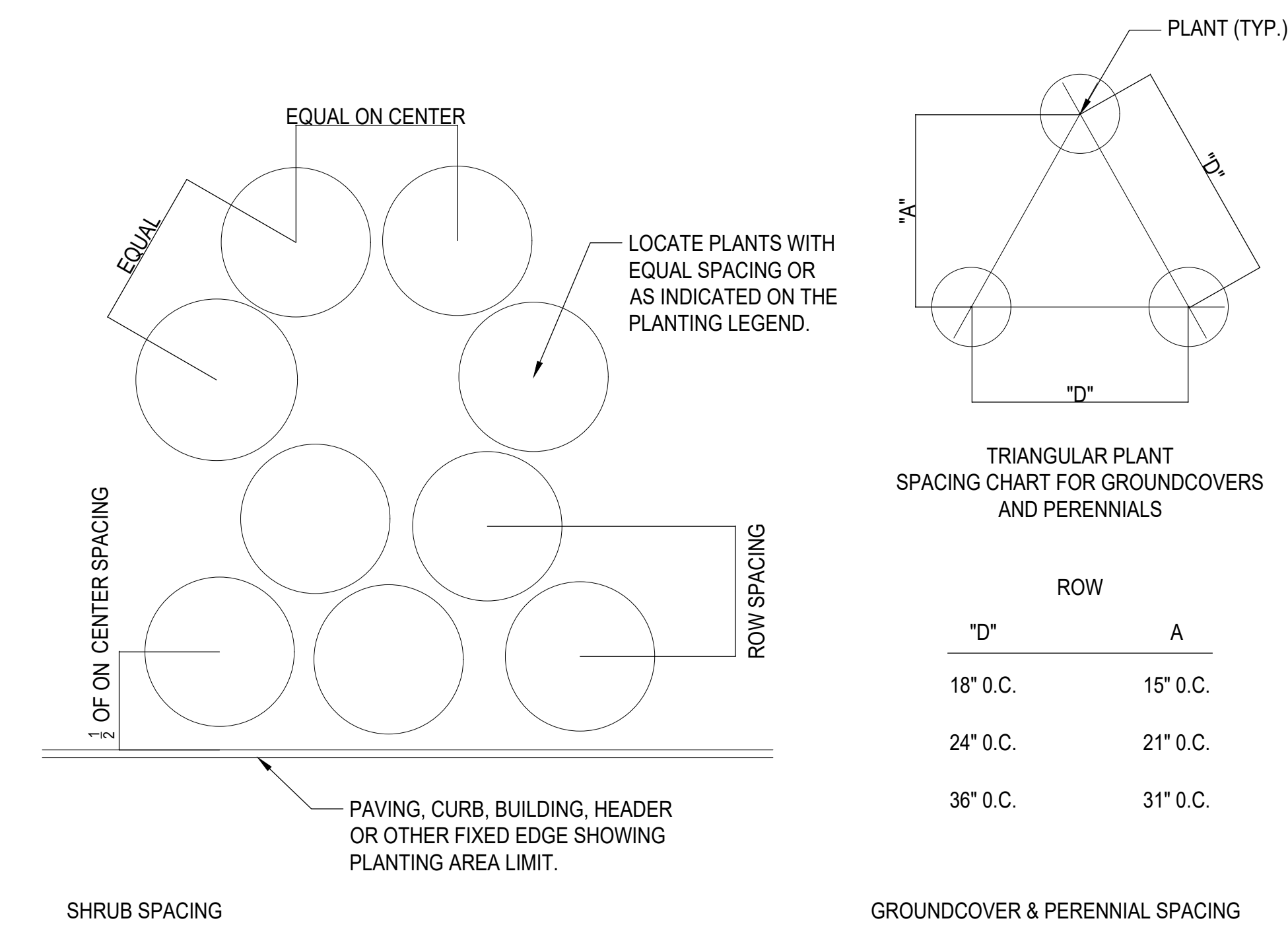

3 PLANT & SHRUB SPACING DETAIL  
SCALE: N/A

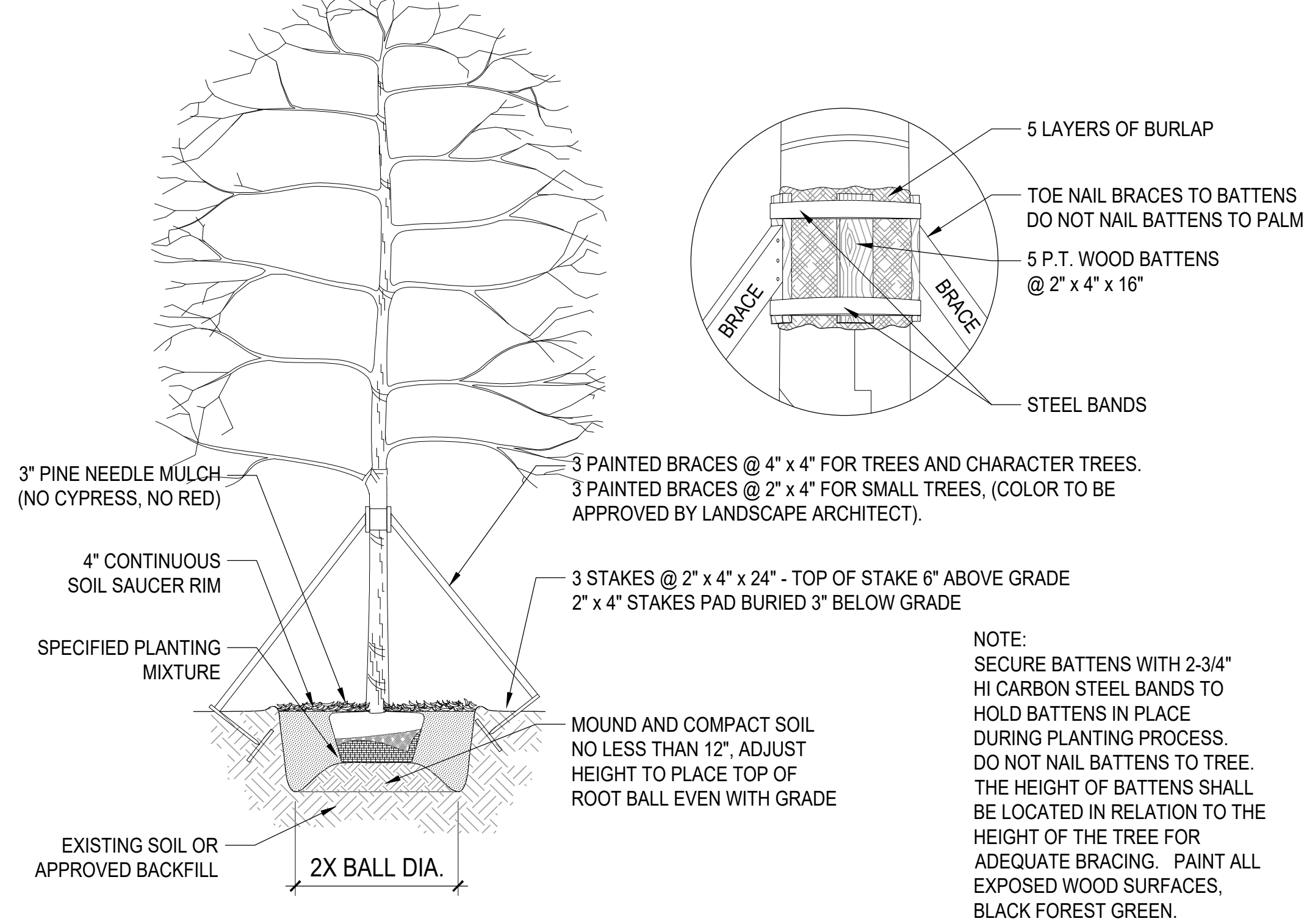

4 TREE PLANTING AND STAKING DETAIL  
SCALE: 3/32" = 1'- 0"

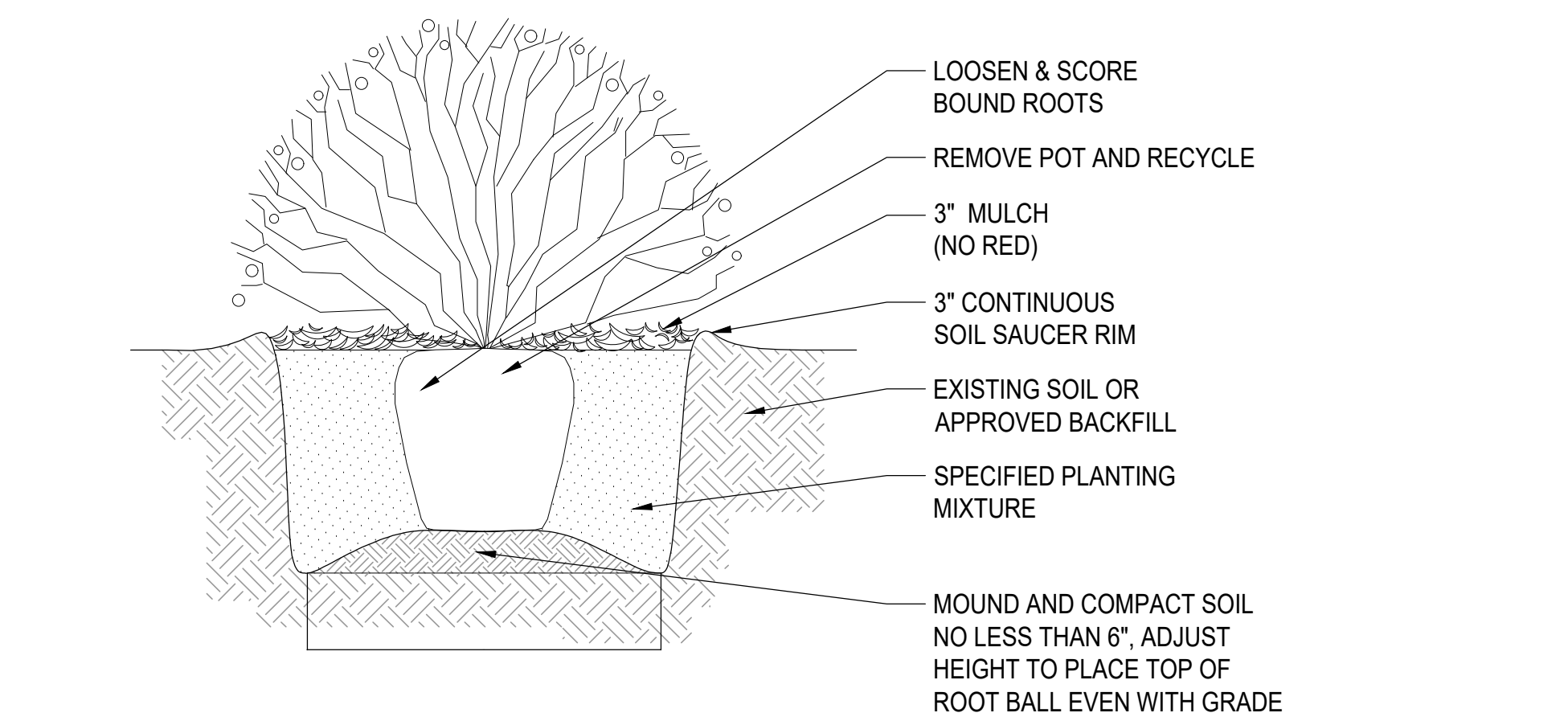

5 SHRUB PLANTING DETAIL  
SCALE: N/A

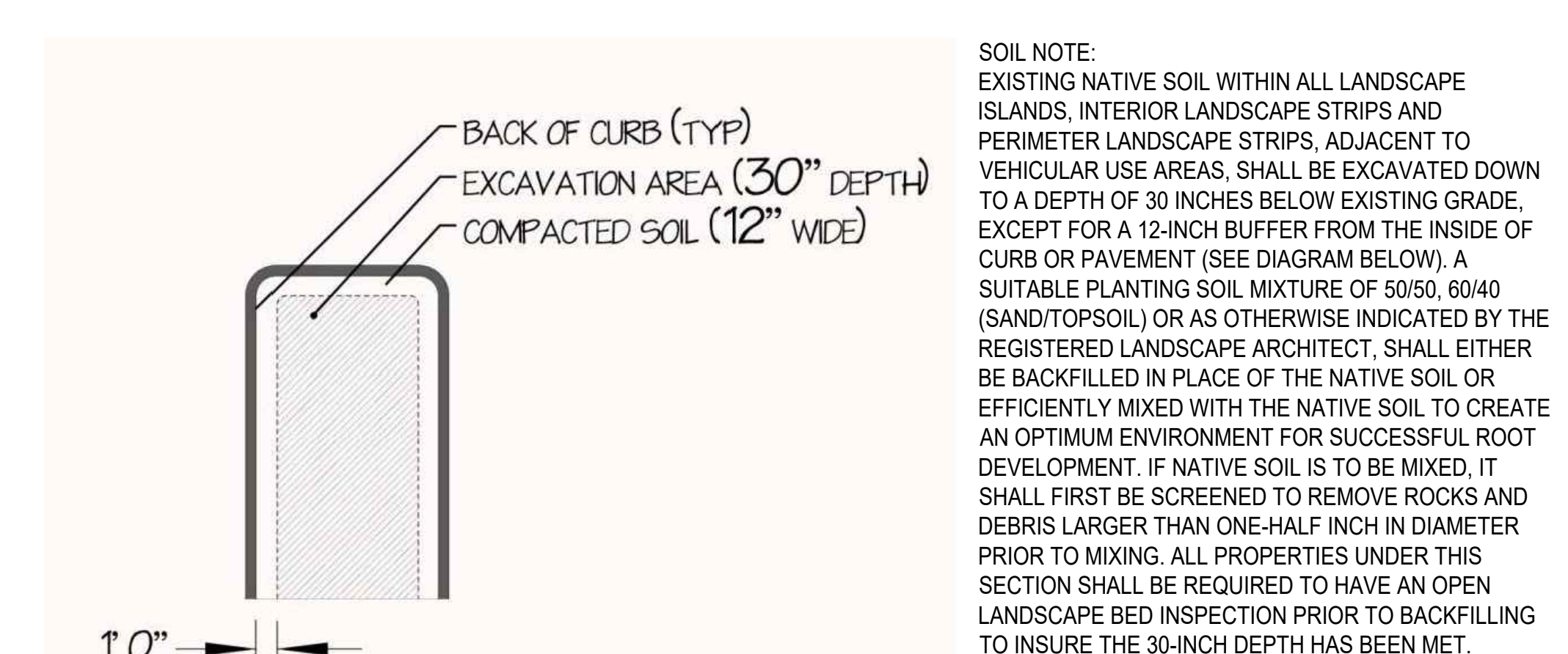

6 LANDSCAPE ISLAND BACKFILLING DETAIL (CITY OF DELRAY BEACH)  
SCALE: NTS

## GENERAL LANDSCAPE NOTES AND SPECIFICATIONS

- LANDSCAPE CONTRACTOR SHALL BECOME FAMILIAR WITH THE SCOPE OF WORK AS WELL AS THE SITE, DIGGING CONDITIONS, AND ANY OBSTACLES PRIOR TO SUBMITTING A BID.
- LANDSCAPE CONTRACTOR SHOULD VERIFY ALL ESTIMATED QUANTITIES OF MATERIAL SHOWN ON THE LANDSCAPE ARCHITECT'S DRAWINGS PRIOR TO SUBMITTING A BID.
- PLANTING PLAN SHALL TAKE PRECEDENCE OVER PLANT LIST IN CASE OF DISCREPANCIES.
- ALL PLANT MATERIAL SYMBOLS SHOWN ON LANDSCAPE PLANS SHALL BE CONSIDERED DIAGRAMMATIC AND SHOULD BE ADJUSTED IN THE FIELD BY LANDSCAPE CONTRACTOR TO AVOID ALL UTILITIES AND ALL OTHER OBSTRUCTIONS.
- ALL SIZES SPECIFIED FOR PLANT MATERIAL ON THE PLAN AND PLANT LIST SHALL BE CONSIDERED MINIMUM.
- ALL PLANT MATERIAL MUST MEET OR EXCEED THE SPECIFIED MINIMUM REQUIREMENTS FOR BOTH HEIGHT AND SPREAD.
- ALL MATERIAL SHALL BE SUBJECT TO AVAILABILITY AT TIME OF INSTALLATION.
- ALL TREES, PALMS, SHRUBS AND GROUND COVERS SHALL BE GUARANTEED FOR A PERIOD OF 6 MONTHS FROM DATE OF FINAL ACCEPTANCE.
- LANDSCAPE CONTRACTOR SHALL LOCATE AND VERIFY ALL UNDERGROUND UTILITIES OR STRUCTURES PRIOR TO DIGGING.
- LANDSCAPE CONTRACTOR SHALL COORDINATE WITH THE GENERAL CONTRACTOR, THE REMOVAL OF ALL BUILDING CONSTRUCTION DEBRIS AND FOREIGN MATERIAL PRIOR TO INSTALLATION OF ANY PLANT MATERIAL.
- SITE PREPARATION SHOULD INCLUDE THE ERADICATION AND REMOVAL OF ANY WEEDS OR GRASS, REMOVAL AND CLEAN UP OF ANY DEAD MATERIAL AND ROUGH AND FINISH GRADING PER SPECS AND OR LANDSCAPE PLANS.
- FOR PLANT MATERIAL DESIGNATED TO BE REMOVED, THE ENTIRE ROOT SYSTEM SHALL BE DUG AND REMOVED FROM THE SITE.
- ALL PLANTING AREAS SHOULD RECEIVE AN 80/20 MIX FILL SOIL. SAND USED IN PLANTING SOIL MIX SHALL BE SILICA SAND.
- ALL PLANT MATERIAL SHALL BE FLORIDA NO. 1 OR BETTER AS SET FORTH IN THE FLORIDA DEPARTMENT OF AGRICULTURE 'GRADES AND STANDARDS FOR NURSERY PLANTS' SECOND EDITION FEB. 1998 INCLUDING REVISIONS AND WHICH MEET OR EXCEED THE SIZES INDICATED IN THE PLANTING SCHEDULE AND DETAILS.
- ALL TREES SHALL BE STAKED IN A GOOD WORKMANLIKE MANNER. NO NAIL STAKING PERMITTED. (REFER TO BRACING NOTES AND PLANTING DETAILS)
- AFTER REMOVAL OR RELOCATION OF EXISTING TREES AND PALMS, ALL REMAINING HOLES SHALL BE BACK FILLED AROUND AND UNDER ROOT BALL.
- ALL EXISTING PLANT MATERIAL TO REMAIN, SHALL BE PROTECTED DURING ALL CONSTRUCTION PHASES. ANY PLANT MATERIAL SCARRED OR DESTROYED DESIGNATED TO REMAIN MUST BE REPLACED AT THE CONTRACTOR'S EXPENSE WITH SIMILAR SPECIES SIZE AND QUALITY.
- ALL TREES AND ALL PLANTING BEDS TO BE TOPPED WITH 3" MIN. "GRADE A" ORGANIC MULCH (MELALEUCA IS PREFERRED), UNLESS OTHERWISE NOTED. (CYPRESS MULCH AND RED MULCH SHALL NOT BE USED).
- ALL TREES SHALL HAVE 2" CALIPER AT D.B.H. MINIMUM FOR A 12' HEIGHT TREE, UNLESS NOTED OTHERWISE.
- ALL 1 GALLON MATERIAL SHALL HAVE 12" SPREAD MINIMUM, ALL 3 GALLON MATERIAL TO HAVE 18-24" SPREAD MINIMUM.
- ALL PLANTING AREAS WITHIN THE LIMITS OF WORK SHALL RECEIVE 100% COVERAGE BY AUTOMATIC IRRIGATION SYSTEM (DRIP PREFERRED) UNLESS OTHERWISE DIRECTED BY OWNER. SEE IRRIGATION PLANS FOR ADDITIONAL SPECIFICATIONS.
- LANDSCAPE CONTRACTOR TO COORDINATE INSTALLATION OF IRRIGATION SYSTEM WITH IRRIGATION CONTRACTOR. IRRIGATION TIME CLOCK TO BE HARD WIRED ON COMPLETION - RESPONSIBILITY OF IRRIGATION CONTRACTOR. LANDSCAPE CONTRACTOR SHALL HAND WATER OR ARRANGE FOR WATERING DURING PLANTING UNTIL IRRIGATION SYSTEM IS 100% OPERABLE. THIS IS THE RESPONSIBILITY OF THE LANDSCAPE CONTRACTOR.
- LANDSCAPE CONTRACTOR SHALL COORDINATE HIS WORK WITH ALL OTHER APPROPRIATE CONTRACTORS.
- THE LANDSCAPE CONTRACTOR SHALL AT ALL TIMES KEEP THE JOB SITE CLEAN AND FREE FROM ACCUMULATION OF WASTE MATERIAL, DEBRIS, AND RUBBISH.
- LANDSCAPE PLAN SHALL BE INSTALLED IN COMPLIANCE WITH ALL LOCAL CODES.
- THESE DRAWINGS, DOCUMENTS, AND ALL CONTENTS ARE THE PROPERTY OF CHRIS CABEZAS LANDSCAPE ARCHITECTURE, INC. ALL RIGHTS ARE RESERVED. UNAUTHORIZED USE OR PRODUCTION, IN PART OR WHOLE, FOR ANY PURPOSE IS UNLAWFUL AND PROHIBITED EXCEPT BY EXPRESS WRITTEN CONSENT.
- THE CONTRACTOR IS RESPONSIBLE FOR OBTAINING ANY PERMITS OR APPROVALS FROM THE FEDERAL, STATE OR LOCAL GOVERNMENT REQUIRED FOR THE WORK INCLUDED IN THIS CONTRACT AND ON THESE DRAWINGS.
- NOTIFY THE OWNER AND LANDSCAPE ARCHITECT OF ANY UNFORESEEN CONDITIONS, I.E., COMPACTED SOIL / SUBGRADE, POOR DRAINAGE, UNCONSOLIDATED SOIL, EROSION, UTILITY CONFLICTS, EXCESSIVE SUN OR SHADE, ETC., PRIOR TO PROCEEDING WITH LANDSCAPE INSTALLATION.
- ALL PLANTS, MATERIALS AND WORKMANSHIP ARE SUBJECT TO THE APPROVAL OF THE LANDSCAPE ARCHITECT AND OWNER.

ca

CABEZAS ALVAREZ  
LANDSCAPE ARCHITECTS, INC.  
80 NE 5TH AVENUE  
DELRAY BEACH, FL 33483  
561.596.6771 | chris@cabezaslandscape.com  
www.chriscabezaslandscape.com

PROJECT:  
307 NE 5TH AVENUE, DELRAY BEACH, FL. 33483  
LANDSCAPE PERMIT DRAWINGS  
CLIENT:  
DELRAY TOWN VILLAS - TOWNHOMES

REVISIONS:		
No.	Date	Description

SEAL:  
LANDSCAPE ARCHITECT - Jose M Alvarez

REGISTRATION NO. RLA 0667245  
SHEET TITLE:

PLANTING DETAILS

Scale: 1" = 10' - 0"  
Drawn By: JMA  
Checked By: JMA  
Date: 01/25/2023  
SHEET NUMBER:

LP-2



## REVISIONS:

05/22/23	TAC COMMENTS
07/17/23	TAC COMMENTS

No. Date Description

## SEAL:

LANDSCAPE ARCHITECT: Jose M Alvarez

REGISTRATION NO. RLA 6967245

SHEET TITLE:

IRRIGATION PLAN

Scale: 1" = 10' - 0"

Drawn By: JMA

Checked By: JMA

Date: 01/25/2023

SHEET NUMBER:

LP-3

2

