



## Equipment Proposal

Proposal # CPQ#13558R2

This Equipment Proposal (the "Proposal") has been prepared by Ten-8 Fire & Safety, LLC ("Company") in response to the undersigned Customer's request for a proposal. This Proposal is comprised of the special terms set forth below, the Proposal Option List, Warranty, and Company's Purchasing Terms and Conditions. Through its signature below or other Acceptance (as defined below), Customer acknowledges having received, read and being bound by this Proposal, all attachments and Company's Purchasing Terms and Conditions.

**Date:** November 7, 2025 ("Proposal Date")      **Customer:** City of Delray Beach ("Customer")

**Customer Address:** 501 West Atlantic Ave, Delray Beach, FL 33444

Qty	Product Description & Options	Price
1	<b>2027 Braun Super Chief Ambulance, custom built on a Freightliner M2 Plus Crew Cab or International MV607 Crew Cab, per the attached specifications.</b>  <b>Pricing based on Florida Sheriff's Association Contract # FSA25-VEF19.0</b>  <b>*Price includes prebuild and final inspection trips to Braun.</b> <b>**Chassis price is an estimate and will be reconciled at time of invoice.</b>	<b>\$649,808.00</b>
<b>**Commercial chassis price is an estimate; final price is net price charged by the chassis manufacturer.</b>		<b>Total: \$649,808.00</b>

**Delivery Timing:** The Product described above in the Product Description and Options Section of this document will be built by and shipped from the manufacturer approximately **18-22 (months)** after Company receives Customer's acceptance of this Proposal as defined below, subject to market and production conditions, Force Majeure, delays from the chassis manufacturer, changes to Order Specifications, or any other circumstances or cause beyond Company's or manufacturer's control.

**Other:** Emissions will be changing in model year 2027. Actual chassis cost will be passed through to customer.

Unless accepted within **45** days from date of proposal, the right is reserved to withdraw this proposal.

ACCEPTANCE OF THIS PROPOSAL CREATES AN ENFORCEABLE BINDING AGREEMENT BETWEEN COMPANY AND CUSTOMER. "ACCEPTANCE" MEANS THAT CUSTOMER DELIVERS TO COMPANY: (A) A PROPOSAL SIGNED BY AN AUTHORIZED REPRESENTATIVE, OR (B) A PURCHASE ORDER INCORPORATING THIS PROPOSAL, WHICH IS DULY APPROVED, TO THE EXTENT APPLICABLE, BY CUSTOMER'S GOVERNING BOARD. ACCEPTANCE OF THIS PROPOSAL IS EXPRESSLY LIMITED TO THE TERMS CONTAINED IN THIS PROPOSAL AND COMPANY'S PURCHASING TERMS AND CONDITIONS. ANY ADDITIONAL OR DIFFERENT TERMS, WHETHER CONTAINED IN CUSTOMER'S FORMS OR OTHERWISE PRESENTED BY CUSTOMER AT ANY TIME, ARE HEREBY REJECTED.

**INTENDING TO CREATE A BINDING AGREEMENT,** Customer and Company have each caused this Proposal to be executed by their duly authorized representatives as of date of the last signature below.

**Customer:** City of Delray Beach Fire Rescue

By: \_\_\_\_\_

Title: \_\_\_\_\_

Print: \_\_\_\_\_

Date: \_\_\_\_\_

**Ten-8 Fire & Safety, LLC**

By: 

Title: **Authorized Sales Representative**

Print: **Michael Day**

Date: **November 7, 2025**

EXHIBIT A

**PROPOSAL OPTION LIST**



LOGO  
ARTWORK PENDING



LETTERING  
GOLD REFL.  
BLACK NON REFL. OUTLINE

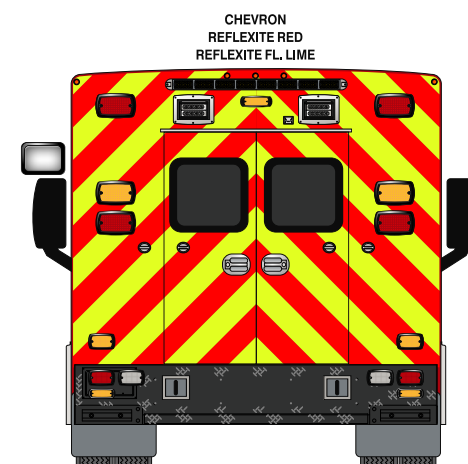

DRAWING IS FOR VISUAL PURPOSE ONLY. OPENINGS, HARDWARE AND BODY CONTOURS MAY VARY AFFECTING OUTCOME OF FINAL LAYOUT.

THIS DESIGN & ENGINEERING IS SUBMITTED AS OUR PROPOSAL AND IS TO REMAIN OUR PROPERTY EXCLUSIVELY UNTIL ACCEPTED AND APPROVED BY PURCHASE COPYRIGHT 2022 ©



**GRAPHICS**

AUTHORIZATION SIGNATURE

DRAWING BY: HAILI KNEPPER

CUSTOMER: DELRAY BEACH

JOB#

DATE: 10-17-25

REV.

DIMENSIONS ARE APPROXIMATE  
 OVERALL HEIGHT = 123" APROX  
 WITH CONDENSOR  
 OVERALL WIDTH WITH RUB  
 RAILS & FENDERETTES = 98"

TRIPLE CORE CONDENSER WITH (3) WHELEN 700 LED  
 LIGHTS: R/W/R WITH CLEAR LENSES, ATTACHED TO  
 FRONT OF SHROUD. A SECOND ENGINE DRIVEN  
 COMPRESSOR

(2) AMBER  
 MINI-LED MARKER LIGHTS

(2) WHELEN 900 RED  
 SUPER LED LIGHTS  
 WITH CLEAR LENSES

360 CAMERA WITH  
 WINDSHIELD MOUNTED  
 MONITOR

AIR HORNS ON  
 FENDERS

FLASHING HEADLIGHTS W/  
 DAYTIME RUNNING LIGHTS

(2) WHELEN RED 700 LED GRILLE  
 LIGHTS W/CLEAR LENSES

HIDDEN UNLOCK SWITCH  
 IN GRILLE AREA

(2) 100 WATT SIREN SPEAKERS  
 RECESSED INTO BUMPER

WHELEN HOWLER SIREN SYSTEM  
 BEHIND THE BUMPER

THIS DRAWING IS FOR REPRESENTATIONAL PURPOSES ONLY. DETAILS ARE CONCEPTUAL AND ARE SUBJECT TO CHANGE DURING DESIGN AND CONSTRUCTION  
 DIMENSIONS ARE APPROXIMATE UNLESS NOTED OTHERWISE TO MEET A SPECIFIC CUSTOMER NEED.

DELRAY BEACH



FRONT EXTERIOR VIEW-STANDARD CAB  
 SUPER CHIEF-I/FREIGHTLINER M2 CREW CAB

DATE:  
 11-6-25  
 DWG. SER NR  
 DATE:

DRAWING NO.  
 CPQ-13558  
 DELRAY-1

APPROVAL SIGNATURE:

DIMENSIONS ARE APPROXIMATE  
 OVERALL HEIGHT = 112" APROX  
 WITH CONDENSER  
 OVERALL WIDTH WITH RUB  
 RAILS & FENDERETTES = 98"

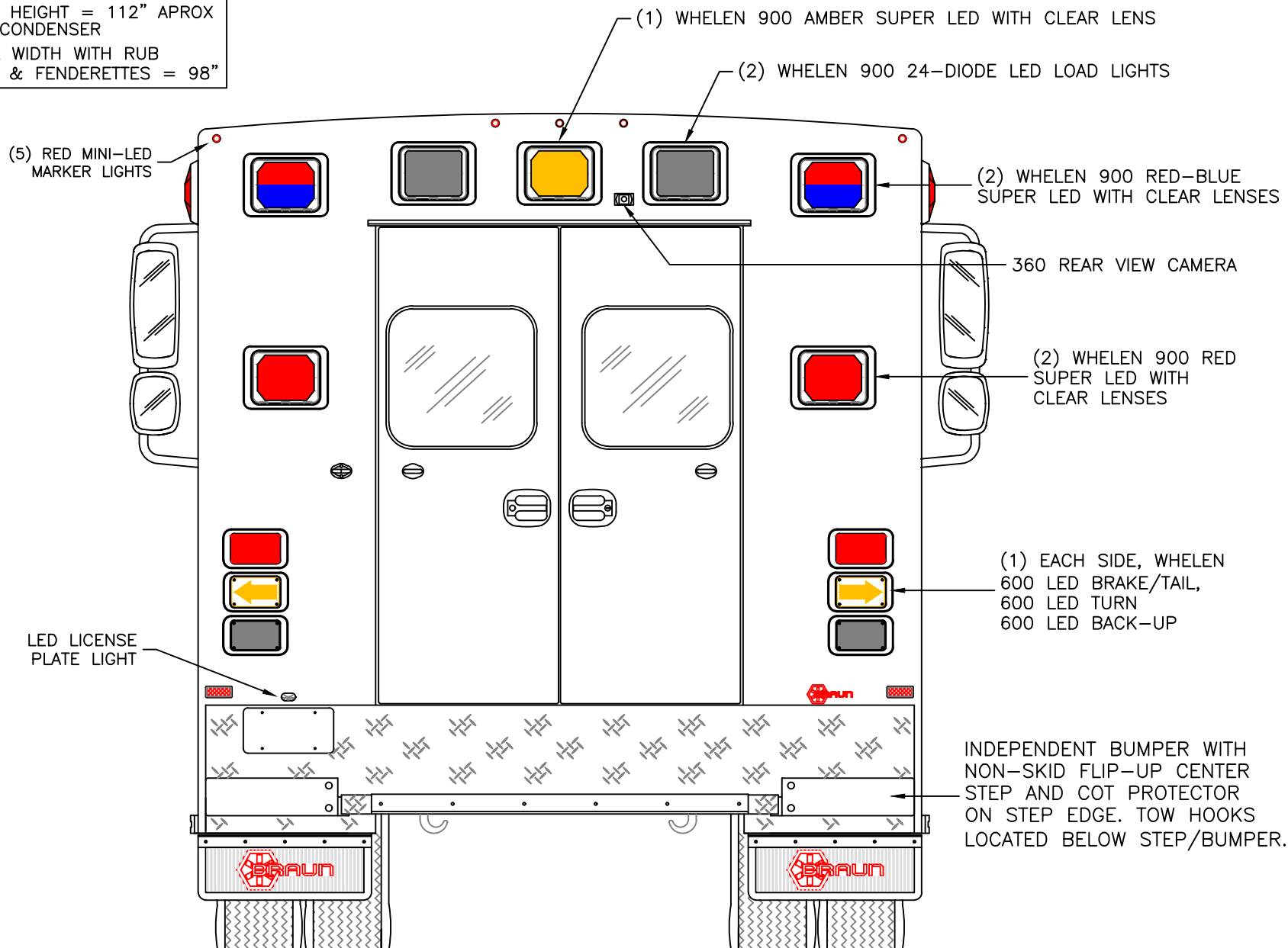

THIS DRAWING IS FOR REPRESENTATIONAL PURPOSES ONLY. DETAILS ARE CONCEPTUAL AND ARE SUBJECT TO CHANGE DURING DESIGN AND CONSTRUCTION  
 DIMENSIONS ARE APPROXIMATE UNLESS NOTED OTHERWISE TO MEET A SPECIFIC CUSTOMER NEED.

DELRAY BEACH



REAR EXTERIOR VIEW  
 SUPER CHIEF-I/FREIGHTLINER M2 CHASSIS

DATE:  
11-6-25  
DWG. SER NR

DRAWING NO.  
CPQ-13558  
DELRAY-2

DIMENSIONS ARE APPROXIMATE  
 OVERALL HEIGHT = 123" APROX  
 WITH CONDENSOR  
 OVERALL LENGTH = 332.5"  
 MODULE LENGTH = 170"  
 WHEELBASE SHOWN = 222"  
 CAB-TO-AXLE = 108"

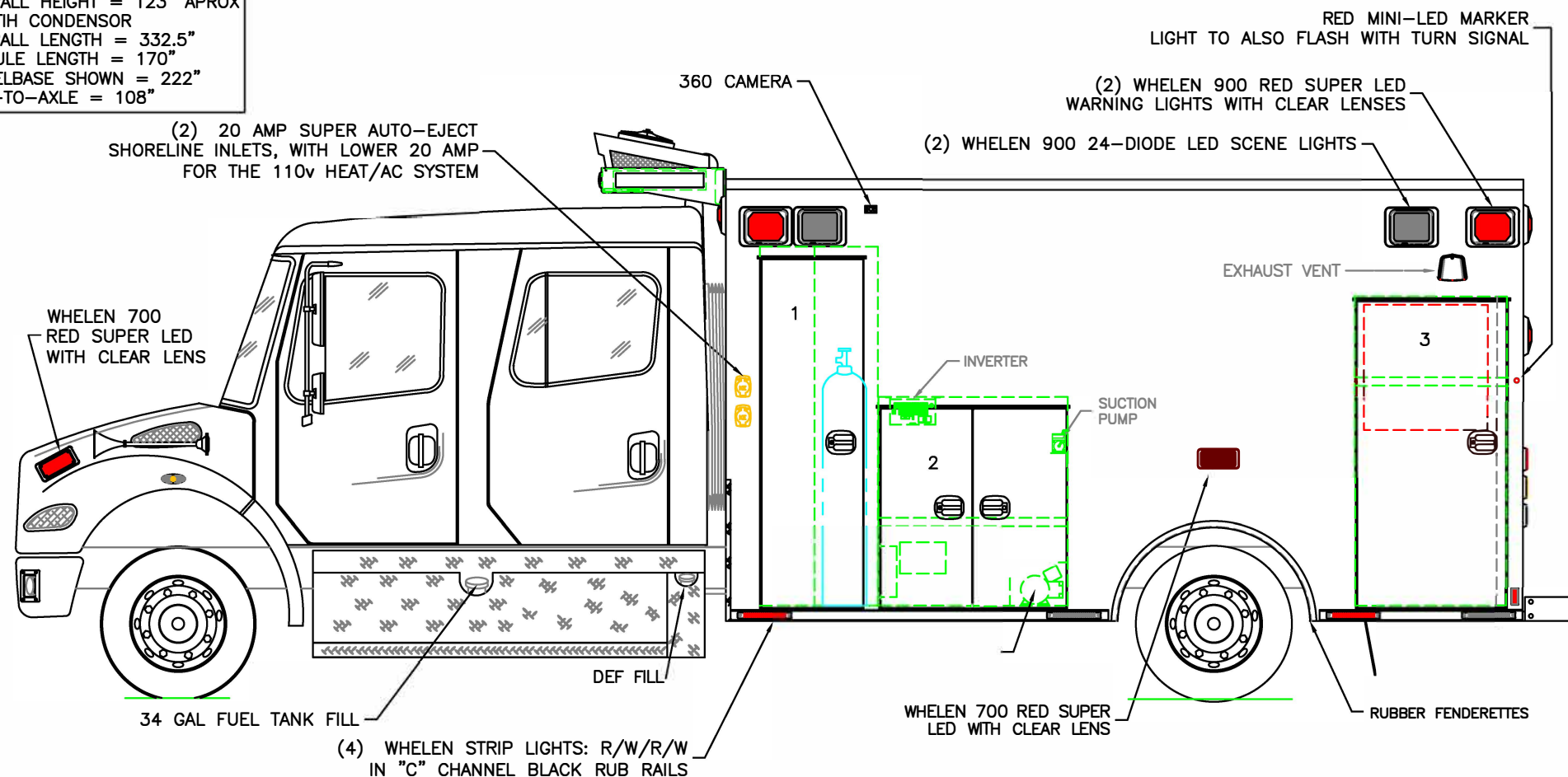

#### COMPARTMENT

##### O.S.S #1

CLEAR OPENING: 73.00h x 18.25w  
 INSIDE DIM'S.: 76.50h x 25.00w x 21.75d  
 VERTICAL DIVIDER  
 MAIN OXYGEN STORAGE REARWARD OF DIVIDER  
 BACKBOARD/SCOPE STORAGE FORWARD OF DIVIDER

##### O.S.S #2

CLEAR OPENING: 41.25h x 34.75w  
 INSIDE DIM'S.: 44.50h x 40.25w x 21.75d  
 (1) ADJUSTABLE SHELF  
 110V HEAT/AC ELECTRICAL COMPONENTS

##### O.S.S #3

CLEAR OPENING: 64.25h x 28.75w  
 INSIDE DIM'S.: 66.00h x 32.50w x 21.75d  
 INSIDE/OUTSIDE ACCESS  
 (1) ADJUSTABLE SHELF

THIS DRAWING IS FOR REPRESENTATIONAL PURPOSES ONLY. DETAILS ARE CONCEPTUAL AND ARE SUBJECT TO CHANGE DURING DESIGN AND CONSTRUCTION  
 DIMENSIONS ARE APPROXIMATE UNLESS NOTED OTHERWISE TO MEET A SPECIFIC CUSTOMER NEED.

DELRAY BEACH



STREETSIDE EXTERIOR VIEW  
 SUPER CHIEF-I/FREIGHTLINER M2 CREW CAB CHASSIS

DATE:

11-6-25

DWG. SER

REV NR

DRAWING NO.

CPQ-13558  
 DELRAY-3

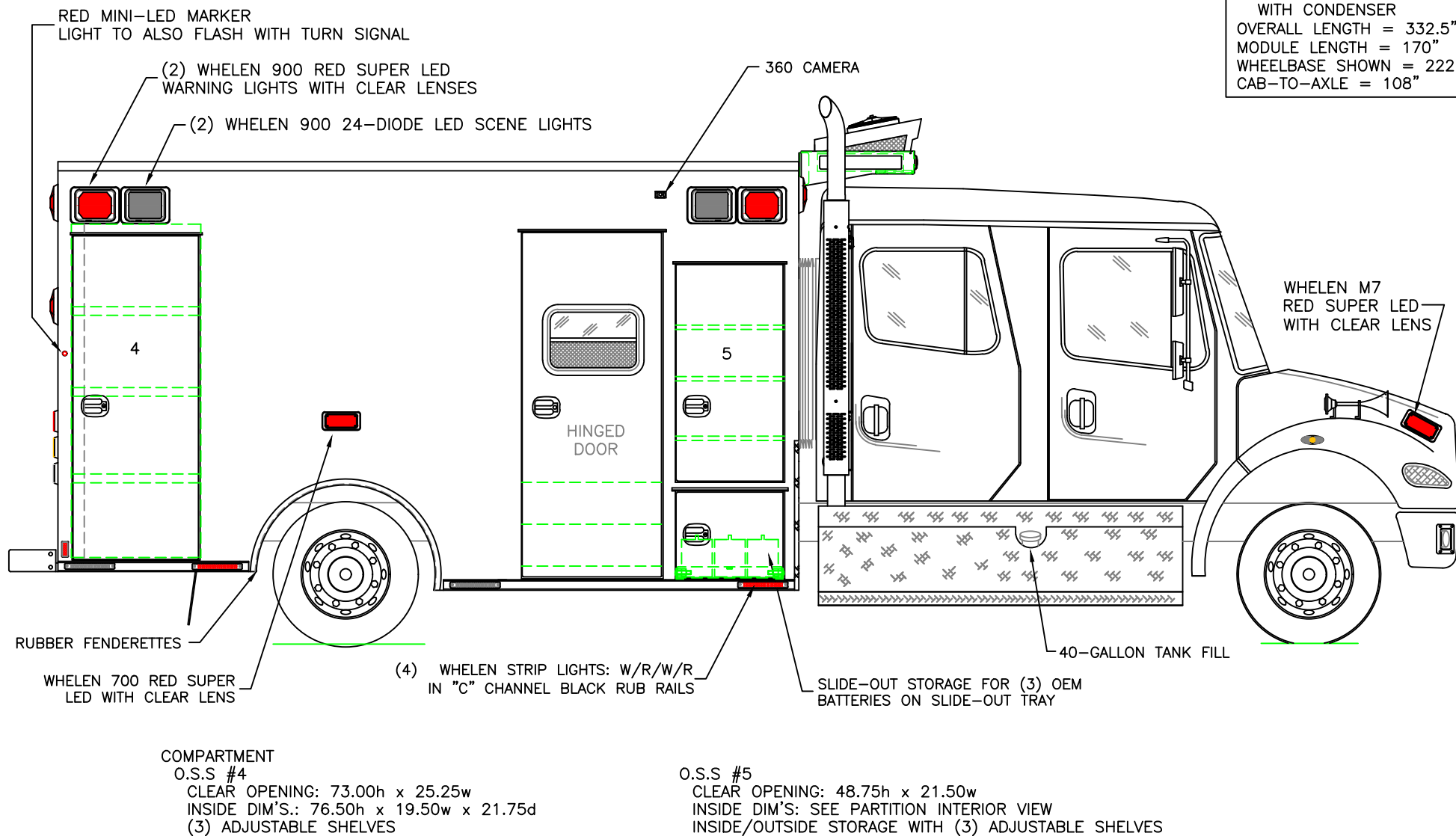

DIMENSIONS ARE APPROXIMATE  
OVERALL HEIGHT = 123" APROX  
WITH CONDENSER  
OVERALL LENGTH = 332.5"  
MODULE LENGTH = 170"  
WHEELBASE SHOWN = 222"  
CAB-TO-AXLE = 108"

THIS DRAWING IS FOR REPRESENTATIONAL PURPOSES ONLY. DETAILS ARE CONCEPTUAL AND ARE SUBJECT TO CHANGE DURING DESIGN AND CONSTRUCTION  
DIMENSIONS ARE APPROXIMATE UNLESS NOTED OTHERWISE TO MEET A SPECIFIC CUSTOMER NEED.

DELRAY BEACH



CURBSIDE EXTERIOR VIEW  
SUPER CHIEF-I/FREIGHTLINER M2 CREW CAB CHASSIS

DATE:	11-6-25	DRAWING NO.	CPQ-13558
DWG. SER	REV. NR	DELRAY-4	



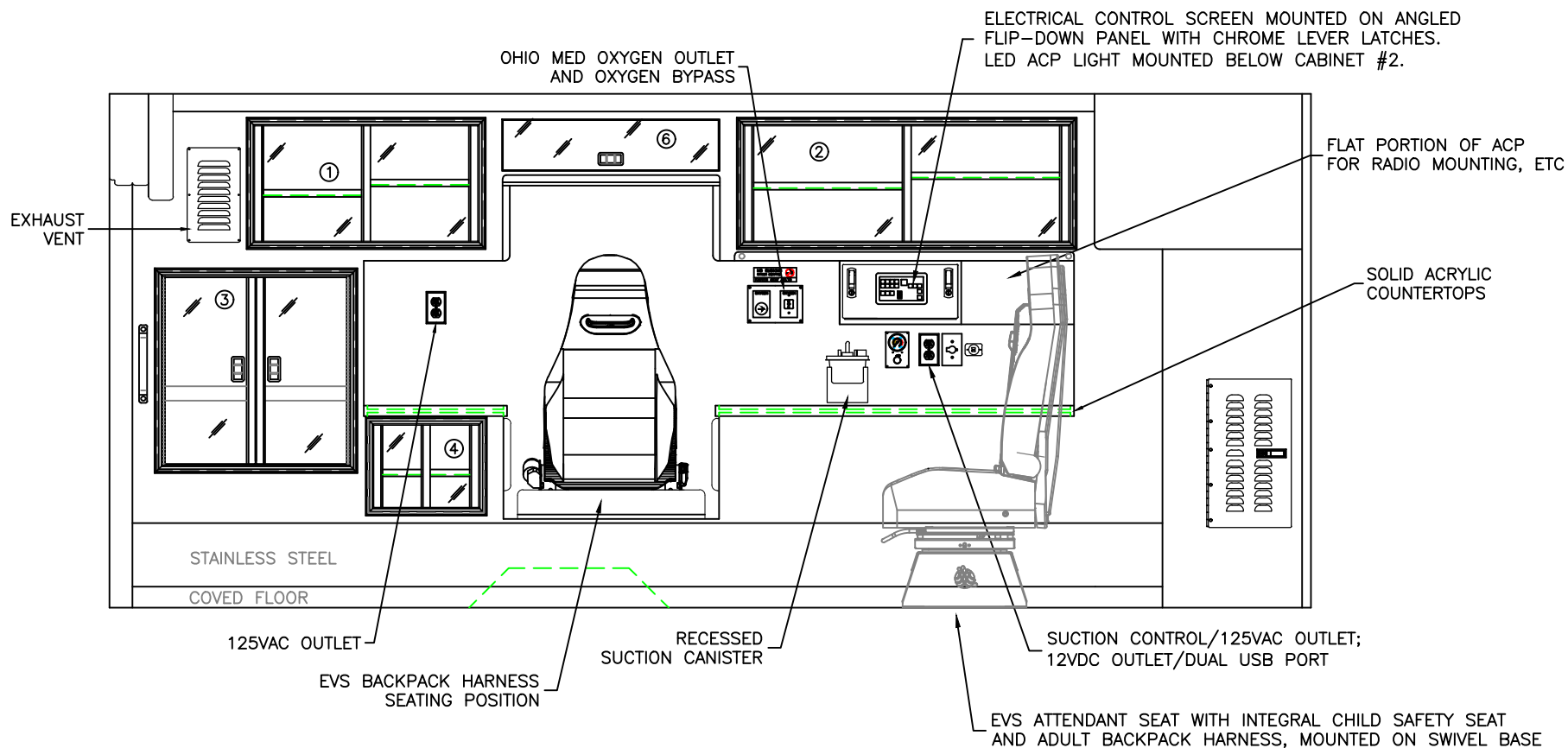

#### COMPARTMENT

#1 DOOR OPENING: 16.25h x 31.50w  
 INSIDE DIMS: 17.75h x 33.00w x 19.25d  
 (1) ADJ SHELF EACH SIDE OF CENTER DIVIDER  
 SLIDING POLYCARBONATE DOORS  
 TOTAL CABINET WEIGHT RATING = 25 lbs.

#2 DOOR OPENING: 16.25h x 45.75w  
 INSIDE DIMS: 17.75h x 47.25w x 19.25d  
 (1) ADJ SHELF EACH SIDE OF CENTER DIVIDER  
 SLIDING POLYCARBONATE DOORS  
 TOTAL CABINET WEIGHT RATING = 25 lbs.

#3 DOOR OPENING: 26.50h x 26.25w  
 INSIDE DIMS: O.S.S. #3  
 HINGED POLYCARBONATE DOORS WITH FULL LENGTH  
 HANDLES AND CENTER SQUEEZE LATCHES  
 TOTAL CABINET WEIGHT RATING = 40 lbs.

#4 DOOR OPENING: 11.50h x 14.75w  
 INSIDE DIMS: 13.00h x 16.25w x 19.25d  
 (1) ADJUSTABLE SHELF  
 SLIDING POLYCARBONATE DOORS  
 TOTAL CABINET WEIGHT RATING = 15 lbs.

#5 NOT USED IN THIS DISPLAY

#6 DOOR OPENING: 7.25h x 30.75w  
 INSIDE DIMS: 7.25h x 30.75w x 19.25d  
 TOP HINGED POLYCARBONATE DOORS  
 TOTAL CABINET WEIGHT RATING = 10 lbs.

THIS DRAWING IS FOR REPRESENTATIONAL PURPOSES ONLY. DETAILS ARE CONCEPTUAL AND ARE SUBJECT TO CHANGE DURING DESIGN AND CONSTRUCTION  
 DIMENSIONS ARE APPROXIMATE UNLESS NOTED OTHERWISE TO MEET A SPECIFIC CUSTOMER NEED.

DELRAY BEACH



STREETSIDE INTERIOR VIEW  
 SUPER CHIEF-I

DATE: 11-6-25		DRAWING NO. CPQ-13558 DELRAY-5
DWG. SER	REV. NR	



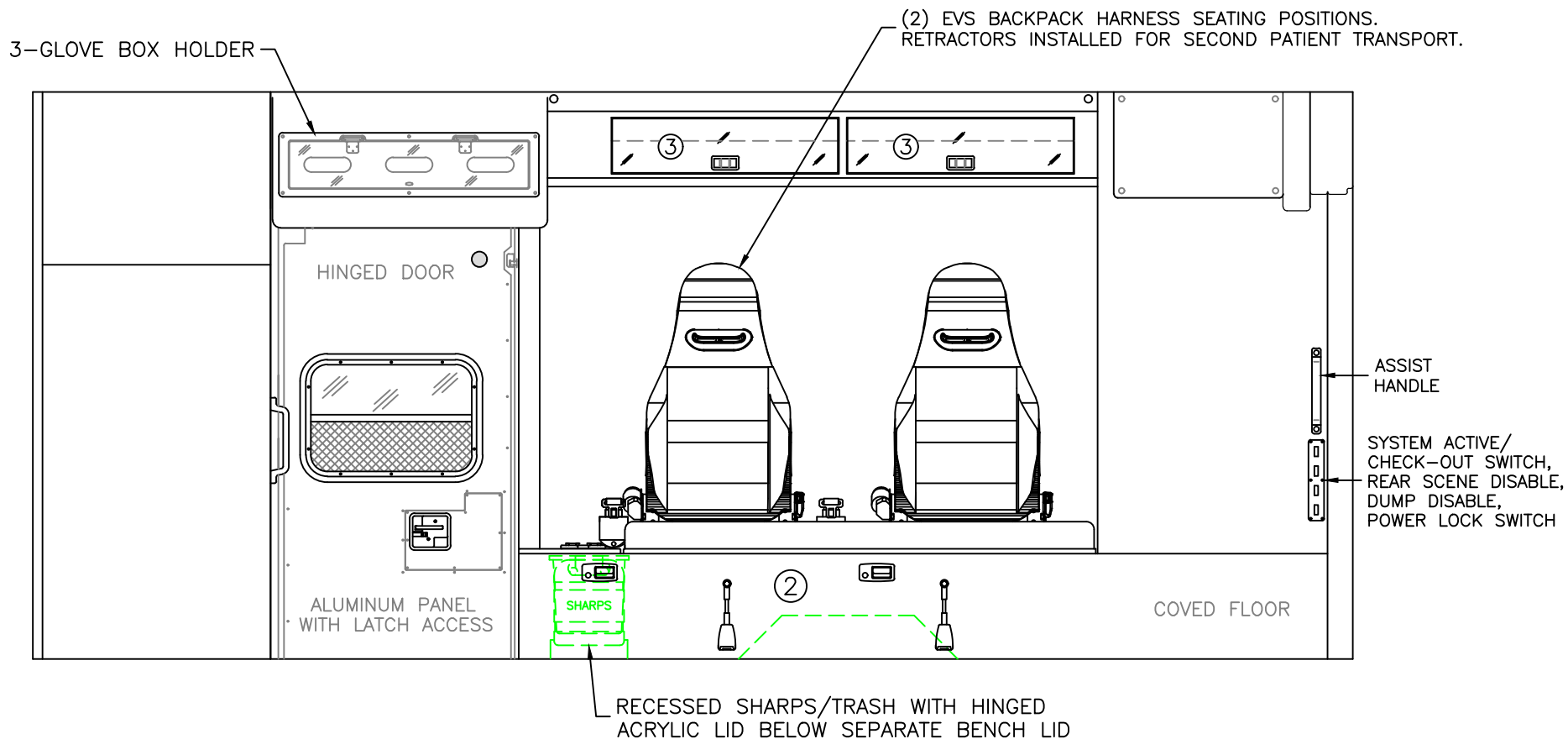

THIS DRAWING IS FOR REPRESENTATIONAL PURPOSES ONLY. DETAILS ARE CONCEPTUAL AND ARE SUBJECT TO CHANGE DURING DESIGN AND CONSTRUCTION  
DIMENSIONS ARE APPROXIMATE UNLESS NOTED OTHERWISE TO MEET A SPECIFIC CUSTOMER NEED.

DELRAY BEACH



CURBSIDE INTERIOR VIEW  
SUPER CHIEF-I

DATE:  
11-6-25  
DWG. SER  
REV. NR

DRAWING NO.  
CPQ-13558  
DELRAY-6

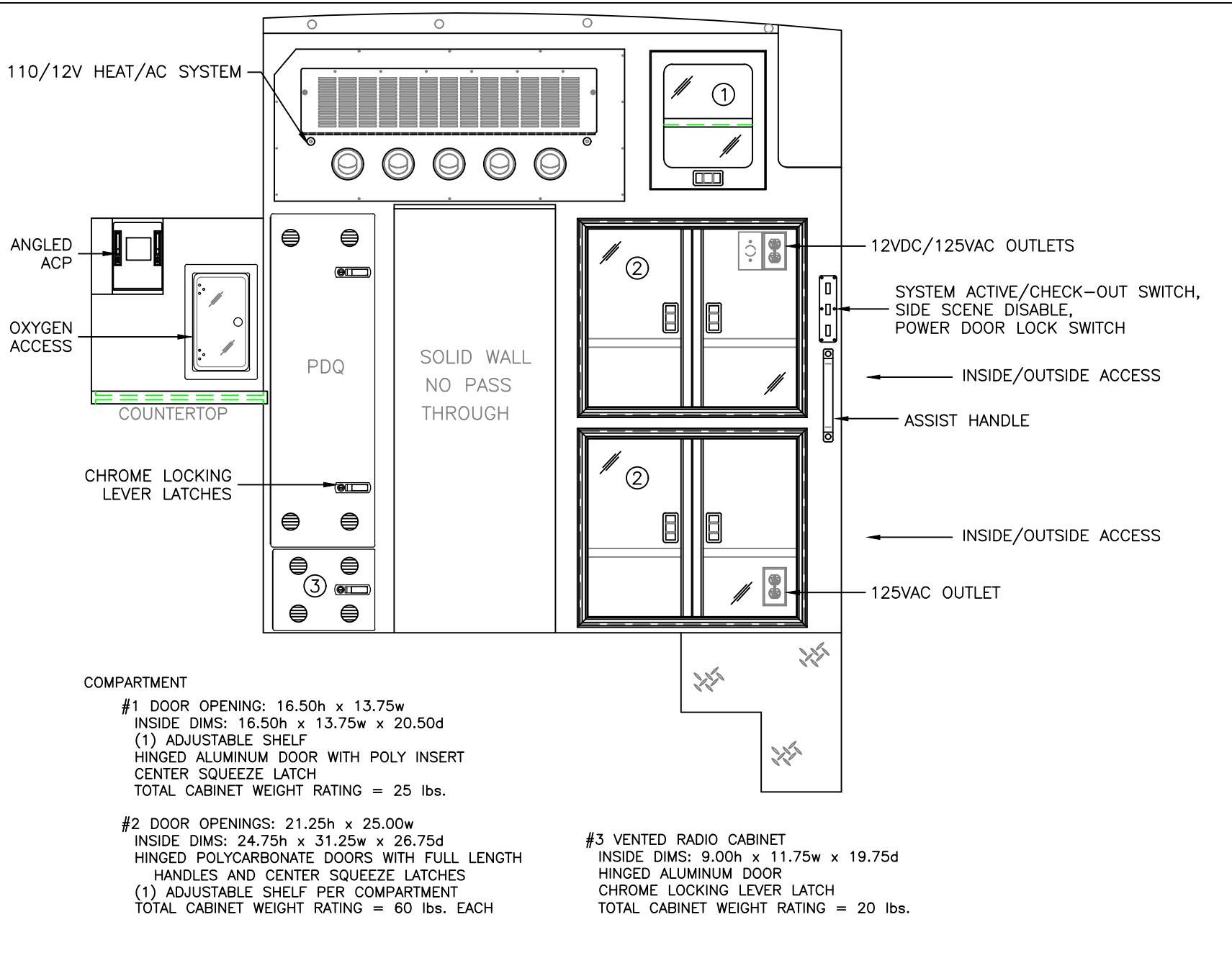

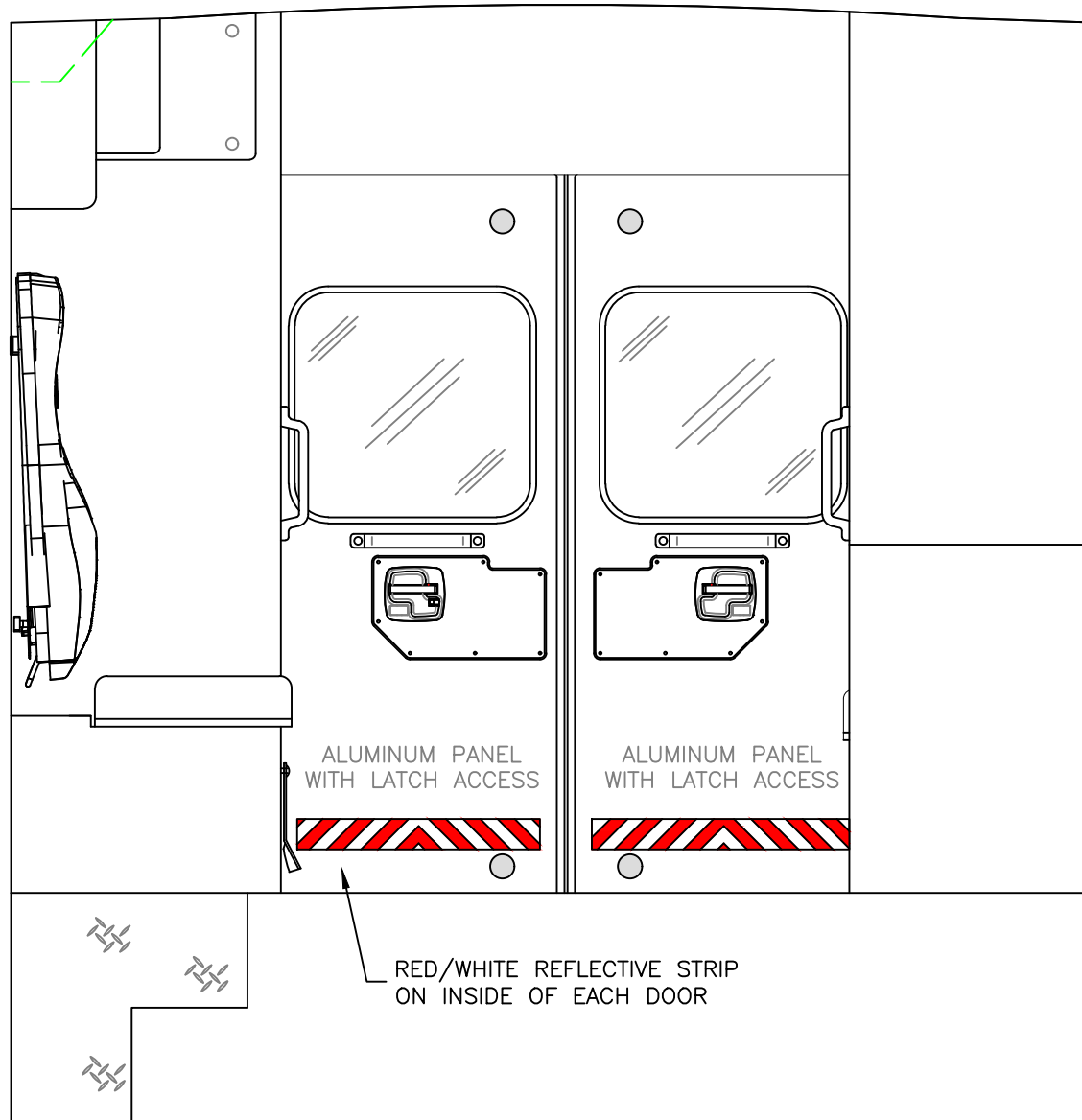

THIS DRAWING IS FOR REPRESENTATIONAL PURPOSES ONLY. DETAILS ARE CONCEPTUAL AND ARE SUBJECT TO CHANGE DURING DESIGN AND CONSTRUCTION  
 DIMENSIONS ARE APPROXIMATE UNLESS NOTED OTHERWISE TO MEET A SPECIFIC CUSTOMER NEED.

DELRAY BEACH



REAR INTERIOR VIEW  
 SUPER CHIEF-I

DATE: 11-6-25  
 DWG. SER NR

DRAWING NO. CPQ-13558  
 DELRAY-8

RECESSED SHARPS/TRASH WITH HINGED  
ACRYLIC LID BELOW SEPARATE BENCH LID

(8) LED  
DOME LIGHTS

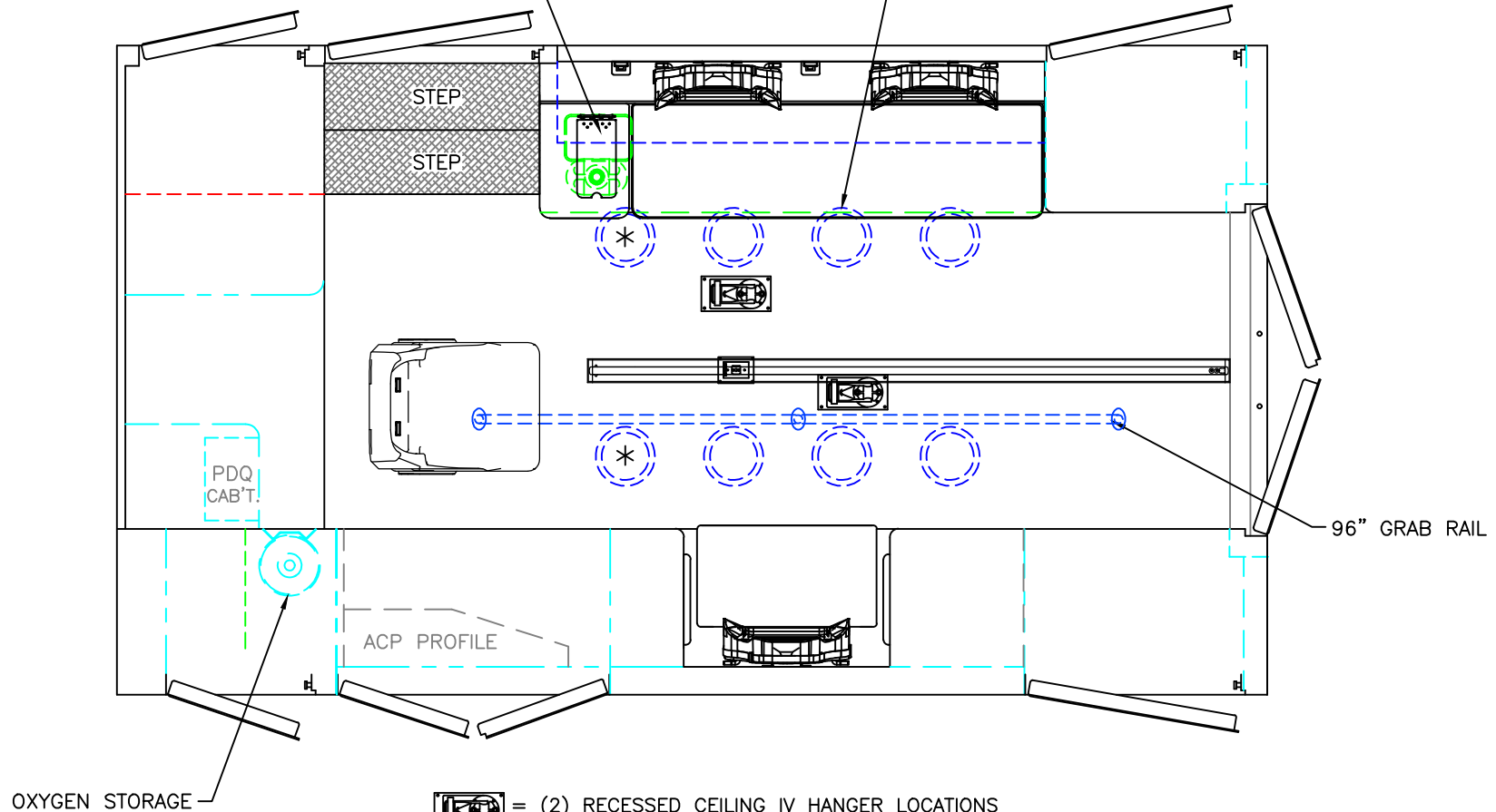

= (2) RECESSED CEILING IV HANGER LOCATIONS

= (1) CEILING OXYGEN OUTLET

\* (2) ANTENNA BASES LOCATED OUTBOARD OF  
DOME LIGHTS WITH COAX SERVICE LOOP

STRYKER FLOOR PLATE AND PRE-WIRE - CENTER MOUNT

MODULE WIDTH = 96"  
MODULE LENGTH = 170"  
MODULE HEAD ROOM = 73.5"

THIS DRAWING IS FOR REPRESENTATIONAL PURPOSES ONLY. DETAILS ARE CONCEPTUAL AND ARE SUBJECT TO CHANGE DURING DESIGN AND CONSTRUCTION  
DIMENSIONS ARE APPROXIMATE UNLESS NOTED OTHERWISE TO MEET A SPECIFIC CUSTOMER NEED.

DELRAY BEACH



FLOOR INTERIOR VIEW  
SUPER CHIEF-I

DATE: 11-6-25  
DWG. SER  
REV. NR

DRAWING NO.  
CPQ-13558  
DELRAY-9



## Quotation Summary

City of Delray Beach Standard Super Chief 2 2025-11-07 06-40-03

**Reference:** QUO0000013558 **Rev:** 2  
**Purchaser:** Ten-8 Fire Equipment, Inc.  
**Contact:** Cindy Morgan  
**Address:** 2904 59th Ave. Dr. East  
Brandenton, FL  
34203  
USA

**Telephone:**

**Sales Contact:** Michael Day  
**Mobile:** 3525725399  
**Phone:**

**Opportunity:** Delray Beach MY25  
**Account:** City of Delray Beach  
**Contact:** Andrew Rayfield  
**Billing Address:** 434 South Swinton Ave.  
Delray Beach, Florida 33444

**Currency:** United States  
USD  
**Quotation Date:** 2025-11-07  
**Quote Exp Date:** 2025-12-07  
**Price Effective:** 2025-11-04  
**Factory Contact:** Chuck Burgess  
**Mobile:** 4196517924

### Name

Super Chief

### Specifications

-73" Headroom  
-170"L Full Seam Welded Module





## Sales Options by Category

### Braun - KKK Change Notice

Item Number	Description	Quantity
00-01-0001	GENERAL CONDITIONS	1.00
00-01-0006	DYNAMIC SIDE IMPACT & ROLLOVER TESTS	1.00
00-01-0017	BIDDER IS KKK-A-1822F AMENDMENT 1 COMPLIANT	1.00
80-10-0000	KKK-A-1822F COMPLIANCE PACKAGE KKK-A-1822F compliance sticker, electrical load analysis sticker, and payload sticker shall be installed in the oxygen compartment. Any deviations from KKK-A-1822F shall be listed in the vehicle delivery packet with a notation on the-compliance sticker.	1.00
00-01-0029	NO CONTRACT REQUIRED NO STS, HGAC, FSA, SOURCEWELL or GPO contract required	1.00
00-01-0053	NO BOND REQUIRED No Bond is Required	1.00

### Braun - Chassis

Item Number	Description	Quantity
SR00223084	Chassis is to be a Freightliner Crew cab chassis. Chassis is to have steel rims painted black, 19.5" tires, air ride, vertical exhaust, second engine driven compressor and a 4" raised cab height.	1.00
00-01-0040	Administration Fee	1.00
MODULE_SCM2	TYPE I - AMBULANCE - SUPER CHIEF I - 73 INCH INTERIOR HEADROOM Super Chief Type I - 170" Module - 73.5" Interior Headroom. Manufactured in Van Wert, Ohio, USA.	1.00
15-00-0010	FUEL TANK - FULL UPON FACTORY RELEASE The chassis fuel tank of the completed unit shall be full at time of release from the ambulance manufacturer's facility.	1.00
20-10-0603	ENGINE BLOCK HEATER - OEM PLUG An engine block heater shall be included in the chassis with the 125 VAC power cord.	1.00
20-20-0277A	HIGH IDLE SYSTEM - A A high-idle function will be added to the chassis. The high idle will be engaged automatically by the M-Tech system when all chassis parameters are met. Chassis parameters include but not limited to vehicle in park, service brake not depressed, accelerator not depressed, parking brake set and battery voltage. High-idle may also be activated by the cruise control or M-Tech heat or A/C.	1.00



20-10-0105	<b>SUSPENSION - LIQUID SPRING - M2</b> Install: Liquid Spring Suspension System	1.00
20-10-0212	<b>BATTERY - TWO SYSTEM - M2</b> Chassis: (2) OEM supplied battery, 12 volt maintenance free 1900 CCA threaded stud batteries.	1.00
20-21-0501	<b>FLOOR CONSOLE M2 STANDARD CONSOLE - ALUMINUM</b> PLEASE NOTE: Must reference the attached console drawing for specific layout design.	1.00
30-10-0018	<b>AIR HORNS - BUELL DUAL TRUMPETS 12" &amp; 15", ON FENDERS W/SW Standard location(s) unless otherwise specified.</b> Mount: Air Horn - (Buell) dual trumpets, (1) 12" and (1) 15", on the chassis fenders, plumb to chassis air tank, horns activated by a switch.	1.00
HVAC_EC_04	<b>HVAC - COMPRESSOR - SECONDARY ENGINE DRIVEN - OEM</b> Install a separate engine mounted compressor, providing AC to patient compartment.	1.00
30-10-0030	<b>BACKUP ALARM</b> Install: (OSHA approved) back up alarm with a disable control for silent backing, located on the MCC (master control console).	1.00
20-30-0811	<b>CAB STEPS - STAR PUNCHED DP - M2-F650</b> Install: Exterior cab step covers shall be constructed of diamond plate material/ star punched non-skid surface/ step covers over the DEF tank area /flip down access panel to access the DEF tank.	1.00
30-10-0747	<b>HOWLER - SIREN &amp; SPEAKER SYSTEM / OPERATED VIA MECHANICAL SWITCH</b> Install Whelen Howler siren & speaker system, to be activated by mechanical switch on MCC.	1.00
20-30-0212	<b>M2 - MIRRORS, WEST COAST HEATED-REMOTE</b> The chassis shall have OEM exterior mirrors. The mirrors shall be West coast bright finish heated mirrors with LH and RH remote, include 8" bright finish convex mirrors mounted under the primary mirrors.	1.00
20-30-0261	<b>OEM AUTO-LOCK DISABLED (cab &amp; module doors do not auto lock or unlock)</b> The OEM auto-lock feature will be disabled.	1.00
30-10-0753	<b>SIREN, WHELEN 295-HFSA7-REMOTE WITH MICROPHONE (Meets CA Title 13)</b> A Whelen 295-HFSA7 remote dual siren amplifier shall be flush-mounted in the master control console located in the cab. The siren shall be capable of hands-free operation and shall be equipped with a noise canceling microphone. (Meets CA Title 13)	1.00
30-10-0811	<b>SIREN SPEAKERS, CAST PRODUCTS - IN FRONT BUMPER - M2</b> Install: Two (2) Cast Products - 100-watt siren speakers shall be installed in the front bumper (or to accommodate chassis options).	1.00
20-30-0900	<b>STABILIZER BAR REAR - NOT REQUIRED</b> Stabilizer Bar, rear, not required.	1.00
20-30-0400	<b>TIRE PRESSURE MONITOR - QuickPressure</b>	1.00





20-40-0208 20	Install QuickPressure tire pressure caps. (must check tire PSI to select correct QuickPressure Model) <b>OEM WHEELS - WITH VALVE STEM EXTENSIONS - MED DUTY - Wheels to be Steel</b> Provide: OEM wheels and valve extensions. -----	1.00
---------------	---	------

### Braun - Electrical

Item Number	Description	Quantity
30-06-0001	<b>ELECTRICAL SYSTEM - MICRO PROCESSOR BASED</b> Install: Microprocessor based multiplex system. -----	1.00
30-10-0110	<b>ELECTRICAL CIRCUITS</b> All electrical circuits: shall have wiring and circuit protection suitable to the demand and must meet the national electric code (NEC) wiring requirements, added on wiring (18 GA through 10 GA) color coded and stamped with code numbers for easy identification, SLX high temperature thermoplastic cross link wire used. SGX insulated cable used for all under hood / underbody battery and charging system cable. High temperature (375° f) thermoplastic loom used on all harnesses. -----	1.00
30-06-0126	<b>ELECTRICAL COMPARTMENT (PDQ) - MULTIPLEX ELECTRICAL SYSTEM</b> Electrical compartment / hinged door w/ (2) chrome locking lever latches/ located on the partition wall behind the attendant seat. -----	1.00
30-06-0325	<b>FLASHER - MULTIPLEX ELECTRICAL SYSTEM</b> Provide: Flasher within and programmed by the multiplex electrical system. -----	1.00
30-06-0350	<b>FLASHING HEADLIGHTS - MULTIPLEX ELECTRICAL SYSTEM</b> Headlights (high beams) shall be programmed through the multiplex system to alternate flash (wig-wag). -----	1.00
30-10-0190	<b>GROUND FAULT CIRCUIT INTERRUPTER-GFCI</b> Install: A 125 VAC, 20 AMP circuit breaker with ground fault circuit interrupter (GFCI) electronic ground leakage detection in the load center for the shoreline circuit. -----	1.00
30-06-0285	<b>MODULE DISCONNECT - MULTIPLEX ELECTRICAL SYSTEM</b> Install: Disconnect to keep the system power engaged after the ignition is switched to the "off" position. -----	1.00
30-06-0575	<b>REVERSE -TRANSMISSION- FUNCTIONS - MULTIPLEX ELECTRICAL SYSTEM</b> System programmed to provide activation for: rear outboard warning lights, rear side warning lights, rear scene lights, the rear side scene lights - when the transmission selector lever is placed into "reverse" position. -----	1.00
30-06-0150	<b>SPARE CIRCUIT - MULTIPLEX ELECTRICAL SYSTEM</b> Provide (1) spare 15-amp circuit. -----	1.00
30-06-0175	<b>WIRING HARNESS CONNECTORS - MULTIPLEX ELECTRICAL SYSTEM</b> Connect all wiring harnesses via quick connect circular plug connectors. -----	1.00
30-06-0300	<b>VOLTMETER - MULTIPLEX ELECTRICAL SYSTEM</b>	1.00



	Provide: (1) digital voltmeter on the master control console screen.	
30-06-0026	<b>WARNING DISPLAY - MULTIPLEX ELECTRICAL SYSTEM</b> Install: digital warning display integrated into the cab display console, programmed through the multiplex system to provide visual and audible indication.	1.00
30-06-0225	<b>EMERGENCY MASTER SWITCH - MULTIPLEX ELECTRICAL SYSTEM</b> Supply: A single emergency master switch for activating all the emergency warning lights on the master control console screen, emergency master switch will activate the module power automatically, include an Emergency Master Menu button to allow access to individual warning light functions.	1.00
30-06-0250	<b>CONTROL PANEL SWITCHES - MULTIPLEX ELECTRICAL SYSTEM</b> Switches on the master control console and attendant control panel screens shall have dimmable perimeter backlighting.	1.00
30-06-0275	<b>MODULE POWER SWITCH - MULTIPLEX ELECTRICAL SYSTEM</b> Provide: A module power switch for the electrical system on both the Master Control Console and the Attendant Control Panel screens.	1.00
30-06-0101	<b>ATTENDANT CONTROL PANEL (ACP) - MULTIPLEX ELECTRICAL SYSTEM</b> Attendant Control Panel (ACP) contains a color micro processor screen, controls all equipment installed in the patient compartment. ***Only applies when an ACP screen is selected***	1.00
30-06-0375	<b>PARK OVERRIDE - MULTIPLEX ELECTRICAL SYSTEM</b> Park override switch on the master control console screen, reactivates all lights disabled when the transmission is placed in the neutral/park position.	1.00
30-06-0400	<b>LOAD MANAGER-SEQUENTIAL SWITCHING SYSTEM - MULTIPLEX ELECTRIC SYSTEM</b> Load manager-sequential switching system controlled by the microprocessor based electrical system: emergency master button shall control the sequential switching of the emergency lights and/or other warning devices, load manager shall automatically shed non-critical electrical loads during low voltage conditions.	1.00
30-06-0450	<b>FRONT CLEAR DISABLE SWITCH - MULTIPLEX ELECTRICAL SYSTEM</b> Activation of the switch on the master control console screen to disable all forward-facing clear warning lights.	1.00
30-06-0076	<b>MASTER CONTROL CONSOLE (MCC) - MULTIPLEX ELECTRICAL SYSTEM</b> Floor mounted Master Control Console (MCC) located in the cab, housing siren, color microprocessor display screen, controlling all the Emergency Warning functions, Patient Compartment lighting and module heat/ac functions.	1.00
30-06-0475	<b>CURBSIDE SCENE LIGHTS ON WITH CURBSIDE DOOR</b> The Curbside scene lights: programmed to activate when the Curbside door is in the open position.	1.00
30-06-0500	<b>REAR SCENE LIGHTS ON WITH REAR DOORS OPEN</b> Rear scene lights programmed to activate when the rear doors are in the open position.	1.00
30-06-0525	<b>DISABLE SWITCH FOR REAR SCENE LIGHTS - MULTIPLEX ELECTRICAL SYSTEM</b>	1.00



	Install: disable switch at the rear door area to disable the rear scene lights.	
30-06-0550	<b>DISABLE SWITCH FOR SIDE SCENE LIGHTS - MULTIPLEX ELECTRICAL SYSTEM</b> A disable switch shall be installed at the curbside door area to disable the curbside scene lights.	1.00
30-07-0001	<b>CONTROL SCREEN, MCC</b> Install: interface module / display screen in the cab.	1.00
30-07-0003	<b>CONTROL SCREEN, ACP</b> Install: interface module / display screen mounted on an angled flip - down panel with chrome lever latches, in the patient compartment ACP area.	1.00
30-10-0901	<b>SYSTEM ACTIVE AND CHECK OUT LIGHTS - 15 MINUTES</b> Switch: located at the curb and rear entry doors for activation of the electrical system, check out light switch located at the curb and rear doors for activation of the LED angled lights prior to entering the module, system programmed to shut down automatically after 15 minutes unless the ignition is on.	1.00
30-06-0050	<b>DAYTIME RUNNING LAMPS - MULTIPLEX ELECTRICAL SYSTEM</b> OEM Daytime Running Light headlights activated for daytime operation, when transmission is placed in drive.	1.00
30-10-0074	<b>FOUR CAMERA SYSTEM WITH 360 DEGREE SURROUND VIEW, WINDSHIELD MOUNT MONITOR</b> Install: color camera system with four (4) wide angle, waterproof cameras and 7-inch monitor installed as follows: one (1) camera mounted on front of chassis per dwg #1; one (1) camera mounted on rear of module per dwg #2; one (1) camera on street side of module per dwg #3; and one (1) camera on the curb side of the module per dwg #4. The monitor mounted on exterior windshield, system also includes the related cables / components for fit and function and operates on 12V.	1.00
30-10-0915	<b>SYSTEM AUTO ACTIVE WITH ENTRY DOOR OPEN OR UNLOCK SIGNAL</b> The system will auto activate when a module entry door is opened or when a door unlock signal is received.	1.00
30-10-0585	<b>USB - DUAL OUTLET, ONE (1) INTERIOR LOCATED ON CONSOLE</b> Install: (1) dual USB port outlet, 5 volt / 2.1 amp, in the vehicle, located on the Master Control Console in the cab.	1.00
USBAA101	<b>OUTLET, USB - ONE (1) DUAL - PRIMARY ACTION AREA</b> One (1) dual USB port outlet, 5 volt / 2.1 amp, shall be installed in the vehicle, located on the streetside primary action area in the patient compartment.	1.00
125AA101	<b>OUTLET, 125VAC - ONE (1) INTERIOR DUPLEX - LEFT WALL ACTION AREA</b> One (1) 2-wire +plus ground 125 VAC duplex outlet in the street side wall in the primary action area.	1.00
125AA201	<b>OUTLET, 125VAC - ONE (1) INTERIOR DUPLEX - SECONDARY ACTION AREA</b> One (1) 2-wire +plus ground 125 VAC duplex outlet in the street side wall in the secondary action area.	1.00



125ADD	<b>OUTLET, ADDITIONAL-125VAC One (1) additional 125V outlet is to be installed in the lower section of the lower front wall cabinet. #2</b>	1.00
	2-wire +plus ground 125 VAC duplex outlet(s) installed per the drawings.	
125IF201	<b>OUTLET, 125VAC - ONE (1) INTERIOR DUPLEX - FRONT WALL CABINET</b>	1.00
	One (1) 2-wire +plus ground 125 VAC duplex outlet in the front wall cabinet.	
30-10-0258	<b>INVERTER, VANNER - 1100 WATT, LIFESINE LSC 12-1100-DC CHARGER OSS#2</b>	1.00
	Install: Vanner LifeSine LSC 12-1100-DC watt inverter with battery conditioner / charger per drawing (non-hardwired).	
12VAA101	<b>OUTLET, 12VDC - ONE (1) - LEFT WALL ACTION AREA</b>	1.00
	One (1) 12 VDC power point outlet shall be installed in the street side wall in the primary action area. The outlet shall be labeled, "12 VDC". A Schottky diode medical isolator shall be provided to protect the 12 VDC outlet.	
12VIF201	<b>OUTLET, 12VDC - ONE (1) FRONT WALL - CABINET</b>	1.00
	One (1) 12 VDC power point outlet shall be installed in the patient compartment, in the front wall cabinet. The outlet shall be labeled, "12 VDC". A Schottky diode medical isolator shall be provided to protect the 12 VDC outlet.	
12VPREWIRE	<b>PRE-WIRE, 12VDC One (1) 12V pre-wire is to be installed in OSS #2. Drop is to be in the front forward corner of compartment.</b>	2.00
	<b>One (1) 12V pre-wire is to be installed in OSS #3. Drop is to be in the front forward corner of compartment.</b>	
	Install: 12VDC pre-wire, quantity(s) and location(s) per drawing(s).	
30-12-0001	<b>RECEPTACLE SHORELINE INLET-SUPER 20 AMP, AUTO EJECT - YELLOW COVER</b>	1.00
	Install: Kussmaul super auto eject shoreline inlet receptacle with yellow cover on module exterior per the drawings, equipped with an integral dynamic disconnect.	
30-12-0012	<b>RECEPTACLE SHORELINE INLET-SUPER 20 AMP, AUTO EJECT - YELLOW COVER - ADDITIONAL</b>	1.00
	Install: Kussmaul super auto eject shoreline inlet receptacle with yellow cover on module exterior per the drawings, equipped with an integral dynamic disconnect.	
30-10-0657	<b>RADIO ANTENNA BASES - TWO (2)</b>	1.00
	Install: (2) antenna bases with attached coax cables shall be installed on the module roof. The coax cables shall terminate in radio cabinet. If no radio cabinet is present, they will terminate behind the drivers seat in the cab. Access to the antenna bases shall be through adjacent module interior dome lights.	
30-10-0299	<b>LIGHT, ATTENDANT CONTROL PANEL AREA - TECNIQ SILHO-X LED - WARM WHITE</b>	1.00
	A Tecniq Silho-X 2.75" round warm white LED light with SS trim ring, shall be mounted above the left wall forward action area counter. The light shall be operated through a button on the control screen screen labeled "Attendant Light". (Braun #26415)	
30-10-0310	<b>LIGHT, LED ELECTRICAL COMPARTMENT -PDQ</b>	1.00
	A 12 VDC LED light shall be located in the PDQ. The light shall be wired "battery-hot" to activate when the PDQ door is in the open position. The light shall be off when the door is in the closed position.	
30-11-0106	<b>LIGHTS, DOME LED (8) WHELEN SUPER LED</b>	1.00
	Eight (8) Whelen #LED (80C0EHCR) dome lights, shall be installed. See dwg #9	



30-11-0155	<b>LIGHTS, DELETE LIGHTS ON PANEL STREETSIDE - ANGLED</b> Delete /omit lights on interior Streetside angled panel.	1.00
30-11-0156	<b>LIGHTS, DELETE LIGHTS ON PANEL CURBSIDE ANGLED</b> Delete / Omit lights on angled panel, Curbside interior.	1.00
30-10-0418	<b>LIGHTS, OSS COMPARTMENTS - RIDGEBACK LED STRIP LIGHTING</b> Install: White Ridgeback brand LED strip lighting, one each side of the door opening, activated by magnetic switch, all standard OSS compartments only, excluding battery compartment, lengths dependent on OSS dimensions.	1.00
40-10-0191	<b>LOCKS POWER - PASSAGE, 5 COMPARTMENTS, KEY FOBS</b> Install: power door locks on module passage doors, and (5) OSS compartments, use OEM key fobs. Does not include battery bay door.	1.00
40-10-0151	<b>SWITCH DOOR UNLOCK, WATERPROOF - HIDDEN IN FRONT GRILLE AREA</b> Install: exterior hidden door unlock switch in grille area.	1.00
30-06-0201	<b>RADIO TIE-IN POINT - (1) 12V/40 AMP - CAB CONSOLE AREA</b> Install (1) set of 12 volt/40 amp radio tie-in studs in cab console: (1) battery hot, (1) ignition hot, (1) grounded stud.	1.00
30-06-0202	<b>RADIO TIE-IN POINT - (1) 12V/40 AMP - PATIENT COMPARTMENT</b> Install (1) set of 12 volt/40 amp radio tie-in studs in patient compartment: (1) battery hot, (1) ignition hot, (1) grounded stud.	1.00
30-06-0203	<b>RADIO TIE-IN POINT - (1) 12V/250 AMP - PDQ</b> Install (1) set of 12 volt/250 amp radio tie-in studs in the PDQ: (1) battery hot, (1) ignition hot, (1) grounded stud.	1.00

#### **Braun - Exterior Lighting**

<b>Item Number</b>	<b>Description</b>	<b>Quantity</b>
30-06-0410	<b>WARNING LIGHTS FLASH PATTERN SIGNAL ALERT 75 - MULTIPLEX ELECTRICAL SYSTEM</b> The default flash pattern for the vehicle warning lights: Signal Alert 75.	1.00
ClearLENS	<b>CLEAR LENSES ON ALL WARNING LIGHTS</b>	1.00
GWL070002	<b>LIGHTS GRILLE - 2 WHELEN 700 SUPER LED</b> Two (2) Whelen 700 series super LED warning lights, with waterproof connectors shall be installed the grille area of the chassis. The lights shall operate from a switch on the master control console labeled "Flashers".	1.00
GWLC1R1R	<b>GRILLE WARNING LIGHT LOCATION 1 - RED</b> The warning light located on the grille in location 1 shall be red.	1.00
GWLC1R2R	<b>GRILLE WARNING LIGHT LOCATION 2 - RED</b> The warning light located on the grille in location 2 shall be red.	1.00
STRPTRN	<b>STRAIGHT PATTERN WARNING LIGHTS</b>	1.00



	The front warning lights will be aligned in a straight pattern across the module.	
30-25-0122	<b>LIGHTS, ICC / LED CLEARANCE - ON MODULE FRONT - TECNIQ</b> Install: (5) amber Tecniq LED (S33-AA00-1) clearance / ICC lights on the front of the module near the roof line per dwg #1.	1.00
FWL070003-1	<b>LIGHTS FRONT MODULE - (3) WHELEN 700 SUPER LED MOUNTED TO SHROUD AROUND THE CONDENSER</b> Mount (3) Whelen Super LED lights, red/white/red, to the shroud around the condenser per drawing. Shroud painted to match module color.	1.00
FWL090002	<b>LIGHTS FRONT MODULE - 2 WHELEN 900 SUPER LED</b> Two (2) Whelen 900 series super LED warning lights with chrome bezels shall be installed on the module front. The lights shall operate from a switch on the master control console, labeled "Flashers".	1.00
FWLCLR1R	<b>FRONT WARNING LIGHT LOCATION 1 - RED</b> The warning light located on the upper front of the module in location 1 shall be red.	1.00
FWLCLR2R	<b>FRONT WARNING LIGHT LOCATION 2 - RED</b> The warning light located on the upper front of the module in location 2 shall be red.	1.00
30-25-0123	<b>LIGHTS, ICC / LED CLEARANCE - ON MODULE REAR - TECNIQ</b> Install: (5) red TECNIQ LED (S33-RR00-1) clearance / ICC lights on the rear of the module near the roof line per dwg #2.	1.00
ROL090002	<b>LIGHTS REAR MODULE, UPPER OUTER - 2 WHELEN 900 LED</b> Two (2) Whelen 900 series super LED warning light with chrome bezels shall be installed on the upper rear of the module, in the outer location. The lights shall operate from a switch on the master control console, labeled "Flashers".	1.00
ROLCLR1RB	<b>REAR OUTER MODULE LIGHT LOCATION 1 - RED-BLUE</b> The warning light located on upper rear of the module, in outer location 1 shall be dual color red/blue.	1.00
ROLCLR2RB	<b>REAR OUTER MODULE LIGHT LOCATION 2 - RED-BLUE</b> The warning light located on upper rear of the module, in outer location 2 shall be dual color red/blue.	1.00
RCL090001	<b>LIGHTS REAR MODULE, UPPER CENTER - 1 WHELEN 900 LED</b> One (1) Whelen 900 series super LED warning light with a chrome bezel shall be installed on the upper rear of the module, center location. The light shall operate from a switch on the master control console, labeled "Flashers".	1.00
RCLCLR1A	<b>REAR CENTER MODULE LIGHT LOCATION 1-AMBER</b> The warning light located on upper rear of the module in the center location shall be amber.	1.00
RS090002	<b>LIGHTS REAR SCENE - 2 WHELEN 900 24 DIODE LED</b> Two (2) Whelen 900 Series super LED scene/load lights with chrome bezels shall be installed on the upper rear of the module. The lights shall operate from a switch on the master control console, labeled "Rear Scene Lights".	1.00



<b>WL090002</b>	<b>LIGHTS REAR WINDOW - 2 WHELEN 900 SUPER LED</b> Two (2) Whelen 900 series super LED warning lights with chrome flanges shall be installed on the rear of the module at window level, one (1) on each side. These lights shall operate from a switch on the master control console, labeled "Flashers". -----	<b>1.00</b>
<b>WLCLR1R</b>	<b>WINDOW LEVEL LIGHT LOCATION 1 - RED</b> The warning light located on rear of the module at window level, location 1 shall be red. -----	<b>1.00</b>
<b>WLCLR2R</b>	<b>WINDOW LEVEL LIGHT LOCATION 2 - RED</b> The warning light located on rear of the module at window level, location 2 shall be red. -----	<b>1.00</b>
<b>30-26-3009</b>	<b>LIGHTS, REAR TAIL - WHELEN 600 LED STOP, TURN, &amp; MAXIMUM INTENSITY BACK-UP</b> Install: (1) pair each of Whelen 600 series LED stop/tail lights, turn lights, and fully populated MAXIMUM intensity LED back-up lights with chrome bezels on rear of the module. -----	<b>1.00</b>
<b>30-26-7002</b>	<b>LIGHT, LICENSE PLATE LED - WHELEN OACOEDCR</b> Install:(1) Whelen OACOEDCR LED license plate light with 45 deg angled chrome-plated bezel on the rear of module, lower left side. -----	<b>1.00</b>
<b>FIL07F0002</b>	<b>LIGHTS FRONT INTERSECTION - 2 WHELEN 700 LED</b> Two (2) Whelen 700 series super LED warning lights, with chrome flanges and water-proof connectors, shall be mounted on the front chassis fenders, one (1) on each side. The lights shall operate from a switch on the master control console labeled "Flashers".NOTE: When vehicle is placed in park, the override switch must be on for intersection light(s) to remain on. -----	<b>1.00</b>
<b>FILCLR1R</b>	<b>FRONT INTERSECTION LIGHT LOCATION 1 - RED</b> The warning light located on front of the chassis fender in location 1 shall be red. -----	<b>1.00</b>
<b>FILCLR2R</b>	<b>FRONT INTERSECTION LIGHT LOCATION 2 - RED</b> The warning light located on front of the chassis fender in location 2 shall be red. -----	<b>1.00</b>
<b>RIL070002</b>	<b>LIGHTS INTERSECTION REAR - 2 WHELEN 700 LED</b> Two (2) Whelen 700 series super LED warning lights with, chrome flanges and water-proof connectors, shall be installed above the rear wheel wells, one (1) on each side. These lights shall operate from a switch on the master control console screen labeled "Flashers".NOTE: When vehicle is placed in park, the override switch must be on for intersection light(s) to remain on. -----	<b>1.00</b>
<b>RILCLR1R</b>	<b>REAR INTERSECTION LIGHT LOCATION 1 - RED</b> The warning light located on above the rear wheel well at location 1 shall be red. -----	<b>1.00</b>
<b>RILCLR2R</b>	<b>REAR INTERSECTION LIGHT LOCATION 2 - RED</b> The warning light located on above the rear wheel well at location 2 shall be red. -----	<b>1.00</b>
<b>30-27-1102</b>	<b>LIGHTS, ICC / LED CLEARANCE - ON MODULE SIDE - TECNIQ</b> Install: (2) red Tecniq LED (S33-RR00-1) clearance/ICC lights, (1) red on each side at rear of the vehicle, flash with turn signal, per Dwg #3 and #4. -----	<b>1.00</b>





<b>SWL090004</b>	<b>LIGHTS SIDE WARNING - 4 WHELEN 900 SUPER LED</b> Four (4) Whelen 900 series super LED warning lights with chrome flanges shall be installed, two (2) on each side of module exterior per dwg.	1.00
<b>SWLCLR1R</b>	<b>SIDE WARNING LIGHT LOCATION 1 - RED</b> The warning light located on side of the module, in outer location 1 shall be red.	1.00
<b>SWLCLR2R</b>	<b>SIDE WARNING LIGHT LOCATION 2 - RED</b> The warning light located on side of the module, in outer location 2 shall be red.	1.00
<b>SWLCLR3R</b>	<b>SIDE WARNING LIGHT LOCATION 3 - RED</b> The warning light located on side of the module, in outer location 3 shall be red.	1.00
<b>SWLCLR4R</b>	<b>SIDE WARNING LIGHT LOCATION 4 - RED</b> The warning light located on side of the module, in outer location 4 shall be red.	1.00
<b>SS090004</b>	<b>LIGHTS SIDE SCENE - 4 WHELEN 900 24 DIODE LED</b> Four (4) Whelen 900 series 24 Diode LED scene lights with chrome flanges shall be installed, two (2) each module side. These lights shall operate from switches on the master control console labeled "Left Scene Light" and "Right Scene Light".	1.00
<b>30-27-4158</b>	<b>LIGHTS, RUB RAIL - WHELEN LED STRIP - 4 EACH SIDE</b> Install: Whelen strip lights on rub rail, (4) LED's each side - (2) red LED's and (2) white LED's alternating in color (red-white-red-white) along the module side, total of eight (8) lights, alternate flash with box warning lights.	1.00

### **Braun - Module Body Construction**

<b>Item Number</b>	<b>Description</b>	<b>Quantity</b>
<b>39-00-0005</b>	<b>AWS ALUMINUM CERTIFIED WELDERS</b>	1.00
<b>39-10-0003</b>	<b>CONNECTIONS, MODULE</b> Bolt: to the chassis frame rail with (12) 5/8" -11 grade 8 bolts through OEM rubber insulating spacers installed on outriggers at twelve (12) separate locations (six each frame rail), providing noise insulation and easy removal for chassis replacement, mounting bolts to be properly torqued and secured with locktite, system used for fastening the module to the frame to be that approved by the chassis manufacturer.	1.00
<b>40-00-0080</b>	<b>INSULATION - POLYURETHANE SPRAY FOAM</b> The entire underside of the module floor (except for mounting pads), the underside of the outside storage compartments, the wheel wells, and the underside of the curbside step area shall be completely insulated with sprayed on Class I urethane foam for thermal and acoustical insulation. The insulation shall comply with FMVSS #302 flame spread requirements. The underside of the body shall be properly prepared to ensure adhesion before the spray insulation is applied.	1.00
<b>40-00-0079</b>	<b>INSULATION - EXTERIOR PASSAGE AND OSS DOORS AND INTERIOR WALLS AND CEILING</b> The walls, ceiling, passage doors, and outside storage doors shall have foam for thermal and acoustical insulation. The insulation shall comply with FMVSS #302 flame	1.00



spread requirements.

39-00-0001	<p><b>MODULE BODY CONSTRUCTION - SEAMLESS</b></p> <p>Module: fabricated entirely of parts cut and formed from .125" (minimum) thickness 5052-H32 flat aluminum sheet stock, using CNC machines capable of .010" repeatability. This is the only alloy that may be used for body parts that are welded together. Roll-cage type interior super-structure, aluminum partition and module welded together into a single unit, roof designed with a minimum 1.5" crown to facilitate water run-off. Floor, roof, sides, all exterior doors fabricated from .125" (minimum) thick flat aluminum sheet stock, exterior joints between the roof and side components continuous full seam welded the entire length of the module. All exterior body panel joints continuous full seam welded. No VHB bonding tape or other adhesives used in the construction of the ambulance module.</p>	1.00
39-00-0002	<p><b>SOLE SOURCE MODULE BODY CONSTRUCTION</b></p>	1.00

#### Braun - Module Features / Exterior

Item Number	Description	Quantity
SR00223268	"C" channel rub rails are to be Powder Coated Black.	1.00
40-00-0009	<p><b>ALUMINUM PARTS - MODULE EXTERIOR</b></p> <p>All unpainted exterior aluminum parts to be bright dip anodized after fabrication to retain the finish and increase corrosion resistance.</p>	1.00
40-00-0010	<p><b>CORROSION MINIMIZATION - MODULE</b></p> <p>All module contact with dissimilar metals shall be minimized with the use of nylon screw-hole inserts to provide hinge to door isolation with the module body, polypropylene strip hinge Isolation, polyethylene backed rubber tape, ceramic coated stainless steel hinge bolts, and corrosion inhibitor spray.</p>	1.00
40-00-0020	<p><b>DOOR CONSTRUCTION - GASKET PLACEMENT</b></p> <p>All exterior hinged module doors shall be constructed in an inverted pan-formed design. The pan shall be constructed from .125" thick 5052-H32 flat sheet aluminum. The exterior door skin shall be constructed of .190" thick aluminum and welded to the pan. Door gaskets shall be attached to the interior side of the door skin on the top, bottom and outer edge of the door. The gasket on the hinge side of the door will be attached to the door frame.</p>	1.00
40-00-0060	<p><b>EXTERIOR COMPARTMENTS - SWEEP-OUT</b></p> <p>Exterior module compartments: a sweep-out design to aid in facilitation of the purchaser's routine care and cleaning of the vehicle. All exterior compartment floors, with the exception of the front ALS compartment to be constructed to be flush with the bottom door frame.</p>	1.00
40-00-0030	<p><b>EXTERIOR COMPARTMENTS DESIGN</b></p> <p>All exterior compartments shall be vented and include: sound absorbing slip resistant polyurethane material sprayed on the inside of all compartments and compartment shelving, slide out trays and closeouts, baffled seep holes provided to prevent water</p>	1.00



	from splashing or seeping into the exterior compartments, full-length, two-way adjustable, stainless steel hinges on all exterior compartment doors with 3/16" stainless steel hinge pins, compartment doors installed, flush with the module body, when double doors are provided, each door to have exterior handle, but only the forward door lockable, rearward door is secured when forward door is locked), all exterior compartments and passage doors keyed alike, lockable Eberhard "free-floating" type chrome plated handles with rotary locks. Gasket installed under each handle to protect the paint; drip rails installed above all exterior compartment doors.	
40-00-0050	<b>EXTERIOR COMPARTMENTS, VENTING</b> (9) square inches (minimum) of venting inside #1, #2, #3, & #4 exterior storage compartments to provide for easier closure of the compartment doors.	1.00
40-00-0055	<b>EXTERIOR COMPARTMENTS, VENTING - OXYGEN STORAGE</b> (9) square inches (minimum) of venting provided in the exterior oxygen storage compartment, to dissipate any leaking oxygen gas.	1.00
40-00-0070	<b>HANDLES, EBERHARD - CHROME FREE FLOATING TYPE</b> Install: Eberhard #EMC-1-2110 chrome "free-floating" handles on each exterior module door, large enough to accommodate a gloved hand.	1.00
40-10-0073	<b>LOWERED MODULE CURB SIDE</b> Module curb side to be as low as possible and still comply with KKK-1822-F ramp break over angle. Lowered side will allow easier entry into the module as well as increased compartment storage.	1.00
40-10-0321	<b>STEPWELL, CURBSIDE DOORWAY - MID STEP AREA</b> Install: aluminum diamond plate step well and mid-level step in curbside doorway threshold area.	1.00
40-00-0091	<b>THRESHOLD, STAINLESS STEEL - ALL OSS STORAGE COMPARTMENTS</b> Each exterior storage compartment with a hinged door: stainless steel lower threshold at the door opening to protect the paint.	1.00
40-00-0082	<b>SOUND DEADENING PACKAGE</b> Apply: An acoustic coating - entire floor, left wall, ceiling, left and right panels forward of the partition to be covered at the manufacturers recommended thickness.	1.00
40-00-0083	<b>UNDERCOATING SEAL</b> Spray: Entire underbody (excluding drive shaft, wheels, fuel tank, and 12" either side of exhaust system) with undercoating seal for reduced corrosion.	1.00
40-00-0085	<b>COATING, CERAMIC THERMAL</b> Apply: Temp-Coat ceramic thermal barrier coating to the interior of the module roof after the spray foam application, to meet or exceed the manufacturer's recommended thickness.	1.00
40-10-0340	<b>STONE GUARDS, MOD FRNT -ANODIZED DIAMOND PLATE</b> Install: anodized aluminum diamond plate stone guards on module front, (1) each side.	1.00
40-10-0046	<b>DOOR HINGED - MODULE CURBSIDE PASSAGE</b> Install hinged curb door.	1.00
40-10-0083	<b>DOORS - REAR PASSAGE</b>	1.00



	A 49.00" wide x 59" high rear door opening to be in patient compartment, doors to be flush without a protruding flange or lip, right rear passage door to have lockable, chrome exterior handle, left rear door to have a non-locking, chrome exterior handle.	
40-10-0130	<b>EMERGENCY RELEASE LEVER, REAR PATIENT PASSAGE DOORS</b> Install emergency release lever, attached to each rear passage door latch to be free-floating from the interior door linkages. Access to the lever shall be behind a removable cover in the door skin.	1.00
40-10-0505	<b>WINDOWS, PASSAGE DOOR - (CURB SLIDING, REAR FIXED)</b> Curbside passage door (sliding) window with removable screen, rear passage doors w/ non-openable window, windows 69% dark tint, secured with black oxide coated fasteners, open doors not to block warning lights.	1.00
40-10-0104	<b>FENDERETTES - RUBBER</b> Install: Black Rubber Fenderettes around rear wheel well openings.	1.00
40-10-0119	<b>HOLD-OPEN - REAR DOORS - GRABBERS</b> Install: door grabbers (1 pair) with hard rubber inserts on rear doors.	1.00
40-10-0360	<b>KICKPLATE/THRESHOLD, REAR DOORWAY - ANODIZED DIAMOND PLATE</b> Install: anodized aluminum diamond plate kick plate at the rear exterior doorway, providing a kick / scuff plate at rear of the vehicle above rear step, per dwg # 2.	1.00
40-10-0204	<b>MUD FLAPS, REAR - BLACK RUBBER FIBERGLASS REINFORCED - THREE COLOR</b> Install black rubber, fiberglass reinforced mud flaps with a minimum 1/4" thickness bolted to underside of module behind rear wheels, to provide adequate coverage of rear dual wheels of the chassis, mud flaps to be (3) color with the Manufacturers Logo.	1.00
40-10-0266	<b>REAR STEP/BUMPER -FLIP-UP CENTER SECTION - STAR PUNCHED AND ANODIZED</b> Affix: rear bumper to chassis frame, constructed with a hinged center section, (2) steel braces to secure step to chassis frame, outer 17" on each end of bumper constructed from heavy gauge stamped polished stainless steel bumper parts, to provide smooth rounded corners, step constructed of star punched .125" thick aluminum diamond plate, (2) rear LED step illumination lights provided. All diamond plate surfaces to be anodized; strip of black PVC installed on face of step.	1.00
40-10-0381	<b>TOW HOOKS, MODULE REAR</b> Secure: fasten (2) tow hooks in rear step area to rear step braces.	1.00
40-10-0283	<b>RUB RAILS, ANODIZED ALUMINUM, "C" CHANNEL</b> Install: anodized aluminum "C" channel rub rails on lower sides of body below outside compartment sill areas, rub rails to be offset 3/16" from body.	1.00
40-00-0019	<b>DOOR SKINS, OUTSIDE STORAGE COMPARTMENTS - DIAMOND PLATE INTERIOR SKINS</b> Interior door skins for all outside storage compartments constructed of .063" thick aluminum diamond plate.	1.00
OS1SCHSTD	<b>OSS #1 - STREETSIDE FORWARD</b> OSS #1 streetside forward, hinged door with spring-loaded gas cylinder, locking handle installed on the exterior of the door.	1.00
OS1SCHOP5	<b>OSS #1 - BACKBOARD AND OXYGEN STORAGE WITH DIVIDER</b>	1.00



	OSS #1 streetside forward, with one (1) fixed vertical divider for backboard/scoop stretcher storage on one side and housing an O2 cylinder on the other.	
<b>OS102WELD</b>	<b>OSS #1 - OXYGEN STORAGE BRACKET WELDED IN FOR H or M CYLINDER</b> An oxygen storage bracket shall be welded in OSS #1 for retention of "H" or "M" oxygen cylinders.	1.00
<b>OS1BB</b>	<b>OSS #1 - BACKBOARD - SCOOP STRETCHER STORAGE</b> OSS #1: storage for backboard / scoop stretcher, with a (1) inch adjustable strap with black plastic buckle.	1.00
<b>OS1DIV1</b>	<b>OSS #1 - FIXED DIVIDER</b> One (1) fixed divider with sprayed on polyurethane material installed in OSS #1.	1.00
<b>OS2SCHSTD</b>	<b>OSS #2 - STREETSIDE CENTER</b> OSS #2 streetside center, hinged double doors with spring-loaded gas cylinders, handles installed on the exterior of each door, forward door with locking handle.	1.00
<b>OS2SCHOP1</b>	<b>OSS #2 - (1) ADJUSTABLE SHELF</b> OSS #2 streetside center, with one (1) adjustable shelf.	1.00
<b>OS2SHELF1</b>	<b>OSS #2 - SHELF ONE (1) ADJUSTABLE WITH TRACK</b> Outside storage compartment #2 shall contain one (1) adjustable shelf with track.	1.00
<b>OS3SCHSTD</b>	<b>OSS #3 - STREETSIDE REAR TALL DOOR</b> OSS #3 streetside rear, hinged door with spring-loaded gas cylinder, locking handle installed on the exterior of the door.	1.00
<b>OS3SCHOP1</b>	<b>OSS #3 - (1) ADJUSTABLE SHELF WITH INSIDE/OUTSIDE ACCESS</b> OSS #3 streetside rear, for providing I/O storage access, and contain one (1) adjustable shelf.	1.00
<b>OS3SHELF1</b>	<b>OSS #3 - SHELF ONE (1) ADJUSTABLE WITH TRACK</b> Outside storage compartment #3 shall contain one (1) adjustable shelf with track.	1.00
<b>OS4SCHSTD</b>	<b>OSS #4 - CURBSIDE REAR</b> OSS #4 curbside rear, hinged door with spring-loaded gas cylinder, locking handle installed on the exterior of the door.	1.00
<b>OS4SCHOP6</b>	<b>OSS #4 - (3) ADJUSTABLE SHELVES WITH OUTSIDE ACCESS ONLY</b> OSS #4 curbside rear, three (3) adjustable shelves.	1.00
<b>OS4SHELF3</b>	<b>OSS #4 - SHELVES THREE (3) ADJUSTABLE WITH TRACK</b> Three (3) adjustable shelves with track in outside storage compartment #4.	1.00
<b>OS5SCHSTD</b>	<b>OSS #5 - CURBSIDE FORWARD</b> OSS #5 curbside forward, hinged door with spring-loaded gas cylinder, locking handle installed on the exterior of the door.	1.00
<b>OS5SCHOP1</b>	<b>OSS #5 - INSIDE/OUTSIDE ACCESS TO THE ALS CABINET</b> OSS #5 curbside forward, inside/outside access to the ALS cabinet.	1.00



OS5SCHBAT	<b>OSS #5 - CURBSIDE FORWARD BATTERY COMPARTMENT</b> Battery compartment: located on front curbside of the module, above rubrail, hinged on the forward edge, slide out tray, exterior handle. -----	1.00
-----------	--	------

### Braun - Module Interior / Patient Compartment

Item Number	Description	Quantity
SR00223165	The standard pass through/walk through is to be deleted. There will be a solid wall between the cab and module. -----	1.00
50-51-1001	<b>CABINET CONSTRUCTION - INTERIOR - ALUMINUM</b> All interior cabinets shall be constructed of .090" thick welded aluminum. -----	1.00
50-60-0220	<b>EMBLEMS / SIGNS - REAR PATIENT COMPARTMENT</b> (2) "No Smoking / Oxygen Equipped / Fasten Seat Belts" signs: (1) sign installed in the cab, (1) above the oxygen outlets in the patient compartment street side cabinet. -----	1.00
50-60-0300	<b>FLOOR CONSTRUCTION- PATIENT COMPARTMENT, NON-WOOD COMPOSITE</b> Sub-floor in the patient compartment: constructed of .125" thick aluminum over .125" and .190" thick reinforcing hat sections and mounting laterals, aluminum sub-floor covered with a 3/4" non-wood composite material, all corner molding, edging and trim anodized aluminum or stainless steel and sealed to prevent fluids from seeping under the cabinets. -----	1.00
50-60-0301	<b>FLOORING - COVE</b> Patient compartment floor radius: coved with pre-formed floor coving material, installed behind the vinyl floor covering, along both the street side and curbside walls. -----	1.00
50-60-0391	<b>HEADLINER - REAR PATIENT COMPARTMENT</b> Headliner in the patient compartment shall be one-piece, seamless, .090 thick aluminum finished with sprayed-on multi-use polychromatic coating.	1.00
50-51-1013	<b>HOLD OPENS FOR INTERIOR DOORS</b> All interior cabinets with doors less than 6" tall shall have friction hinges as hold opens for door(s). Doors 6" and taller shall be designed using gas shocks as hold opens for the door(s). -----	1.00
50-60-0660	<b>PADDED EDGING PROTECTION</b> Install: padded corner edging where necessary on exposed corners and edges in the patient compartment for patient and attendant protection.	1.00
50-00-0202	<b>ROUNDED INTERIOR CORNERS</b> Interior vertical edges: rounded corners in the following locations: forward and aft edges of the CPR seat, the wall at the aft end of the squad bench, the partition opening cabinet edges and the upper front wall cabinet.	1.00
50-51-1011	<b>RECESSED ADJUSTABLE SHELF TRACK - CABINETS</b> Install recessed adjustable shelf track in cabinets. -----	1.00
50-51-5001	<b>UPHOLSTERY - PATRIOT PLUS CHARCOAL #8605</b> All cushions, head pads and seating surfaces shall be covered with Patriot Plus Charcoal #8605 -----	1.00



50-60-0661	<b>INTERIOR MODULE PADS</b> Vinyl upholstered, foam cushioned head/back pads shall be installed as follows: the lower edge of the upper front wall cabinet (above the partition doorway or window), above the rear doors, above the side door, and on the street side wall behind and on each side of the CPR seat. The pads shall be covered with a flame-retardant color coordinated vinyl upholstery material.	1.00
50-51-6003	<b>LONPLATE II, NON-SLIP EMBOSSED SM. GRID - GUNMETAL #424</b> The floor in the patient compartment shall be covered with Lonseal brand "Lonplate II" non-slip; small grid (embossed) Gunmetal #424.	1.00
50-51-2002	<b>CABINET DOORS - CLEAR POLYCARBONATE</b> All cabinet doors shall be clear polycarbonate material / installed in aluminum track lined with PPL inserts / An edge mounted aluminum handle shall be installed on each sliding cabinet door.	1.00
50-51-3001	<b>CABINETS/ WALLS - POLYCHROMATIC COATING - MARBLE STONE</b> Headliner, walls, cabinet faces, and cabinet interiors MultiSpec color to be Marble Stone	1.00
IS-CNT2-ACR	<b>COUNTER TOP, SOLID ACRYLIC - SECONDARY ACTION AREA</b> Install: solid acrylic countertop with 1/2" lip on the secondary action area.	1.00
IS-CNT-ACR	<b>COUNTER TOP, SOLID ACRYLIC</b> Install: solid acrylic countertop with 1/2" lip on the primary action area.	1.00
50-51-4033	<b>COUNTERTOP - SOLID ACRYLIC - RAVEN BOULDER (GRAY/BLACK)</b> Install a solid acrylic counter top, Raven Boulder (#810).	1.00
50-01-0408	<b>LATCHES, CABINET, CN10 COMPLIANT AS APPLICABLE - INCLUDING RADIO CABINET</b> The ACP (attendant control panel) door, the PDQ (power distribution quarters) door, and the radio cabinet door shall be secured with chrome locking lever latches/ all remaining interior hinged cabinet doors with center squeeze latches/all interior drawers with locking flush pull latches.	1.00
50-10-0229	<b>LEFT WALL - ATTENDANT CONTROL PANEL - WITH FLAT AREA</b> A control screen shall be mounted on a hinged access panel and secured with two (2) latches. The panel will be located to the immediate right of the attendant's seat. The forward portion of the panel will contain a flat area that may be used for future radio mounting, etc.	1.00
IS1SCHOP1	<b>CABINET - FIXED FRAME WITH SLIDING POLYCARBONATE DOORS AND (1) ADJ. SHELF EACH SIDE OF CENTER DIVIDER</b> Left wall, upper rear interior cabinet (#1): fixed frame, sliding polycarbonate doors w/full length handles, the outer most sliding door to have handles on both ends, center divider with (1) adjustable shelf each side	1.00
IS2SCHOP1	<b>CABINET - FIXED FRAME WITH SLIDING POLYCARBONATE DOORS AND (1) ADJ. SHELF EACH SIDE OF CENTER DIVIDER</b> Left wall, upper interior cabinet (#2): fixed frame, sliding polycarbonate doors w/full length handles, the outer most sliding door to have handles on both ends, center divider with (1) adjustable shelf, each side.	1.00





IS3SCHOP1	<b>CABINET - HINGED POLYCARBONATE DOORS WITH LATCHES AND FULL LENGTH HANDLES, INSIDE/OUTSIDE ACCESS TO OSS #3</b> Left wall rear interior cabinet (#3): fixed frame, hinged polycarbonate doors w/ latches and full length handles, inside/outside access to OSS #3.	1.00
IS4SCHOP1	<b>CABINET - SLIDING POLYCARBONATE DOORS WITH (1) ADJUSTABLE SHELF</b> Left wall interior cabinet (#4) below secondary action area: fixed frame, sliding polycarbonate doors w/ full length handles, the outermost sliding door to have handles on both ends (1) adjustable shelf.	1.00
IS5SCHOP5	<b>NO DRAWERS , SUCTION RELOCATED TO COUNTERTOP</b> Drawer #5 shall be omitted / not installed, and the suction unit shall be relocated.	1.00
ISRAISED	<b>RAISE STREETSIDE CABINETS, DELETE ANGLED LIGHTS</b>	1.00
IS6SCHOP1	<b>CABINET - HINGED POLYCARBONATE DOOR WITH LATCH AND GAS SHOCK HOLD-OPEN</b> Left wall upper interior cabinet (#6): cabinet w/ (1) flip up hinged polycarbonate door with gas filled hold-open shocks, latch.	1.00
50-60-0017	<b>ASPIRATOR / SUCTION - SSCOR - WITH ELECTRIC PUMP - COUNTER</b> An SSCOR suction system shall be installed on the action wall counter near the attendant's seat. The 12 VDC SSCOR electric pump to be installed in an exterior compartment per the location on the drawing (must use SSCOR pump and tubing).	1.00
IC1SCHOP3	<b>CABINET #1 OPTION REMOVED</b> Cabinet #1 will be removed/ omitted	1.00
IC2SCHOP22	<b>SQUAD BENCH WITH RECESSED SHARPS/WASTE BELOW SEPARATE BENCH LID. SECOND PATIENT TRANSPORT ON THE SQUAD BENCH.</b> The Curbside wall shall have a squad bench which will include storage, a split lid with gas cylinder hold opens, and a recessed sharps and trash container.	1.00
IC3SCHC1	<b>CABINETS - RIGHT WALL, UPPER #3- HINGED FLIP UP DOORS</b> Curb side interior wall cabinet #3: overhead separated into (2) cabinet sections, each section enclosed by (1) flip up, hinged polycarbonate door with latch.	1.00
IC3SCHOP2	<b>OVERHEAD CABINETS WITH HINGED POLYCARBONATE DOORS, GAS SHOCK HOLD-OPENS, AND LATCHES. OXYGEN OUTLET MOUNTED BESIDE THE CABINETS.</b> Curb side interior wall cabinet #3: overhead, separated into (2) cabinet sections, each section enclosed by (1) flip up, hinged polycarbonate door with latch, gas shock hold-opens.	1.00
50-50-0503	<b>SQUAD BENCH TOP - SPLIT WITH HINGED LID FORWARD WITH SHARPS / TRASH ACCESS</b> Squad bench top and cushion shall be split into two (2) sections with separate hinged lids/ forward most section shall have the sharps and trash container installed/ bench covered with color coordinated vinyl upholstery material/automatic latching fastener shall be installed in both sections	1.00
50-50-0541	<b>HOLD OPENS - SQUAD BENCH LID - GAS CYLINDERS</b>	1.00



	Gas cylinder hold-open(s) shall be provided and installed to hold lid in the open and closed position.	
50-60-0709	<b>SHARPS AND TRASH CONTAINERS - ACCESS THRU SQUAD BENCH LID</b> A sharps container and a trash container installed in the forward end of the squad bench base, containers accessed through the squad bench lid covered with a 3/8" thick clear acrylic hinged lid with a biohazard warning label.	1.00
50-60-0718	<b>SQUAD BENCH FACE - VINYL FLOORING MATERIAL</b> The face of the squad bench shall be covered with vinyl flooring material.	1.00
SQ-BN-BASE	<b>SQUAD BENCH BASE W/STORAGE</b> A storage area shall be provided in the squad bench base. The squad bench base shall be constructed of .090" thick aluminum for maximum storage capacity and minimum weight. The interior of the squad bench shall be sprayed with sound absorbing polyurethane material.	1.00
IF3PDQ	<b>CABINET - PDQ</b> The Power Distribution Quarters (PDQ) shall hold electrical components, (i.e., power distribution nodes, circuit breakers, etc.), hinged door with (2) chrome locking lever latches, located on the partition wall behind the attendant seat.	1.00
IF1SCHC4	<b>CABINET - FRONT WALL, UPPER #1 - NARROW HINGED ALUMINUM DOOR W/INSERT</b> The front wall interior cabinet #1, hinged aluminum door with a polycarbonate insert, gas shock hold-open(s), latch, (1) adjustable shelf.	1.00
IF1SCHOP4	<b>CABINET WITH HINGED ALUMINUM DOOR WITH POLYCARBONATE INSERT AND LATCH WITH (1) ADJUSTABLE SHELF</b> Install cabinet with hinged aluminum door with polycarbonate insert and gas shock hold-open(s), in the upper front wall.	1.00
IF2SCHOP1	<b>CABINET - UPPER/LOWER WITH HINGED POLYCARBONATE DOORS, LATCHES, (1) ADJ. SHELF PER CABINET</b> Front interior wall cabinet #2 fixed frame separated into (2) cabinet sections, upper and lower, each enclosed with (1) set of hinged polycarbonate doors with full length handles and latches, (1) adjustable shelf per each section and (1) adjustable shelf between the sections for a total of (3) adjustable shelves.	1.00
IF3SCHOP1	<b>CABINET - VENTED RADIO CABINET PDQ ABOVE</b> Power Distribution Quarters (PDQ) compartment and a vented radio compartment below the PDQ, lower front wall, left.	1.00
IF3SCHRAD	<b>CABINET - FRONT WALL, LOWER BELOW PDQ (SINGLE VENTED DOOR)</b> A radio cabinet with a vented, hinged aluminum door, secured by a chrome locking lever latch, located on the front lower left wall, door to open towards rear of the module.	1.00
50-50-0104	<b>SEATING - ATTENDANT - EVS HiBAC, INTEGRAL CHILD, SWIVEL BASE with BACKPACK belting CN8 COMPLIANT</b> A rear facing EVS HiBAC attendant seat shall be installed at the head of the patient cot. The seat shall be equipped with a sliding swivel base and incorporate an integral child safety restraint system and the Backpack belting system. The seat shall be padded and	1.00



	covered with color coordinated, cushioned vinyl.	
50-50-0122	<b>SEATING - ATTENDANT - SIDE MOUNT POSITION</b> The attendant seat shall be in a side mount position.	1.00
CPROP4	<b>SEATING - CPR - EVS WITH BACKPACK HARNESS</b> A CPR seat shall be installed on the street side of the patient compartment aft of the primary action area counter. The CPR seat shall be KKK-A-1822F Change Notice 8 compliant with the Backpack style shoulder / seat belt system and conform to all applicable FMVSS and SAE J3026 requirements.	1.00
SQSTOP7	<b>SEATING - CN8 COMPLIANT TWO (2) EVS BACKPACK</b> A Squad bench seat: (2) EVS individual seating positions will be installed on the curb side of the patient compartment. Seats shall have the EVS Backpack Belting system and be covered with color coordinated, cut and sewn vinyl.	1.00
HVC_PRE_02	<b>HVAC - PREMIUM 110/12V INDEPENDENT PACKAGE - SMALL HEAT STRIP</b> Install 110/12v independent Premium Package HVAC system with small heat strip. THE 110/12V EVAPORATOR, 60,000BTU 12V/30,000BTU 110V CONDENSER, TIED-IN TO A SECONDARY COMPRESSOR AND OEM COOLANT LINES, MAKING THE AC OPERABLE ON SHORLINE OR 12V, HEATING AND COOLING THE AIR OF THE PATIENT COMPARTMENT THROUGH THE VENTS. SMALL HEAT STRIP SETUP. (110/12V PREMIUM SETUP).	1.00
COND_BRK_02	<b>CONDENSER BRACKETS TO BE WEDGE DESIGN AND COLOR MATCH TO THE CONDENSER</b> The condenser bracket shall be a wedge designed, painted to match the condenser, mounted to the bulkhead of the module.	1.00
50-61-0001	<b>ASSIST HANDLES, (6) BLACK RUBBER</b> Install: a total of (6) 10-7/8" black vulcanized rubber with steel core assist handles installed: (1) handle on each rear door, (1) on the curbside door, (1) at the curbside doorway and (2) at the rear doorway.	1.00
50-60-0730	<b>DOOR PANELS - MODULE PASSAGE DOORS - FULL LENGTH ALUMINUM - W/ACCESS PANELS</b> Interior rear and curbside passage door panels to be full length aluminum, Multi-Spec sprayed to match interior color and contain removable latch access panel per dwg. # 6 & # 8. (Total 3).	1.00
50-60-0256	<b>EXHAUST VENTILATOR, 3-SPEED - MULTIPLEX ELECTRIC SYSTEM</b> Install: three-speed, 250 CFM (minimum) exhaust fan in the street side cabinet in the patient compartment, fan pulse width modulated from a switch on the attendant control panel control screen, exhaust system to have a louvered grille inside and a chrome vent outside, system vent through the side of the vehicle.	1.00
50-60-0322	<b>GLOVE DISPENSER - (3) BOX - ABOVE ENTRY DOOR - CURBSIDE (ABS)</b> A three (3) - box glove dispenser unit, with a clear acrylic hinged access panel with three (3) cut-outs, shall be provided above the curbside entry door. A 1/4" turn latch will be installed on the face of the glove box access panel.	1.00
50-60-0340	<b>GRAB RAIL, 1-1/4" DIAMETER, (96") OVER COT AREA</b>	1.00



	One (1) 1-1/4" diameter x 96" long stainless steel grab rail shall be installed on the ceiling. The grab rail shall be attached to the ceiling with three (3) mounting brackets that secure it to the super structure of the module.	
50-60-0440	<b>IV HANGERS - CEILING RECESSED - DUAL IV BAG HOLDER</b> Recessed ceiling IV hanger(s) provided and installed per the drawings.	2.00
50-60-0640	<b>OXYGEN SYSTEM, ELECTRIC - MULTIPLEX ELECTRIC SYSTEM</b> A 12 VDC controlled electric O2 system operated through the electrical system shall be provided and installed.	1.00
50-60-1601	<b>OXYGEN OUTLET (1) LEFT WALL - OHIO MED - ACTION AREA</b> One (1) Ohio Medical flush mounted; quick release wall outlet shall be installed in the forward street side cabinet action area. Per dwg #5	1.00
50-60-1680	<b>OXYGEN OUTLET (1) CEILING - OHIO MED - ABOVE HEAD OF COT</b> One (1) Ohio Medical flush mounted; quick release oxygen outlet shall be installed in the ceiling above the head of cot in the center mount position. Per dwg #9	1.00
50-60-0629	<b>FLOW METER, OXYGEN - THORPE STYLE</b> One (1) Thorpe style oxygen flow meter (15LPM) shipped loose with the completed vehicle.	1.00
50-60-0761	<b>STAINLESS STEEL WALL PROTECTION - INTERIOR STREETSIDE</b> A brushed stainless steel panel shall be provided on the street side wall from the bottom of the CPR seat.	1.00
50-60-0820	<b>ANTI-SLIP MATTING - CURBSIDE STEPWELL</b> Anti-Slip charcoal gray matting shall be installed in the curbside step well.	1.00

#### **Braun - Optional Patient Compartment Items**

<b>Item Number</b>	<b>Description</b>	<b>Quantity</b>
50-62-0446	<b>COT FASTENER - STRYKER FLOOR PLATE AND 12v PRE-WIRE</b> Install Stryker Floor plate kit and 12v pre-wire for dealer supplied Powerload. Powerload and PowerPro2 stretcher included.	1.00

#### **Braun - Paint / Graphics**

<b>Item Number</b>	<b>Description</b>	<b>Quantity</b>
SR00222996	Graphics to match the attached layout	1.00
60-01-0001	<b>PAINT PROCEDURE</b> All non-anodized aluminum module body surfaces: completely chemically steam cleaned, filled with premium body filler as needed, sanded smooth and primed with an epoxy primer and then primed again with a high solid primer, cured primer surfacer shall be DA sanded with 320 grit and cleaned. A high solid primer shall then be applied, where needed, as a sealer.	1.00
60-01-0005	<b>STANDARDS AND SPECIFICATIONS FOR VEHICLE PAINT APPEARANCE</b>	1.00



60-01-0017	<b>BUFF PAINT - STANDARD CAB TYPE I</b> The paint on the cab shall be buffed to a high shine using a recommended paint buff system.	1.00
60-01-0004	<b>BUFFING, PAINT - MODULE</b> The paint on the module sides shall be buffed to a high shine using a recommended paint buff system.	1.00
60-09-0250	<b>PAINT BOTTOM HALF MODULE ONLY RED/BLACK</b> Bottom half of the module painted in an alternate color, remainder of the module shall be painted OEM white in color.	1.00
60-09-0111	<b>PAINT MODULE ROOF - TO STOP BELOW THE SIDE WARNING LIGHTS. COLOR: RED/BLACK</b> Paint module roof down the sides, roughly 13" from the radius, below the side warning lights, one color plus clear coat. Paint line should extend around the front and rear of module at the same height.	1.00
60-09-0208	<b>PAINT BOTTOM HALF OF CAB ONLY RED/BLACK</b> The bottom half of the cab shall be painted in an alternate color. The remainder of the cab shall be painted OEM white in color.	1.00
60-20-0305	<b>CHEVRON STRIPING - SIDE PANELS - DOOR LEVEL</b> Chevron striping 6" wide shall be installed on the rear module side panels from the bottom of the module up to level with the top of the doors.	1.00
GR_CHV_RFX_RED_1	<b>REFLEXITE RED REFLECTIVE - CHEVRON - COLOR 1</b> Stripe Color 1 to be Reflexite Red conspicuity tape.	1.00
GR_CHV_RFX_YEL18_2	<b>REFLEXITE YELLOW 18 REFLECTIVE - CHEVRON - COLOR 2</b> Stripe Color 2 to be Reflexite Yellow 18 conspicuity tape.	1.00
60-30-0200	<b>REFLECTIVE - DOOR REFLECTIVITY</b> Install reflective material (25" x 2.5" red/white chevron style), on the lower interior panel of each rear door and hinged side door. NOTE: If a sliding side door is provided, install a 1.50" x 40.00" white reflective stripe on the rear facing edge.	1.00

### Braun - Vehicle Manuals

Item Number	Description	Quantity
80-20-0001	<b>VEHICLE MANUALS (1) PACKAGE SET</b> One (1) Delivery Manual Package shall be supplied with the vehicle and shall include the following items: Ambulance manufacturer parts, service, and operation manuals, OEM chassis owner's guide, complete 12 VDC and 125 VAC wiring schematics for all included standard and optional systems, Multiplex Electrical system programming - electronic media	1.00
90-10-0007	<b>STATEMENT OF LIMITED WARRANTY NEW AMBULANCES</b>	1.00



EXHIBIT B

**WARRANTY**





# BRAUN PERFORMANCE EXCELLENCE SYSTEM

## Statement of Limited Warranty New Ambulances

Document No. and Level: BPES-P-076-100 / Level II  
Effective Date: July 11, 2023  
Revision No. F  
Prepared By: Kim Braun  
Owner: Kim Braun  
Page: 1 of 2

### NEW AMBULANCE WARRANTY

Subject to the provisions, limitations, and conditions set forth in this Statement of Limited Warranty, Braun Industries, Inc. (the "**Company**") warrants to the original registered/licensed U.S. end-user (the "**Purchaser**") that its new ambulances (the "**Product**") are free of defects in material and workmanship and shall maintain such integrity under normal use and service. This Limited Warranty (as defined below) is valid only in the United States and all warranty periods start upon completion of production and quality inspection by Company and the Product is declared ready for delivery (the "**Delivery**") and expires per the disclosures listed below. The Company warrants to repair or replace with new or refurbished materials at its sole discretion; components, installation, or workmanship deemed to be defective under the terms and conditions set forth in this Statement of Limited Warranty. Warranty repairs must be performed by the Company or by Company's Authorized Dealer / Service Center.

### EXCLUSIONS AND LIMITATIONS

**NOTWITHSTANDING ANY OTHER PROVISION HEREOF TO THE CONTRARY, OTHER THAN THE EXPRESS WARRANTIES SET FORTH HEREIN, THE COMPANY MAKES NO OTHER WARRANTY, WHETHER EXPRESS OR IMPLIED BY LAW, COURSE OF DEALING, COURSE OF PERFORMANCE, USAGE OF TRADE, OR OTHERWISE, REGARDING THE PRODUCT, RELATED EQUIPMENT AND MATERIALS, AND/OR SERVICES PROVIDED BY COMPANY. COMPANY EXPRESSLY DISCLAIMS ANY AND ALL OTHER WARRANTIES, INCLUDING WITHOUT LIMITATION, ANY IMPLIED WARRANTY OF MERCHANTABILITY OR FITNESS FOR A PARTICULAR PURPOSE, OR THE WARRANTY IN SECTION 2-312 OF THE UCC THAT SUCH PRODUCT AND/OR PRODUCTS DO NOT INFRINGE ON THE RIGHTS OF ANY OTHER PERSON.** You may have other rights which vary from state to state. The Purchaser's right to repair or replacement of defective parts or workmanship is the exclusive remedy, and neither the Company nor the Company's Authorized Dealer / Service Center shall be liable for damages, whether ordinary, incidental, or consequential under this warranty. Any remedy of consequential damages; including but not limited to economic loss, transportation, mileage, trip charges, wages, etc., and any remedy of incidental damages or loss are hereby excluded. Damages caused by normal use, improper maintenance, and loss resulting from any acts of God or natural disasters including but not limited to storm, flood, fire, lightning, freezing are excluded. Purchaser's noncompliance with any part of this specific Limited Warranty shall immediately render the total warranty null, void and non-enforceable.

The Purchaser shall use, service and maintain the Product according to the written instructions furnished by the Company and failure of Purchaser to properly use, service and maintain the product in accordance with such instructions shall void the warranty, including, without limitation, (i) use of the modular body for any purpose other than what it was originally designed to perform, (ii) overloading the Product beyond its applicable weight rating, (iii) overloading the Product beyond its electrical load rating, (iv) defects or damage as a result of misuse, abuse, negligence, theft, tampering, vandalism or riot, (v) failure to provide normal routine maintenance, (vi) resale of Product by original registered/licensed U.S. end-user, and (vii) remounting of Product by anyone other than the Company

This Statement of Limited Warranty does not apply to: (i) any product or component that is consumable from normal wear and tear, (ii) any product or component that is added, repaired, modified, altered, or replaced by anyone other than Company, and (iii) any product or component supplied by the Purchaser. Purchaser shall be responsible and liable for such modifications, alterations, integrations and installations performed by Purchaser and Purchaser hereby agrees to indemnify and hold harmless Company and its successors and assigns from all liabilities, obligations,

cost, losses, demands, actions, proceedings, claims, damages, and penalties (including, without limitation, all attorney fees) incurred or suffered by Company and arising or relating to such modifications, alterations, integrations and installations performed by Purchaser.

The Company reserves the right to make changes to the design and features of its Products without any obligation to make corresponding changes to Products previously manufactured. No other person is authorized to make any representation or warranty on behalf of the Company or of Company's Authorized Dealer / Service Center, other than as stated in the Company's warranty.

### STRUCTURAL WARRANTY

The modular body, including seams, joints, door frames, roof, floor, wall construction and exterior doors, as well as all aluminum cabinetry, are warranted to be structurally sound and free of defects in both materials and workmanship for the life of the Product, without mileage limitation, in accordance with the provisions hereof (the "**Limited Structural Warranty**").

Excluded from the Limited Structural Warranty are (i) any product or component that is consumable from normal wear and tear, (ii) any product or component that is added, repaired, modified, altered, or replaced by anyone other than Company, (iii) specific workmanship and materials covered by other warranties including paint finishes, sealant deterioration, filler shrinkage, hardware, moldings, windows, non-aluminum cabinets and other components and accessories that are not structural components of the modular body, (iv) any part or component becoming defective as a result of accident damage or other casualty.

The potential for reinstatement of the Limited Structural Warranty after accident damage or other casualty is dependent on an inspection by the Company or Company's Authorized Dealer / Service Center within sixty (60) days of the occurrence. The inspection will determine the structural integrity of the modular body and if there is an opportunity to reinstate the Limited Structural Warranty.

### ELECTRICAL WARRANTY

The electrical system, including standard installations of harness, terminals, connectors, nodes, touchpads, and electrical display screens, programming, system functions and specified optional components is warranted to be free from defects of both material and workmanship for a pro-rated period of seven (7) years or 84,000 miles, whichever occurs first. Pro-rated items warranted separately include (a) controls buttons for a period of two (2) years with unlimited mileage; and (b) display screen material for a period of three (3) years with unlimited mileage up to \$200. The limited warranties described herein and in accordance with the provisions herein, collectively (the "**Limited Electrical Warranty**").

Excluded from the Limited Electrical Warranty are (i) any product or component that is consumable from normal wear and tear, (ii) any product or component that is added, repaired, modified, altered, or replaced by anyone other than Company, (iii) chassis and all related chassis electrical systems, components and accessories covered by the Chassis Warranty and (iv) any components and equipment not manufactured by the Company covered the Supplier Warranty.

### PAINT WARRANTY

The paint finish, including surface preparation, paint application, curing, topcoat and/or other layers of paint applied to the Product by Company is warranted to be free from defects of both material and workmanship for a pro-rated period of seven (7) years or 84,000 miles, whichever occurs first. Pro-rated as follows: (i) the first four (4) years, or up to 48,000 miles, whichever first occurs, are covered at 100% for parts and labor; (ii) the fifth year or up to 60,000 miles, whichever first occurs, is covered at 75% for parts and labor; (iii) the sixth and seventh years or up

**This is an Electronically CONTROLLED Document and the property of Demers Braun Crestline  
Uncontrolled When Printed**



# BRAUN PERFORMANCE EXCELLENCE SYSTEM

## Statement of Limited Warranty New Ambulances

Document No. and Level: BPES-P-076-100 / Level II  
Effective Date: July 11, 2023  
Revision No. F  
Prepared By: Kim Braun  
Owner: Kim Braun  
Page: 2 of 2

to 84,000 miles, whichever first occurs, are covered at 50% for parts and labor; and (iv) non-OEM coated bumpers are covered for one year, unlimited mileage. The limited warranties described herein and in accordance with the provisions herein, collectively (the "**Limited Paint Warranty**").

Excluded from the Limited Paint Warranty are (i) paint deterioration caused by road salt, magnesium, calcium chloride, or other substances which are used to free roads from ice/snow, (ii) paint deterioration caused by accidents, acid rain, chemical fallout, acts of nature, or the lack of routine maintenance such as regular washing and waxing or the failure to touch-up stone chips, (iii) damage caused by chemicals including but not limited to: DEF (diesel exhaust fluid), gasoline, diesel fuel, anti-freeze, power steering fluid, brake fluid, fuel additives, abrasive cleaners, etc., (iv) failures resulting from product misuse or abuse including but not limited to stone chips, scratches, gouges, other impact damage, etc., (v) hazing, chalking or loss of gloss caused by improper care, abrasive polishes, cleaning agents, pressure washing, or aggressive mechanical wash systems, (vii) repairs not pre-authorized by the Company, (vi) failure of finishes applied by anyone other than Company or Company's authorized Dealer / Service Center.

### CONVERSION WARRANTY

The conversion, including non-structural construction, assembly and installation of heating/cooling systems, interior doors, windows, hardware, latches, locks, trim, wall coverings, flooring, kick plates, cot mount hardware, grab handles, IV hangers, graphics and Company manufactured seating, headpads, and other cushion/upholstery items is warranted to be free of defects in materials and workmanship for a period of three (3) years or 36,000 miles, whichever occurs first, in accordance with the provisions herein (the "**Limited Non-Structural Warranty**").

Excluded from the Non-Structural Limited Warranty are (i) any product or component that is consumable from normal wear and tear, (ii) any product or component that is added, repaired, modified, altered, or replaced by anyone other than Company, (iii) chassis and all related chassis electrical systems, components and accessories covered by the Chassis Warranty and (iv) any components and equipment not manufactured by the Company covered the Supplier Warranty, (v) damage to graphics caused by chemicals including but not limited to: DEF (diesel exhaust fluid), gasoline, diesel fuel, anti-freeze, power steering fluid, brake fluid, fuel additives, magnesium, calcium chloride, road salt, or other substances which are used to free roads from ice/snow and (iv) damage caused by power washers, or other aggressive forms of washing.

### SUPPLIER WARRANTY

OEM materials and workmanship, including but not limited to battery, battery charger, siren, inverter, light bar, radio, laptop, docking stations, mounts, actuators, and similar supplier equipment installed by Company but not originally manufactured by Company are warranted by separate warranties offered by the OEM that manufactured the component (the "**Limited Supplier Warranty**"). When necessary, Company will provide Purchaser with warranty assistance with the OEM.

Excluded from the Limited Supplier Warranty are (i) any product or component that is consumable from normal wear and tear, (ii) any product or component that is added, repaired, modified, altered, or replaced by anyone other than Company, (iii) chassis and all related chassis electrical systems, components and accessories covered by the Chassis Warranty.

### CHASSIS WARRANTY

All new Products that are mounted on a new chassis will carry the full Chassis Warranties as well as the Federal and California Emission Defect Warranties and Emission Performance Warranties, as issued by the specific chassis OEM (collectively the "**Chassis Warranty**"). This Chassis Warranty is administered by the chassis OEM's representing dealer and is subject to the guidelines, restrictions, and limitations that they set forth.

The Chassis Warranty does not apply to any portion of the truck or chassis directly included in the alteration process, including materials added to and work accomplished on the original chassis by a qualified modifier. Should any chassis service/repairs be required due to Company alterations, such repairs/service are covered under the Limited Structural Warranty, the Limited Non-Structural Warranty, the Limited Electrical Warranty, the Limited Paint Warranty or the Limited Supplier Warranty (collectively the "**Limited Warranty**") for a term equal in duration, and in every other aspect, to the Chassis Warranty for the applicable chassis model year.

Purchaser must complete an alignment after the unit is loaded and readied for use, as added weight and weight distribution will affect Product alignment. Alignments are a function of normal Product maintenance and are not covered by the Chassis Warranty or the Limited Warranty.

### TRANSFER OF WARRANTY

The Limited Warranty may be transferred to a subsequent owner(s), provided that the Product is inspected by the Company or Company's Authorized Dealer / Service Center within sixty (60) days of transfer of ownership and the warranty revalidation forms are completed and filed with the Company verifying warranty compliance. A warranty transfer fee, in addition to inspection charges, will apply. Once the Limited Structural Warranty has become invalidated by failure to comply with this provision or for any other reason, it cannot be reinstated.

### OBTAINING WARRANTY SERVICE

To obtain warranty service contact the Company's Authorized Dealer / Service Center from whom you purchased the Product. You may also contact the Company at 1-800-22-BRAUN or ServiceTeam@BraunAmbulances.com. Claims for warranty service must be submitted to Company within thirty (30) days from date of service to Product. To expedite warranty support please have the following information ready (i) chassis make and model, (ii) chassis vin, (iii) Company model, (iv) Company's identification number, (v) date of Delivery, and (vi) current mileage.

### DELAYED WARRANTY REGISTRATION

As a requirement of NHTSA, end-user contact information must be maintained by Company. In the case of Product Delivery by Company without end-user fully identified; the Purchaser must submit a delayed warranty registration to Company identifying the original registered/licensed U.S. end-user's (i) entity name, (ii) contact name, (iii) address, (iv) email, and (v) phone within 10-days from date of delivery to original end-user. Delayed warranty notification may be submitted via Company's website or by submitting the attached form.



# BRAUN PERFORMANCE EXCELLENCE SYSTEM

## Statement of Limited Warranty New Ambulances

Document No. and Level: BPES-P-076-100 / Level II  
Effective Date: July 11, 2023  
Revision No. F  
Prepared By: Kim Braun  
Owner: Kim Braun  
Page: 3 of 2

### DELAYED WARRANTY REGISTRATION

Please submit to [ServiceTeam@BraunAmbulances.com](mailto:ServiceTeam@BraunAmbulances.com)  
For assistance, please call 1-800-22-BRAUN

#### SALES INFORMATION

Dealer Name	
Sales Person Name	
Vehicle Date of Delivery to End-User	
Mileage on Date of Delivery	
Comments	

#### VEHICLE INFORMATION

Ambulance Identification Number	
Ambulance Model Name and Type	
Chassis Vehicle Identification Number	
Chassis Brand, Model and Year	
Original Purchaser's Name (authorized Dealer)	

#### END-USER INFORMATION

Company Name	
Contact Name and Title	
Mailing Address	
Email	
Phone	



# BRAUN PERFORMANCE EXCELLENCE SYSTEM

## Statement of Limited Warranty New Ambulances

Document No. and Level: BPES-P-076-100 / Level II  
Effective Date: July 11, 2023  
Revision No. F  
Prepared By: Kim Braun  
Owner: Kim Braun  
Page: 4 of 2

### 1. APPROVALS AND REVISION HISTORY:

Date	Revision	Description of Change	Approval (s):
12/11/15	Release	New Document	Kim Braun
8/19/16	A	Clarified OEM versus Braun responsibility on Chassis Warranty Section	Kim Braun/Dennis Gallo
7/28/17	B	Yearly Review-Content Updated	Kim Braun
12/22/17	C Release	Document content updated	Kim Braun
12/22/18	C	Document Review- December 2018	Kim Braun
10/23/19	D Release	Update to Electrical Warranty & Paint	Kim Braun
12/22/19	D	Yearly Document Review- December 2019	Kim Braun
12/11/20	E	Yearly Document Review- Minor updates	Kim Braun
12/22/21	F	Yearly Document Review- Change Per Kim Braun	Kim Braun
12/22/23	F	Yearly Document Review- No Changes	Kim Braun

EXHIBIT C

**PURCHASING TERMS AND CONDITIONS**

## **PURCHASING TERMS AND CONDITIONS**

These Purchasing Terms and Conditions, together with the Equipment Proposal and all attachments (collectively, the "Agreement") are entered into by and between Ten-8 Fire & Safety, LLC, a Florida company ("Company") and Customer (as defined in Ten-8 Fire & Safety LLC's Equipment Proposal document) and is effective as of the date specified in Section 3 of these Purchasing Terms and Conditions. Both Company and Customer may be referred throughout this document individually as a "party" or collectively as the "parties."

### **1. Definitions.**

- a. **"Acceptance"** has the same meaning set forth in Company's Equipment Proposal.
- b. **"Company's Equipment Proposal"** means the Equipment Proposal provided by Company and prepared in response to Customer's request for proposal for a fire apparatus, associated equipment or an ambulance.
- c. **"Cooperative Purchasing Contract"** means an Agreement between Company and a public authority, including without limitation, a department, division, agency of a municipal, county or state government ("Public Authority"), that adopts or participates in an existing agreement between Company and another non-party customer (including, but not limited to such non-party customer's equipment proposal, its applicable exhibits, attachments and purchasing terms and conditions), often referred to as a "piggyback arrangement," which is expressly agreed to, in writing, by Company. Company has sole discretion to determine whether it will agree to such a Cooperative Purchasing Contract.
- d. **"Delivery"** means when Company delivers physical possession of the Product to Customer.
- e. **"Manufacturer"** means the Manufacturer of any Product.
- f. **"Prepayment Discount"** means the prepayment discounts, if any, specified in Company's Equipment Proposal.
- g. **"Product"** means the fire apparatus and any associated equipment, or ambulance manufactured or furnished for Customer by Company pursuant to the Specifications.
- h. **"Purchase Price"** means the Total price set forth in the Quotation, adjusted for the final net price for the chassis charged by the original equipment manufacturer set forth in the final invoice submitted to the Company by the manufacturer. Additionally, if transportation charges are included in the Purchase Price, any changes in transportation charges shall be borne by Customer. Unless otherwise stated herein, Company shall not be responsible for switching, handling, loading, sorting, storage, demurrage, or any other transportation or peripheral charges. If any tax, public charge, tariff, duty, or increase in such taxes or tariffs, is now, or shall be, assessed, levied, or imposed upon, or with respect to the sale of Product by Company or the Manufacturer to Customer or upon any sale, delivery, or other action taken under any validly accepted order for Product, or upon the export or import of such Product by Company or Manufacturer, or if any change shall be made in the custom house or railway classification of such Product or in existing freight rates applicable thereto, the burden of such charge or change shall be borne by the Customer.
- i. **"Purchasing Terms and Conditions"** means these Purchasing Terms and Conditions; however, if the Company's Equipment Proposal or the Customer's related Purchase Order states that it is governed by a Cooperative Purchasing Agreement, "Purchasing Terms and Conditions" shall mean those terms and conditions set forth in the applicable Cooperative Purchasing Agreement.
- j. **"Specifications"** means the general specifications, technical specifications, training, and testing requirements for the Product contained in Company's Equipment Proposal and its Exhibit A (Proposal Option List or for ambulance sales, the Quotation, or Order Form, as applicable), prepared in response to Customer's request for such a proposal.

### **2. Purpose.** This Agreement sets forth the terms and conditions of Company's sale of the Product to Customer.

### **3. Term of Agreement.** This Agreement will become effective on the date of Acceptance as defined in Company's Equipment Proposal ("Effective Date") and, unless earlier terminated pursuant to the terms of this Agreement, it will terminate upon Delivery and payment in full of the Purchase Price.

### **4. Purchase and Payment.** Customer agrees to pay Company the Purchase Price for the Product(s). The Purchase Price is in U.S. dollars. Where Customer opts for a Prepayment Discount that specifies that Customer will tender one or more prepayments to Company, Customer must provide each prepayment within the time frame specified in the Equipment Proposal in order to receive the Prepayment Discount for that prepayment installment. To the

extent permitted by applicable law, Company may in its sole discretion charge a convenience fee if Customer elects to pay the Purchase Price by means of a credit card.

5. Representations and Warranties. Customer hereby represents and warrants to Company that the purchase of the Product(s) has been approved by Customer in accordance with applicable general laws and, as applicable, Customer's charter, ordinances and other governing documents, and funding for the purchase has been duly budgeted and appropriated.
6. Cancellation/Termination.
  - a. Fire Equipment and Apparatus Sales. In the event this Agreement is cancelled or terminated by Customer before completion, Company may charge Customer a cancellation fee. The following charge schedule is based on costs incurred by Manufacturer and Company for the Product, which may be applied and charged to Customer: (a) 12% of the Purchase Price after the order for the Product(s) is accepted and entered into Manufacturer's system by Company; (b) 22% of the Purchase Price after completion of approval drawings by Customer, and; (c) 32% of the Purchase Price upon any material requisition made by the Manufacturer for the Product. The cancellation fee will increase in excess of (c) in this Section 6, accordingly, as additional costs are incurred by Manufacturer and Company as the order progresses through engineering and into the manufacturing process.
  - b. Ambulance Sales. This Section 6 for Cancellation/Termination does not apply to Ambulance Sales. An order for an ambulance cannot be cancelled or terminated once Company receives and processes Customer's Acceptance of Company's Equipment Proposal.
7. Delivery. The Product is scheduled to be delivered as specified in the Delivery Timing section of the Equipment Proposal ("Delivery Timing"), which will be F.O.B. Company's facility. The Delivery Timing is an estimate, and Company is not bound to such date unless it otherwise agrees in writing. Company is not responsible for Delivery delays caused by or as the result of actions, omissions or conduct of the Manufacturer, its employees, affiliates, suppliers, contractors, and carriers. All right, title and interest in and to the Product, and risk of loss, shall pass to Customer upon Delivery of the Product(s) to Customer.
8. Standard Warranty. The manufacturer warranties applicable to this Agreement, if any, are attached to Company's Equipment Proposal as Exhibit A and are incorporated herein as part of the Agreement.
  - a. Disclaimer. EXCEPT AS OTHERWISE SET FORTH IN THIS AGREEMENT, COMPANY, INCLUDING ITS PARENT COMPANY, AFFILIATES, SUBSIDIARIES, AND THEIR RESPECTIVE OFFICERS, DIRECTORS, EMPLOYEES, SHAREHOLDERS, AGENTS OR REPRESENTATIVES DO NOT MAKE ANY REPRESENTATIONS OR WARRANTIES, EXPRESS OR IMPLIED, WITH RESPECT TO THE PRODUCTS PROVIDED UNDER THIS AGREEMENT, WHETHER ORAL OR WRITTEN, EXPRESS, IMPLIED OR STATUTORY. WITHOUT LIMITING THE FOREGOING DISCLAIMER, ANY IMPLIED WARRANTY OR CONDITION OF MERCHANTABILITY, IMPLIED WARRANTY AGAINST INFRINGEMENT, AND IMPLIED WARRANTY OR CONDITION OF FITNESS FOR A PARTICULAR PURPOSE ARE EXPRESSLY EXCLUDED AND DISCLAIMED. STATEMENTS MADE BY SALES REPRESENTATIVES OR IN PROMOTIONAL MATERIALS DO NOT CONSTITUTE WARRANTIES.
9. Limitation of Liability. COMPANY WILL NOT BE LIABLE FOR ANY INCIDENTAL, CONSEQUENTIAL, INDIRECT, ECONOMIC, PUNITIVE, SPECIAL OR EXEMPLARY DAMAGES ARISING FROM OR IN ANY WAY CONNECTED WITH THIS AGREEMENT WITHOUT REGARD TO THE NATURE OF THE CLAIM OR THE UNDERLYING THEORY OR CAUSE OF ACTION (WHETHER IN CONTRACT, TORT, STRICT LIABILITY, EQUITY OR ANY OTHER THEORY OF LAW) ON WHICH SUCH DAMAGES ARE BASED. COMPANY'S LIMIT OF LIABILITY UNDER THIS AGREEMENT SHALL BE CAPPED AT THE TOTAL AMOUNT OF THE MONIES PAID BY CUSTOMER TO COMPANY UNDER THIS AGREEMENT.

10. Force Majeure. Company shall not be responsible nor deemed to be in default on account of delays in performance due to causes which are beyond Company's control or which make Company's performance impracticable, including but not limited to wars, insurrections, strikes, riots, fires, storms, floods, other acts of nature, explosions, earthquakes, accidents, transportation or delivery delays or losses outside of Company's control, any act of government, inability or delay of Company or manufacture in obtaining necessary labor or adequate or suitable manufacturing components at reasonable prices, allocation regulations or orders affecting materials, equipment, facilities or completed products, failure to obtain any required license or certificates, acts of God or the public enemy, terrorism, epidemics, quarantine restrictions, failure of vendors to perform their contracts or labor troubles of Company or a manufacturer causing cessation, slowdown, or interruption of work.
11. Customer's Obligations. Customer shall provide its timely and best efforts to cooperate with Company and Manufacturer during the manufacturing process to create the Product. Reasonable and timely cooperation includes, without limitation, Customer's providing timely information in response to a request from Manufacturer or Company and Customer's participation in traveling to Manufacturer's facility for inspections and approval of the Product.
12. Default. The occurrence of one or more of the following shall constitute a default under this Agreement: (a) Customer's failure to pay any amounts due under this Agreement or Customer's failure to perform any of its obligations under this Agreement; (b) Company's failure to perform any of its obligations under this Agreement; (c) either party becoming insolvent or becoming subject to bankruptcy or insolvency proceedings; (d) any representation made by either party to induce the other to enter into this Agreement, which is false in any material respect; (e) an action by Customer to dissolve, merge, consolidate or transfer a substantial portion of its property to another entity; or (f) a default or breach by Customer under any other contract or agreement with Company.
13. Manufacturer's Statement of Origin. Company shall retain possession of the manufacturer's statement of origin ("MSO") for the Product until the entire Purchase Price has been paid. If more than one Product is covered by this Agreement, Company shall retain the MSO for each individual Product until the Purchase Price for that Product has been paid in full.
14. Arbitration. Any controversy or claim arising out of or relating to this Agreement, or the breach thereof, shall be settled by arbitration administered by the American Arbitration Association in accordance with its Commercial Arbitration Rules, and judgment on the award rendered by the arbitrator(s) may be entered in any court having jurisdiction thereof. The Arbitration shall take place in Bradenton, Florida.
15. Miscellaneous. The relationship of the parties established under this Agreement is that of independent contractors and neither party is a partner, employee, agent, or joint venture of or with the other. Neither party may assign its rights and obligations under this Agreement without the prior written approval of the other party. This Agreement and all transactions between Ten-8 Fire & Safety, LLC will be governed by and construed in accordance with the laws of the State of Florida. The delivery of signatures to this Agreement may be via facsimile transmission or other electronic means and shall be binding as original signatures. This Agreement shall constitute the entire agreement and supersede any prior agreement between the parties concerning the subject matter of this Agreement. This Agreement may only be modified by an amendment, in writing, signed by duly authorized representatives of both parties with authority to sign such amendments to this Agreement. In the event of a conflict between the Ten-8 Proposal and these Terms and Conditions, the Ten-8 Proposal shall control except in the case of a Cooperative Purchasing Contract as set forth in Section 1(c) and (h) of these Purchasing Terms and Conditions. If any term of this Agreement is determined to be invalid or unenforceable by a competent legal authority, such term will be either reformed or deleted, as the case may be, but only to the extent necessary to comply with the applicable law, regulation, order or rule, and the remaining provisions of the Agreement will remain in full force and effect.