

REUSE OF DOCUMENTS: THESE DOCUMENTS AND DESIGNS PROVIDED BY PROFESSIONAL SERVICE, INCORPORATED HEREIN, ARE THE PROPERTY OF CDM SMITH AND ARE NOT TO BE USED, IN WHOLE OR PART, FOR ANY OTHER PROJECT WITHOUT THE WRITTEN AUTHORIZATION OF CDM SMITH.

	Section 4.6.16 (H)(3)(a) - 5' Minimum landscape strip between the off-street parking area or other vehicular use area and the right-of-way.
	Section 4.6.16 (H)(3)(i) - One shade tree shall be planted in every island with a minimum of 75 square feet of shrubs and groundcovers.
	Section 4.6.16 (H)(4)(a) - Foundation landscaping shall be required. This shall incorporate trees, shrubs and groundcovers with the minimum required specifications as set forth in 4.6.16(E). Multiple tiers of plant material should be utilized and thoughtfully designed to accomplish the goal of softening the building mass while adding vibrant color and textures.
	Impervious area
	Pervious area

APPROX
21.0
PER M

ISSUED FOR PERMITTING

REV. NO.	DATE	DRWN	CHKD	REMARKS

DESIGNED BY: _____ AF/BB
DRAWN BY: _____ AF/BB
SHEET CHK'D BY: _____ EH
CROSS CHK'D BY: _____ JG
APPROVED BY: _____ EH
DATE: _____ AUGUST 2025

**CDM
Smith**
621 N.W. 53rd St., Suite 265
Boca Raton, FL 33487
Tel: (561) 571-3800



XREFS: [CDMS_2234, CW2001ST, CEP000ST, AWP000NF, XR-22 X 34-SRVY-BRDR, CEP001ST] Images: []
Last saved by: MILLERZA Time: 12/5/2024 2:28:04 PM
C:\Users\millerza\Documents\CDM Smith Inc\Delray Membrane WTP Project Files\Design\02 Civil\10 CAD\1-3.dwg
© 2025 CDM SMITH ALL RIGHTS RESERVED.
REUSE OF DOCUMENTS: THESE DOCUMENTS AND DESIGNS PROVIDED BY PROFESSIONAL SERVICE, INCORPORATED HEREIN, ARE THE PROPERTY OF CDM SMITH AND ARE NOT TO BE USED, IN WHOLE OR PART, FOR ANY OTHER PROJECT WITHOUT THE WRITTEN AUTHORIZATION OF CDM SMITH.

NOTE: EXISTING SITE FEATURES AND APPURTENANCES SUCH AS, BUT NOT LIMITED EXISTING CONTOUR LINES, VAULTS PIPING, WELL LOCATIONS, ETC. ARE SHOWN AND LABELED ON THE LANDSCAPE PLANS FOR REFERENCE ONLY. REFER TO DEMOLITION AND CIVIL PLANS FOR DISPOSITION OF SITE FEATURES OTHER THAN LANDSCAPE MATERIALS.

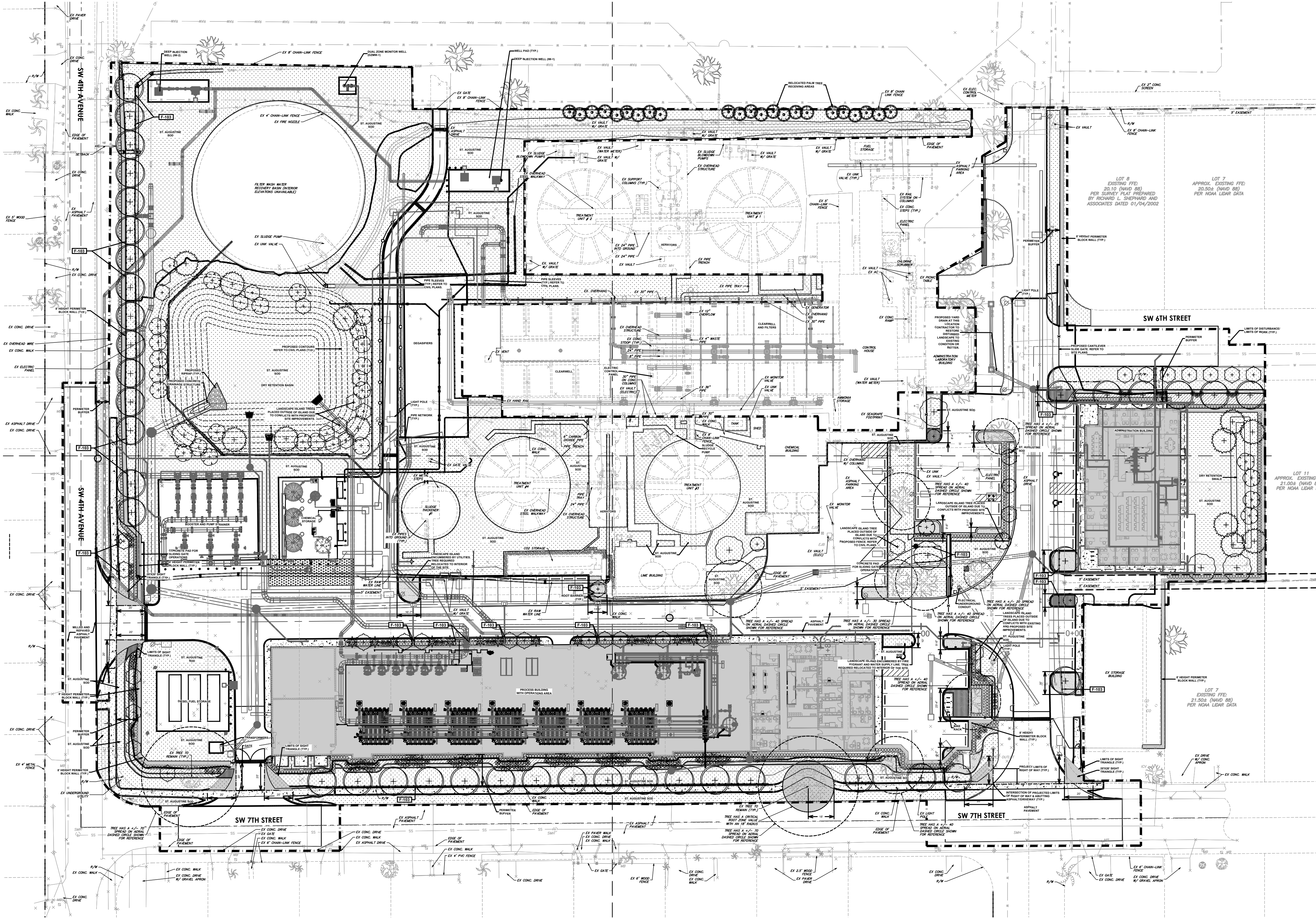

*NOTE:
LANDSCAPE IMPROVEMENTS ARE PREDICATED ON THE AREA ASSOCIATED WITH THE LIMITS OF WORK. LANDSCAPE REQUIREMENTS OUTSIDE OF THESE LIMITS ARE CONSIDERED CODE COMPLIANT AND IS NOT REQUIRED PER COORDINATION WITH CITY STAFF ON 12/10/2024.

SECTION 4.6.16(D)(2)(D): ALL TREE(S) WHICH ARE TO BE PRESERVED UNDER THIS SECTION AND DO NOT SURVIVE SHALL BE REPLACED BY A TREE A MINIMUM OF 18 FEET IN HEIGHT WITH A TEN-FOOT SPREAD OF CANOPY.

ANY TREES OR SHRUBS PLACED WITHIN WATER, SEWER OR DRAINAGE ELEMENTS SHALL CONFORM TO THE CITY OF DELRAY BEACH STANDARD DETAILS: LD 1.0 & LD 2.0.

INDIVIDUAL TREES PLANTED IN LAWN AREAS SHALL BE MULCHED WITH A MINIMUM 3' DIAMETER MULCH RING PER LANDSCAPE NOTE 7.2.

SECTION 4.6.16(E): PLANT SCHEDULE HAS BEEN CREATED FOLLOWING FLORIDA-FRIENDLY LANDSCAPE PRINCIPLES THROUGH THE SELECTION OF A MAJORITY OF FLORIDA NATIVE PLANTS.

SECTION 4.6.16(H)(3)(A): ONE TREE SHALL BE PLANTED EVERY 25' TO FORM A SOLID TREE LINE. ANY TREE(S) THAT CONFLICT WITH THE EXISTING OR PROPOSED UTILITY DESIGN, PROPOSED SIDEWALK OR PROPOSED SCREENING WALL ALONG SW 4TH AVENUE WILL BE INSTALLED BEHIND THE PERIMETER WALL WITHIN THE INTERIOR OF THE SITE.

PLAN
1"=40'-0"



500 Australian Avenue South
Suite 850
West Palm Beach, FL 33401
561.746.6900
www.chenmoore.com

ROOT BARRIER AND WEED FABRIC SCHEDULE

SYMBOL	CODE	DESCRIPTION	QTY
	F-103	ROOT BARRIER	1,573 LF
	K-101	57 GRAVEL WITH WEED FABRIC	2,12 CY

THIS ITEM HAS BEEN DIGITALLY SIGNED BY:
ERIC D. HARRISON,
RLA ON THE DATE ADJACENT TO THE SEAL.
PRINTED COPIES OF THIS DOCUMENT ARE
NOT CONSIDERED SIGNED AND SEALED
AND THE SIGNATURE MUST BE VERIFIED ON
ANY ELECTRONIC COPIES.

THE NAMED LICENSE LANDSCAPE
ARCHITECT SHALL BE RESPONSIBLE FOR THIS
SHEET IN ACCORDANCE WITH RULE
61G10-11.011, F.A.C.

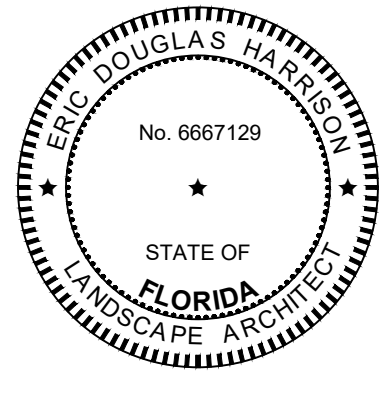

DATE:
ERIC HARRISON
LA NO. 6667129

PROJECT NO. 159676-291242
FILE NAME: L-5.DWG

SHEET NO.

L-5

ISSUED FOR PERMITTING

PLANT LEGEND

SYMBOL	CODE	COMMON NAME	RELOCATED PALMS
	TD	Bald Cypress	SS-R Cobbage Palmetto
	IC	Dahoon Holly	COA Auntie Lou Ti Plant
	CD	Green Buttonwood	VIB Evergreen Sweet Viburnum
	BS	Gumbo Limbo	COM Mammy Crotan
	QV	Live Oak 'Cathedral'	CHR Red Tip Coco Plum
	AG	Pond Apple	
	MR	Simpson's Stopper	
	PE	Alexander Palm	
	PD	Date Palm	

SHRUBS	SHRUB AREAS	GROUND COVERS	MULCH
	HAP2 Firebush	HED Dune Sunflower	MUL MULCH
	DUE Gold Mound Duranta	ZAF Florida Coanle	
	FIG Green Island Ficus		

PLANTING NOTES:

- CONTRACTOR SHALL REFER TO THE LANDSCAPE PLANTING DETAILS, PLANT LIST, GENERAL NOTES AND ALL CONTRACT DOCUMENTS FOR FURTHER AND COMPLETE INSTRUCTIONS.
- PLANT LIST QUANTITIES ARE PROVIDED FOR CONVENIENCE. IN THE EVENT OF QUANTITY DISCREPANCIES THE DRAWING SHALL TAKE PRECEDENCE. ANY DISCREPANCIES SHALL BE BROUGHT TO THE ATTENTION OF THE LANDSCAPE ARCHITECT PRIOR TO BIDDING.
- PLANT SIZES LISTED ARE THE MINIMUM SIZE THAT WILL BE ACCEPTED FOR THAT PLANT.
- ANY SUBSTITUTION IN SIZE AND/OR PLANT MATERIAL MUST BE APPROVED BY THE LANDSCAPE ARCHITECT IN WRITING. ALL PLANTS WILL BE SUBJECT TO APPROVAL BY LANDSCAPE ARCHITECT AND/OR OWNER'S REPRESENTATIVE BEFORE PLANTING CAN BEGIN.
- CONTRACTOR SHALL FIELD ADJUST LOCATION OF PLANT MATERIAL AS NECESSARY TO AVOID DAMAGE TO EXISTING UNDERGROUND UTILITIES AND/OR INTERFERE WITH EXISTING ABOVE GRADE ELEMENTS. ALL CHANGES REQUIRED SHALL BE COMPLETED AT THE CONTRACTOR'S EXPENSE AND SHALL BE COORDINATED WITH THE OWNER'S REPRESENTATIVE AND THE LANDSCAPE ARCHITECT.
- THE CONTRACTOR SHALL BEAR ALL COSTS OF TESTING OF SOILS, AMENDMENTS, ETC. ASSOCIATED WITH THE WORK AND INCLUDED IN THE SPECIFICATIONS.
- CONTRACTOR SHALL FAMILIARIZE HIM/HERSELF WITH THE LIMITS OF WORK AND EXISTING CONDITIONS AND VERIFY ALL INFORMATION. IF DISCREPANCIES EXIST, CONTRACTOR SHALL NOTIFY OWNER'S REPRESENTATIVE IN WRITING WITHIN SEVEN CALENDAR DAYS OF NOTICE TO PROCEED.
- ALL NEW AND TRANSPLANTED PLANT MATERIAL SHALL BE IRRIGATED BY AN AUTOMATIC UNDERGROUND IRRIGATION SYSTEM.
- ANY TREES OR SHRUBS PLACED WITHIN WATER, SEWER, OR DRAINAGE EASEMENTS SHALL CONFORM TO CITY OF DELRAY BEACH STANDARD DETAILS.
- A FULL IRRIGATION DESIGN WILL BE PROVIDED AT THE TIME OF THE BUILDING DEPARTMENT SUBMITTAL PER COORDINATION WITH STAFF HELD ON 12/10/2024.
- REFER TO SHEET L-9 FOR FULL PLANT SCHEDULE AND LANDSCAPE CALCULATIONS.

FOR DEVELOPMENT SERVICES USE

XREFS: [CDMS_2234, CW2001ST, CEP000ST, AWP000NF, XR-22 X 34-SRVY-BRDR, CEP001ST] Images: []
Last saved by: MILLERZA Time: 12/5/2024 2:28:04 PM
C:\Users\millerza\Documents\CDM Smith Inc\Delray Membrane WTP\Project Files\Design\02 Civil\10 CAD\10-3.dwg
© 2025 CDM SMITH ALL RIGHTS RESERVED.
REUSE OF DOCUMENTS: THESE DOCUMENTS AND DESIGNS PROVIDED BY PROFESSIONAL SERVICE, INCORPORATED HEREIN, ARE THE PROPERTY OF CDM SMITH AND ARE NOT TO BE USED, IN WHOLE OR PART, FOR ANY OTHER PROJECT WITHOUT THE WRITTEN AUTHORIZATION OF CDM SMITH.

NOTE: EXISTING SITE FEATURES AND APPURTENANCES SUCH AS, BUT NOT LIMITED EXISTING CONTOUR LINES, VAULTS PIPING, WELL LOCATIONS, ETC. ARE SHOWN AND LABELED ON THE LANDSCAPE PLANS FOR REFERENCE ONLY. REFER TO DEMOLITION AND CIVIL PLANS FOR DISPOSITION OF SITE FEATURES OTHER THAT LANDSCAPE MATERIALS.

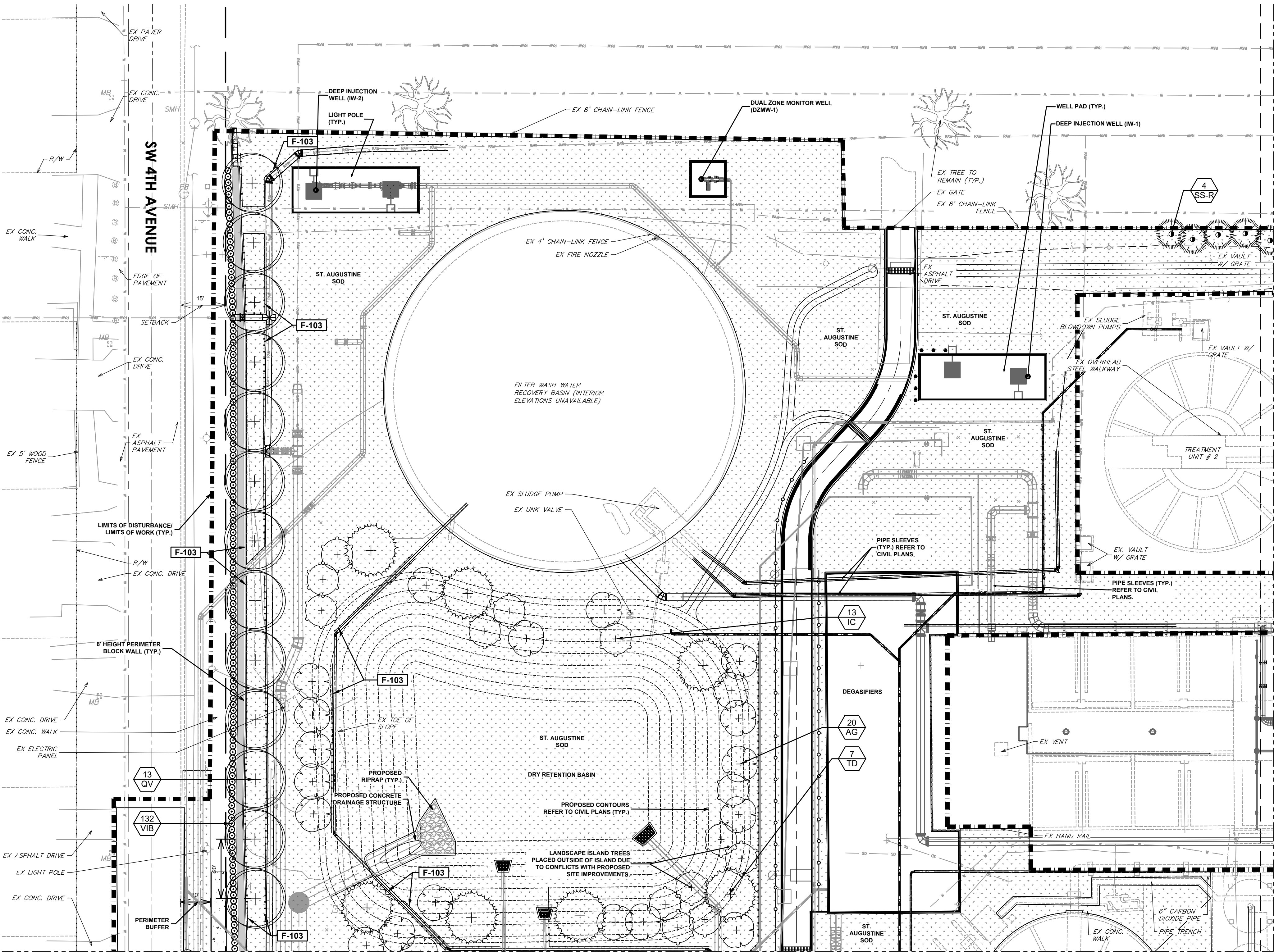

*NOTE:
LANDSCAPE IMPROVEMENTS ARE PREDICATED ON THE AREA ASSOCIATED WITH THE LIMITS OF WORK. LANDSCAPE REQUIREMENTS OUTSIDE OF THESE LIMITS ARE CONSIDERED CODE COMPLIANT AND IS NOT REQUIRED PER COORDINATION WITH CITY STAFF ON 12/10/2024.

SECTION 4.6.16(D)(2)(D): ALL TREE(S) WHICH ARE TO BE PRESERVED UNDER THIS SECTION AND DO NOT SURVIVE SHALL BE REPLACED BY A TREE A MINIMUM OF 18 FEET IN HEIGHT WITH A TEN-FOOT SPREAD OF CANOPY.

ANY TREES OR SHRUBS PLACED WITHIN WATER, SEWER OR DRAINAGE ELEMENTS SHALL CONFORM TO THE CITY OF DELRAY BEACH STANDARD DETAILS; LD 1.0 & LD 2.0.

INDIVIDUAL TREES PLANTED IN LAWN AREAS SHALL BE MULCHED WITH A MINIMUM 3' DIAMETER MULCH RING PER LANDSCAPE NOTE 7.2.

SECTION 4.6.16(E): PLANT SCHEDULE HAS BEEN CREATED FOLLOWING FLORIDA-FRIENDLY LANDSCAPE PRINCIPLES THROUGH THE SELECTION OF A MAJORITY OF FLORIDA NATIVE PLANTS.

SECTION 4.6.16(H)(3)(A): ONE TREE SHALL BE PLANTED EVERY 25' TO FORM A SOLID TREE LINE. ANY TREE(S) THAT CONFLICT WITH THE EXISTING OR PROPOSED UTILITY DESIGN, PROPOSED SIDEWALK OR PROPOSED SCREENING WALL ALONG SW 4TH AVENUE WILL BE INSTALLED BEHIND THE PERIMETER WALL WITHIN THE INTERIOR OF THE SITE.

PLAN
1"=40'-0"



500 Australian Avenue South
Suite 850
West Palm Beach, FL 33401
561.746.6900
www.chenmoore.com



DELRAY BEACH, FLORIDA
DELRAY BEACH
MEMBRANE WATER TREATMENT PLANT

PLANT LEGEND

SYMBOL CODE COMMON NAME

TREES

+	TD	Bald Cypress
+	IC	Dahoon Holly
+	CD	Green Buttonwood
+	BS	Gumbo Limbo
+	QV	Live Oak 'Cathedral'
+	AG	Pond Apple
+	MR	Simpson's Stopper

PALMS

+	PE	Alexander Palm
+	PD	Date Palm

RELOCATED PALMS

+	SS-R	Cabbage Palmetto
---	------	------------------

SHRUBS

+	COA	Auntie Lou Ti Plant
+	VIB	Evergreen Sweet Viburnum
+	COM	Mommy Croton
+	CHR	Red Tip Coco Plum

SHRUB AREAS

+	HAP2	Firebush
+	DUE	Gold Mound Duranta
+	FIG	Green Island Ficus

GROUND COVERS

+	HED	Dune Sunflower
+	ZAF	Florida Coontie

MULCH

+	MUL	MULCH
---	-----	-------

SOD

+	SOD	St. Augustine Grass
---	-----	---------------------

ROOT BARRIER SCHEDULE

CODE DESCRIPTION QTY

FENCE

+	F-103	ROOT BARRIER	885 LF
---	-------	--------------	--------

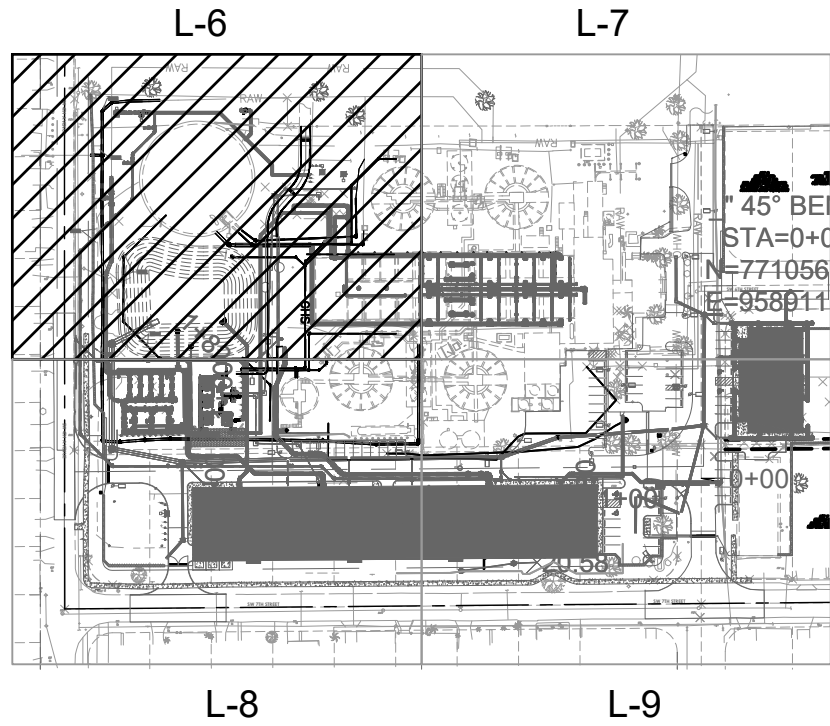

KEY PLAN

1"=200'-0"

FOR DEVELOPMENT SERVICES USE

THIS ITEM HAS BEEN DIGITALLY SIGNED BY:
ERIC D. HARRISON,
RLA ON THE DATE ADJACENT TO THE SEAL.
PRINTED COPIES OF THIS DOCUMENT ARE
NOT CONSIDERED SIGNED AND SEALED
AND THE SIGNATURE MUST BE VERIFIED ON
ANY ELECTRONIC COPIES.

THE NAMED LICENSE LANDSCAPE
ARCHITECT SHALL BE RESPONSIBLE FOR THIS
SHEET IN ACCORDANCE WITH RULE
61G10-11.011, F.A.C.

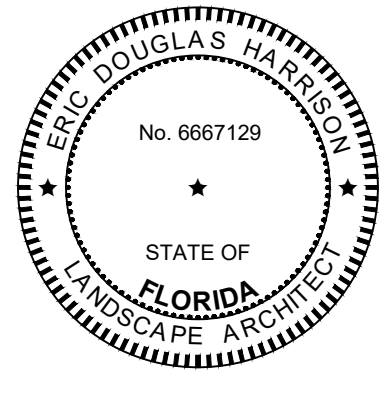

DATE:
ERIC HARRISON
LA NO. 6667129

PROJECT NO. 159676-291242
FILE NAME: L-6.DWG

SHEET NO.

L-6

ISSUED FOR PERMITTING

XREFS: [CDMS_2234, AWP0004B, AWP000NF, CWZ001ST, CEP001ST] Images: []
Last saved by: MILLERZA Time: 12/5/2024 2:31:25 PM
C:\Users\millerza\Documents\CDM Smith Inc\Delray Membrane WTP\Project Files\Design\02 Civil\10 CAD\1-4.dwg
© 2025 CDM SMITH ALL RIGHTS RESERVED.
REUSE OF DOCUMENTS: THESE DOCUMENTS AND DESIGNS PROVIDED BY PROFESSIONAL SERVICE, INCORPORATED HEREIN, ARE THE PROPERTY OF CDM SMITH AND ARE NOT TO BE USED, IN WHOLE OR PART, FOR ANY OTHER PROJECT WITHOUT THE WRITTEN AUTHORIZATION OF CDM SMITH.

NOTE: EXISTING SITE FEATURES AND APPURTENANCES SUCH AS, BUT NOT LIMITED EXISTING CONTOUR LINES, VAULTS PIPING, WELL LOCATIONS, ETC. ARE SHOWN AND LABELED ON THE LANDSCAPE PLANS FOR REFERENCE ONLY. REFER TO DEMOLITION AND CIVIL PLANS FOR DISPOSITION OF SITE FEATURES OTHER THAT LANDSCAPE MATERIALS.

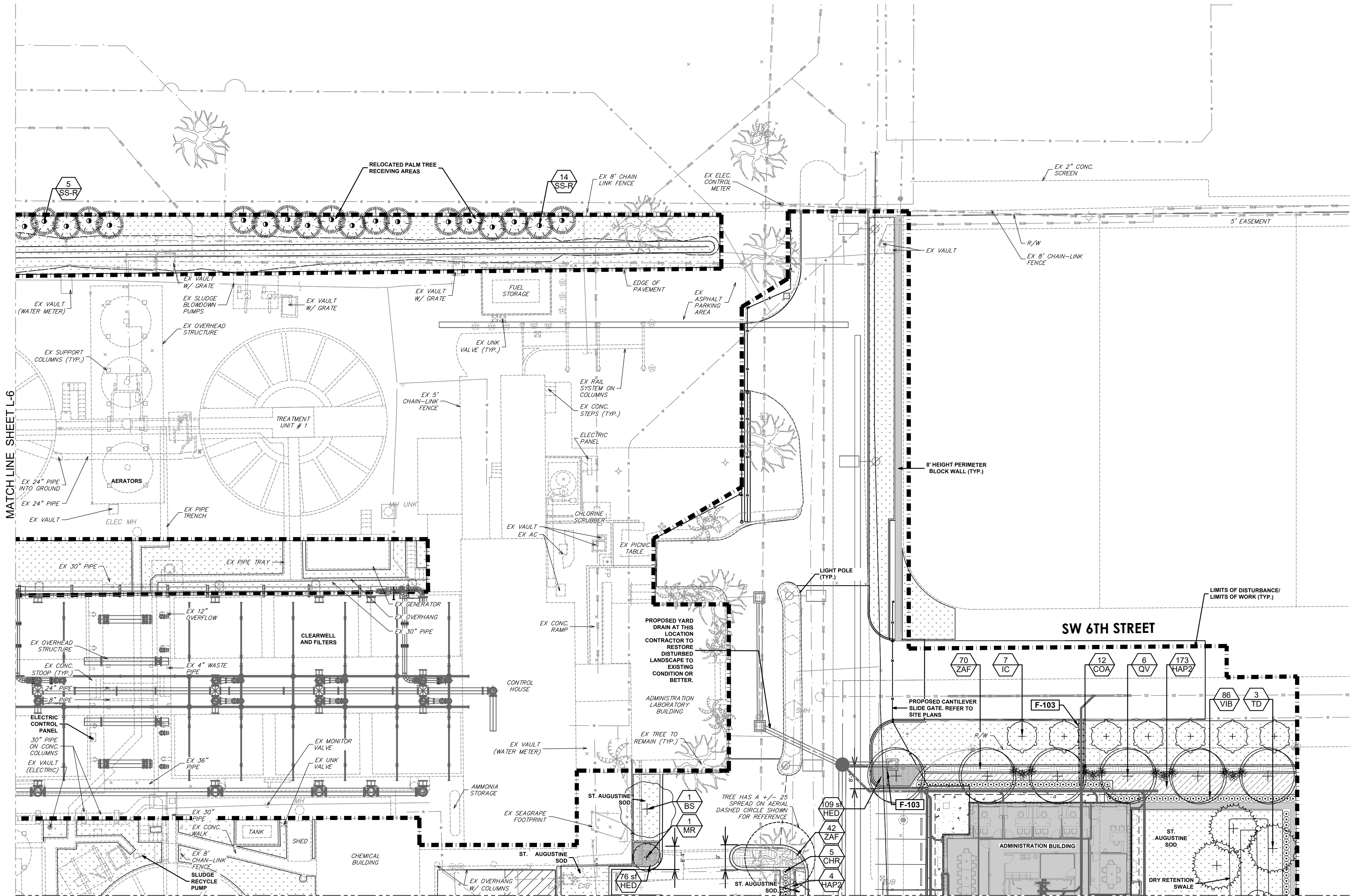

*NOTE:
LANDSCAPE IMPROVEMENTS ARE PREDICATED ON THE AREA ASSOCIATED WITH THE LIMITS OF WORK. LANDSCAPE REQUIREMENTS OUTSIDE OF THESE LIMITS ARE CONSIDERED CODE COMPLIANT AND IS NOT REQUIRED PER COORDINATION WITH CITY STAFF ON 12/10/2024.

SECTION 4.6.16(D)(2)(D): ALL TREE(S) WHICH ARE TO BE PRESERVED UNDER THIS SECTION AND DO NOT SURVIVE SHALL BE REPLACED BY A TREE A MINIMUM OF 18 FEET IN HEIGHT WITH A TEN-FOOT SPREAD OF CANOPY.

ANY TREES OR SHRUBS PLACED WITHIN WATER, SEWER OR DRAINAGE ELEMENTS SHALL CONFORM TO THE CITY OF DELRAY BEACH STANDARD DETAILS; LD 1.0 & LD 2.0.

INDIVIDUAL TREES PLANTED IN LAWN AREAS SHALL BE MULCHED WITH A MINIMUM 3' DIAMETER MULCH RING PER LANDSCAPE NOTE 7.2.

SECTION 4.6.16(E): PLANT SCHEDULE HAS BEEN CREATED FOLLOWING FLORIDA-FRIENDLY LANDSCAPE PRINCIPLES THROUGH THE SELECTION OF A MAJORITY OF FLORIDA NATIVE PLANTS.

PLAN
1"=40'-0"



500 Australian Avenue South
Suite 850
West Palm Beach, FL 33401
561.746.6900
www.chenmoore.com



DELRAY BEACH, FLORIDA
DELRAY BEACH
MEMBRANE WATER TREATMENT PLANT

PLANT LEGEND

SYMBOL	CODE	COMMON NAME
TREES		
	TD	Bald Cypress
	IC	Dahoon Holly
	CD	Green Buttonwood
	BS	Gumbo Limbo
	QV	Live Oak 'Cathedral'
	AG	Pond Apple
	MR	Simpson's Stopper
PALMS		
	PE	Alexander Palm
	PD	Date Palm
RELOCATED PALMS		
	SS-R	Cabbage Palmetto
SHRUBS		
	COA	Auntie Lou Ti Plant
	VIB	Evergreen Sweet Viburnum
	COM	Mammy Croton
	CHR	Red Tip Coco Plum
SHRUB AREAS		
	HAP2	Firebush
	DUE	Gold Mound Duranta
	FIG	Green Island Ficus
GROUND COVERS		
	HED	Dune Sunflower
	ZAF	Florida Coontie
MULCH		
	MUL	MULCH
SOD		
	SOD	St. Augustine Grass

ROOT BARRIER SCHEDULE

CODE	DESCRIPTION	QTY
F-103	ROOT BARRIER	54 LF

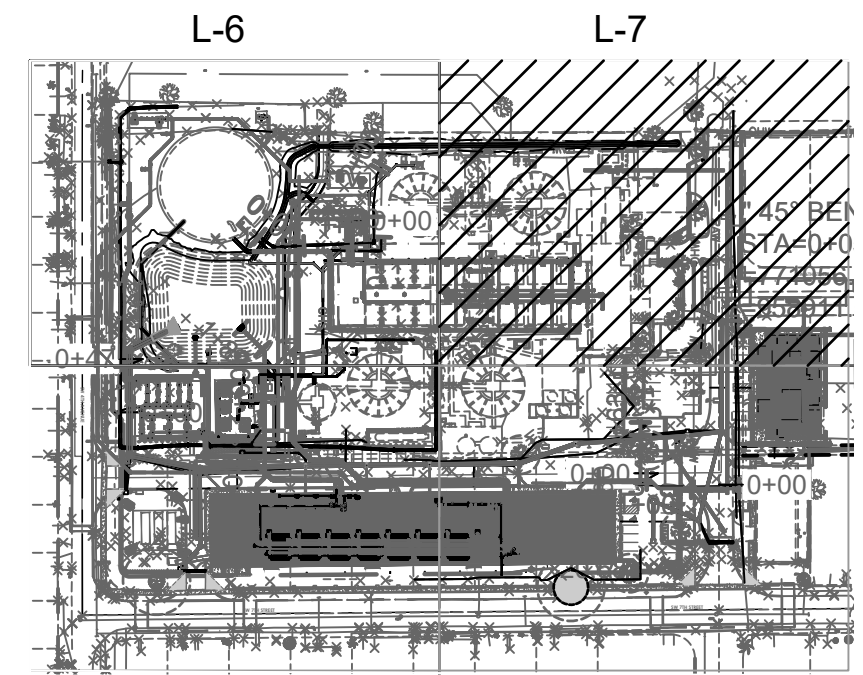

KEY PLAN

1"=200'-0"

FOR DEVELOPMENT SERVICES USE

THIS ITEM HAS BEEN DIGITALLY SIGNED BY:
ERIC D. HARRISON,
RLA ON THE DATE ADJACENT TO THE SEAL.
PRINTED COPIES OF THIS DOCUMENT ARE
NOT CONSIDERED SIGNED AND SEALED
AND THE SIGNATURE MUST BE VERIFIED ON
ANY ELECTRONIC COPIES.

THE NAMED LICENSE LANDSCAPE
ARCHITECT SHALL BE RESPONSIBLE FOR THIS
SHEET IN ACCORDANCE WITH RULE
61G10-11.011, F.A.C.

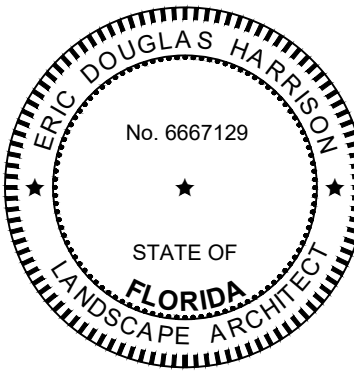

DATE:
ERIC HARRISON
LA NO. 6667129

PROJECT NO. 159676-291242
FILE NAME: L-7.DWG

SHEET NO.



L-7

ISSUED FOR PERMITTING

MATCH LINE SHEET L-6

ROOT BARRIER SCHEDULE

<u>SYMBOL</u>	<u>CODE</u>	<u>DESCRIPTION</u>	<u>QTY</u>
---------------	-------------	--------------------	------------

FENCE			
	F-103	ROOT BARRIER	480 L
ROCK			
	K-101	57 GRAVEL WITH WEED FABRIC	2.12

$$1'' = 200' - 0''$$

THIS ITEM HAS BEEN DIGITALLY SIGNED BY:
ERIC D. HARRISON,
RLA ON THE DATE ADJACENT TO THE SEAL.
PRINTED COPIES OF THIS DOCUMENT ARE
NOT CONSIDERED SIGNED AND SEALED
AND THE SIGNATURE MUST BE VERIFIED ON
ANY ELECTRONIC COPIES.

THE NAMED LICENSE LANDSCAPE
ARCHITECT SHALL BE RESPONSIBLE FOR THIS
SHEET IN ACCORDANCE WITH RULE
61G10-11.011, F.A.C.

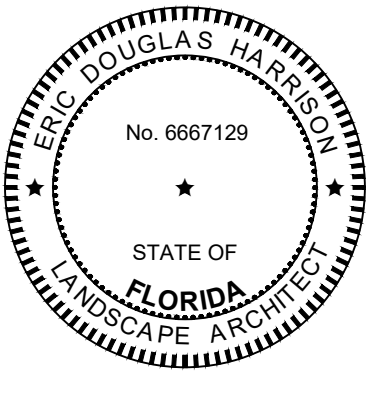

DATE:
ERIC HARRISON
LA NO. 6667129

PROJECT NO. 159676-291242
FILE NAME: L-8.DWG

SHEET NO.

L-8

ISSUED FOR PERMITTING

CDS: 2234, CWZ001ST, AWP0004B, AWP000NF, CEP001ST Images: ☐
 XREFS: [CDS: 2234, CWZ001ST, 12/5/2024 2:35:35 PM
 Last used by: MILLERA
 C: Users\millerza\DC\ACCDocs\CDM Smith Inc\Delroy Membrane WTP\Project Files\Design\02 Civil\10 CADD\L-5.dwg
 © 2005 CDM SMITH ALL RIGHTS RESERVED.

*NOTE:
LANDSCAPE IMPROVEMENTS ARE PREDICATED ON THE AREA ASSOCIATED WITH THE LIMITS OF WORK. LANDSCAPE REQUIREMENTS OUTSIDE OF THESE LIMITS ARE CONSIDERED CODE COMPLIANT AND IS NOT REQUIRED PER COORDINATION WITH CITY STAFF ON 12/10/2024.

SECTION 4.6.16(D)(2)(D): ALL TREE(S) WHICH ARE TO BE PRESERVED UNDER THIS SECTION AND DO NOT SURVIVE SHALL BE REPLACED BY A TREE A MINIMUM OF 18 FEET IN HEIGHT WITH A TEN-FOOT SPREAD OF CANOPY.

ANY TREES OR SHRUBS PLACED WITHIN WATER, SEWER OR DRAINAGE ELEMENTS SHALL CONFORM TO THE CITY OF DELRAY BEACH STANDARD DETAILS; LD 1.0 & LD 2.0.

INDIVIDUAL TREES PLANTED IN LAWN AREAS SHALL BE MULCHED WITH A MINIMUM 3' DIAMETER MULCH RING PER LANDSCAPE NOTE 7.2.

SECTION 4.6.16(E): PLANT SCHEDULE HAS BEEN CREATED FOLLOWING FLORIDA-FRIENDLY LANDSCAPE PRINCIPLES THROUGH THE SELECTION OF A MAJORITY OF FLORIDA NATIVE PLANTS.

SECTION 4.6.16(H)(3)(A): ONE TREE SHALL BE PLANTED EVERY 25' TO FORM A SOLID TREE LINE. ANY TREE(S) THAT CONFLICT WITH THE EXISTING OR PROPOSED UTILITY DESIGN, PROPOSED SIDEWALK OR PROPOSED SCREENING WALL ALONG SW 4TH AVENUE WILL BE INSTALLED BEHIND THE PERIMETER WALL WITHIN THE INTERIOR OF THE SITE.

PLAN

$$1'' = 40' - 0''$$

500 Australian Avenue South
Suite 850
West Palm Beach, FL 33401
561.746.6900
www.chenmoore.com



DELRAY BEACH, FLORIDA
DELRAY BEACH
MEMBRANE WATER TREATMENT PLANT

					DESIGNED BY: _____ AF/BB
					DRAWN BY: _____ AF/BB
					SHEET CHK'D BY: _____ EH
					CROSS CHK'D BY: _____ JG
					APPROVED BY: _____ EH
					DATE: _____ AUGUST 2025
REV. NO.	DATE	DRWN	CHKD	REMARKS	



DESIGNED BY: _____ AF/BB
DRAWN BY: _____ AF/BB
SHEET CHK'D BY: _____ EH
CROSS CHK'D BY: _____ JG
APPROVED BY: _____ EH
DATE: _____ AUGUST 2025

REV. NO.	DATE	DRWN	CHKD	REMARKS	

XREFs: [CDMS_2234_CW2001ST_CEP000ST_AWP000AB_AWP000NF] Images: []
Last saved by: MILLERZA Time: 12/5/2024 2:36:56 PM
C:\Users\millerza\Documents\CDM Smith Inc\Delray Membrane WTP\Project Files\Design\02 Civil\10 CAD\1--6.dwg
© 2025 CDM SMITH ALL RIGHTS RESERVED.
REUSE OF DOCUMENTS: THESE DOCUMENTS AND DESIGNS PROVIDED BY PROFESSIONAL SERVICE, INCORPORATED HEREIN, ARE THE PROPERTY OF CDM SMITH AND ARE NOT TO BE USED, IN WHOLE OR PART, FOR ANY OTHER PROJECT WITHOUT THE WRITTEN AUTHORIZATION OF CDM SMITH.

NOTE: EXISTING SITE FEATURES AND APPURTENANCES SUCH AS, BUT NOT LIMITED EXISTING CONTOUR LINES, VAULTS PIPING, WELL LOCATIONS, ETC. ARE SHOWN AND LABELED ON THE LANDSCAPE PLANS FOR REFERENCE ONLY. REFER TO DEMOLITION AND CIVIL PLANS FOR DISPOSITION OF SITE FEATURES OTHER THAT LANDSCAPE MATERIALS.

MATCH LINE SHEET L-7

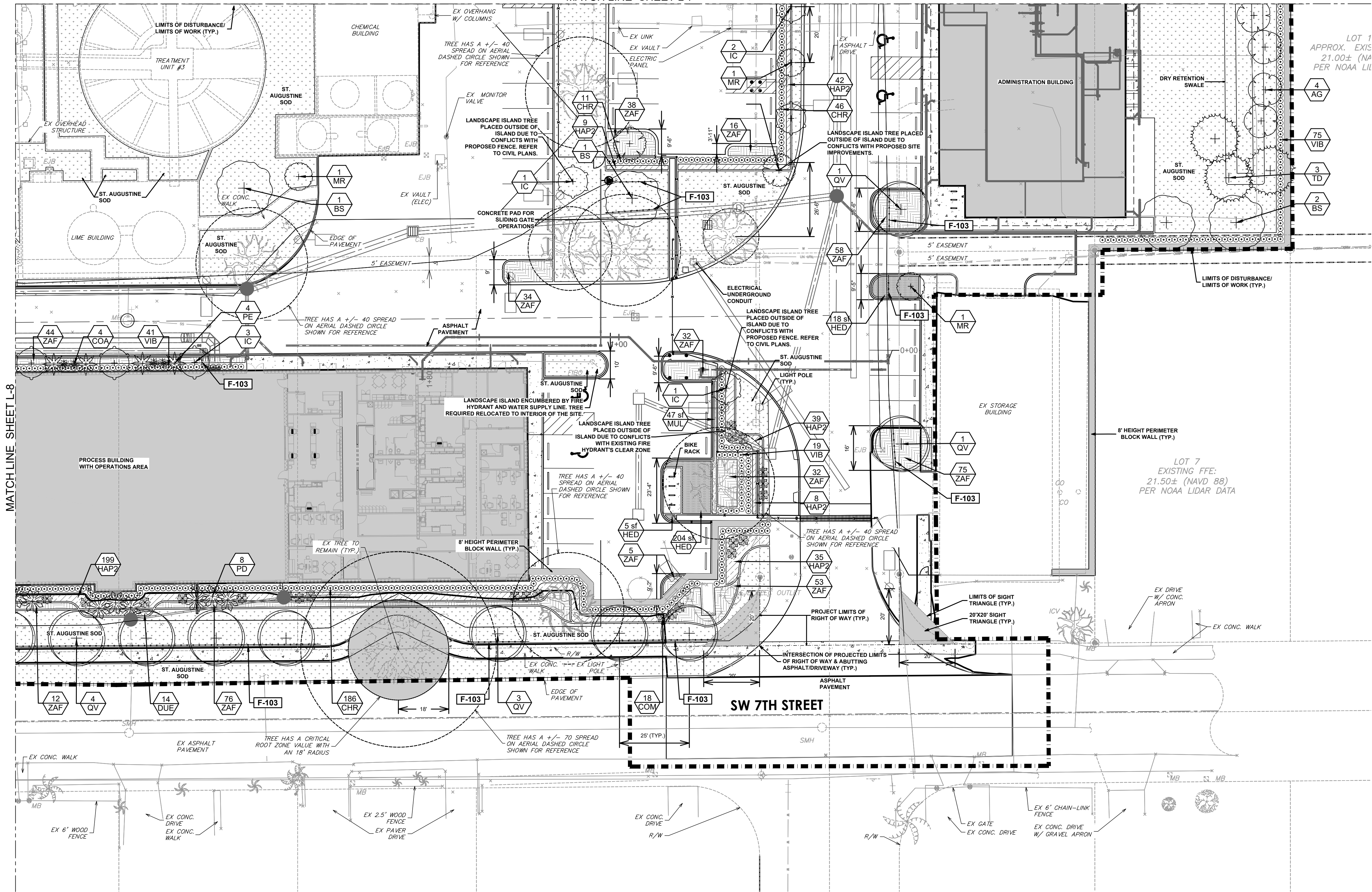

*NOTE:
LANDSCAPE IMPROVEMENTS ARE PREDICATED ON THE AREA ASSOCIATED WITH THE LIMITS OF WORK. LANDSCAPE REQUIREMENTS OUTSIDE OF THESE LIMITS ARE CONSIDERED CODE COMPLIANT AND IS NOT REQUIRED PER COORDINATION WITH CITY STAFF ON 12/10/2024.

SECTION 4.6.16(D)(2)(D): ALL TREE(S) WHICH ARE TO BE PRESERVED UNDER THIS SECTION AND DO NOT SURVIVE SHALL BE REPLACED BY A TREE A MINIMUM OF 18 FEET IN HEIGHT WITH A TEN-FOOT SPREAD OF CANOPY.

ANY TREES OR SHRUBS PLACED WITHIN WATER, SEWER OR DRAINAGE ELEMENTS SHALL CONFORM TO THE CITY OF DELRAY BEACH STANDARD DETAILS; LD 1.0 & LD 2.0.

INDIVIDUAL TREES PLANTED IN LAWN AREAS SHALL BE MULCHED WITH A MINIMUM 3' DIAMETER MULCH RING PER LANDSCAPE NOTE 7.2.

SECTION 4.6.16(E): PLANT SCHEDULE HAS BEEN CREATED FOLLOWING FLORIDA-FRIENDLY LANDSCAPE PRINCIPLES THROUGH THE SELECTION OF A MAJORITY OF FLORIDA NATIVE PLANTS.

PLAN
1"=40'-0"



500 Australian Avenue South
Suite 850
West Palm Beach, FL 33401
561.746.6900
www.chenmoore.com



DELRAY BEACH, FLORIDA
DELRAY BEACH
MEMBRANE WATER TREATMENT PLANT

LANDSCAPE PLAN IV

PLANT LEGEND

SYMBOL	CODE	COMMON NAME
TREES		
	TD	Bald Cypress
	IC	Dahoon Holly
	CD	Green Buttonwood
	BS	Gumbo Limbo
	QV	Live Oak 'Cathedral'
	AG	Pond Apple
	MR	Simpson's Stopper
PALMS		
	PE	Alexander Palm
	PD	Date Palm
RELOCATED PALMS		
	SS-R	Cabbage Palmetto
SHRUBS		
	COA	Auntie Lou Ti Plant
	VIB	Evergreen Sweet Viburnum
	COM	Mammy Croton
	CHR	Red Tip Coco Plum
SHRUB AREAS		
	HAP2	Firebush
	DUE	Gold Mound Duranta
	FIG	Green Island Ficus
GROUND COVERS		
	HED	Dune Sunflower
	ZAF	Florida Coontie
MULCH		
	MUL	MULCH
SOD		
	SOD	St. Augustine Grass

ROOT BARRIER SCHEDULE

CODE	DESCRIPTION	QTY
F-103	ROOT BARRIER	154 LF

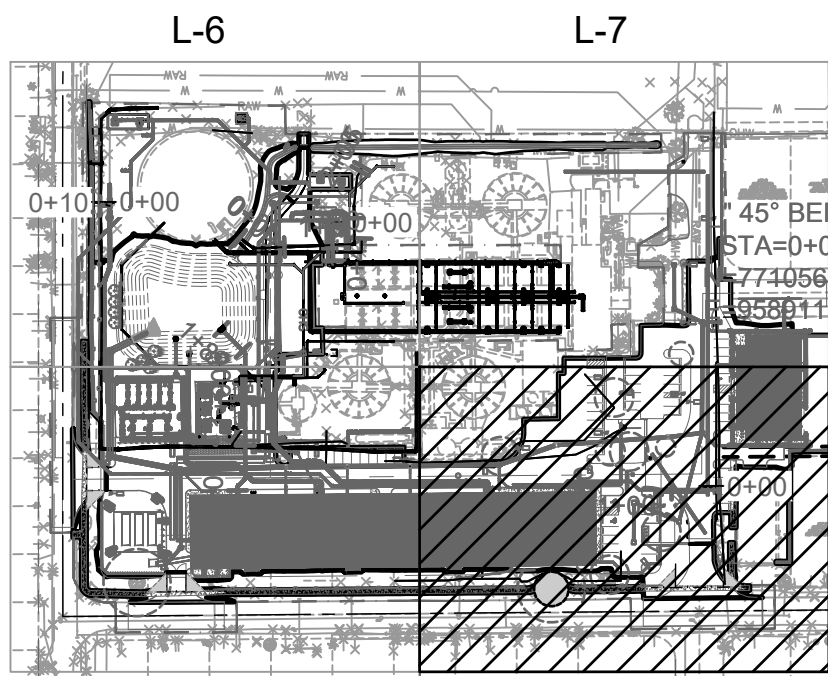

KEY PLAN

1"=200'-0"

FOR DEVELOPMENT SERVICES USE

THIS ITEM HAS BEEN DIGITALLY SIGNED BY:
ERIC D. HARRISON,
RLA ON THE DATE ADJACENT TO THE SEAL.
PRINTED COPIES OF THIS DOCUMENT ARE
NOT CONSIDERED SIGNED AND SEALED
AND THE SIGNATURE MUST BE VERIFIED ON
ANY ELECTRONIC COPIES.

THE NAMED LICENSE LANDSCAPE
ARCHITECT SHALL BE RESPONSIBLE FOR THIS
SHEET IN ACCORDANCE WITH RULE
61G10-11.011, F.A.C.

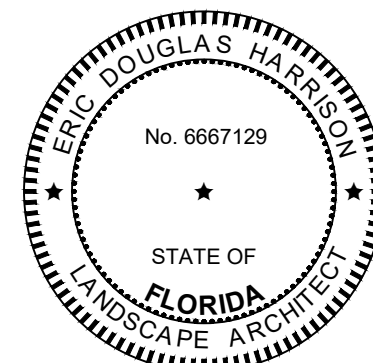

DATE:
ERIC HARRISON
LA NO. 6667129

PROJECT NO. 159676-291242
FILE NAME: L-9.DWG

SHEET NO.

L-9

ISSUED FOR PERMITTING

XREFs: [CDMS_2234] Images: []
Last saved by: MILLERZA Time: 10/16/2024 5:01:30 PM
C:\Users\millerza\Documents\CDM Smith Inc\Delray Membrane WTP\Project Files\Design\02 Civil\10 CADD\U007LSP.dwg
©2025 CDM SMITH ALL RIGHTS RESERVED.
REUSE OF DOCUMENTS: THESE DOCUMENTS AND DESIGNS PROVIDED BY PROFESSIONAL SERVICE, INCORPORATED HEREIN, ARE THE PROPERTY OF CDM SMITH AND ARE NOT TO BE USED, IN WHOLE OR PART, FOR ANY OTHER PROJECT WITHOUT THE WRITTEN AUTHORIZATION OF CDM SMITH.

PLANT SCHEDULE



SYMBOL	CODE	QTY	COMMON NAME	BOTANICAL NAME	CONT	SIZE	NATIVE
TREES							
	AG	24	POND APPLE	ANNONA GLABRA	SEE SIZE	8' OAH, 3" DBH, 4' SPRD	YES
	BS	5	GUMBO LIMBO	BURSERA SIMARUBA	SEE SIZE	16' OAH, 8' CT, 7' SPRD	YES
	CD	2	GREEN BUTTONWOOD	CONOCARPUS ERECTUS	SEE SIZE	8' OAH, 3" DBH, 4' SPRD	YES
	IC	41	DAHOON HOLLY	ILEX CASSINE	SEE SIZE	8' OAH, 3" DBH, 4' SPRD	YES
	MR	4	SIMPSON'S STOPPER	MYRICANTHES FRAGRANS	SEE SIZE	8' OAH, 3" DBH, 4' SPRD	YES
	QV	39	LIVE OAK 'CATHEDRAL'	QUERCUS VIRGINIANA	SEE SIZE	20' OAH, 8' CT, 7' SPRD	YES
	TD	13	BALD CYPRESS	TAXODIUM DISTICHUM	SEE SIZE	16' OAH, 8' CT, 7' SPRD	YES
PALMS							
	PD	24	DATE PALM	PHOENIX DACTYLIFERA	SEE SIZE	16' OAH, 8' CT	NO
	PE	13	ALEXANDER PALM	PTYCHOSPERMA ELEGANS	SEE SIZE	16' OAH, 8' CT	NO

RELOCATED PALMS

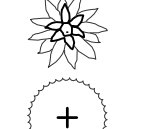

	SS-R	23	CABBAGE PALMETTO	SABAL PALMETTO	RELOCATED		
-----------------------------------------------------------------------------------	------	----	------------------	----------------	-----------	--	--

SYMBOL	CODE	QTY	COMMON NAME	BOTANICAL NAME	CONT	SIZE	NATIVE	SPACING
--------	------	-----	-------------	----------------	------	------	--------	---------

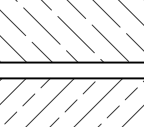
SHRUBS

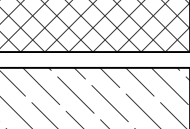

	CHR	382	RED TIP COCO PLUM	CHRYSOBALANUS ICACO 'RED TIP'	SEE SIZE	5'-6` HT, FULL	YES	24" o.c.
	COM	52	MAMMY CROTON	CODIAEUM VARIEGATUM 'MAMMY'	SEE SIZE	3` HT, FULL	NO	48" o.c.
	COA	22	AUNTIE LOU TI PLANT	CORDYLINE FRUTICOSA 'AUNTIE LOU'	SEE SIZE	3` HT, FULL	NO	48" o.c.
	VIB	564	EVERGREEN SWEET VIBURNUM	VIBURNUM AWABUKI	SEE SIZE	5'-6` HT, FULL	NO	24" o.c.

SHRUB AREAS

	DUE	109	GOLD MOUND DURANTA	DURANTA ERECTA 'GOLD MOUND'	SEE SIZE	24" HT, 12" SPR	NO	24" o.c.
	FIG	91	GREEN ISLAND FICUS	FICUS MICROCARPA 'GREEN ISLAND'	SEE SIZE	24" HT, 24" SPRD	NO	24" o.c.
	HAP2	835	FIREBUSH	HAMELIA PATENS	SEE SIZE	24" HT, 24" SPRD	YES	24" o.c.

SYMBOL	CODE	QTY	COMMON NAME	BOTANICAL NAME	CONT	SIZE	NATIVE
--------	------	-----	-------------	----------------	------	------	--------

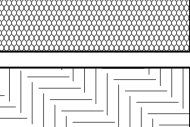
GROUND COVERS

	HED	594 SF	DUNE SUNFLOWER	HELIANTHUS DEBILIS	SEE SIZE	6" HT, 6" SPRD	YES
	ZAF	788	FLORIDA COONTIE	ZAMIA FLORIDANA	SEE SIZE	18" HT, 18" SPRD	YES

MULCH

	MUL	178 SF	MULCH	MULCH		MULCH	
-------------------------------------------------------------------------------------	-----	--------	-------	-------	--	-------	--

SOD

	SOD	104,955 SF	ST. AUGUSTINE GRASS	STENOTAPHRUM SECUNDATUM	SOD		
-------------------------------------------------------------------------------------	-----	------------	---------------------	-------------------------	-----	--	--

TREE MITIGATION

	CODE	QUANTITY	COMMON NAME	BOTANICAL NAME	DBH SIZE AT INSTALLATION	TOTAL DBH REPLACEMENT (IN)
TREES	TD	13	Bald Cypress	Taxodium distichum	5	65
	IC	41	Dahoon Holly	Ilex cassine	3	123
	CD	2	Green Buttonwood	Conocarpus erectus	3	6
	BS	5	Gumbo Limbo	Bursera simaruba	5	25
	QV	39	Live Oak 'Cathedral'	Quercus virginiana	8	312
	AG	24	Pond Apple	Annona glabra	3	72
PALMS	MR	4	Simpson's Stopper	Myricanthes fragrans	3	12
	PE	13	Alexander Palm	Ptychosperma elegans		
	PD	24	Date Palm	Phoenix dactylifera		
	SS-R	23	Cabbage Palm	Sabal palmetto		
TOTAL DBH PROPOSED						615
TOTAL DBH REMOVED						489
NET DIFFERENCE						126
TOTAL PALMS PROPOSED						60
TOTAL PALMS REMOVED						7
NET DIFFERENCE						53
TOTAL PALM GROUPINGS OF THREE						8
NOTES						
Sec. 4.6.16.(E)(6) - Palm species that do not have a mature spread of crown of at least 15 feet shall be grouped in threes, and three palms shall equal one shade tree.						

LANDSCAPE CALCULATIONS

CODE SECTION	CODE APPLICATION	REQUIRED	PROPOSED	EXISTING	TOTAL	COMMENTS
Section 4.6.16 (H)(4)(a)	Foundation landscaping shall be required. This shall incorporate trees, shrubs and groundcovers with the minimum required specifications as set forth in 4.6.16(E). Multiple tiers of plant material should be utilized and thoughtfully designed to accomplish the goal of softening the building mass while adding vibrant color and textures.	12' to 25' Height, Spaced Per Table 2 Typical Foundation Trees and Spacing Requirements (LF of Foundation)	8 Palm Groupings (3 16' Palms per Grouping)		8 Palm Groupings (3 16' Palms per Grouping)	
SECTION 4.6.16(H)(3)(a)	A strip of land at least five feet in depth located between the off-street parking area or other vehicular use area and the right-of-way. A hedge, wall or other durable landscape area shall be placed along the interior perimeter of the landscape strip.	1 Tree/30LF + Continuous Hedge or Wall (LF of Screening)	47 Trees + Continuous Hedge	4 Trees	51 Trees + Continuous Hedge	
SECTION 4.6.16(H)(3)(e)	Where any commercial or industrial areas about a residential zoning district or properties in residential use, in addition to requirements established for district boundary line separators in the zoning code, one tree shall be planted every 25 feet to form a solid tree line.	SW 7TH ST : 27 Trees	17 Trees	3 Trees	20 Trees	Site constraints
		SW 6TH ST : 6 Trees	5 Trees		5 Trees	Site constraints
		SW 4TH AVE : 20 Trees	20 Trees		20 Trees	

NATIVE PLANT MATERIAL CALCULATIONS

	CODE	QUANTITY	COMMON NAME	NATIVE TOTAL	NON-NATIVE TOTAL	DROUGHT TOLERANCE
TREES						
	TD	13	Bald Cypress	13		High
	IC	41	Dahoon Holly	41		Moderate
	CD	2	Green Buttonwood	2		High
	BS	5	Gumbo Limbo	5		High
	QV	39	Live Oak 'Cathedral'	39		High
	AG	24	Pond Apple	24		Low
	MR	4	Simpson's Stopper	4		High
	PE	13	Alexander Palm		13	High
	PD	24	Date Palm		24	High
	SS-R	23	Cabbage Palm	23		High
PERCENT NATIVE (50% REQUIRED)				80%		
SHRUBS & GROUND COVERS						
	COA	22	Auntie Lou Ti Plant		22	Low
	VIB	564	Evergreen Sweet Viburnum		564	Moderate
	COM	52	Mammy Croton		52	Low
	CHR	382	Red Tip Coco Plum	382		Moderate
	HAP2	835	Firebush	835		Moderate
	DUE	109	Gold Mound Duranta		109	High
	FIG	91	Green Island Ficus		91	High
	HED	594	Dune Sunflower	594		High
	ZAF	788	Florida Coontie	788		High
PERCENT NATIVE (25% REQUIRED)				76%		
TOTAL NATIVE TREES				151		
TOTAL NON-NATIVE TREES				37		
TOTAL NATIVE SHRUBS				2,599		
TOTAL NON-NATIVE SHRUBS				838		

REV. NO.	DATE	DRWN	CHKD	REMARKS

DESIGNED BY: _____	AF / BB
DRAWN BY: _____	AF / BB
SHEET CHK'D BY: _____	EH
CROSS CHK'D BY: _____	JG
APPROVED BY: _____	EH
DATE: _____	AUGUST 2025

CDM Smith

621 N.W. 53rd St., Suite 265
Boca Raton, FL 33487
Tel: (561) 571-3800



DELRAY BEACH, FLORIDA

DELRAY BEACH

MEMBRANE WATER TREATMENT PLANT

LANDSCAPE CALCULATIONS

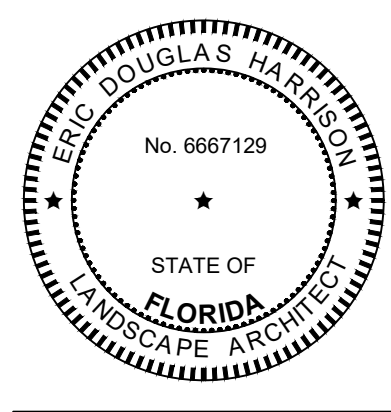

DATE: ERIC HARRISON LA NO. 6667129
PROJECT NO. 159676-291242 FILE NAME: L-10.DWG
SHEET NO. L-10

XREFs: [CDMS_2234] Images: []
Last saved by: MILLERZA Time: 10/16/2024 5:01:30 PM
C:\Users\millerza\Documents\CDM Smith Inc\Delray Membrane WTP\Project Files\Design\02 Civil\10 CADD\007LSP.dwg
© 2025 CDM SMITH ALL RIGHTS RESERVED.
REUSE OF DOCUMENTS: THESE DOCUMENTS AND DESIGNS PROVIDED BY PROFESSIONAL SERVICE, INCORPORATED HEREIN, ARE THE PROPERTY OF CDM SMITH AND ARE NOT TO BE USED, IN WHOLE OR PART, FOR ANY OTHER PROJECT WITHOUT THE WRITTEN AUTHORIZATION OF CDM SMITH.

CALIPER MEASUREMENTS NOTES:

- CALIPER MEASUREMENT IS 6" FROM TOP OF ROOT BALL FOR TREES WITH 6" CALIPER OR LESS.
- CALIPER MEASUREMENT IS 12" FROM TOP OF ROOT BALL FOR TREES WITH 6" CALIPER GREATER.

REFER TO PLANT SCHEDULE FOR INDIVIDUAL SIZES.

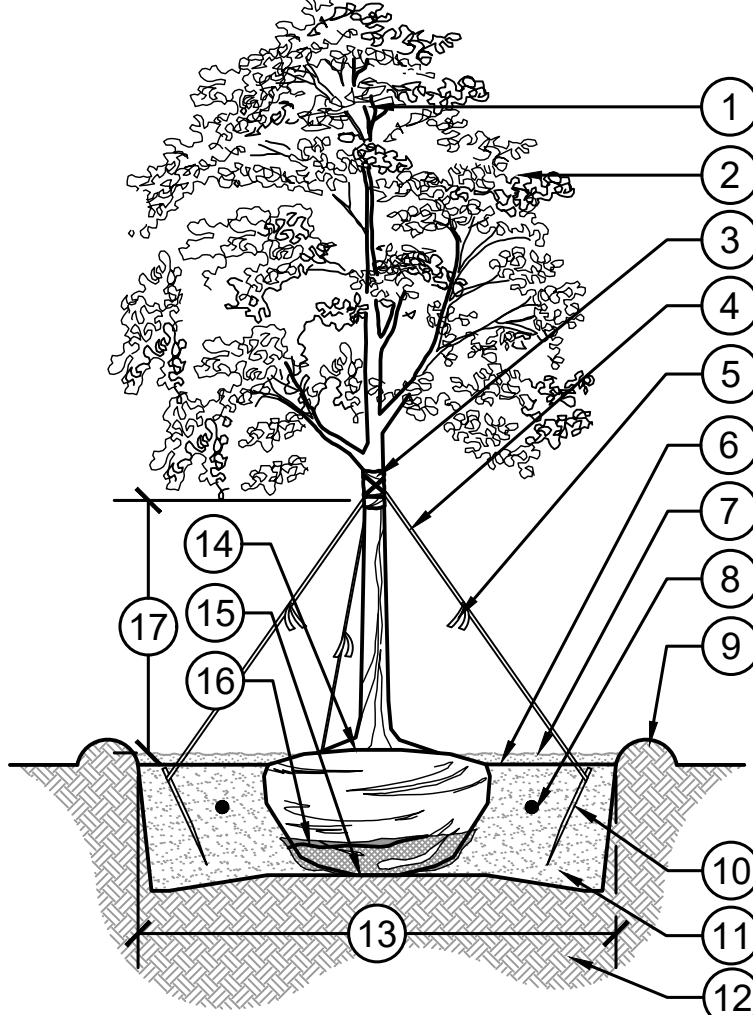

- DO NOT PRUNE CENTRAL LEADER
- PRUNE DAMAGED OR DEAD WOOD IMMEDIATELY PRIOR TO PLANTING USING ACCEPTABLE NURSERY PRACTICES OR AS DIRECTED BY THE LANDSCAPE ARCHITECT
- PROTECT TRUNK WITH 3 LAYERS OF BURLAP MINIMUM
- 1" WIDE MIN. NYLON STRAPPING AT EQUAL SPACING (3 PER TREE) GUY WIRES SHALL NOT TO BE USED
- FLUORESCENT MARKING FLAG
- FINISH GRADE
- 3" LAYER OF SPECIFIED MULCH: DO NOT INSTALL WITHIN 3" OF TREE TRUNK
- FERTILIZER TABLET IF APPLICABLE
- CONSTRUCT TEMPORARY 3" WATERING BASIN
- 2"x4"x8" STAKE: SET 2' BELOW FINISH GRADE
- SPECIFIED SOIL MIX
- EXISTING SOIL
- 2X DIAMETER OF THE ROOTBALL
- SET CROWN OF ROOT BALL SLIGHTLY ABOVE SURROUNDING FINISH GRADE. REMOVE TOP 2/3 OF BURLAP FROM ROOTBALL. TRUNK TAPER SHALL BE VISIBLE AT TIME OF INSTALLATION
- SET ROOTBALL ON UNDISTURBED SOIL
- REMOVE TOP 2/3 OF BURLAP/WIRE BASKET FROM ROOTBALL
- CLEAR TRUNK: REFER TO PLANT SCHEDULE

1 LARGE TREE PLANTING: 2" CALIPER AND GREATER

1/4" = 1'-0"

329301-17

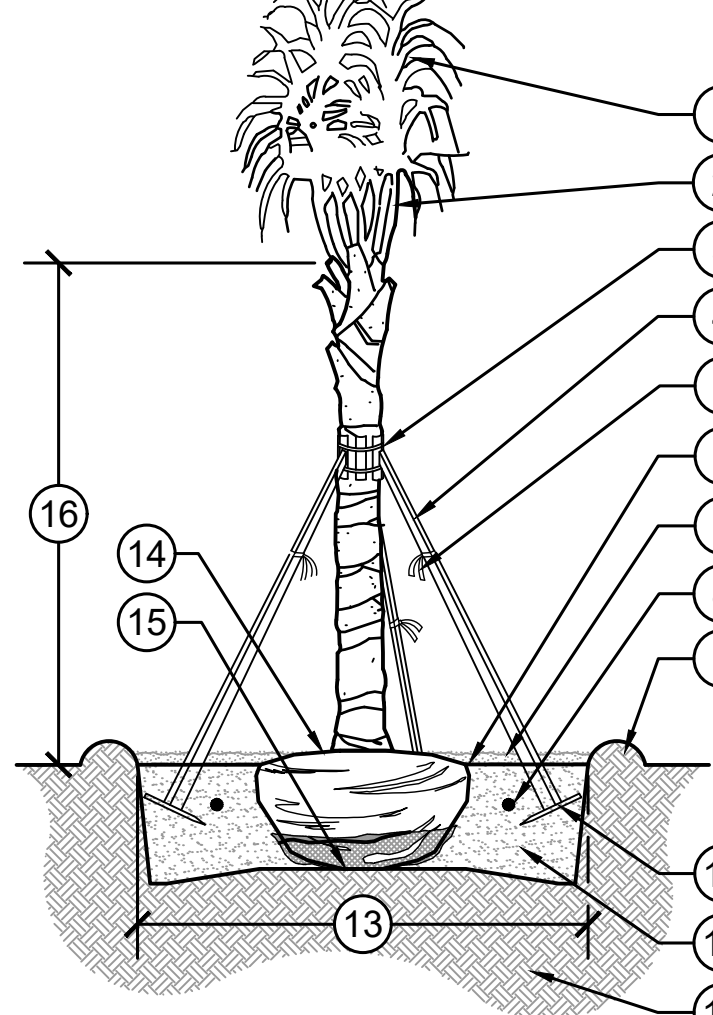

- DO NOT HURRICANE CUT FRONDS
- UNTIE FRONDS PRIOR TO INSPECTION
- METAL STRAPS SECURING 2"x4" WOOD BATTENS, MIN. 5 LAYERS BURLAP, TOE NAIL BRACES TO 2"x4" WOOD BATTENS: DO NOT NAIL STAKES DIRECTLY TO TRUNK
- 2"x4" WOOD BRACE AT EQUAL SPACING (3 PER TREE)
- 1/2"x2' FLUORESCENT MARKER
- FINISH GRADE
- 3" LAYER OF SPECIFIED MULCH: DO NOT INSTALL WITHIN 3" OF TREE TRUNK
- FERTILIZER TABLET IF APPLICABLE
- CONSTRUCT TEMPORARY 3" WATERING BASIN
- 2"x4"x8" STAKE: SET 2' BELOW FINISH GRADE
- BACKFILL WITH SPECIFIED SOIL MIX
- EXISTING SOIL
- 2X DIAMETER OF THE ROOTBALL
- SET CROWN OF ROOT BALL 0'-2" ABOVE SURROUNDING FINISH GRADE. REMOVE TOP 2/3 OF BURLAP FROM ROOTBALL: TRUNK TAPER SHALL BE VISIBLE AT TIME OF INSTALLATION
- SET ROOTBALL ON UNDISTURBED SOIL
- CLEAR TRUNK: REFER TO PLANT SCHEDULE

2 SABAL PALM PLANTING

1/4" = 1'-0"

329343-21

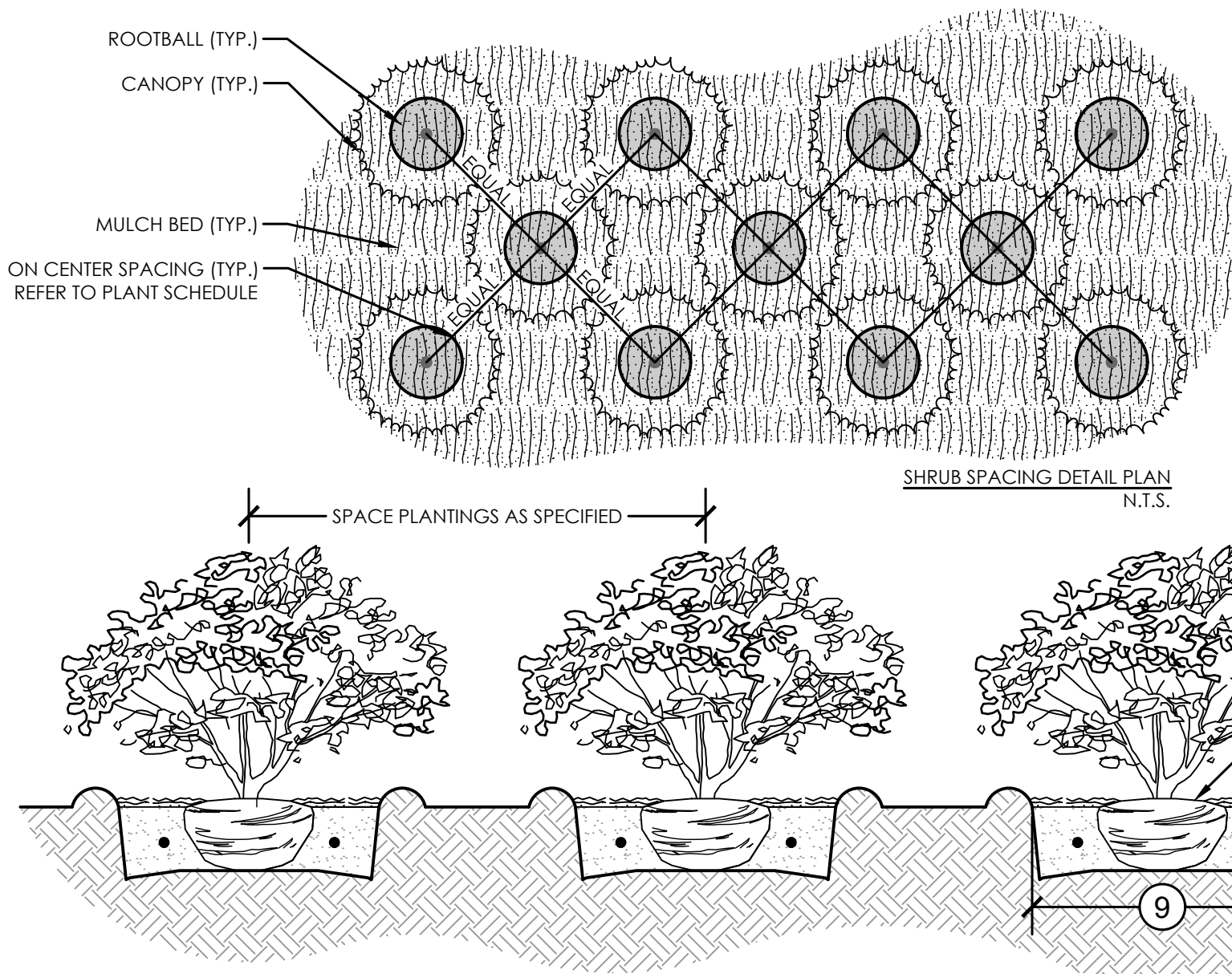

3 SHRUB/GROUND COVER PLANTING & SPACING

1" = 1'-0"

329301-08

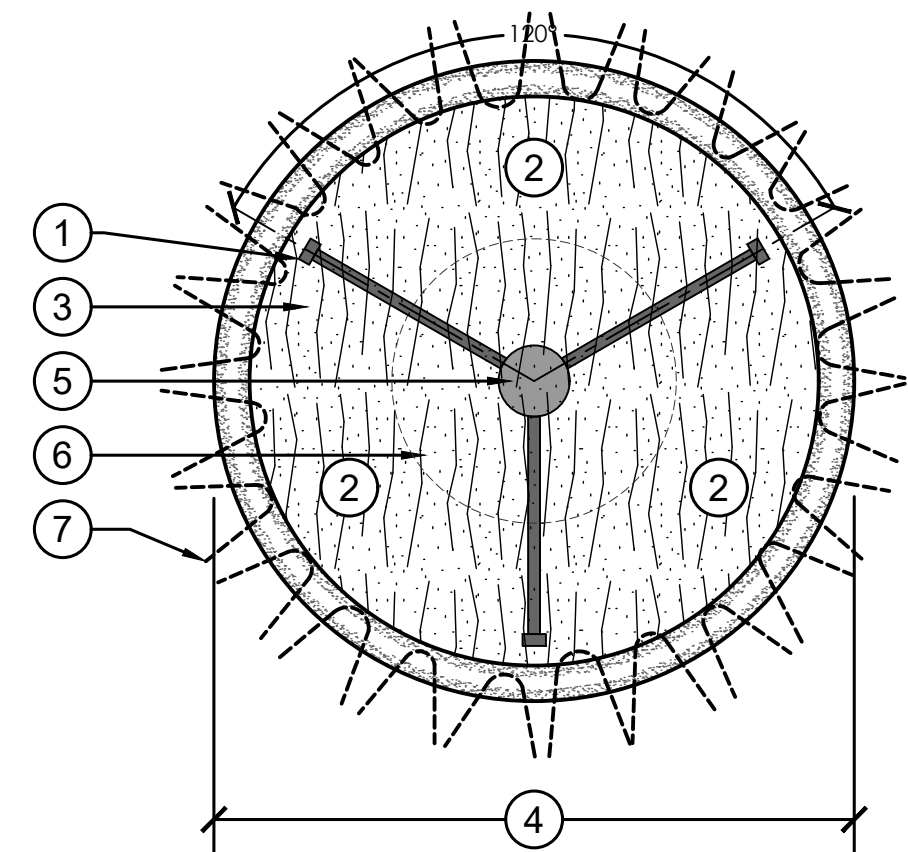

- 2"x4" WOOD BRACE AT EQUAL SPACING (3 PER TREE)
- 3" LAYER OF SPECIFIED MULCH: DO NOT INSTALL WITHIN 3" OF TREE TRUNK
- CONSTRUCT TEMPORARY 3" WATERING BASIN
- 2X DIAMETER OF THE ROOTBALL
- TREE TRUNK
- ROOTBALL
- TREE CANOPY

4 LARGE TREE STAKING DETAIL

3/8" = 1'-0"

329301-22

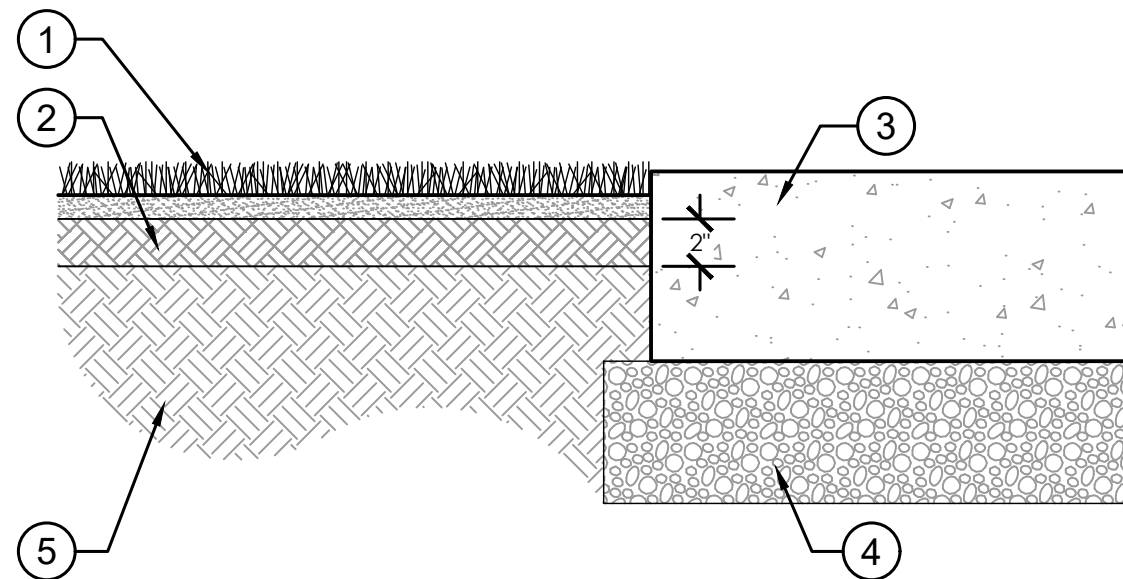

- SOD (AS SPECIFIED)
- PLANTING MIX: 80% SILICA SAND, 20% ORGANIC
- SIDEWALK OR CURB
- SUB-BASE
- NATIVE SOIL

5 SOD PLANTING

1 1/2" = 1'-0"

329301-03

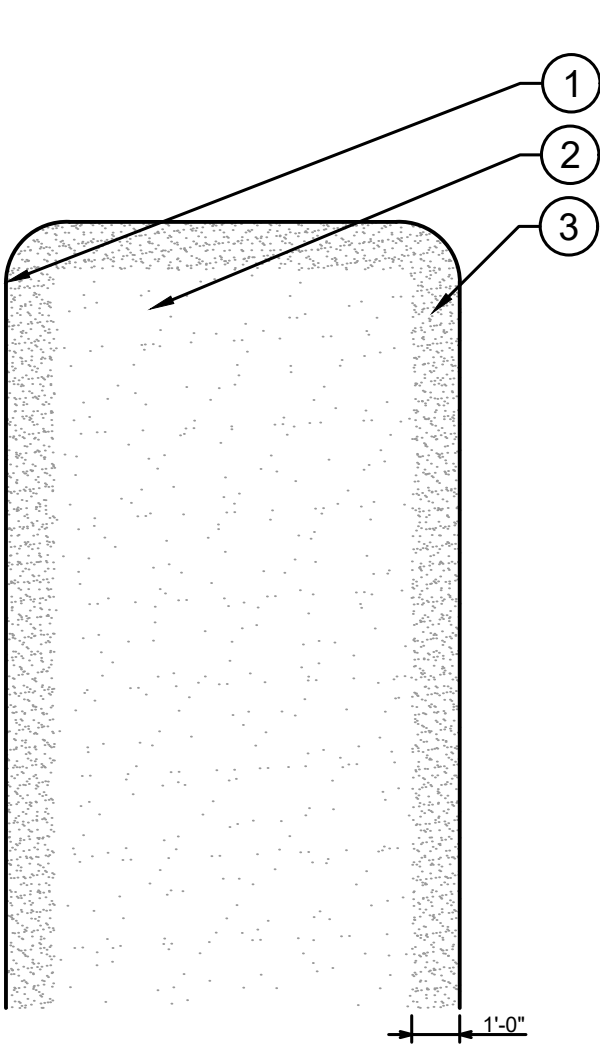

- BACK OF CURB (TYP)
- EXCAVATION AREA (30" DEPTH)
- COMPACTED SOIL (12" WIDTH)

NOTES:
ALL EXISTING SOIL WITHIN LANDSCAPE AREAS ADJACENT TO VEHICULAR USE AREAS IS REQUIRED TO BE REMOVED (TO 30" BELOW GRADE), INSPECTED TO ENSURE PROPER EXCAVATION DEPTH IS MET, AND THEN REPLACED WITH A TOPSOIL MIX AS NEEDED IN SPECIFICATIONS. TOPSOIL MIX SHALL BE SCREENED OF ROCK.

ALL PROPERTIES ARE REQUIRED TO HAVE AN OPEN BED INSPECTION PRIOR TO BACKFILLING TO INSURE THE 30" DEPTH HAS BEEN MET.

6 TYPICAL PARKING ISLAND EXCAVATION DETAIL

1/4" = 1'-0"

P-DE-07

FOR BUILDING DEPARTMENT USE

- PLANT MATERIAL SHALL NOT BE PRUNED PRIOR TO INSTALLATION: AFTER PLANTS HAVE BEEN INSTALLED, EACH PLANT SHALL BE PRUNED FOR UNIFORMITY
- SET CROWN OF ROOT SLIGHTLY ABOVE SURROUNDING FINISH GRADE: TRUNK TAPER SHALL BE VISIBLE AT TIME OF INSTALLATION
- 3" LAYER OF SPECIFIED MULCH: DO NOT INSTALL WITHIN 3" OF TREE TRUNK
- CONSTRUCT TEMPORARY 3" WATERING BASIN
- FINISH GRADE
- FERTILIZER TABLET IF APPLICABLE.
- BACKFILL WITH SPECIFIED SOIL MIX
- EXISTING SOIL
- 2X DIAMETER OF THE ROOTBALL

FOR DEVELOPMENT SERVICES USE

THIS ITEM HAS BEEN DIGITALLY SIGNED BY:
ERIC D. HARRISON,
RLA ON THE DATE ADJACENT TO THE SEAL.
PRINTED COPIES OF THIS DOCUMENT ARE NOT CONSIDERED SIGNED AND SEALED AND THE SIGNATURE MUST BE VERIFIED ON ANY ELECTRONIC COPIES.

THE NAMED LICENSE LANDSCAPE ARCHITECT SHALL BE RESPONSIBLE FOR THIS SHEET IN ACCORDANCE WITH RULE 61G10-11.011, F.A.C.

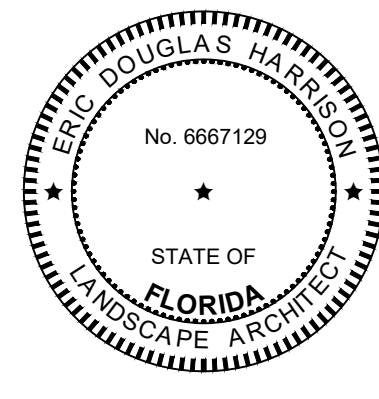

DATE:
ERIC HARRISON
LA NO. 6667129

PROJECT NO. 159676-291242
FILE NAME: L-11.DWG

SHEET NO.

L-11

ISSUED FOR PERMITTING



500 Australian Avenue South
Suite 850
West Palm Beach, FL 33401
561.746.6900
www.chenmoore.com



DELRAY BEACH, FLORIDA

DELRAY BEACH
MEMBRANE WATER TREATMENT PLANT

LANDSCAPE DETAILS I

REV. NO.	DATE	DRWN	CHKD	REMARKS

DESIGNED BY:	AF/BB
DRAWN BY:	AF/BB
SHEET CHK'D BY:	EH
CROSS CHK'D BY:	JG
APPROVED BY:	EH
DATE:	AUGUST 2025

XREFs: [CDMS_2234] Images: []
Last saved by: MILLERZA Time: 10/16/2024 5:01:30 PM
C:\Users\millerza\Documents\CDM Smith Inc\Delray Membrane WTP\Project Files\Design\02 Civil\10 CADD\LO07LSP.dwg
©2025 CDM SMITH ALL RIGHTS RESERVED.
REUSE OF DOCUMENTS: THESE DOCUMENTS AND DESIGNS PROVIDED BY PROFESSIONAL SERVICE, INCORPORATED HEREIN, ARE THE PROPERTY OF CDM SMITH AND ARE NOT TO BE USED, IN WHOLE OR PART, FOR ANY OTHER PROJECT WITHOUT THE WRITTEN AUTHORIZATION OF CDM SMITH.

1 PLANTINGS ADJACENT TO BUILDINGS
1 1/2" = 1'-0" P-DE-08

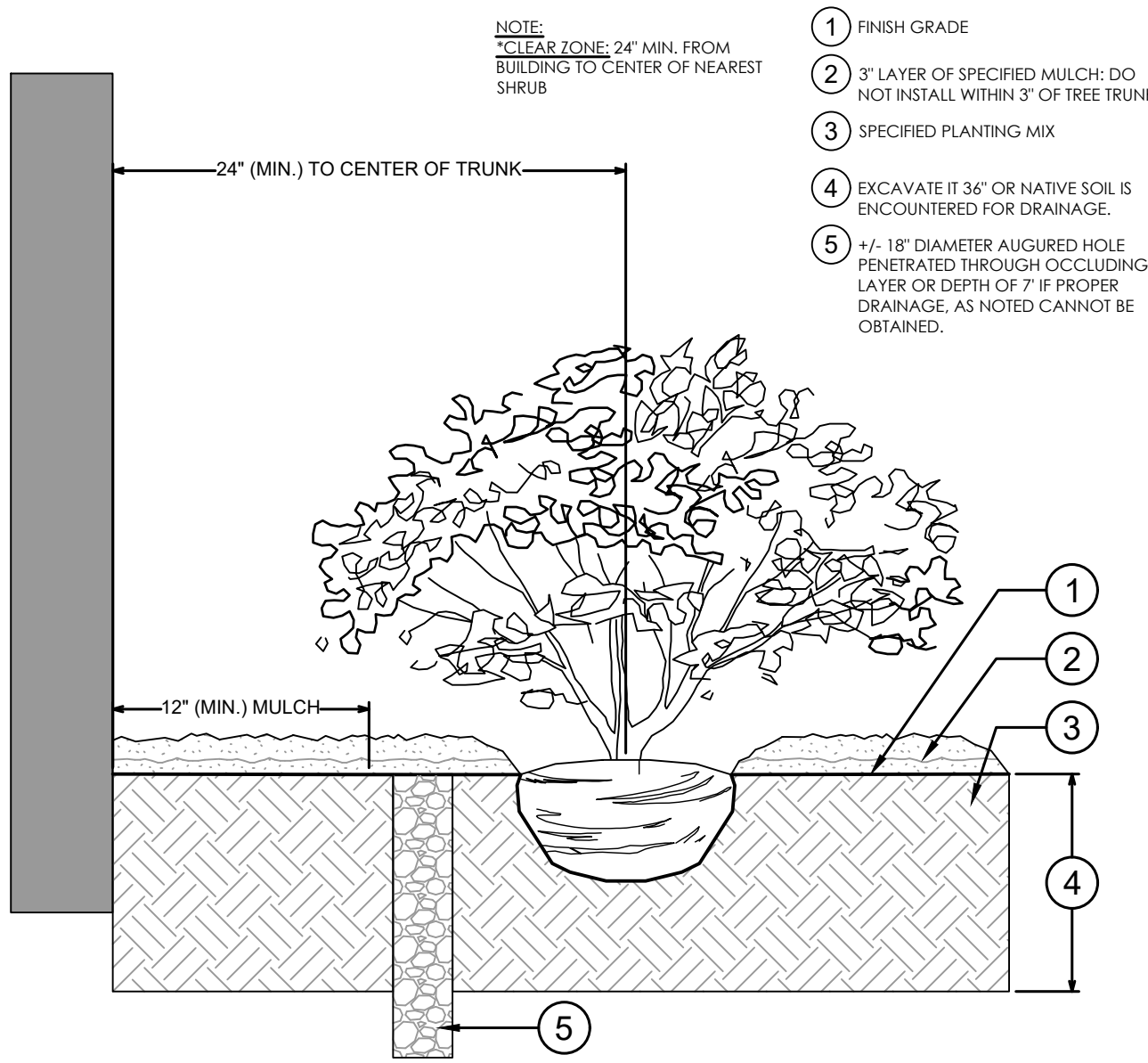

2 POOR DRAINAGE CONDITION
1/2" = 1'-0" P-DE-04

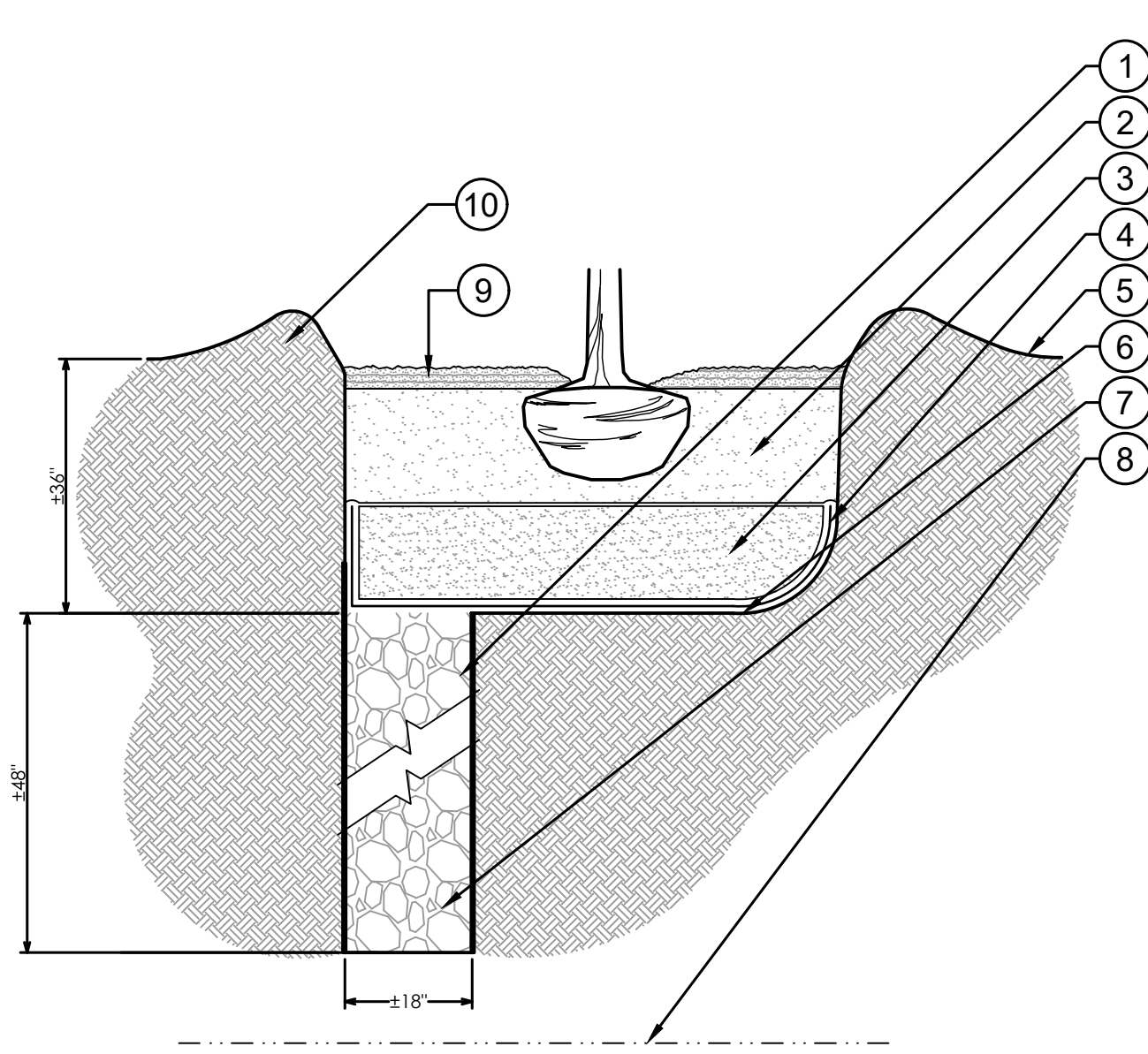

3 FIRE HYDRANT CLEAR ZONE
1/4" = 1'-0" P-DE-02

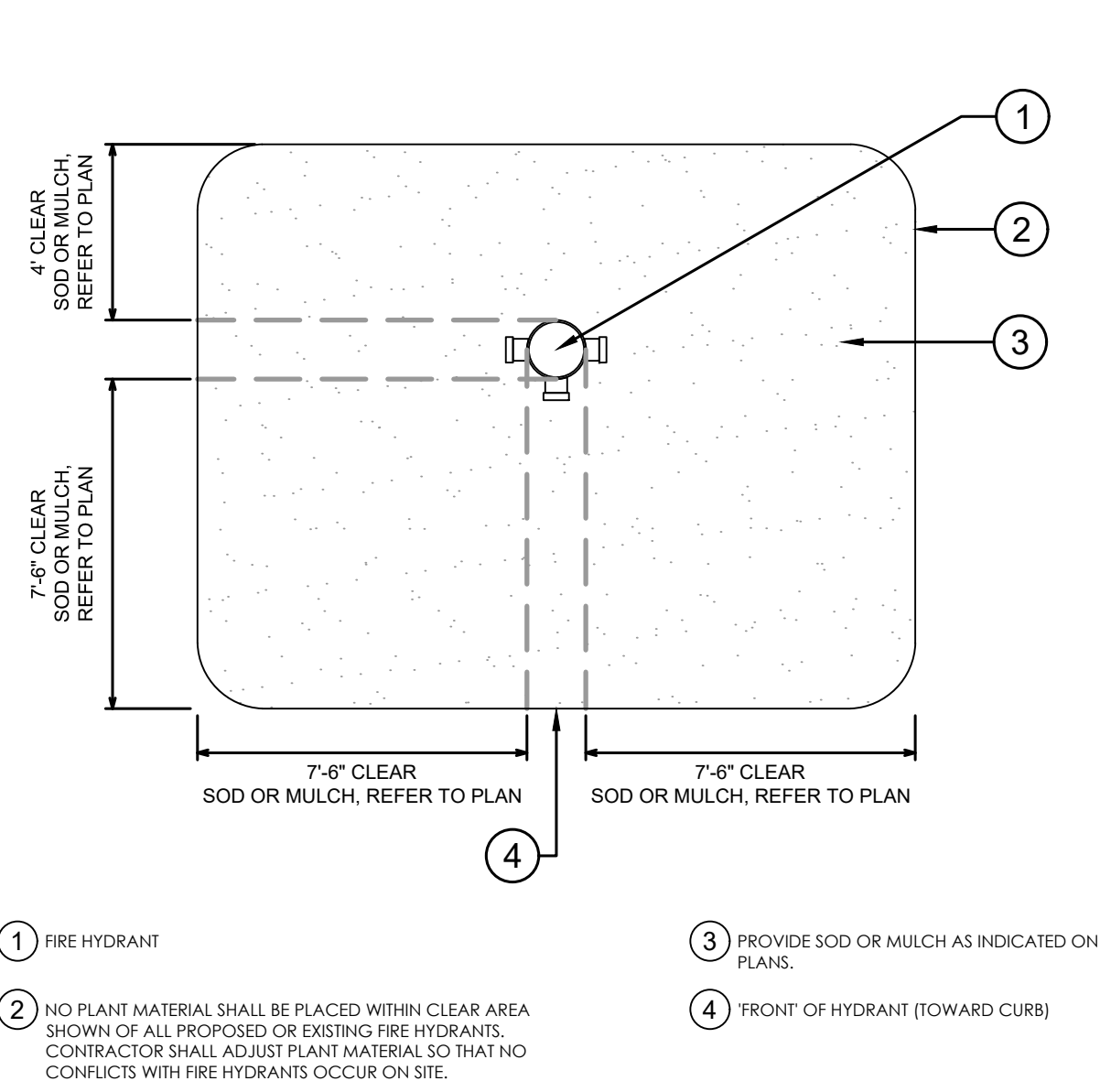

4 PARKING SPACE/ CURB PLANTING
1/2" = 1'-0" P-DE-09

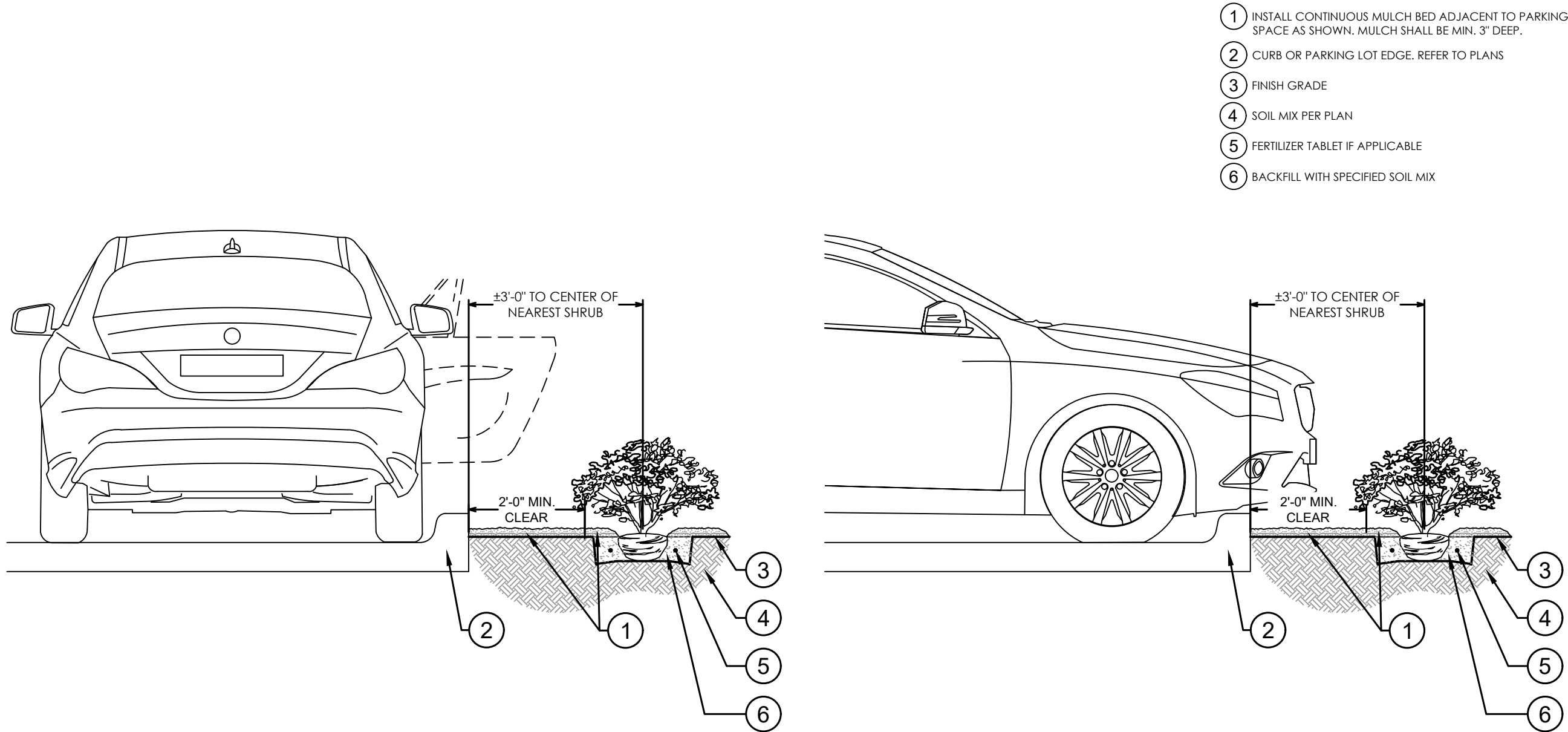

REV. NO.	DATE	DRWN	CHKD	REMARKS

DESIGNED BY:	AF/BB
DRAWN BY:	AF/BB
SHEET CHK'D BY:	EH
CROSS CHK'D BY:	JG
APPROVED BY:	EH
DATE:	AUGUST 2025

CDM Smith
621 N.W. 53rd St., Suite 265
Boca Raton, FL 33487
Tel: (561) 571-3800



cma
chen moore and associates

500 Australian Avenue South
Suite 850
West Palm Beach, FL 33401
561.746.6900
www.chenmoore.com

DELRAY BEACH, FLORIDA
DELRAY BEACH
MEMBRANE WATER TREATMENT PLANT

LANDSCAPE DETAILS II

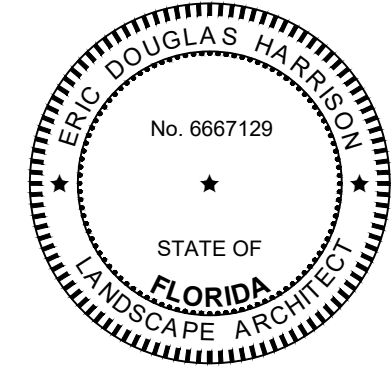

DATE:
ERIC HARRISON
LA NO. 6667129

PROJECT NO. 159676-291242
FILE NAME: L-12.DWG

SHEET NO.
L-12

ISSUED FOR PERMITTING

XREFs: [CDMS_2234] Images: []
Last saved by: MILLERZA Time: 10/16/2024 5:01:30 PM
C:\Users\millerza\Documents\CDM Smith Inc\Delray Membrane WTP\Project Files\Design\02 Civil\10 CADD\007LSP.dwg
©2025 CDM SMITH ALL RIGHTS RESERVED.
REUSE OF DOCUMENTS: THESE DOCUMENTS AND DESIGNS PROVIDED BY PROFESSIONAL SERVICE, INCORPORATED HEREIN, ARE THE PROPERTY OF CDM SMITH AND ARE NOT TO BE USED, IN WHOLE OR PART, FOR ANY OTHER PROJECT WITHOUT THE WRITTEN AUTHORIZATION OF CDM SMITH.

1 TYPICAL TREE WITHOUT ROOT BARRIER

1/4" = 1'-0"

P-DE-05

2 MOUNDED PARKING LOT ISLANDS/ MEDIANS

3/4" = 1'-0"

P-DE-03

CALIPER MEASUREMENTS NOTES:
1. CALIPER MEASUREMENT IS 6" FROM TOP OF ROOT BALL FOR TREES WITH 6" CALIPER OR LESS.
2. CALIPER MEASUREMENT IS 12" FROM TOP OF ROOT BALL FOR TREES WITH 6" CALIPER GREATER.

REFER TO PLANT SCHEDULE FOR INDIVIDUAL SIZES.

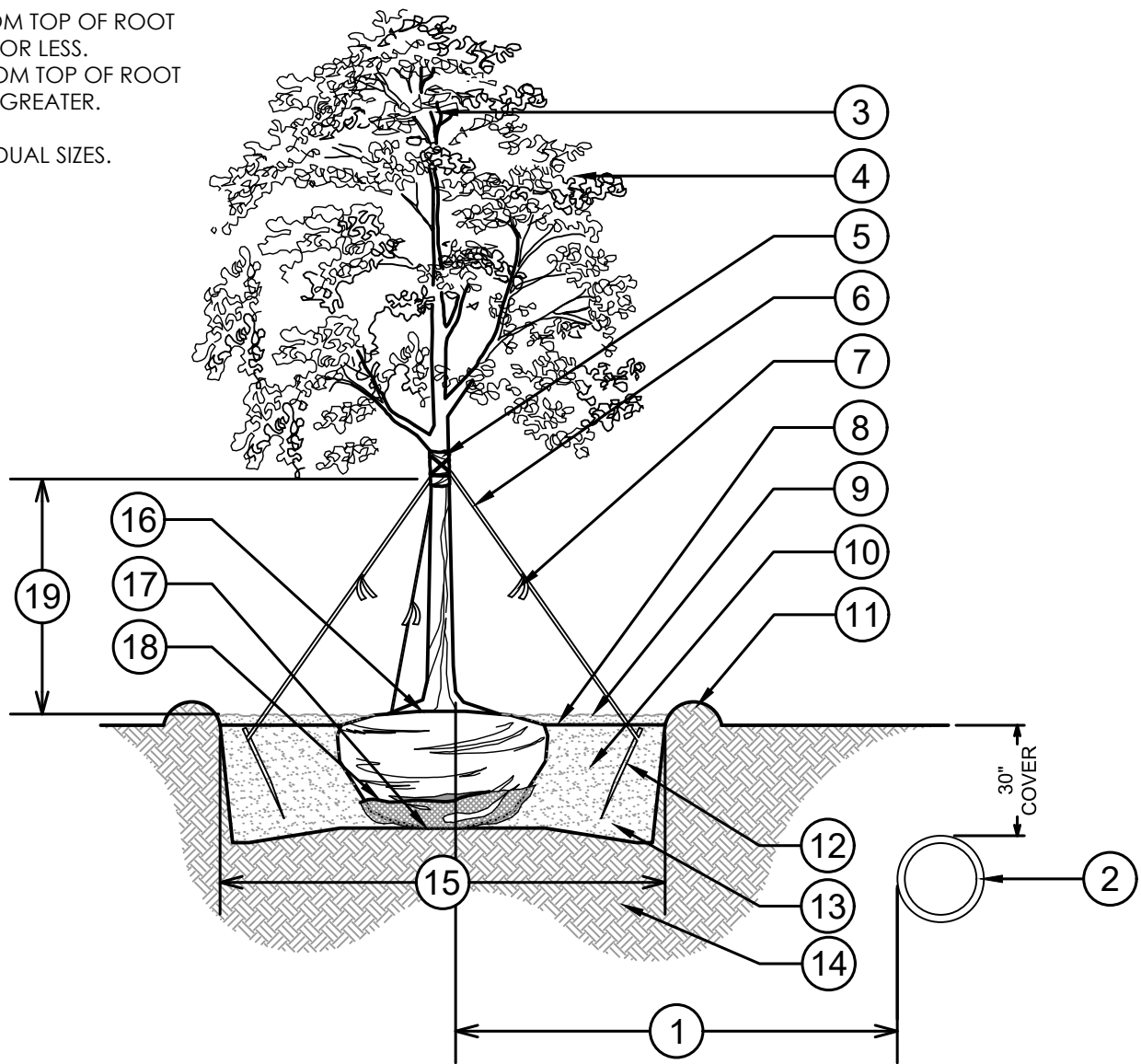

- 1 THE DISTANCE SHALL BE 10' MIN. FROM ALL CITY FACILITIES IF NO ROOT BARRIER IS USED
- 2 CITY FACILITIES (MAINS, SERVICES, ETC.)
- 3 DO NOT PRUNE CENTRAL LEADER
- 4 PRUNE DAMAGED OR DEAD WOOD IMMEDIATELY PRIOR TO PLANTING USING ACCEPTABLE NURSERY PRACTICES OR AS DIRECTED BY THE LANDSCAPE ARCHITECT
- 5 PROTECT TRUNK WITH 3 LAYERS OF BURLAP MINIMUM
- 6 1" WIDE MIN. NYLON STRAPPING AT EQUAL SPACING (3 PER TREE) GUY WIRES SHALL NOT TO BE USED
- 7 FLUORESCENT MARKING FLAG
- 8 FINISH GRADE
- 9 3" LAYER OF SPECIFIED MULCH: DO NOT INSTALL WITHIN 3" OF TREE TRUNK
- 10 FERTILIZER TABLET IF APPLICABLE
- 11 CONSTRUCT TEMPORARY 3" WATERING BASIN
- 12 2"x4"x8" STAKE: SET 2" BELOW FINISH GRADE
- 13 SPECIFIED SOIL MIX
- 14 EXISTING SOIL
- 15 2X DIAMETER OF THE ROOTBALL
- 16 SET CROWN OF ROOT BALL SLIGHTLY ABOVE SURROUNDING FINISH GRADE. REMOVE TOP 2/3 OF BURLAP FROM ROOTBALL. TRUNK TAPER SHALL BE VISIBLE AT TIME OF INSTALLATION
- 17 SET ROOTBALL ON UNDISTURBED SOIL
- 18 REMOVE TOP 2/3 OF BURLAP/WIRE BASKET FROM ROOTBALL
- 19 CLEAR TRUNK: REFER TO PLANT SCHEDULE

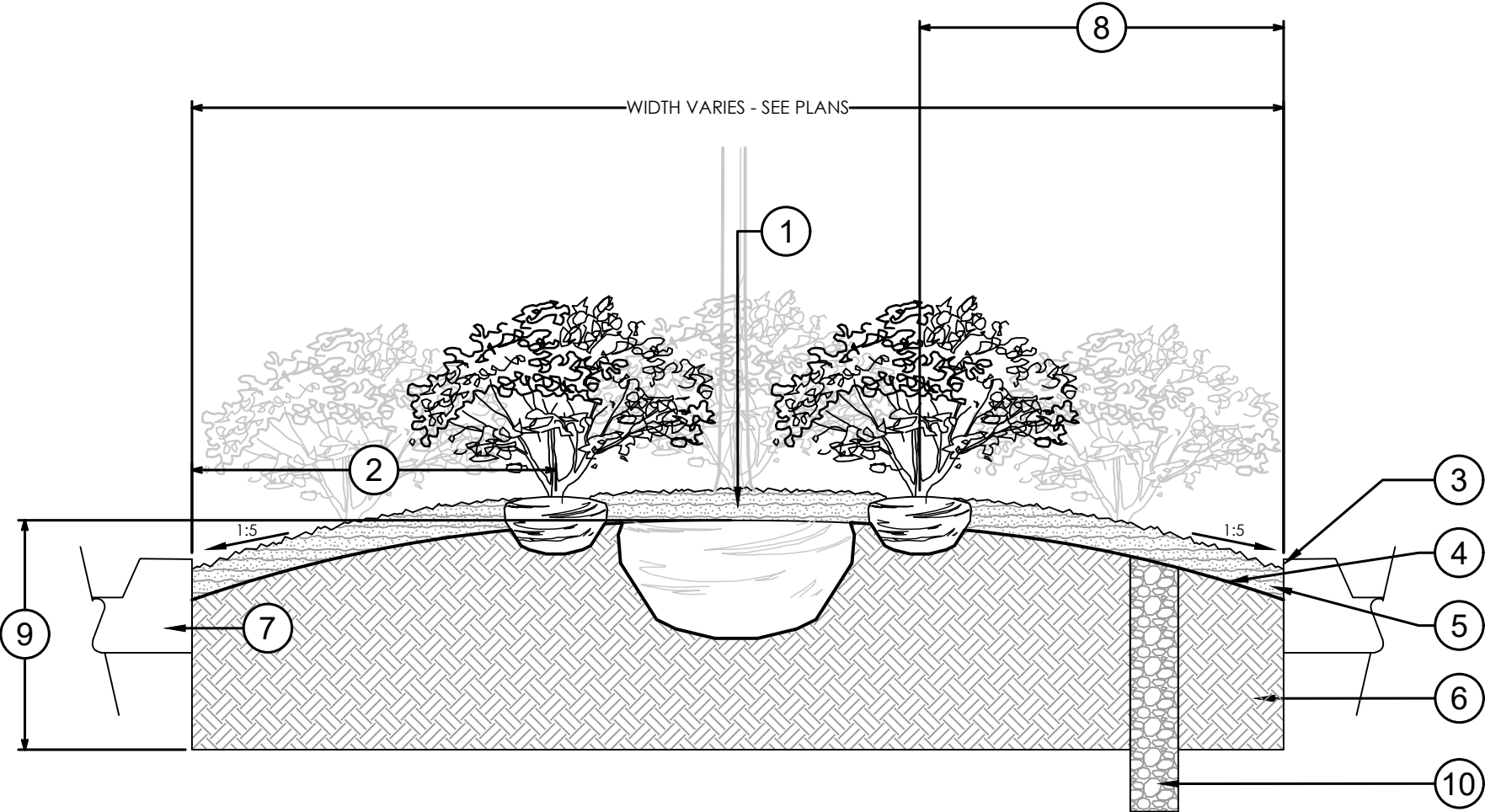

- 1 CROWN ISLANDS AT 5:1 SLOPES (OR AS SPECIFIED ON THE LANDSCAPE PLANS).
- 2 CLEAR ZONE SHALL CONTAIN 3" CONTINUOUS MULCH OR TURF. SEE PLANS. SEE DETAIL "PARKING SPACE/ CURB PLANTING" FOR PLANTER MEDIANS ADJACENT TO PARKING SPACES.
- 3 1" MIN. VERTICAL CLEARANCE, TOP OF CURB TO TOP OF MULCH. EXCAVATE CONTINUOUS 36" DEEP (FROM TOP OF CURB) FOR ENTIRE LENGTH AND WIDTH OF ISLAND AND BACKFILL WITH APPROVED PLANTING MIX.
 - PROTECT AND RETAIN ALL CURBS AND BASE. COMPACTED SUBGRADE TO REMAIN FOR STRUCTURAL SUPPORT OF CURB SYSTEM (TYP).
 - ALL ISLANDS SHALL UTILIZE POOR DRAINAGE DETAIL WHEN PERCOLATION RATES ARE 2" PER HOUR OR LESS.
- 4 FINISH GRADE
- 5 3" LAYER OF SPECIFIED MULCH: DO NOT INSTALL WITHIN 3" OF TREE TRUNK
- 6 SPECIFIED PLANTING MIX
- 7 CURB. REFER TO PLANS
- 8 INSTALL HALF THE DISTANCE OF SPECIFIED SIZE. REFER TO PLANT SCHEDULE UNLESS OTHERWISE NOTED.
- 9 EXCAVATE IF 36" OR NATIVE SOIL IS ENCOUNTERED FOR DRAINAGE.
- 10 +/- 18" DIAMETER AUGURED HOLE PENETRATED THROUGH OCCLUDING LAYER OR DEPTH OF 7" IF PROPER DRAINAGE, AS NOTED CANNOT BE OBTAINED.

FOR BUILDING DEPARTMENT USE

FOR DEVELOPMENT SERVICES USE

THIS ITEM HAS BEEN DIGITALLY SIGNED BY:
ERIC D. HARRISON,
RLA ON THE DATE ADJACENT TO THE SEAL.
PRINTED COPIES OF THIS DOCUMENT ARE
NOT CONSIDERED SIGNED AND SEALED
AND THE SIGNATURE MUST BE VERIFIED ON
ANY ELECTRONIC COPIES.

THE NAMED LICENSE LANDSCAPE
ARCHITECT SHALL BE RESPONSIBLE FOR THIS
SHEET IN ACCORDANCE WITH RULE
61G10-11.011, F.A.C.

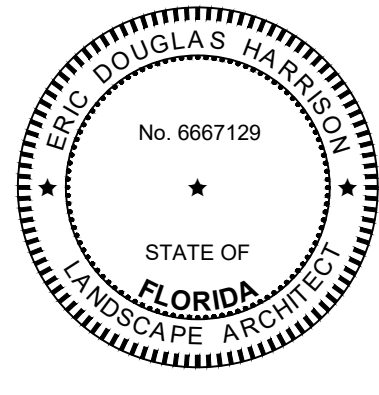

DATE:
ERIC HARRISON
LA NO. 6667129

PROJECT NO. 159676-291242
FILE NAME: L-13.DWG

SHEET NO.

L-13

ISSUED FOR PERMITTING



500 Australian Avenue South
Suite 850
West Palm Beach, FL 33401
561.746.6900
www.chenmoore.com



DELRAY BEACH, FLORIDA
DELRAY BEACH
MEMBRANE WATER TREATMENT PLANT

LANDSCAPE DETAILS III

REV. NO.	DATE	DRWN	CHKD	REMARKS

DESIGNED BY: AF/BB
DRAWN BY: AF/BB
SHEET CHK'D BY: EH
CROSS CHK'D BY: JG
APPROVED BY: EH
DATE: AUGUST 2025

XREFs: [CDMS_2234] Images: []
Last saved by: MILLERZA Time: 10/16/2024 5:23:40 PM
C:\Users\millerza\Documents\CDM Smith Inc\Delray Membrane WTP\Project Files\Design\02 Gw\10 CADD\LO08LSP.dwg
© 2025 CDM SMITH ALL RIGHTS RESERVED.
REUSE OF DOCUMENTS: THESE DOCUMENTS AND DESIGNS PROVIDED BY PROFESSIONAL SERVICE, INCORPORATED HEREIN, ARE THE PROPERTY OF CDM SMITH AND ARE NOT TO BE USED, IN WHOLE OR PART, FOR ANY OTHER PROJECT WITHOUT THE WRITTEN AUTHORIZATION OF CDM SMITH.

LANDSCAPE SPECIFICATIONS

1. GENERAL
- 1.1. WORK PERFORMED SHALL COMPLY WITH THE FOLLOWING:

1.1.1. THESE GENERAL NOTES, CONSTRUCTION DOCUMENTS AND SPECIFICATIONS.

1.1.2. ALL APPLICABLE LOCAL, STATE AND FEDERAL CODES, ORDINANCES AND REGULATIONS.
- 1.2. SOURCE OF BASE INFORMATION IS PROVIDED BY CDM SMITH AND IS ASSUMED TO BE CORRECT. IF SITE DISCREPANCIES ARE PRESENT, CONTRACTOR SHALL NOTIFY OWNER'S REPRESENTATIVE IMMEDIATELY. IF CONTRACTOR CONTINUES WORK WITHOUT THE PROPER NOTIFICATION, CONTRACTOR DOES SO AT HIS OWN RISK.
- 1.3. THE CONTRACTOR SHALL FURNISH ALL MATERIALS, LABOR, SUPERVISION, AND EQUIPMENT REQUIRED FOR THE WORK AS SHOWN ON THE CONSTRUCTION DOCUMENTS DESCRIBED HEREIN.
- 1.4. CONTRACTOR SHALL BE RESPONSIBLE FOR ANY COORDINATION WITH SUB-CONTRACTORS AS REQUIRED TO COMPLETE THE WORK OF THIS PROJECT.
- 1.5. CONTRACTOR SHALL VERIFY LOCATIONS OF PERTINENT SITE IMPROVEMENTS INSTALLED UNDER OTHER CONTRACTS. IF ANY PART OF THIS PLAN CANNOT BE FOLLOWED DUE TO SITE CONDITIONS, CONTACT OWNER'S REPRESENTATIVE FOR INSTRUCTIONS PRIOR TO COMMENCING WORK.
- 1.6. CONTRACTOR TO NOTIFY "SUNSHINE STATE ONE CALL OF FLORIDA, INC." AT 1-800-432-4770 TWO FULL BUSINESS DAYS PRIOR TO DIGGING FOR UNDERGROUND UTILITY LOCATIONS.
- 1.7. CONTRACTOR IS RESPONSIBLE FOR DETERMINING ALL UTILITY LOCATIONS AND INSTALLING FACILITIES SO AS TO NOT CONFLICT. THE LOCATION OF EXISTING UTILITIES OR SITE FEATURES AS SHOWN ON THE PLANS MAY VARY IN RELATION TO ACTUAL EXISTING CONDITIONS. ANY DIFFERING SITE CONDITIONS FROM THAT WHICH IS REPRESENTED HEREON, WHETHER ABOVE, ON OR BELOW THE SURFACE OF THE GROUND, SHOULD BE BROUGHT TO THE IMMEDIATE ATTENTION OF THE LANDSCAPE ARCHITECT AND THE OWNER IN WRITING. NO CLAIM FOR EXPENSES INCURRED BY THE CONTRACTOR DUE TO DIFFERING SITE CONDITIONS WILL BE ALLOWED IF THE CONTRACTOR FAILS TO PROVIDE THE REQUIRED WRITTEN NOTIFICATION OF SUCH CONDITIONS FOR REVIEW BY THE LANDSCAPE ARCHITECT AND THE OWNER.
- 1.8. CONTRACTOR SHALL NOTIFY ALL APPROPRIATE UTILITY COMPANIES OF PROPOSED START OF WORK IN ACCORDANCE WITH THEIR STANDARD REQUIREMENTS, INCLUDING BUT NOT LIMITED TO, WATER, SANITARY SEWER, POWER, NATURAL GAS, TELEPHONE AND CABLE TV COMPANIES.
- 1.9. IT SHALL BE THE CONTRACTOR'S SOLE RESPONSIBILITY TO TAKE THE NECESSARY PRECAUTIONS TO ENSURE PROPER SAFETY AND WORKMANSHIP WHEN WORKING IN THE VICINITY OF EXISTING UTILITY LINES.
- 1.10. PERFORM EXCAVATION IN THE VICINITY OF UNDERGROUND UTILITIES WITH CARE AND BY HAND, IF NECESSARY. THE CONTRACTOR BEARS FULL RESPONSIBILITY FOR THIS WORK AND DISRUPTION OF DAMAGE TO UTILITIES SHALL BE REPAIRED IMMEDIATELY AND AT NO EXPENSE TO THE OWNER.
- 1.11. THE SUCCESSFUL BIDDER SHALL FURNISH TO THE OWNER A UNIT PRICE BREAKDOWN FOR ALL MATERIALS. THE OWNER MAY, AT ITS DISCRETION, ADD OR DELETE FROM THE MATERIALS UTILIZING THE UNIT PRICE BREAKDOWN SUBMITTED.
- 1.12. IT IS THE RESPONSIBILITY OF THE CONTRACTOR TO ENSURE THAT ALL REQUIRED PERMITS ARE OBTAINED AND ARE IN HAND AT THE JOB SITE PRIOR TO THE COMMENCEMENT OF CONSTRUCTION. CONTRACTOR SHALL ABIDE BY ALL PERMIT CONDITIONS.
2. PRE-CONSTRUCTION RESPONSIBILITY
- 2.1. UPON RECEIPT OF NOTICE OF AWARD, THE CONTRACTOR SHALL ARRANGE A PRE-CONSTRUCTION CONFERENCE TO INCLUDE ALL INVOLVED GOVERNMENTAL AGENCIES, ALL AFFECTED UTILITY OWNERS, THE OWNER, THE LANDSCAPE ARCHITECT, ANY OTHER PERTINENT PARTIES AND HIMSELF.

2.2. CONTRACTOR SHALL PROVIDE TEMPORARY SANITARY FACILITIES ONSITE. LOCATION TO BE DETERMINED BY THE OWNER. JANITORIAL SERVICES SHALL BE PROVIDED BY CONTRACTOR THROUGHOUT THE DURATION OF PROJECT.

2.3. PRIOR TO BEGINNING CONSTRUCTION, THE CONTRACTOR SHALL VERIFY THE SIZE, LOCATION, ELEVATION, AND MATERIAL OF ALL EXISTING UTILITIES WITHIN THE AREA OF CONSTRUCTION.

2.4. IF UPON EXCAVATION, AN EXISTING UTILITY IS FOUND TO BE IN CONFLICT WITH THE PROPOSED CONSTRUCTION OR TO BE OF A SIZE OR MATERIAL DIFFERENT FROM THAT SHOWN ON THE PLANS; THE CONTRACTOR SHALL IMMEDIATELY NOTIFY THE LANDSCAPE ARCHITECT.

2.5. IT SHALL BE THE CONTRACTOR'S RESPONSIBILITY TO MAKE ARRANGEMENTS FOR THE FIELD LOCATIONS AND FOR ANY TREES PROPOSED FOR RELOCATION. THIS SHALL BE DONE IN A TIMELY MANNER TO MINIMIZE IMPACT ON CONSTRUCTION SCHEDULE. ANY DELAY CAUSED BY THE CONTRACTOR BY THE RELOCATION OF TREES SHALL BE INCIDENTAL TO THE CONTRACT AND NO EXTRA COMPENSATION WILL BE ALLOWED.

2.6. CONTRACTOR SHALL VERIFY LIMITS OF CONSTRUCTION AS NOTED ON THE PLANS. ANY WORK PERFORMED OUTSIDE OF THE AGREED UPON LIMITS OF CONSTRUCTION SHALL BE DONE AT THE EXPENSE OF THE CONTRACTOR.
3. SITE DEMOLITION
- 3.1. ITEMS SHALL REMAIN UNLESS OTHERWISE NOTED ON THE PLAN(S). REMOVE DESIGNATED ITEMS SHOWN ON THE PLAN TO THE FULL DEPTH OF THEIR CONSTRUCTION UNLESS OTHERWISE NOTED.

3.2. ALL HARDSCAPE DESIGNATED FOR REMOVAL SHALL BE SAW CUT, LEAVING UNIFORM EDGES TO THE GREATEST EXTENT POSSIBLE. MATERIAL EDGES TO REMAIN SHALL BE SHORED UP AND PROTECTED DURING CONSTRUCTION TO PRESERVE EDGE INTACT. REPAIRS TO DAMAGED EDGES SHALL BE REPAIRED BY CONTRACTOR AT NO ADDITIONAL COST TO THE OWNER.

3.3. NO EXISTING MATERIAL SHALL BE USED IN NEW CONSTRUCTION UNLESS NOTED ON THE PLANS OR APPROVED DURING THE SHOP DRAWING APPROVAL PROCESS.

3.4. SALVAGE EXISTING MATERIALS AS INDICATED ON THE PLANS. SALVAGED MATERIALS SHALL BE HANDLED WITH CARE AND STORED ON-SITE OR AS DIRECTED BY OWNER. CLEAN ALL DEBRIS AND CONSTRUCTION MATERIAL FROM SALVAGED ITEMS; REUSE AS DIRECTED BY OWNER'S

- REPRESENTATIVE.
- 3.5. REMOVE DEMOLISHED MATERIALS FROM SITE AND DISPOSE OF AS REQUIRED BY LOCAL, STATE OR FEDERAL LAWS.
- 3.6. CONTRACTOR SHALL PROTECT ADJACENT WATER BODIES, COASTAL DUNE SYSTEMS AND PROPERTIES FROM DAMAGE BY SEDIMENTATION OR OTHER POTENTIAL CONSTRUCTION RELATED CAUSES.
- 3.7. ALL IRRIGATION IN DEMOLITION AREA TO BE CAPPED AND ADJUSTED AS NECESSARY TO ENSURE OVERALL SYSTEM IS NOT AFFECTED.
4. PLANTING SOIL
- 4.1. ALL TREES SHALL BE PLANTED WITH A MINIMUM OF 12" TOPSOIL AROUND AND BENEATH THE ROOTBALL.

4.2. ALL TREES SHALL BE PLANTED WITH A MINIMUM OF 6" TOPSOIL AROUND AND BENEATH THE ROOTBALL.

4.3. MINIMUM TOPSOIL SHALL BE 2" FOR SODDED GRASS AREAS.

4.4. PLANTING SOIL MIX SHALL BE A WEED FREE MIX AS FOLLOWS:

4.4.1. DICOT TREES & SHRUBS: 50% SAND, 40% MUCK & 10% PEAT

4.4.2. MONOCOT PALMS: 70% SAND & 30% MUCK

4.4.3. TURF: 80% SAND, 10% PEAT & 10% MUCK
5. LANDSCAPE PLANTING
- 5.1. THIS PLAN HAS BEEN DESIGNED TO MEET OR EXCEED ALL APPLICABLE CODES.

5.2. THE PLANTING PLAN SHALL BE INSTALLED IN COMPLIANCE WITH ALL EXISTING CODES AND APPLICABLE DEED RESTRICTIONS.

5.3. PLANT MATERIAL: ALL PLANT MATERIAL SHALL BE FLORIDA #1 OR BETTER AS ESTABLISHED BY "GRADES AND STANDARDS FOR NURSERY PLANTS" OF THE STATE OF FLORIDA, DEPARTMENT OF AGRICULTURE.

5.4. ALL PLANT MATERIAL SHALL BE TRUE TO THE BOTANICAL NAME, GENUS, SPECIES AND/OR HYBRID DESIGNATION.

5.5. ALL TREES, SHRUBS AND GROUNDCOVERS SHALL BE OF THE SIZES (HEIGHT & SPREAD) AS SPECIFIED IN THE PLANT LIST. CONTAINER SIZE IS FOR REFERENCE PURPOSES ONLY. ALL PLANT MATERIAL SHALL MEET OR EXCEED THE MINIMUM SIZES AT INSTALLATION, AS SPECIFIED IN THE PLANT LIST.

5.6. QUANTITIES LISTED ON THE PLANT LIST ARE FOR ESTIMATING PURPOSES. CONTRACTOR SHALL VERIFY ALL QUANTITIES. MULCH, TOPSOIL, FERTILIZER, ETC. SHALL BE INCLUDED IN THE UNIT COST OF THE PLANTS.

5.7. WHERE THERE IS A DISCREPANCY EITHER IN QUANTITIES, PLANT NAMES, SIZES OR SPECIFICATIONS BETWEEN THE PLAN OR PLANT LIST, THE PLAN TAKES PRECEDENCE.

5.8. ALL SUBSTITUTIONS AND CHANGES SHALL BE APPROVED IN WRITING PRIOR TO INSTALLATION. ANY DISCREPANCIES BETWEEN PLANS, SITE AND SPECIFICATIONS SHALL BE BROUGHT TO THE IMMEDIATE ATTENTION OF THE LANDSCAPE ARCHITECT, THE OWNER AND/OR GOVERNING MUNICIPALITY.

5.9. CONTRACTOR SHALL BE RESPONSIBLE FOR PROVIDING FINAL GRADING OF ALL ASSOCIATED PLANTING AREAS.

5.10. AFTER FINAL GRADE, LANDSCAPE AREAS ARE TO BE RAKED TO A DEPTH OF 6". ALL ROCK AND FOREIGN INORGANIC MATERIALS SHALL BE REMOVED AND DISPOSED OF PROPERLY OFF-SITE.

5.11. ALL PLANTING HOLES TO BE HAND DUG EXCEPT WHERE MACHINE DUG HOLES WILL NOT ADVERSELY AFFECT EXISTING TREES, DAMAGE UTILITIES OR OTHER IMPROVEMENTS.

5.12. ALL PLANTING BEDS IN OPEN AREAS AND AROUND BUILDING FOUNDATIONS SHALL BE EXCAVATED TO A DEPTH OF TWENTY-FOUR INCHES (24") AND BACK FILLED WITH SOIL MIX AS SPECIFIED IN SECTION 5.00. PLANTING BED SHALL BE FREE FROM ROCK, CONSTRUCTION DEBRIS OR OTHER EXTRANEIOUS MATERIAL.

5.13. ALL PLANTING BEDS IN MEDIANS, HARDSCAPE AREAS OR AREAS ENCOMPASSED BY IMPERVIOUS MATERIAL SHALL BE EXCAVATED TO A DEPTH OF THIRTY-SIX INCHES (36") OR UNTIL NATIVE SOILS ENCOUNTERED TO ENSURE DRAINAGE. BACK FILL WITH SOIL MIX AS SPECIFIED IN SECTION 5.00. PLANTING BED SHALL BE FREE FROM ROCK, CONSTRUCTION DEBRIS OR OTHER EXTRANEIOUS MATERIAL.

5.14. EXCAVATE PLANTING PITS TO A DEPTH SO THAT THE TRUNK FLARE AND FIRST ORDER LATERAL ROOT(S) WILL BE PLANTED AT FINISH GRADE OR SLIGHTLY HIGHER. ADVENTITIOUS ROOTS ARE NOT CONSIDERED FIRST ORDER ROOTS.

5.15. BURLAP, SYNTHETIC STRING, CORDS AND/OR LIFTING ROPES SHALL BE REMOVED FROM THE ROOTBALLS BEFORE ANY TREES ARE PLANTED. THE TOP 1/3RD OF BURLAP MUST BE REMOVED FROM HE TOP OF THE ROOTBALLS. THE TOP 1/3RD OF WIRE BASKETS SHALL BE COMPLETELY REMOVED AND THE BOTTOM 2/3RDS SHALL BE CUT BEFORE THE TREES ARE INSTALLED.

5.16. NO PLUNGING OF ANY TREE OR PALM WILL BE ACCEPTED.

5.17. NO PLANT MATERIAL WILL BE ACCEPTED SHOWING EVIDENCE OF CABLE, CHAIN MARKS, EQUIPMENT SCARS, OR OTHERWISE DAMAGED.

5.18. PLANT MATERIAL WILL NOT BE ACCEPTED WHEN THE BALL OF EARTH SURROUNDING ITS ROOTS HAS BEEN CRACKED, BROKEN OR OTHERWISE DAMAGED.

5.19. ALL TREES SPECIFIED AS FIELD GROWN OR B&B TREES SHALL BE ROOT-PRUNED AT THE NURSERY A MINIMUM OF (8) WEEKS PRIOR TO PLANTING.

5.20. ALL PLANT MATERIAL PLANTED WITHIN THE SIGHT DISTANCE TRIANGLE AREAS SHALL BE MAINTAINED TO PROVIDE UNOBSTRUCTED CROSS-VISIBILITY AT A HORIZONTAL LEVEL BETWEEN 30 INCHES AND 8 FEET ABOVE ADJACENT STREET GRADE.

5.21. NO CANOPY TREES SHALL BE PLANTED WITHIN 12 FEET OF A LIGHT POLE. NO PALM SPECIES SHALL BE PLANTED WITHIN 6 FEET OF A LIGHT POLE.

5.22. GROUND COVER PLANTINGS SHALL PROVIDE NOT LESS THAN 50 PERCENT COVERAGE IMMEDIATELY
- UPON PLANTING AND 100 PERCENT COVERAGE WITHIN 6 MONTHS AFTER PLANTING.

5.23. TREES AND PALMS SHALL BE MAINTAINED TO ALLOW FOR CLEAR PASSAGE 8' IN ALL PEDESTRIAN AREAS.

5.24. ALL LANDSCAPE MATERIAL SHALL BE SETBACK A MINIMUM OF 10' FROM ANY FIRE HYDRANT.

5.25. CONTRACTOR SHALL REMOVE ALL NURSERY STAKES, CONDUIT, FLAGGING AND NURSERY TAPE PRIOR TO STAKING.

5.26. CONTRACTOR SHALL STAKE & GUY ALL TREES AND PALMS AT TIME OF PLANTING AS PER THE APPROPRIATE DETAIL. CONTRACTOR IS RESPONSIBLE FOR THE MAINTENANCE AND/OR REPAIR OF ALL STAKING AND GUYING DURING WARRANTY PERIOD AND REMOVAL & DISPOSAL OF STAKING AFTER ESTABLISHMENT/WARRANTY PERIOD.

5.27. TREES THAT CANNOT STAND WITHOUT THE SUPPORT OF STAKES AND/OR GUYS SHALL BE REJECTED.

6. TURF GRASSES

6.1. ALL AREAS NOT USED FOR BUILDINGS, VEHICULAR USE AREAS, WALKS OR PLANTING BEDS SHALL BE GRASSED. GRASSING SHALL EXTEND TO ANY ABUTTING STREET PAVEMENT EDGE AND TO THE MEAN WATERLINE OF ANY ABUTTING CANAL, LAKE OR WATERWAY. REFER TO PLANTING SCHEDULE FOR ESTIMATED QUANTITY AND SPECIES.

7. MULCH & FERTILIZER

7.1. ALL PLANTING BEDS AND WATER BASINS FOR TREES SHALL BE COVERED WITH A 3" MINIMUM DEPTH OF SHREDDED FLORI-MULCH, MELALEUCA OR EUCALYPTUS MULCH GRADE 'B' OR BETTER, UNLESS OTHERWISE SPECIFIED.

7.2. INDIVIDUAL TREES PLANTED IN LAWN AREAS SHALL BE MULCHED WITH A MINIMUM 3' DIAMETER MULCH RING.

7.3. MULCH SHALL NOT BE INSTALLED WITHIN 3" OF TREE TRUNKS.

7.4. FERTILIZER MIX AS FOLLOWS:

7.4.1. DICOT TREES & SHRUBS: NPK 18-4-2, SLOW RELEASE W/ MICRONUTRIENTS

7.4.2. MONOCOT PALMS: NPK 8-2-12, SLOW RELEASE W/ MICRONUTRIENTS

7.4.3. TURF: NPK 16-4-8, SLOW RELEASE W/ MICRONUTRIENTS

8. WATERING

8.1. NO NEW IRRIGATION IS PROPOSED WITHIN THE PUBLIC RIGHT OF WAY OR ASSOCIATED WITH THIS PROJECT. REFER TO IRRIGATION RESTORATION NOTES ON SHEET LA-22.

8.2. ALL PLANT MATERIAL SHALL BE WATERED IN AT TIME OF PLANTING IN ACCORDANCE WITH STANDARD NURSERY PRACTICES. IN ADDITION, CONTRACTOR WILL CONTINUE THE WATERING OF PLANT MATERIAL UNTIL SUBSTANTIAL COMPLETION AND THE LANDSCAPE IS TURNED OVER TO THE OWNER.

9. PROJECT CLOSEOUT

9.1. DURING CONSTRUCTION, THE PROJECT SITE AND ALL ADJACENT AREAS SHALL BE MAINTAINED IN A NEAT AND CLEAN MANNER. UPON FINAL CLEAN UP, THE PROJECT SITE SHALL BE LEFT CLEAR OF ALL SURPLUS MATERIAL OR TRASH. THE PAVED AREAS SHALL BE SWEEP BROOM CLEAN.

9.2. THE CONTRACTOR SHALL RESTORE, REPLACE OR AS DIRECTED BY THE LANDSCAPE ARCHITECT, ANY PUBLIC OR PRIVATE PROPERTY DAMAGED BY THE WORK OF THE CONTRACTOR. HIS EQUIPMENT, EMPLOYEES OR THOSE OF HIS SUB-CONTRACTORS. THIS WORK SHALL BE RESTORED TO A CONDITION EQUAL TO OR BETTER THAN THAT OF THE EXISTING ADJACENT AREAS. THE RESTORATION WORK SHALL BE AT THE CONTRACTOR'S EXPENSE. SUITABLE MATERIALS AND METHODS SHALL BE USED FOR SUCH RESTORATION.

9.3. WHERE MATERIAL OR DEBRIS HAS WASHED OR FLOWED INTO OR BEEN PLACED IN WATER COURSES, DITCHES, DRAINS, CATCH BASINS, OR ELSEWHERE AS A RESULT OF THE CONTRACTOR'S OPERATIONS, SUCH MATERIAL OR DEBRIS SHALL BE REMOVED AND SATISFACTORILY DISPOSED OF DURING PROGRESS OF THE WORK. THESE AREAS SHALL BE KEPT IN A CLEAN AND NEAT CONDITION.

9.4. THE CONTRACTOR SHALL MAINTAIN ACCURATE AND COMPLETE RECORDS OF WORK ITEMS COMPLETED.

9.5. UPON COMPLETION OF CONSTRUCTION, THE CONTRACTOR SHALL SUBMIT TO THE LANDSCAPE ARCHITECT OF RECORD COMPLETE SETS OF "AS-BUILT" CONSTRUCTION DRAWINGS. THESE DRAWINGS SHALL BE MARKED TO SHOW "AS-BUILT" CONSTRUCTION CHANGES AND DIMENSIONED LOCATIONS AND ELEVATIONS OF ALL IMPROVEMENTS INCLUDING PRODUCT/EQUIPMENT AS SPECIFIED OR REVISED DURING THE SHOP DRAWING SUBMITTAL PROCESS. AS-BUILT DRAWINGS SHALL BE SIGNED AND SEALED BY A FLORIDA REGISTERED LAND SURVEYOR.

10. GUARANTEE

10.1. ALL NEW PLANT MATERIAL SHALL BE GUARANTEED FOR 1 YEAR FROM TIME OF FINAL ACCEPTANCE OF PROJECT. ANY PLANT MATERIAL NOT IN A HEALTHY GROWING CONDITION WILL BE REPLACED IN KIND BY THE CONTRACTOR AT NO ADDITIONAL COST TO THE OWNER WITHIN 10 DAYS OF NOTIFICATION.

10.2. FOR ALL REPLACEMENT PLANT MATERIAL, THE WARRANTY PERIOD SHALL BE EXTENDED AN ADDITIONAL 90 DAYS BEYOND THE ORIGINAL WARRANTY PERIOD. REPLACEMENT MATERIAL SHALL BE REPLACED IN KIND AS IT RELATES TO SPECIES, QUANTITY AND SIZE.

10.3. ALL TREES THAT LEAN OR ARE BLOWN OVER, CAUSED BY WINDS LESS THAN 74 MPH AS DETERMINED BY THE NATIONAL HURRICANE CENTER, WILL BE RE-SET AND BRACED BY THE CONTRACTOR AT NO ADDITIONAL COST TO THE OWNER.
-
- 500 Australian Avenue South
Suite 850
West Palm Beach, FL 33401
561.746.6900
www.chenmoore.com
- DELRAY BEACH, FLORIDA
DELRAY BEACH
MEMBRANE WATER TREATMENT PLANT
- LANDSCAPE NOTES
- THIS ITEM HAS BEEN DIGITALLY SIGNED BY:
ERIC D. HARRISON,
RLA ON THE DATE ADJACENT TO THE SEAL.
PRINTED COPIES OF THIS DOCUMENT ARE
NOT CONSIDERED SIGNED AND SEALED
AND THE SIGNATURE MUST BE VERIFIED ON
ANY ELECTRONIC COPIES.
- THE NAMED LICENSE LANDSCAPE
ARCHITECT SHALL BE RESPONSIBLE FOR THIS
SHEET IN ACCORDANCE WITH RULE
61G10-11.011, F.A.C.
-
- DATE:
ERIC HARRISON
LA NO. 6667129
- PROJECT NO. 159676-291242
FILE NAME: L-14.DWG
- SHEET NO.
- L-14
- ISSUED FOR PERMITTING