

# GENERAL NOTES

- GSN1. CODES:**  
ALL WORK SHALL CONFORM TO THE FLORIDA BUILDING CODE, 8th EDITION (2023) AND ALL OTHER APPLICABLE LOCAL CODES.
- GSN2. DESIGN CRITERIA:**  
THE STRUCTURAL FRAMING WAS DESIGNED USING THE FOLLOWING SUPERIMPOSED LOADS. DESIGN WIND LOADS WERE DETERMINED IN ACCORDANCE WITH ASCE 7-22.  
DESIGN WIND SPEED = 175 MPH  
RISK CATEGORY = II  
EXPOSURE = C  
INTERNAL PRESSURE = + 0.18/ - 0.18
- GSN21 SHOP DRAWINGS AND OTHER SUBMITTALS:**
- SUBMIT TO THE ENGINEER COMPLETE SHOP DRAWINGS AS REQUIRED BY THESE CONTRACT DOCUMENTS.
  - CHECK ALL SHOP DRAWINGS FOR COMPLIANCE AND COMPLETENESS PRIOR TO SUBMITTAL. ALL SHOP DRAWINGS SHALL BEAR EVIDENCE OF CONTRACTOR'S REVIEW AND APPROVAL.
  - REVIEW OF SHOP DRAWINGS BY THE ENGINEER IS FOR CONFORMANCE WITH DESIGN CONCEPT AND INFORMATION INDICATED IN CONTRACT DOCUMENTS. ACCURACY, COMPLETENESS, DIMENSIONS, QUANTITIES, SAFETY PRECAUTIONS, CONSTRUCTION MEANS AND METHODS, SEQUENCE OF CONSTRUCTION, COORDINATION WITH OTHER TRADES AND PERFORMANCE OF SYSTEMS REMAIN THE RESPONSIBILITY OF THE CONTRACTOR.
  - REVIEW BY THE ENGINEER IS NOT FOR THE PURPOSE OF APPROVING CHANGES OR SUBSTITUTIONS.
  - ALLOW ADEQUATE TIME FOR TRANSPORT AND PROCESSING OF THE SUBMITTAL BEFORE FABRICATION, THE STRUCTURAL ENGINEER WILL REVIEW AN AVERAGE SUBMITTAL WITHIN 14 CALENDAR DAYS OF RECEIPT BY THEM.

- GSN3. CONSTRUCTION DOCUMENTS:**
- EXAMINE AND STUDY ALL CONSTRUCTION DOCUMENTS PRIOR TO COMMENCEMENT OF WORK. DIRECT ANY QUESTIONS TO THE ENGINEER.
- GSN4. COORDINATION AND DIMENSIONS:**
- COORDINATE ALL DIMENSIONS PRIOR TO PROCEEDING WITH WORK. VERIFY ALL DIMENSIONS AND CONDITIONS RELATED TO EXISTING CONDITIONS IN THE FIELD PRIOR TO CONSTRUCTION. BRING ANY DISCREPANCIES TO THE IMMEDIATE ATTENTION OF THE ENGINEER. WRITTEN DIMENSIONS TAKE PRECEDENCE OVER SCALE. SCALE IS FOR GUIDELINE PURPOSES ONLY. IF DIMENSIONS ARE UNCLEAR, DO NOT SCALE. REQUEST CLARIFICATION FROM THE ENGINEER.
  - COORDINATE ALL DIMENSIONS RELATIVE TO MANUFACTURED ITEMS.
- GSN5. METHODS & SAFETY:**
- THE CONTRACTOR IS RESPONSIBLE FOR ALL METHODS, PROCEDURES AND SEQUENCES OF CONSTRUCTION. PROVIDE APPROPRIATE SUPERVISION THROUGHOUT THE PROJECT. CONSTRUCTION SITE SAFETY, INCLUDING ALL ADEQUATE TEMPORARY BRACING AND SHORING, IS THE SOLE RESPONSIBILITY OF THE CONTRACTOR. IT IS THE RESPONSIBILITY OF THE CONTRACTOR TO EMPLOY THE NECESSARY PROFESSIONAL SERVICES TO DETERMINE THE NECESSARY METHODS AND SUPPORTS REGARDING FORMING AND CONSTRUCTION LOADS.
  - CONTRACTOR IS SOLELY RESPONSIBLE FOR THE SAFE AND APPROPRIATE USE OF ALL PRODUCTS AND MATERIALS. STRICTLY CONFORM TO ALL OF THE MANUFACTURERS', PROVIDERS' OR INDUSTRY'S RESTRICTIONS, RECOMMENDATIONS, PRECAUTIONS AND PROTECTIONS (INCLUDING AS INDICATED IN THE MATERIAL/PRODUCT SAFETY DATA SHEET) FOR EACH PRODUCT'S OR MATERIAL'S STORAGE, HANDLING, USE, APPLICATION, CLEAN-UP AND DISPOSAL.

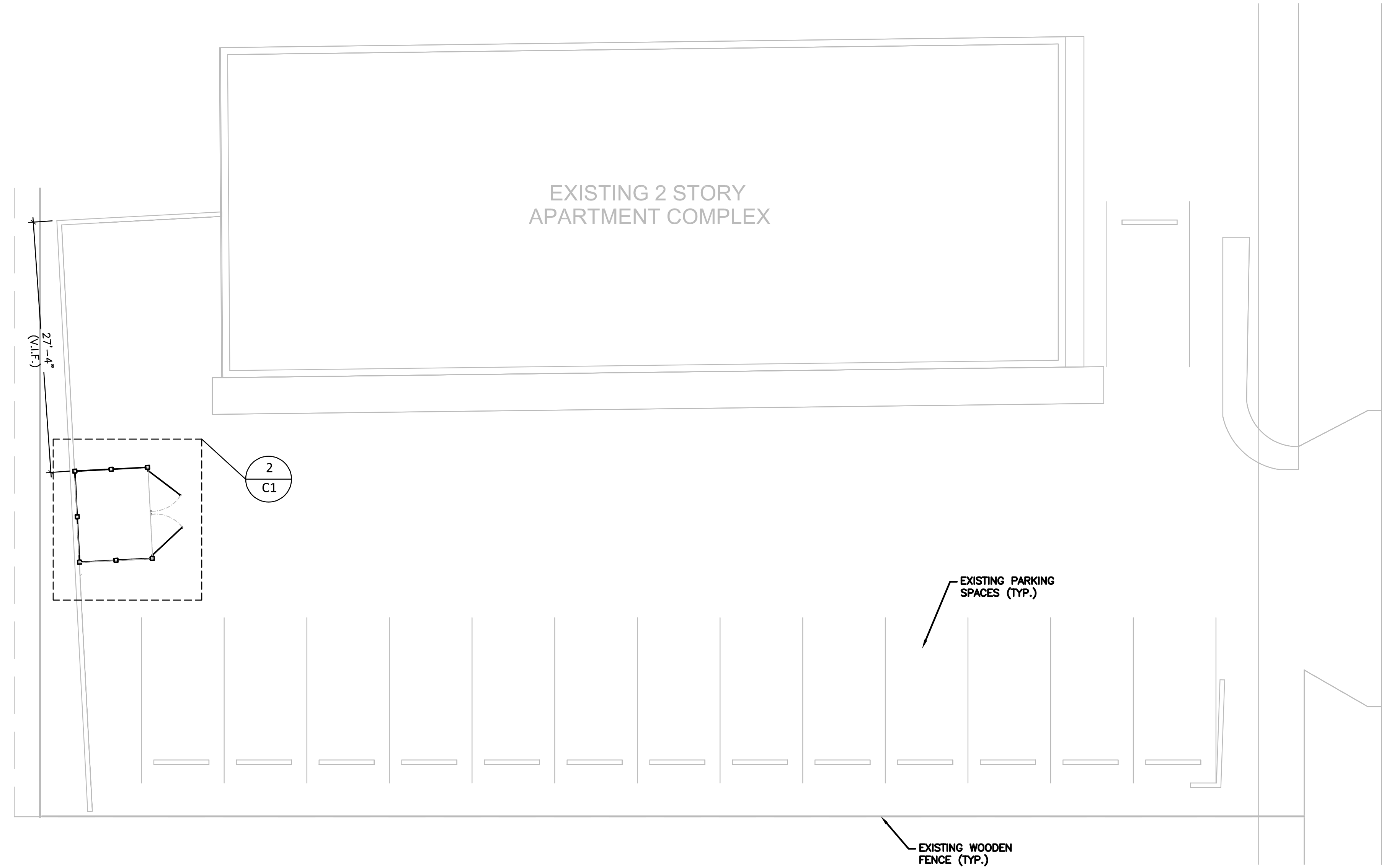

**1 SITE PLAN**  
Scale: 1/8" = 1'-0"

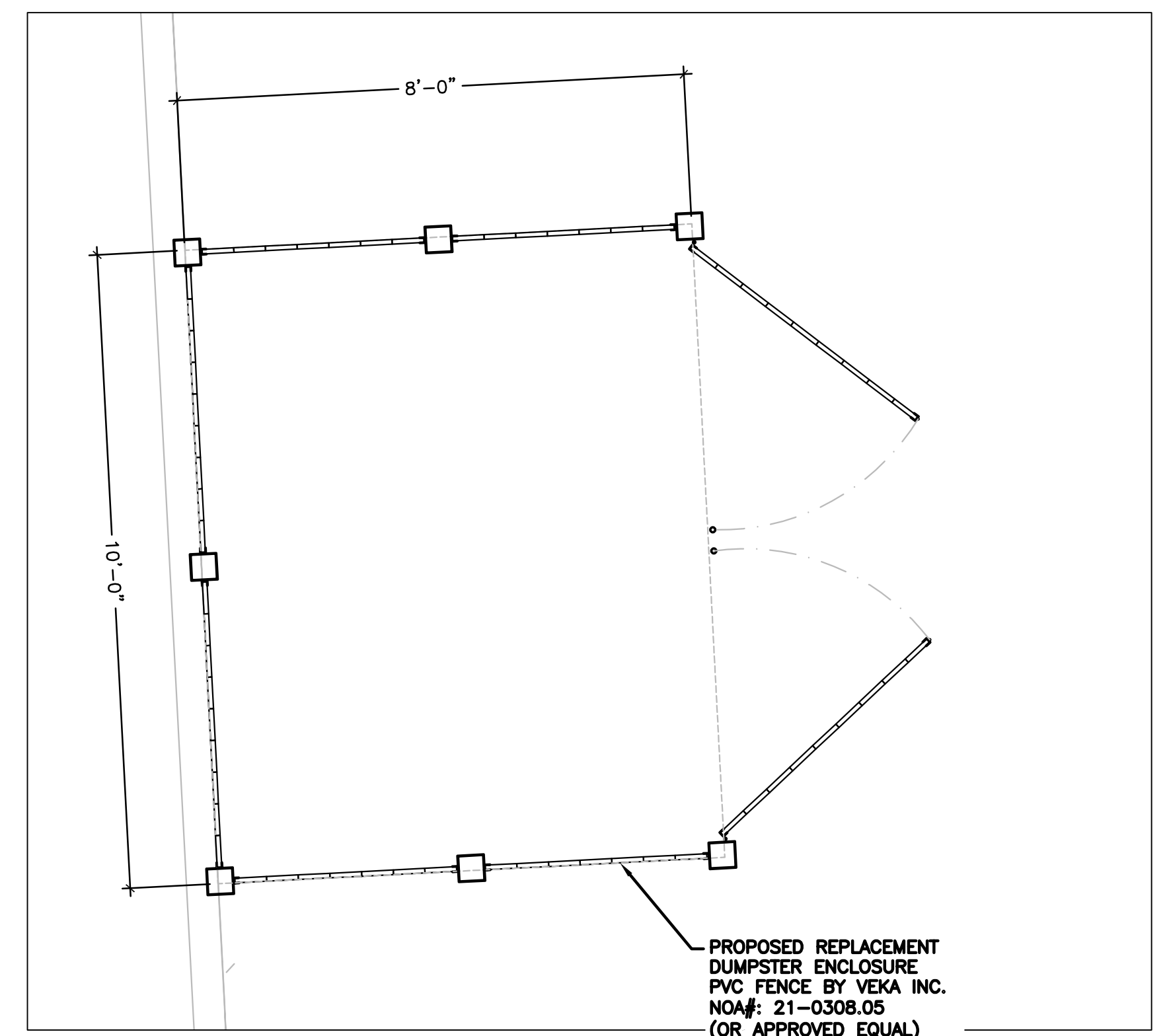

**2 REPLACEMENT DUMPSTER DETAIL**  
Scale: 1/2" = 1'-0"

THIS DRAWING IS COPYRIGHTED AND IS THE SOLE PROPERTY OF THE OWNER. IT IS PRODUCED SOLELY FOR USE BY THE OWNER AND ITS AFFILIATES. REPRODUCTION OR USE OF THIS DRAWING AND/OR THE INFORMATION CONTAINED IN IT IS FORBIDDEN WITHOUT THE WRITTEN PERMISSION OF THE OWNER.

**ED ENGINEERING LLC**  
14359 Miramar Parkway #147  
Miramar, FL 33027  
Tel: (954) 918-9608  
ediaz@edengllc.com  
Certificate of Authorization #34175

**DUMPSTER REPLACEMENT**  
PROJECT ADDRESS: 238 SE 1st Ave, Delray Beach, FL 33444

REV	DESCRIPTION	DATE
A	ISSUED FOR COORDINATION	03.12.2024

PROJECT NO: 24-001  
DRAWN BY: EDE  
SCALE: AS SHOWN

SHEET TITLE  
**GENERAL NOTES, SITE PLAN & DETAILS**

SHEET NUMBER  
**C1**