

MICHAEL D. MILES, STATE OF FLORIDA PROFESSIONAL ENGINEER, LICENSE NO. 81313. THIS ITEM HAS BEEN DIGITALLY SIGNED AND SEALED BY MICHAEL D. MILES, P.E. ON 04/14/2025. PRINTED COPIES OF THIS DOCUMENT ARE NOT CONSIDERED SIGNED AND SEALED AND THE SIGNATURE MUST BE VERIFIED ON ANY ELECTRONIC COPIES.

16' ALLEY RIGHT OF WAY

Plotted: 04/14/25 - 11:07 AM, By: arajas
File: P:\DEPC PROJECTS\4477 Investments Limited\23-00284 Delray Beach\Dwg\Entitlements\D44772300284SG1.dwg, ----> C2.00 PAVING GRADING & DRAINAGE PLAN

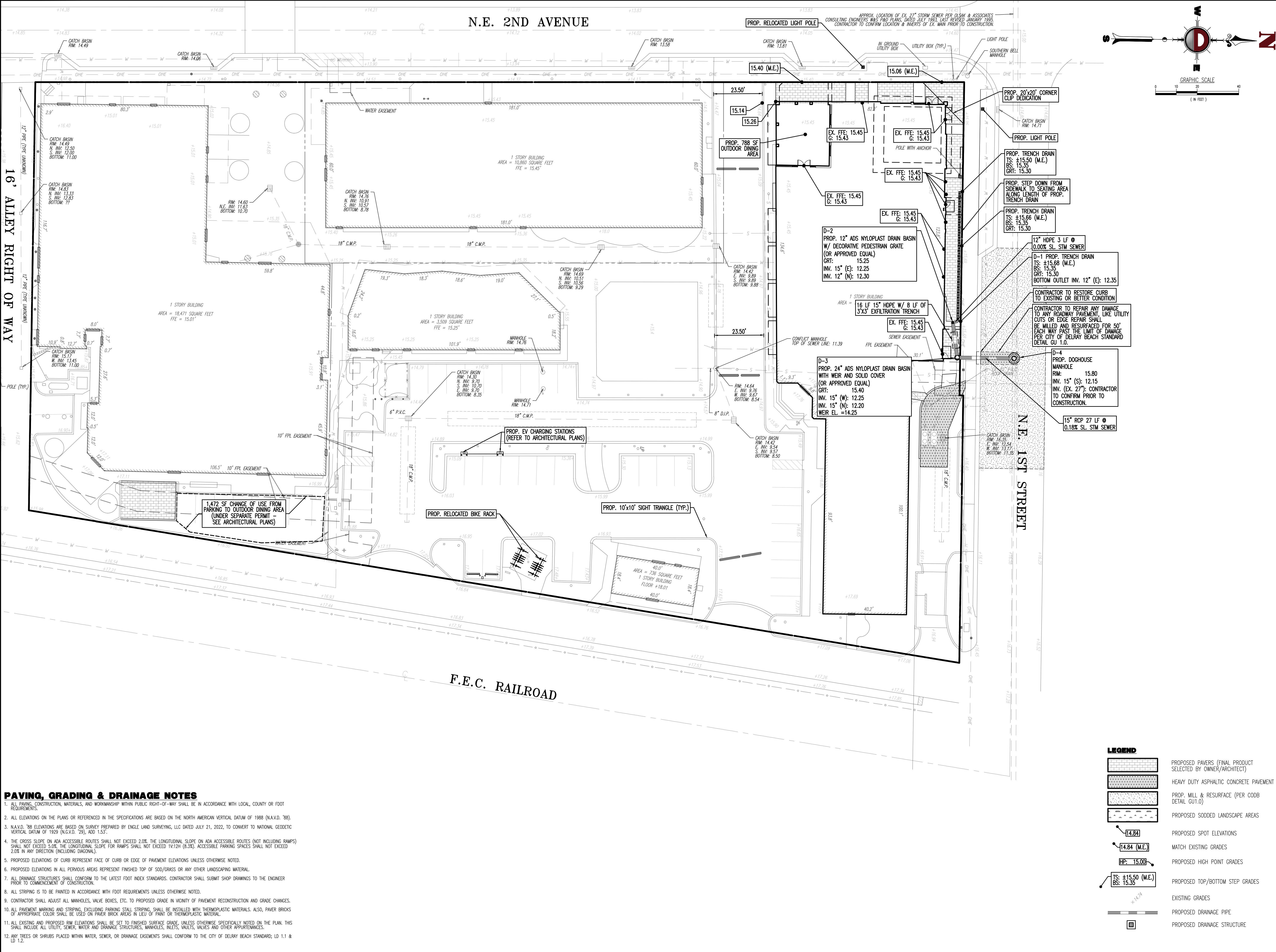

PAVING, GRADING & DRAINAGE NOTES

1. ALL PAVING, CONSTRUCTION, MATERIALS, AND WORKSMANSHIP WITHIN PUBLIC RIGHT-OF-WAY SHALL BE IN ACCORDANCE WITH LOCAL, COUNTY OR FOOT REQUIREMENTS.
2. ALL ELEVATIONS ON THE PLANS OR REFERENCED IN THE SPECIFICATIONS ARE BASED ON THE NORTH AMERICAN VERTICAL DATUM OF 1988 (N.A.83 '88).
3. N.A.83 '88 ELEVATIONS ARE BASED ON SURVEY PREPARED BY ENGLE LAND SURVEYING, LLC DATED JULY 21, 2022, TO CONVERT TO NATIONAL GEODETIC DATUM OF 1929 (N.G.D.'29), ADD 1.53'.
4. THE CROSS SLOPE ON ADA ACCESSIBLE ROUTES SHALL NOT EXCEED 2.0%. THE LONGITUDINAL SLOPE ON ADA ACCESSIBLE ROUTES (NOT INCLUDING RAMPS SHALL NOT EXCEED 5.0% IN ANY DIRECTION. THE LONGITUDINAL SLOPE FOR RAMPS SHALL NOT EXCEED 1:12(8.33%). ACCESSIBLE PARKING SPACES SHALL NOT EXCEED 2.0% IN ANY DIRECTION (INCLUDING DIAGONAL).
5. PROPOSED ELEVATIONS OF CURB REPRESENT FACE OF CURB OR EDGE OF PAVEMENT EXCEPTS UNLESS OTHERWISE NOTED.
6. PROPOSED ELEVATIONS IN ALL PERVIOUS ARE REPRESENT FINISHED TOP OF SOO/GRASS OR ANY OTHER LANDSCAPING MATERIAL.
7. ALL DRAINAGE STRUCTURES SHALL CONFORM TO THE LATEST FOOT INDEX STANDARDS. CONTRACTOR SHALL SUBMIT SHOP DRAWINGS TO THE ENGINEER PRIOR TO COMMENCEMENT OF CONSTRUCTION.
8. ALL STRIPING IS TO BE PAINTED IN ACCORDANCE WITH FOOT REQUIREMENTS UNLESS OTHERWISE NOTED.
9. CONTRACTOR SHALL ADJUST ALL MANHOLES, VALE BOXES, ETC. TO PROPOSED GRADE IN VICINITY OF PAVEMENT RECONSTRUCTION AND GRADE CHANGES.
10. ALL PAVEMENT MARKING AND STRIPING, EXCLUDING PARKING STALL STRIPING, SHALL BE INSTALLED WITH THERMOPLASTIC MATERIALS. ALSO, PAVEMENT GRADINGS OF APPROPRIATE COLOR SHALL BE USED ON PAVEMENT BRICKS IN LEAD OF PAVEMENT OR THERMOPLASTIC MATERIAL.
11. ALL EXISTING AND PROPOSED R/W ELEVATIONS SHALL BE SET TO FINISHED SURFACE GRADE UNLESS OTHERWISE SPECIFICALLY NOTED ON THE PLAN. THIS SHALL INCLUDE ALL UTILITY, SEWER, WATER AND DRAINAGE STRUCTURES, MANHOLES, INLETS, VALVES AND OTHER APPURTENANCES.
12. ALL TREES OR SHRUBS PLANTED WITHIN WATER, SEWER, OR DRAINAGE EASEMENTS SHALL CONFORM TO THE CITY OF DELRAY BEACH STANDARD, LD 1.1 & LD 1.2.

COPYRIGHT © 2025 - DYNAMIC ENGINEERING CONSULTANTS, PC - ALL RIGHTS RESERVED

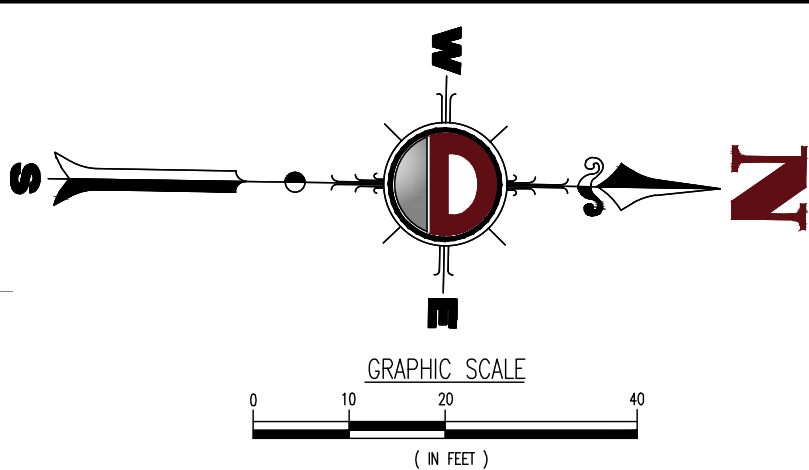

LEGEND

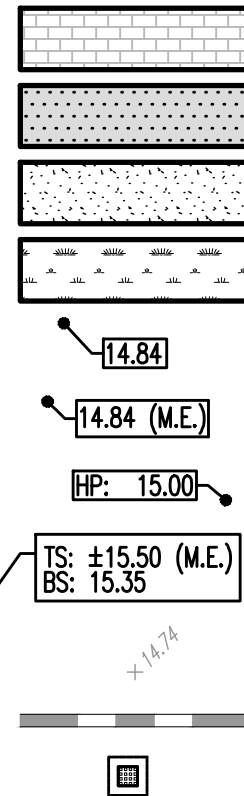

PROPOSED PAVERS (FINAL PRODUCT
SELECTED BY OWNER/ARCHITECT)

HEAVY DUTY ASPHALTIC CONCRETE PAVEMENT

PROP. MILL & RESURFACE (PER COOB
DETAIL GU1.0)

PROPOSED SODDED LANDSCAPE AREAS

PROPOSED SPOT ELEVATIONS

MATCH EXISTING GRADES

PROPOSED HIGH POINT GRADES

PROPOSED TOP/BOTTOM STEP GRADES

EXISTING GRADES

PROPOSED DRAINAGE PIPE

PROPOSED DRAINAGE STRUCTURE

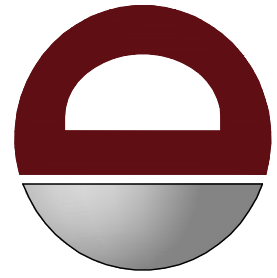

DYNAMIC
ENGINEERING • EARTH
SCIENCE • TRAFFIC

[illegible]

THIS PLAN SET IS FOR PERMITTING PURPOSES
ONLY AND MAY NOT BE USED FOR CONSTRUCTION

OWN BY:	DESIGNED BY:	CHECKED BY:	CHECKED BY:
SRM	LPG	AP	-

PROJECT: **PROPOSED OCEAN CITY LUMBER PROPERTY**
DELRAY TRIO, LLC
PARCEL ID # 12-43-46-16-C8-000-0010, 12-43-46-16-C8-000-0020
& 12-43-46-16-C8-000-0030
220 NE 1ST STREET, 25 & 45 NE 2ND AVE
DELRAY BEACH, PALM BEACH COUNTY, FL 33444



PROTECT YOURSELF

FOR STATE SPECIFIC DIRECT PHONE NUMBERS VISIT:
WWW.CALL811.COM

DYNAMIC ENGINEERING

**LAND DEVELOPMENT CONSULTING • PERMITTING
GEOTECHNICAL • ENVIRONMENTAL
TRAFFIC • SURVEY • PLANNING & ZONING**

**100 NE 5th Avenue, Suite B2
Delray Beach, FL 33483**

T: 561.921.8570

Offices conveniently located at:

Lake Como, New Jersey • T: 732.974.0158
Cheshire, New Jersey • T: 908.679.5229
Newark, New Jersey • T: 973.755.7000
Trenton, New Jersey • T: 732.974.0198
Newtown, Pennsylvania • T: 287.685.0276
Philadelphia, Pennsylvania • T: 215.383.4688
Scranton, Pennsylvania • T: 414.398.4400
Allen, Texas • T: 972.534.1200
Houston, Texas • T: 281.768.6400
Austin, Texas • T: 512.666.2646
Dayton Beach, Florida • T: 351.921.8520

Florida Certificate of Authorization No. 32535
www.dynanicec.com

MICHAEL D. MILES

PROFESSIONAL ENGINEER
FLORIDA LICENSE No. 81313
DATE:

ÁNGEL PIÑERO

PROFESSIONAL ENGINEER
FLORIDA LICENSE No. 88047
DATE:

TITLE: PAVING, GRADING
& DRAINAGE PLAN

SCALE: (H) AS (V) NOTED	DATE: 12/23/2024
PROJECT No: 4477-23-00284	

SHEET No: **C2.00**

MICHAEL D. MILES, STATE OF FLORIDA PROFESSIONAL ENGINEER, LICENSE NO. 81313, HAS REVIEWED AND SIGNED THIS SET OF DRAWINGS. PRINTED COPIES OF THIS DOCUMENT ARE NOT CONSIDERED SIGNED AND SEALED BY MICHAEL D. MILES. ANY E-MAILED COPIES OF THIS DOCUMENT ARE NOT CONSIDERED SIGNED AND SEALED BY MICHAEL D. MILES. ANY E-MAILED COPIES OF THIS DOCUMENT ARE NOT CONSIDERED SIGNED AND SEALED BY MICHAEL D. MILES.

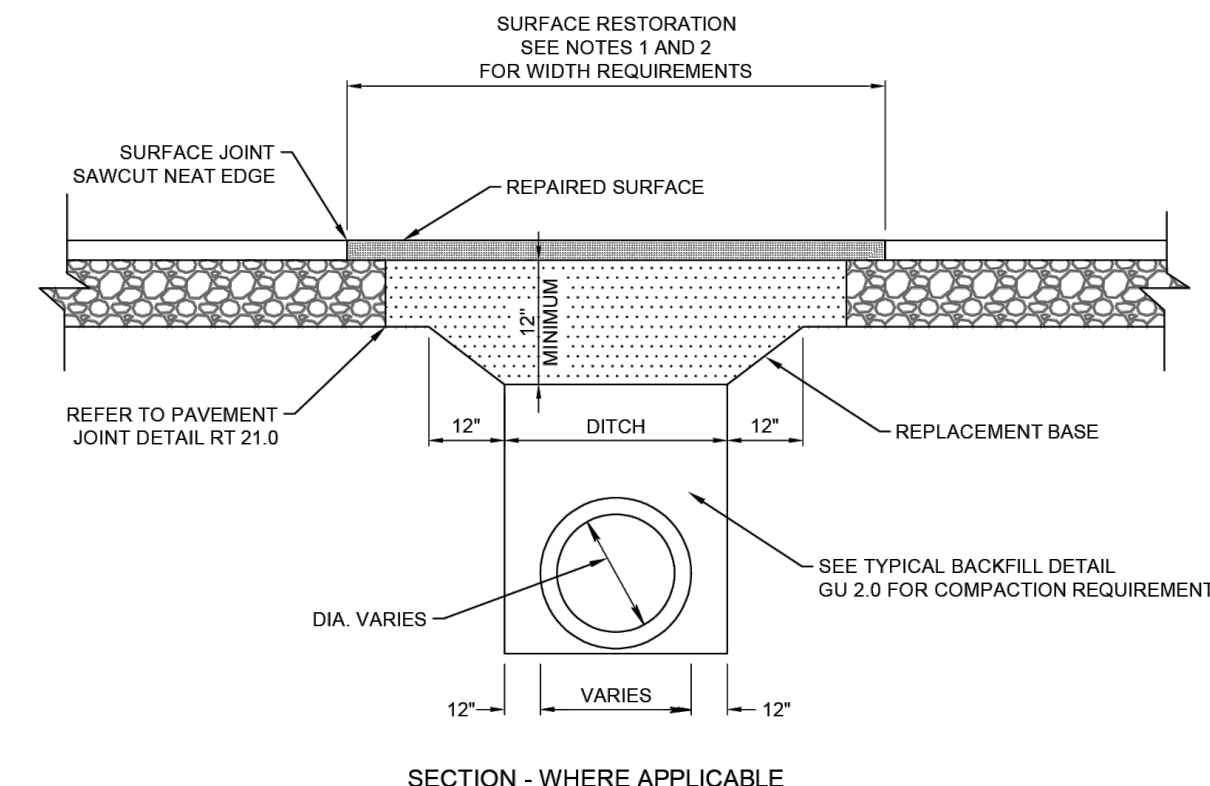

- SECTION - WHERE APPLICABLE
- NOTES:
- FOR COMMERCIAL PROJECTS THAT DAMAGE THE ROADWAY SURFACE THE ROADWAY SHALL BE MILLED AND RESURFACED 50' IN EACH DIRECTION FROM THE DAMAGED AREA. MILLING AND RESURFACING SHALL BE FOR THE FULL LANE WIDTH OF ANY DAMAGED LANE.
 - FOR RESIDENTIAL PROJECTS THAT DAMAGE THE ROADWAY SURFACE THE ROADWAY SHALL BE MILLED AND RESURFACED FOR THE WIDTH OF THE RESIDENTIAL PROPERTY (MIN. 50' REPAIR LENGTH). MILLING AND RESURFACING SHALL BE FOR THE FULL LANE WIDTH OF ANY DAMAGED LANE.
 - MILLING DEPTH SHALL BE 1" AND RESURFACING SHALL BE 1" TYPE S-H ASPHALTIC CONCRETE.
 - BASE MATERIAL SHALL BE PLACED IN TWO LIFTS AND EACH LIFT COMPACTED TO 98% MAXIMUM DENSITY PER AASHTO T-180. MAX LIFT THICKNESS SHALL BE 6".
 - 24" EXCAVATABLE FLOWABLE FILL MIN. 100 P.S.I. MAY BE USED IN LIEU OF 12" BASE.
 - ASPHALTIC CONCRETE PAVEMENT JOINTS SHALL BE MECHANICALLY SAWED.
 - ALL DISTURBED PAVEMENT MARKINGS SHALL BE RESTORED IN ACCORDANCE WITH CITY STANDARDS.
 - SURFACE MATERIAL SHALL BE S-H ASPHALTIC CONCRETE FOR TRENCH REPAIR. THICKNESS SHOULD BE TWICE THE THICKNESS OF THE ADJACENT EXISTING ASPHALT.
 - ANY PAVEMENT CUTS SHALL BE COLD PATCHED AT THE END OF EACH WORKING DAY TO FACILITATE UNHINDERED TRAFFIC FLOW.

**CITY of DELRAY BEACH**
PUBLIC WORKS DEPARTMENT
434 SOUTH SWINTON AVENUE, DELRAY BEACH, FLORIDA 33444

PAVEMENT REPAIR DETAIL

DATE: 10-04-2024
GU 1.0

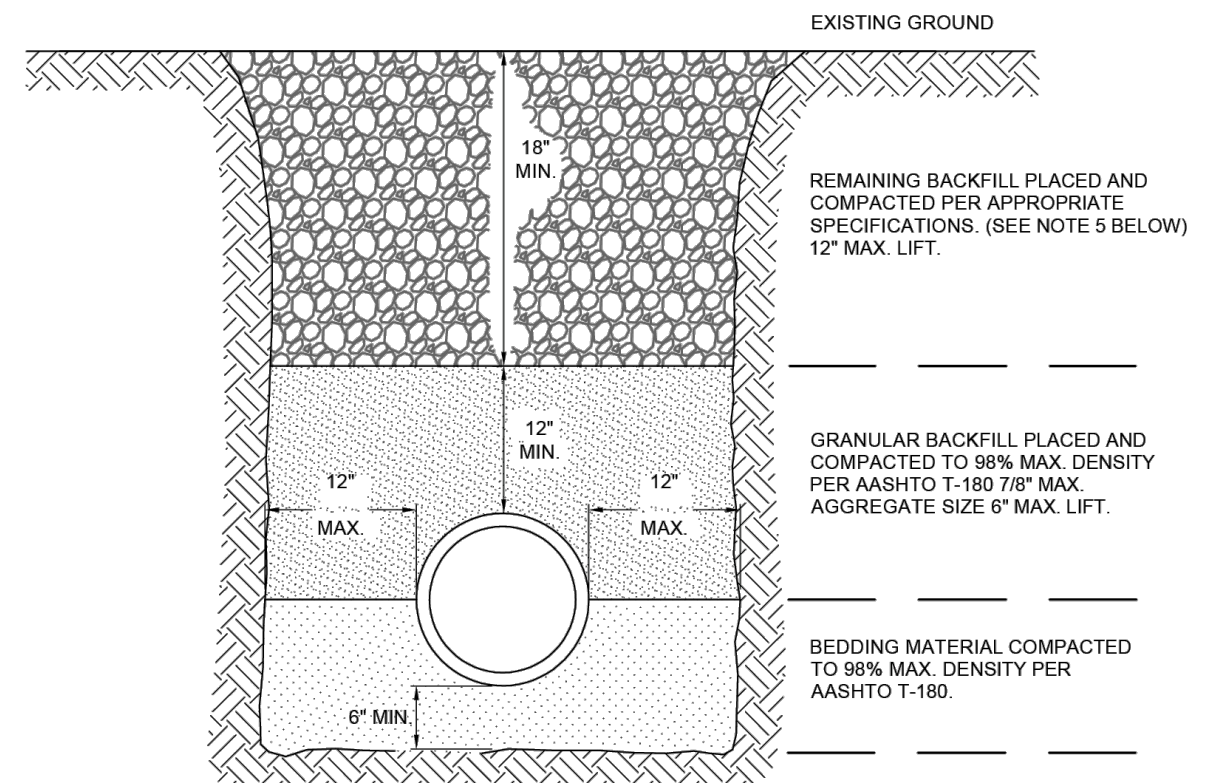

- NOTES:
- UNSUITABLE IN-SITU MATERIALS SUCH AS MUCK, DEBRIS AND LARGE ROCKS SHALL BE REMOVED OFF SITE AND DISPOSED IN A PROPER LANDFILL. BEDDING MATERIAL AND BACKFILL CONSISTING OF WASHED AND GRADED LIMEROCK 3/8" - 7/8" SIZING.
 - THE PIPE AND/OR STRUCTURE SHALL BE FULLY SUPPORTED FOR ITS ENTIRE LENGTH WITH APPROPRIATE COMPACTION UNDER THE PIPE HAUNCHES.
 - THE PIPE AND/OR STRUCTURE SHALL BE PLACED IN A DRY TRENCH.
 - BACKFILL SHALL BE FREE OF UNSUITABLE MATERIAL SUCH AS LARGE ROCK, MUCK, AND DEBRIS.
 - COMPACT BACKFILL TO 98% DENSITY UNDER PAVEMENT AND TO 95% DENSITY ELSEWHERE PER (AASHTO T-180)
 - COMPACTION AND DENSITY TESTS SHALL BE COMPLETED DURING BACKFILL OPERATIONS. CONTRACTORS NOT FOLLOWING THIS PROCEDURE, FOR WHATEVER REASONS, SHALL BE REQUIRED TO RE-EXCAVATE THE AREA IN QUESTION, DOWN TO THE BEDDING MATERIAL, THEN BACKFILL FOLLOWING THE ABOVE PROCEDURES.

**CITY of DELRAY BEACH**
PUBLIC WORKS DEPARTMENT
434 SOUTH SWINTON AVENUE, DELRAY BEACH, FLORIDA 33444

TYPICAL BACKFILL DETAIL

DATE: 10-04-2024
GU 2.0

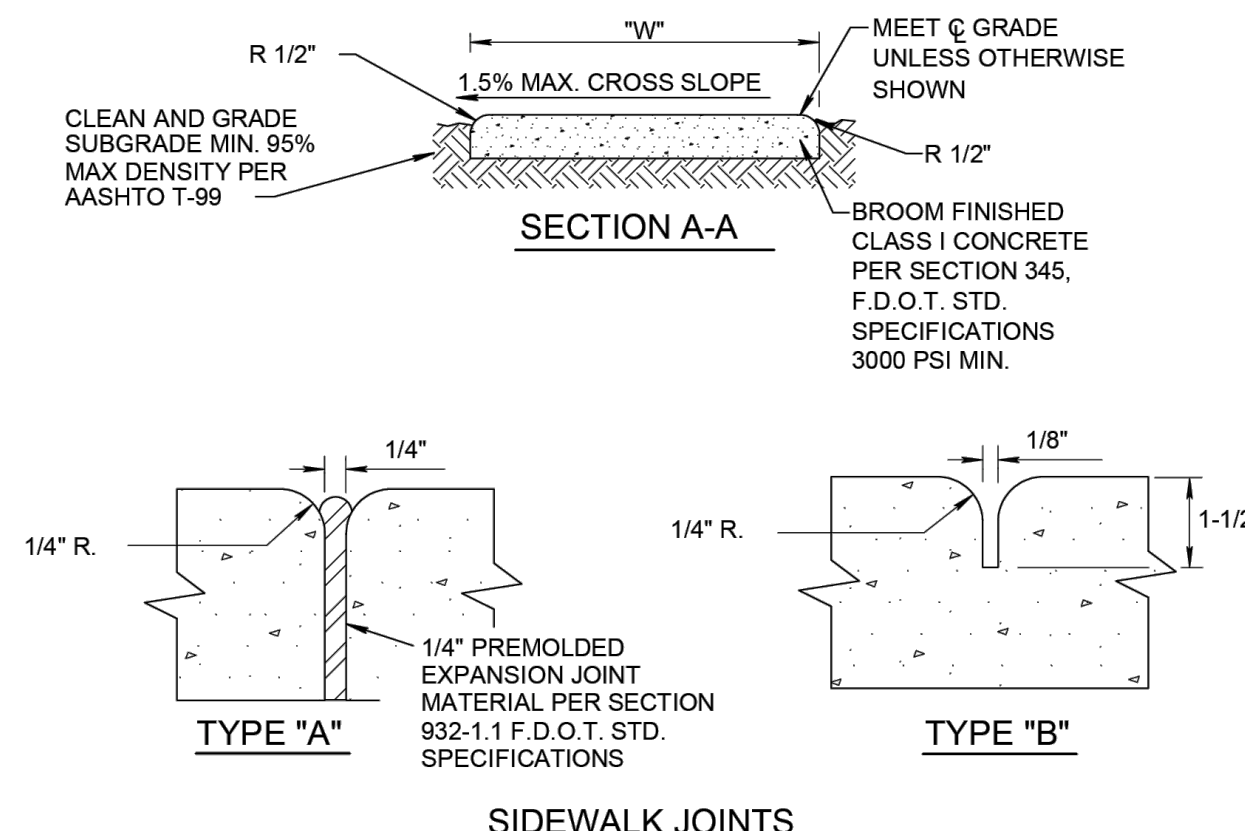

- NOTE:
- ALL SIDEWALKS SHALL BE CONSTRUCTED THRU DRIVEWAYS.
 - ALL SIDEWALKS SHALL INCLUDE ADA COMPLIANT RAMPS @ INTERSECTIONS.
 - ALL SIDEWALKS SHALL INCLUDE CROSS SLOPE AND RUNNING SLOPE IN ACCORDANCE WITH ADA REQUIREMENTS.
 - CURB RAMP DETECTABLE WARNING SURFACE SHALL EXTEND THE FULL WIDTH OF THE RAMP AND 24" DEEP.
 - SIDEWALK SHALL BE 9" THICK FOR 2' AT THE CONNECTION TO ROADWAYS WITH A 6" TRANSITION TO 6" FOR THE REMAINDER OF THE REQUIRED 10'.

TABLE OF SIDEWALK THICKNESS - "T"	
GENERAL AREAS	4"
WITHIN 10' OF CROSS-STREETS, AT DRIVEWAYS & OTHER AREAS	6"

TABLE OF SIDEWALK WIDTHS - "W"	
SINGLE-FAMILY AREAS	5'
MULTI-FAMILY AREAS	5'
OTHER AREAS AS SPECIFIED BY THE CITY.	

TABLE OF SIDEWALK JOINTS	
TYPE	LOCATION
"A"	P.C. AND P.T. OF CURVES JUNCTION OF EXISTING & NEW SIDEWALKS & EVERY 30'
"B"	5'-0" CENTER TO CENTER ON SIDEWALKS SCORED DURING PLACEMENT OR SAWCUT WITHIN 24 HOURS OF PLACEMENT.
"A"	WHERE SIDEWALK ABUTS CONCRETE CURBS, DRIVEWAYS, AND SIMILAR STRUCTURES.

**CITY of DELRAY BEACH**
PUBLIC WORKS DEPARTMENT
434 SOUTH SWINTON AVENUE, DELRAY BEACH, FLORIDA 33444

SIDEWALK CONSTRUCTION

DATE: 10-04-2024
RT 18.1

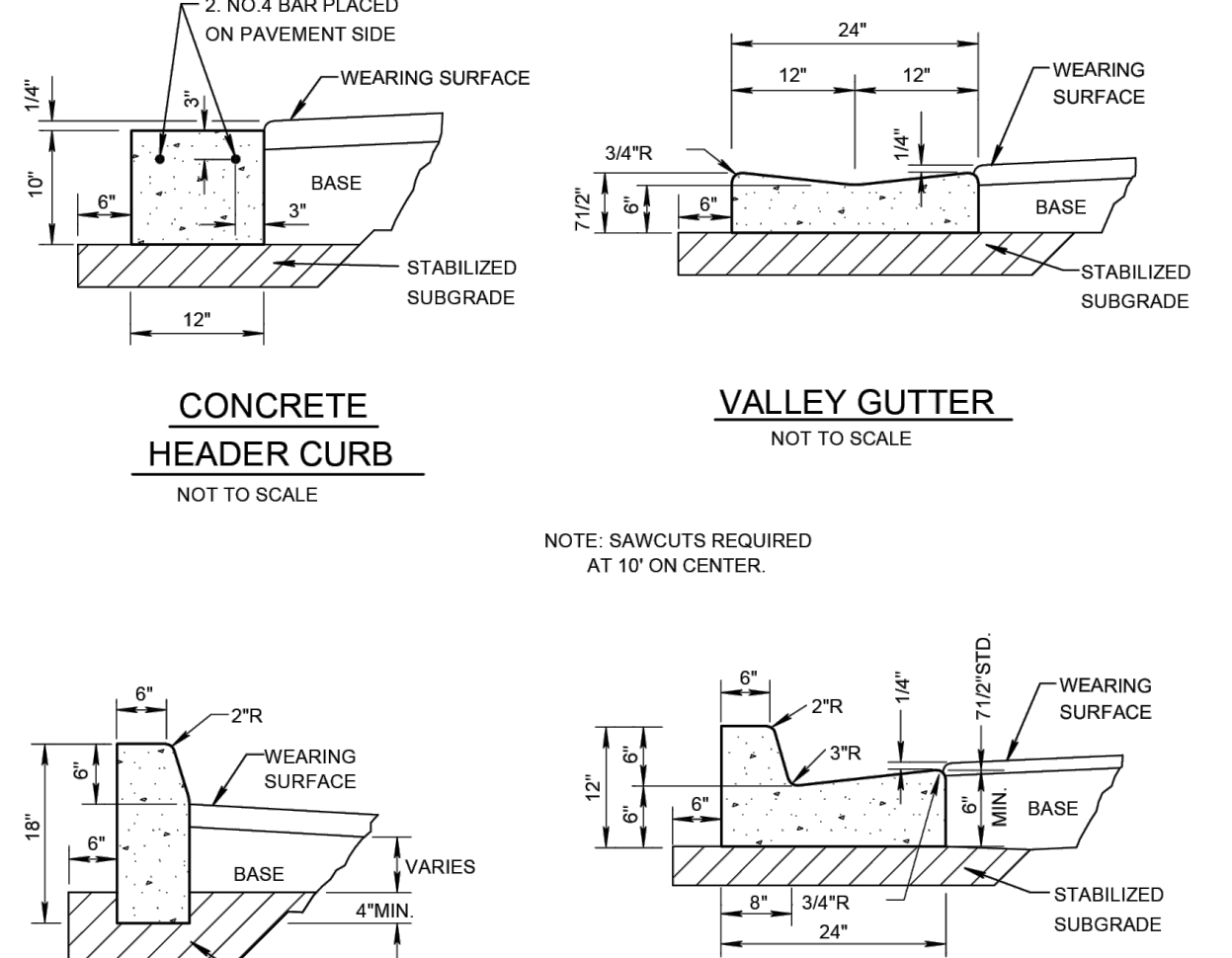

- F.D.O.T. TYPE "D" CONCRETE CURB
- NOT TO SCALE
- NOTES:
- ROADWAY SUBGRADE SHALL IN ALL CASES EXTEND BELOW CURBING.
 - SAWCUTS AT 10' ON CENTER SHALL BE MADE WITHIN 24 HOURS OF CONCRETE PLACEMENT.
- F.D.O.T. TYPE "F" CONCRETE CURB AND GUTTER
- NOT TO SCALE

**CITY of DELRAY BEACH**
PUBLIC WORKS DEPARTMENT
434 SOUTH SWINTON AVENUE, DELRAY BEACH, FLORIDA 33444

CURB AND GUTTER SECTIONS

DATE: 10-04-2024
RT 19.0

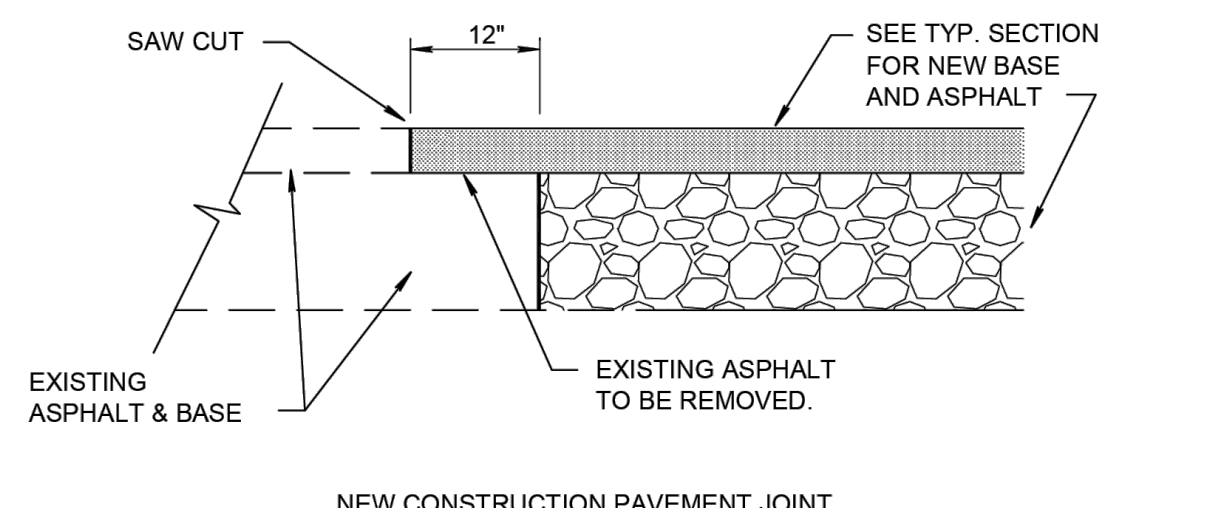

NEW CONSTRUCTION PAVEMENT JOINT

NOTE:

THIS METHOD OF PAVEMENT JOINT SHALL BE USED FOR ANY APPLICATION OR CONSTRUCTION WHERE PROPOSED PAVEMENT AND BASE WILL BE CONNECTED TO EXISTING PAVEMENT AND BASE.

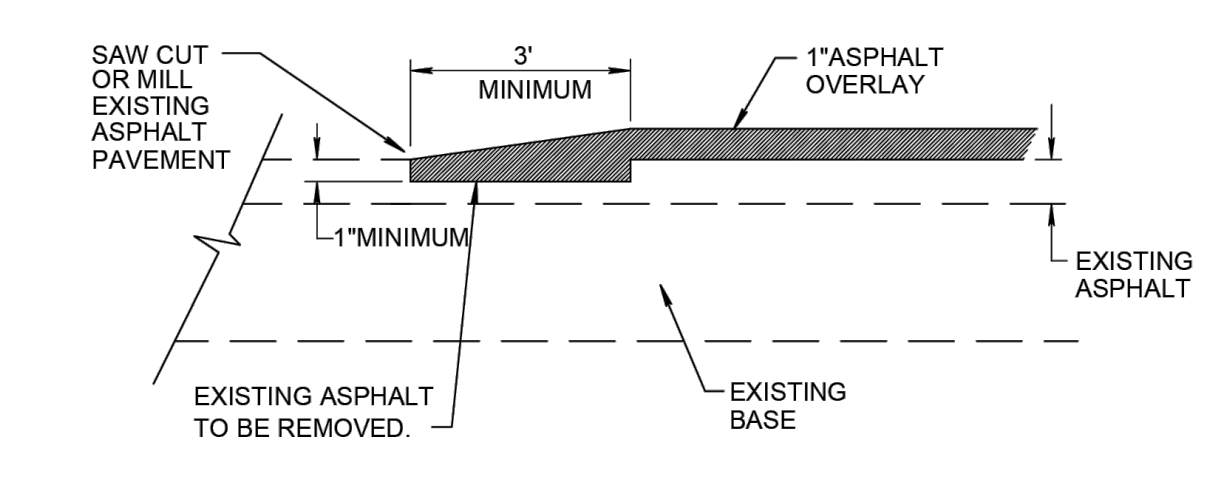

NEW OVERLAY PAVEMENT JOINT

NOTE:

THIS METHOD OF PAVEMENT JOINT SHALL BE USED FOR ANY APPLICATION OR CONSTRUCTION WHERE PROPOSED PAVEMENT WILL BE CONNECTED TO EXISTING PAVEMENT.

**CITY of DELRAY BEACH**
PUBLIC WORKS DEPARTMENT
434 SOUTH SWINTON AVENUE, DELRAY BEACH, FLORIDA 33444

PAVEMENT JOINT DETAIL

DATE: 10-04-2024
RT 21.0

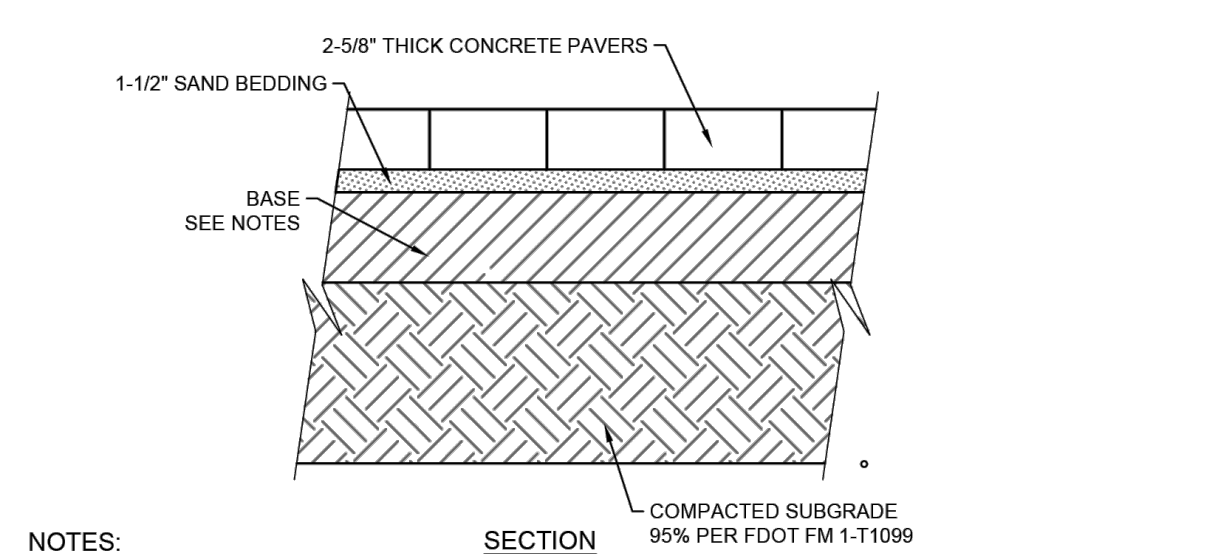

- NOTES:
- SIDEWALK BASE OUTSIDE OF THE RIGHT-OF-WAY SHALL BE 4" LIMEROCK COMPACTED TO 98% MAX DENSITY PER AASHTO T-180.
 - SIDEWALK BASE INSIDE THE RIGHT-OF-WAY SHALL BE 6" LIMEROCK COMPACTED TO 98% MAX DENSITY PER AASHTO T-180.
 - IF CITY APPROVES PAVERS TO BE USED IN LIEU OF CONCRETE SIDEWALK, PAVERS SHALL BE HOLLAND-STONE, 45" HERRINGBONE, RED/CHARCOAL, COLOR MIX #2.

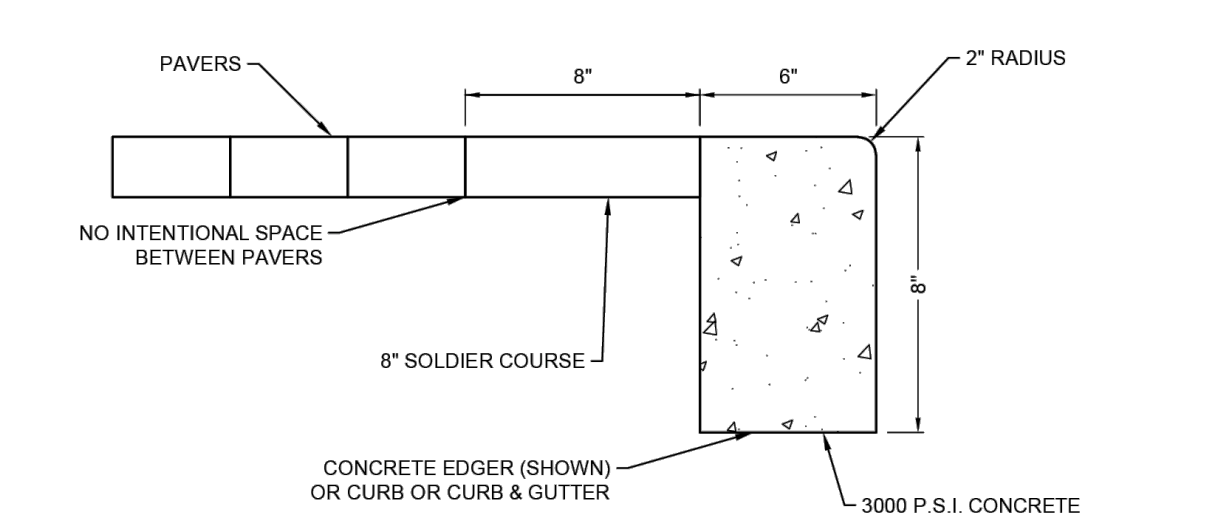

**CITY of DELRAY BEACH**
PUBLIC WORKS DEPARTMENT
434 SOUTH SWINTON AVENUE, DELRAY BEACH, FLORIDA 33444

SIDEWALK PAVBR BRICK SECTION

DATE: 10-04-2024
RT 26.0

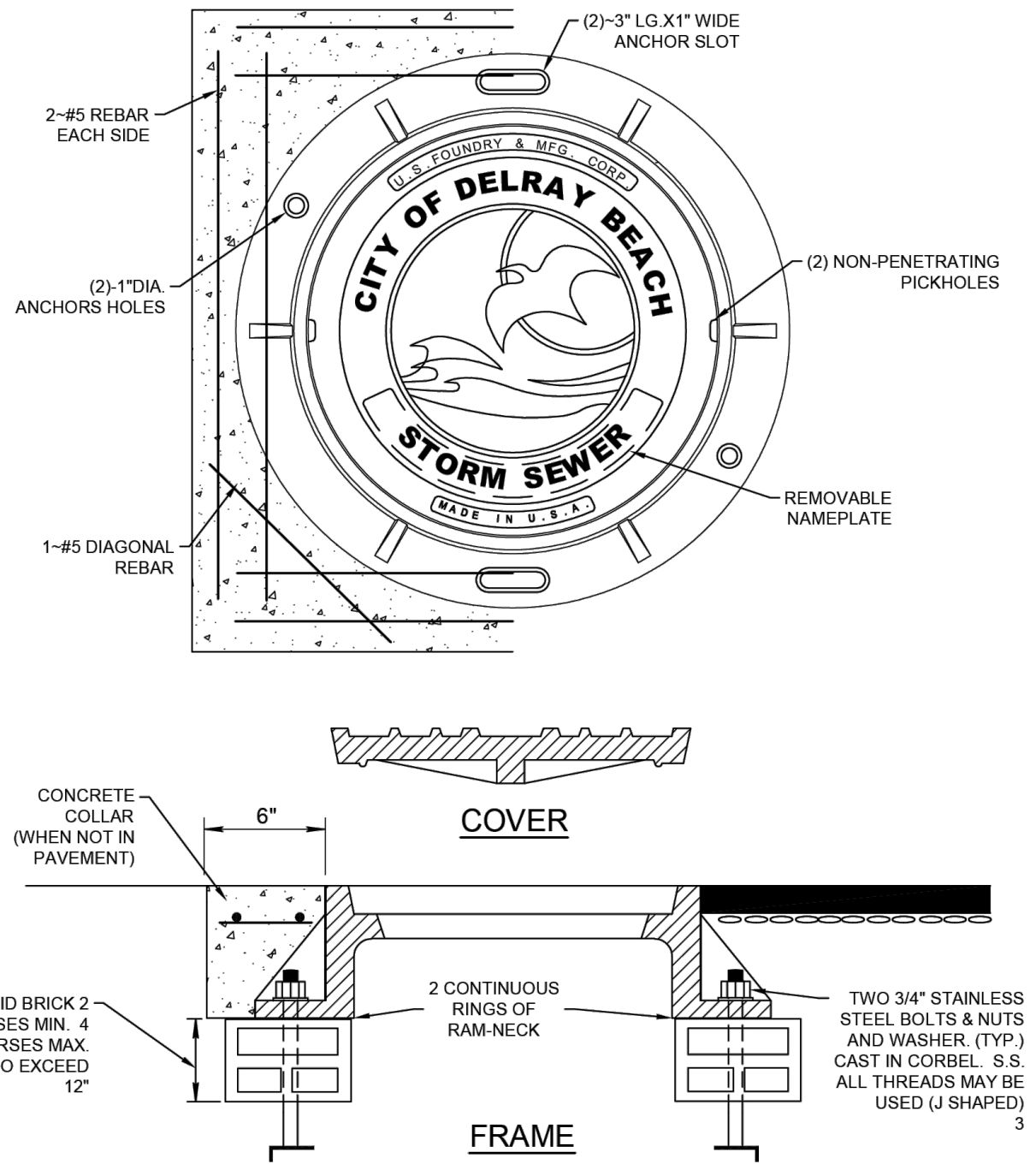

- NOTES:
- COLLAR IS REQUIRED ONLY WHEN MANHOLE IS OUT OF PAVEMENT.
 - FRAME AND COVER SHALL BE U.S. FOUNDRY MR-ORS AND RING SHALL BE USF 576
 - MANHOLE ADJUSTING RINGS SHALL BE CAST IRON, USF TYPE B. CITY LOGO LID TO BE USED ON CITY MAINTAINED STORM SEWER ONLY. STANDARD NO. 576BH IS TO BE USED ON PRIVATELY MAINTAINED STORM SEWER.

**CITY of DELRAY BEACH**
PUBLIC WORKS DEPARTMENT
434 SOUTH SWINTON AVENUE, DELRAY BEACH, FLORIDA 33444

STORM SEWER MANHOLE FRAME & COVER

DATE: 10-04-2024
D 1.0

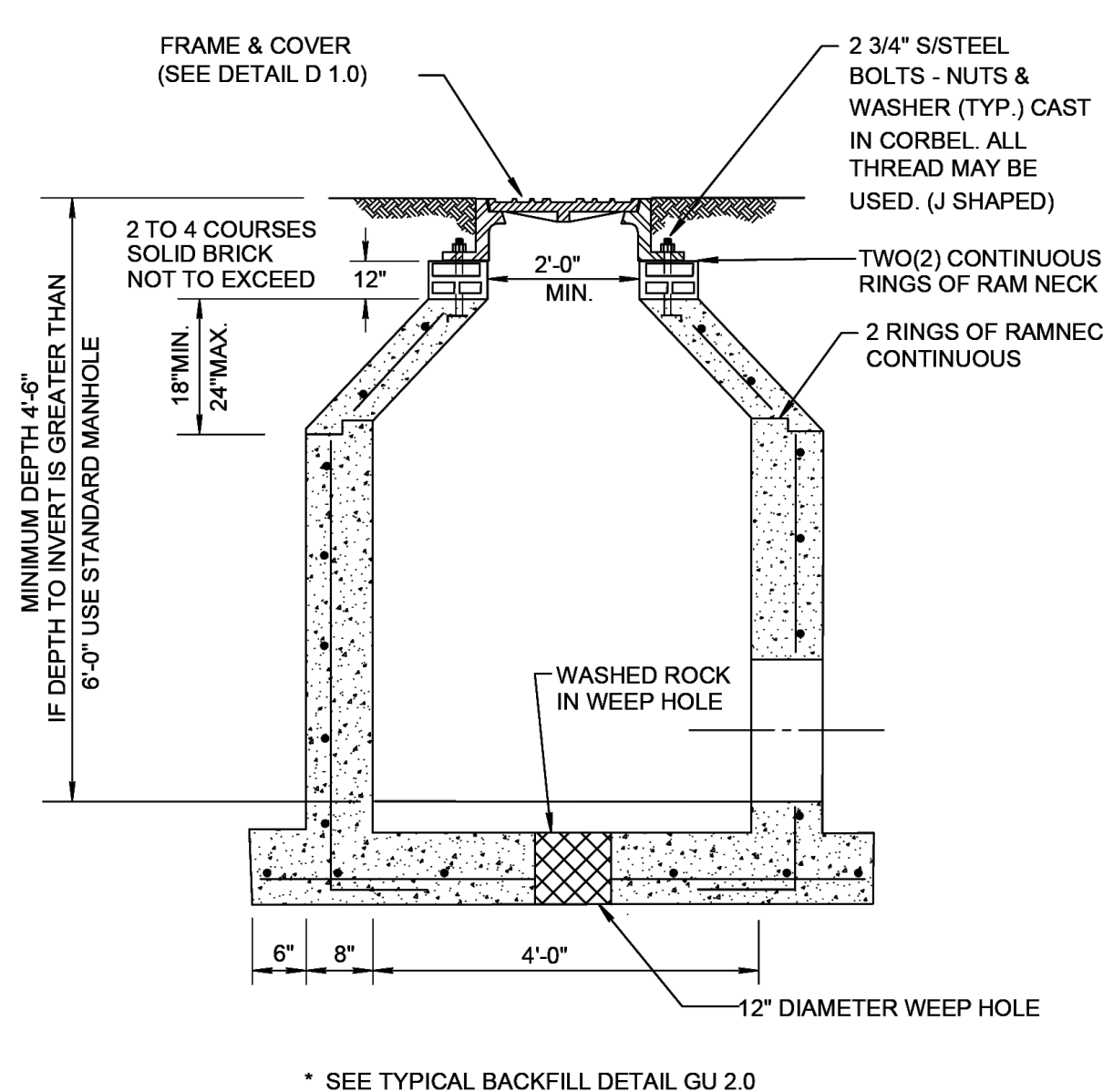

- NOTE:
- ALL STANDARD MANHOLE NOTES AND DETAILS ARE APPLICABLE. (SEE DETAIL D 2.0)
 - IF THE STRUCTURE IS INSTALLED IN WATER TABLE MUST HAVE BEDDING. (SEE DETAIL BEDDING D 4.0)

**CITY of DELRAY BEACH**
PUBLIC WORKS DEPARTMENT
434 SOUTH SWINTON AVENUE, DELRAY BEACH, FLORIDA 33444

SHALLOW MANHOLE

DATE: 10-04-2024
D 3.0

Plotted: 04/14/25 - 11:07 AM, By: aroja
File: P:\CEPC PROJECTS\4477 Investments\4477 Investments.dwg, C2.01 PAVING GRADING & DRAINAGE DETAILS
Copyright © 2025 - DYNAMIC ENGINEERING CONSULTANTS, PC - ALL RIGHTS RESERVED

**DYNAMIC ENGINEERING**
LAND DEVELOPMENT CONSULTING • PERMITTING
GEOTECHNICAL • ENVIRONMENTAL
TRAFFIC • SURVEY • PLANNING & ZONING
100 NE 5th Avenue, Suite B2
Delray Beach, FL 33483
T: 561.921.8570
Offices conveniently located at:
Fort Lauderdale • 1-754-771-1111
Coral Gables • 1-305-441-1111
Miami • 1-305-441-1111
Fort Myers • 1-888-871-1111
Tampa • 1-888-871-1111
Orlando • 1-888-871-1111
Jacksonville • 1-888-871-1111
Fort Worth • 1-888-871-1111
Dallas • 1-888-871-1111
Houston • 1-888-871-1111
Phoenix • 1-888-871-1111
San Antonio • 1-888-871-1111
Austin • 1-888-871-1111
San Diego • 1-888-871-1111
Los Angeles • 1-888-871-1111
San Francisco • 1-888-871-1111
Seattle • 1-888-871-1111
Portland • 1-888-871-1111
Denver • 1-888-871-1111
Chicago • 1-888-871-1111
New York • 1-888-871-1111
Boston • 1-888-871-1111
Washington, DC • 1-888-871-1111
Atlanta • 1-888-871-1111
Nashville • 1-888-871-1111
Indianapolis • 1-888-871-1111
Columbus • 1-888-871-1111
San Jose • 1-888-871-1111
Oakland • 1-888-871-1111
San Francisco • 1-888-871-1111
Seattle • 1-888-871-1111
Portland • 1-888-871-1111
Denver • 1-888-871-1111
Chicago • 1-888-871-1111
New York • 1-888-871-1111
Boston • 1-888-871-1111
Washington, DC • 1-888-871-1111
Atlanta • 1-888-871-1111
Nashville • 1-888-871-1111
Indianapolis • 1-888-871-1111
Columbus • 1-888-871-1111
San Jose • 1-888-871-1111
Oakland • 1-888-871-1111
San Francisco • 1-888-871-1111
Seattle • 1-888-871-1111
Portland • 1-888-871-1111
Denver • 1-888-871-1111
Chicago • 1-888-871-1111
New York • 1-888-871-1111
Boston • 1-888-871-1111
Washington, DC • 1-888-871-1111
Atlanta • 1-888-871-1111
Nashville • 1-888-871-1111
Indianapolis • 1-888-871-1111
Columbus • 1-888-871-1111
San Jose • 1-888-871-1111
Oakland • 1-888-871-1111
San Francisco • 1-888-871-1111
Seattle • 1-888-871-1111
Portland • 1-888-871-1111
Denver • 1-888-871-1111
Chicago • 1-888-871-1111
New York • 1-888-871-1111
Boston • 1-888-871-1111
Washington, DC • 1-888-871-1111
Atlanta • 1-888-871-1111
Nashville • 1-888-871-1111
Indianapolis • 1-888-871-1111
Columbus • 1-888-871-1111
San Jose • 1-888-871-1111
Oakland • 1-888-871-1111
San Francisco • 1-888-871-1111
Seattle • 1-888-871-1111
Portland • 1-888-871-1111
Denver • 1-888-871-1111
Chicago • 1-888-871-1111
New York • 1-888-871-1111
Boston • 1-888-871-1111
Washington, DC • 1-888-871-1111
Atlanta • 1-888-871-1111
Nashville • 1-888-871-1111
Indianapolis • 1-888-871-1111
Columbus • 1-888-871-1111
San Jose • 1-888-871-1111
Oakland • 1-888-871-1111
San Francisco • 1-888-871-1111
Seattle • 1-888-871-1111
Portland • 1-888-871-1111
Denver • 1-888-871-1111
Chicago • 1-888-871-1111
New York • 1-888-871-1111
Boston • 1-888-871-1111
Washington, DC • 1-888-871-1111
Atlanta • 1-888-871-1111
Nashville • 1-888-871-1111
Indianapolis • 1-888-871-1111
Columbus • 1-888-871-1111
San Jose • 1-888-871-1111
Oakland • 1-888-871-1111
San Francisco • 1-888-871-1111
Seattle • 1-888-871-1111
Portland • 1-888-871-1111
Denver • 1-888-871-1111
Chicago • 1-888-871-1111
New York • 1-888-871-1111
Boston • 1-888-871-1111
Washington, DC • 1-888-871-1111
Atlanta • 1-888-871-1111
Nashville • 1-888-871-1111
Indianapolis • 1-888-871-1111
Columbus • 1-888-871-1111
San Jose • 1-888-871-1111
Oakland • 1-888-871-1111
San Francisco • 1-888-871-1111
Seattle • 1-888-871-1111
Portland • 1-888-871-1111
Denver • 1-888-871-1111
Chicago • 1-888-871-1111
New York • 1-888-871-1111
Boston • 1-888-871-1111
Washington, DC • 1-888-871-1111
Atlanta • 1-888-871-1111
Nashville • 1-888-871-1111
Indianapolis • 1-888-871-1111
Columbus • 1-888-871-1111
San Jose • 1-888-871-1111
Oakland • 1-888-871-1111
San Francisco • 1-888-871-1111
Seattle • 1-888-871-1111
Portland • 1-888-871-1111
Denver • 1-888-871-1111
Chicago • 1-888-871-1111
New York • 1-888-871-1111
Boston • 1-888-871-1111
Washington, DC • 1-888-871-1111
Atlanta • 1-888-871-1111
Nashville • 1-888-871-1111
Indianapolis • 1-888-871-1111
Columbus • 1-888-871-1111
San Jose • 1-888-871-1111
Oakland • 1-888-871-1111
San Francisco • 1-888-871-1111
Seattle • 1-888-871-1111
Portland • 1-888-871-1111
Denver • 1-888-871-1111
Chicago • 1-888-871-1111
New York • 1-888-871-1111
Boston • 1-888-871-1111
Washington, DC • 1-888-871-1111
Atlanta • 1-888-871-1111
Nashville • 1-888-871-1111
Indianapolis • 1-888-871-1111
Columbus • 1-888-871-1111
San Jose • 1-888-871-1111
Oakland • 1-888-871-1111
San Francisco • 1-888-871-1111
Seattle • 1-888-871-1111
Portland • 1-888-871-1111
Denver • 1-888-871-1111
Chicago • 1-888-871-1111
New York • 1-888-871-1111
Boston • 1-888-871-1111
Washington, DC • 1-888-871-1111
Atlanta • 1-888-871-1111
Nashville • 1-888-871-1111
Indianapolis • 1-888-871-1111
Columbus • 1-888-871-1111
San Jose • 1-888-871-1111
Oakland • 1-888-871-1111
San Francisco • 1-888-871-1111
Seattle • 1-888-871-1111
Portland • 1-888-871-1111
Denver • 1-888-871-1111
Chicago • 1-888-871-1111
New York • 1-888-871-1111
Boston • 1-888-871-1111
Washington, DC • 1-888-871-1111
Atlanta • 1-888-871-1111
Nashville • 1-888-871-1111
Indianapolis • 1-888-871-1111
Columbus • 1-888-871-1111
San Jose • 1-888-871-1111
Oakland • 1-888-871-1111
San Francisco • 1-888-871-1111
Seattle • 1-888-871-1111
Portland • 1-888-871-1111
Denver • 1-888-871-1111
Chicago • 1-888-871-1111
New York • 1-888-871-1111
Boston • 1-888-871-1111
Washington, DC • 1-888-871-1111
Atlanta • 1-888-871-1111
Nashville • 1-888-871-1111
Indianapolis • 1-888-871-1111
Columbus • 1-888-871-1111
San Jose • 1-888-871-1111
Oakland • 1-888-871-1111
San Francisco • 1-888-871-1111
Seattle • 1-888-871-1111
Portland • 1-888-871-1111
Denver • 1-888-871-1111
Chicago • 1-888-871-1111
New York • 1-888-871-1111
Boston • 1-888-871-1111
Washington, DC • 1-888-871-1111
Atlanta • 1-888-871-1111
Nashville • 1-888-871-1111
Indianapolis • 1-888-871-1111
Columbus • 1-888-871-1111
San Jose • 1-888-871-1111
Oakland • 1-888-871-1111
San Francisco • 1-888-871-1111
Seattle • 1-888-871-1111
Portland • 1-888-871-1111
Denver • 1-888-871-1111
Chicago • 1-888-871-1111
New York • 1-888-871-1111
Boston • 1-888-871-1111
Washington, DC • 1-888-871-1111
Atlanta • 1-888-871-1111
Nashville • 1-888-871-1111
Indianapolis • 1-888-871-1111
Columbus • 1-888-871-1111
San Jose • 1-888-871-1111
Oakland • 1-888-871-1111
San Francisco • 1-888-871-1111
Seattle • 1-888-871-1111
Portland • 1-888-871-1111
Denver • 1-888-871-1111
Chicago • 1-888-871-1111
New York • 1-888-871-1111
Boston • 1-888-871-1111
Washington, DC • 1-888-871-1111
Atlanta • 1-888-871-1111
Nashville • 1-888-871-1111
Indianapolis • 1-888-871-1111
Columbus • 1-888-871-1111
San Jose • 1-888-871-1111
Oakland • 1-888-871-1111
San Francisco • 1-888-871-1111
Seattle • 1-888-871-1111
Portland • 1-888-871-1111
Denver • 1-888-871-1111
Chicago • 1-888-871-1111
New York • 1-888-871-1111
Boston • 1-888-871-1111
Washington, DC • 1-888-871-1111
Atlanta • 1-888-871-1111
Nashville • 1-888-871-1111
Indianapolis • 1-888-871-1111
Columbus • 1-888-871-1111
San Jose • 1-888-871-1111
Oakland • 1-888-871-1111
San Francisco • 1-888-871-1111
Seattle • 1-888-871-1111
Portland • 1-888-871-1111
Denver • 1-888-871-1111
Chicago • 1-888-871-1111
New York • 1-888-871-1111
Boston • 1-888-871-1111
Washington, DC • 1-888-871-1111
Atlanta • 1-888-871-1111
Nashville • 1-888-871-1111
Indianapolis • 1-888-871-1111
Columbus • 1-888-871-1111
San Jose • 1-888-871-1111
Oakland • 1-888-871-1111
San Francisco • 1-888-871-1111
Seattle • 1-888-871-1111
Portland • 1-888-871-1111
Denver • 1-888-871-1111
Chicago • 1-888-871-1111
New York • 1-888-871-1111
Boston • 1-888-871-1111
Washington, DC • 1-888-871-1111
Atlanta • 1-888-871-1111
Nashville • 1-888-871-1111
Indianapolis • 1-888-871-1111
Columbus • 1-888-871-1111
San Jose • 1-888-871-1111
Oakland • 1-888-871-1111
San Francisco • 1-888-871-1111
Seattle • 1-888-871-1111
Portland • 1-888-871-1111
Denver • 1-888-871-1111
Chicago • 1-888-871-1111
New York • 1-888-871-1111
Boston • 1-888-871-1111
Washington, DC • 1-888-871-1111
Atlanta • 1-888-871-1111
Nashville • 1-888-871-1111
Indianapolis • 1-888-871-1111
Columbus • 1-888-871-1111
San Jose • 1-888-871-1111
Oakland • 1-888-871-1111
San Francisco • 1-888-871-1111
Seattle • 1-888-871-1111
Portland • 1-888-871-1111
Denver • 1-888-871-1111
Chicago • 1-888-871-1111
New York • 1-888-871-1111
Boston • 1-888-871-1111
Washington, DC • 1-888-871-1111
Atlanta • 1-888-871-1111
Nashville • 1-888-871-1111
Indianapolis • 1-888-871-1111
Columbus • 1-888-871-1111
San Jose • 1-888-871-1111
Oakland • 1-888-871-1111
San Francisco • 1-888-871-1111
Seattle • 1-888-871-1111
Portland • 1-888-871-1111
Denver • 1-888-871-1111
Chicago • 1-888-871-1111
New York • 1-888-871-1111
Boston • 1-888-871-1111
Washington, DC • 1-888-871-1111
Atlanta • 1-888-871-1111
Nashville • 1-888-871-1111
Indianapolis • 1-888-871-1111
Columbus • 1-888-871-1111
San Jose • 1-888-871-1111
Oakland • 1-888-871-1111
San Francisco • 1-888-871-1111
Seattle • 1-888-871-1111
Portland • 1-888-871-1111
Denver • 1-888-871-1111
Chicago • 1-888-871-1111
New York • 1-888-871-1111
Boston • 1-888-871-1111
Washington, DC • 1-888-871-1111
Atlanta • 1-888-871-1111
Nashville • 1-888-871-1111
Indianapolis • 1-888-871-1111
Columbus • 1-888-871-1111
San Jose • 1-888-871-1111
Oakland • 1-888-871-1111
San Francisco • 1-888-871-1111
Seattle • 1-888-871-1111
Portland • 1-888-871-1111
Denver • 1-888-871-1111
Chicago • 1-888-871-1111
New York • 1-888-871-1111
Boston • 1-888-871-1111
Washington, DC • 1-888-871-1111
Atlanta • 1-888-871-1111
Nashville • 1-888-871-1111
Indianapolis • 1-888-871-1111
Columbus • 1-888-871-1111
San Jose • 1-888-871-1111
Oakland • 1-888-871-1111
San Francisco • 1-888-871-1111
Seattle • 1-888-871-1111
Portland • 1-888-871-1111
Denver • 1-888-871-1111
Chicago • 1-888-871-1111
New York • 1-888-871-1111
Boston • 1-888-871-1111
Washington, DC • 1-888-871-1111
Atlanta • 1-888-871-1111
Nashville • 1-888-871-1111
Indianapolis • 1-888-871-1111
Columbus • 1-888-871-1111
San Jose • 1-888-871-1111
Oakland • 1-888-871-1111
San Francisco • 1-888-871-1111
Seattle • 1-888-871-1111
Portland • 1-888-871-1111
Denver • 1-888-871-1111
Chicago • 1-888-871-1111
New York • 1-888-871-1111
Boston • 1-888-871-1111
Washington, DC • 1-888-871-1111
Atlanta • 1-888-871-1111
Nashville • 1-888-871-1111
Indianapolis • 1-888-871-1111
Columbus • 1-888-871-1111
San Jose • 1-888-871-1111
Oakland • 1-888-871-1111
San Francisco • 1-888-871-

Plotted: 04/14/25 - 11:07 AM, By: arojas
File: P:\DECPC PROJECTS\4477 Investments Limited\23--00284 Delroy Beach\Dwg\Entitlements\D44772300284SD1.dwg, ----> PAVING GRADING & DRAINAGE DETAILS

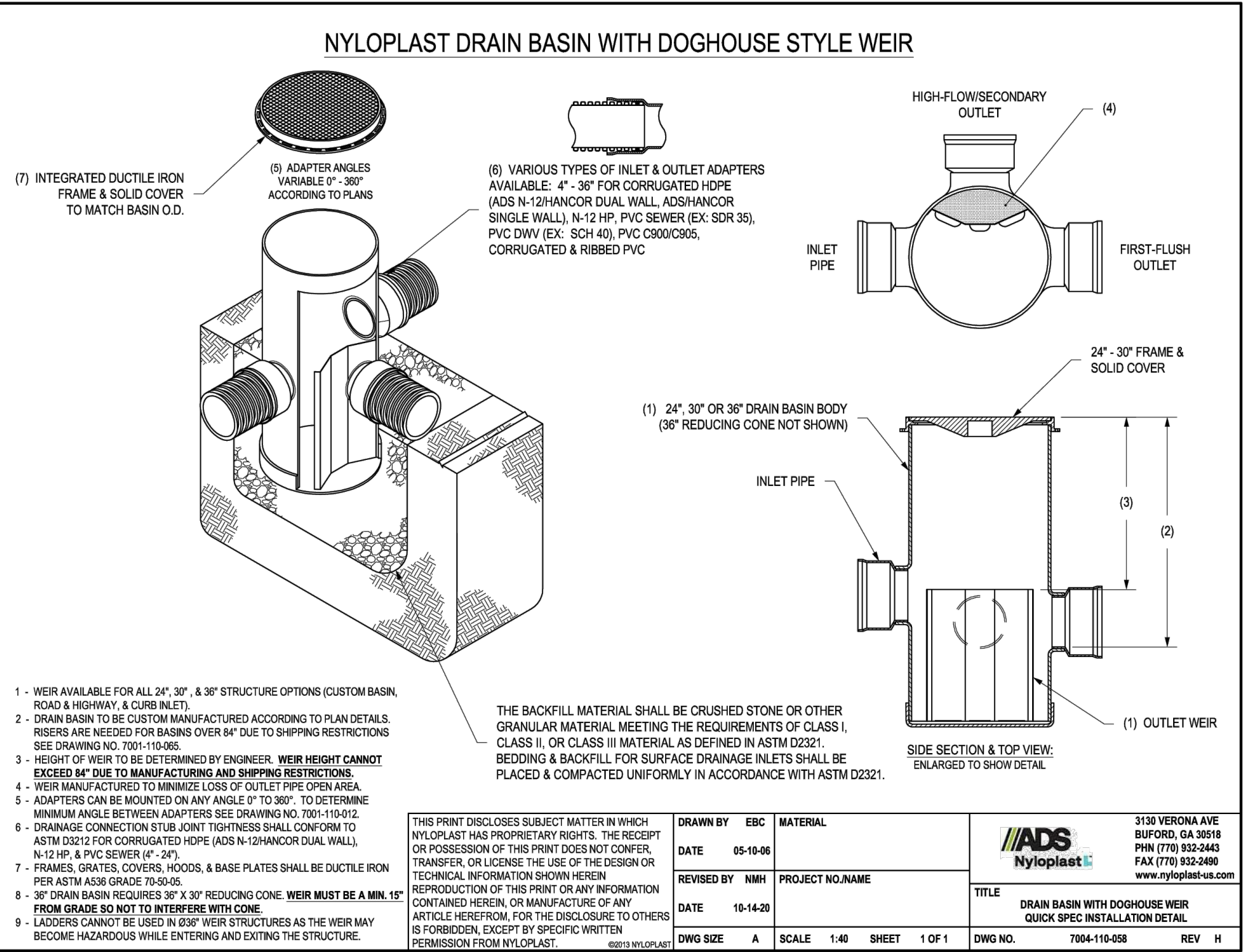

COPYRIGHT © 2025 - DYNAMIC ENGINEERING CONSULTANTS, PC - ALL RIGHTS RESERVED

Plotted: 04/14/25 - 11:07 AM, By: arajas
 File: P:\DEPCP PROJECTS\4477 Investments Limited\23-00284 Delroy Beach Dwg\Entitlements\D44772300284SD1.dwg, ---> C3.01 UTILITY DETAILS