

# LEGACY SIGNS OF TEXAS

**CUSTOMER APPROVAL:** Note: The colors depicted on this rendering may not match actual colors used on the finished display. Note: The proportion of signs shown on building and landscape area photos is an approximate representation.

**PLEASE READ CAREFULLY:** Before you OK this proof, please read your copy carefully and completely. Check for spelling errors and copy omissions. Any changes or alterations from the original instructions will be charged according to time and material.

**FINAL PROOF APPROVAL:** By signing this form I am approving the above described job and I hereby acknowledge that I have read and accept the proofing policy and Terms and Conditions of Legacy Signs of Texas. Please sign and return so that we may process your order.



# delray

---

## ORTHODONTICS

CLIENT SIGNATURE: \_\_\_\_\_

DATE: \_\_\_\_\_

7923 E. McKinney St., Denton, TX 76208  
O 817.431.5700 F 817.431.5799

UL E226292 TDLR - 18933

This drawing is the property of Legacy Signs & Electrical. All rights to its use for reproduction are reserved by Legacy Signs & Electrical.

**FINAL ELECTRICAL CONNECTION BY CUSTOMER**

THIS SIGN IS INTENDED TO BE INSTALLED IN ACCORDANCE WITH ARTICLE 600 OF THE NATIONAL ELECTRICAL CODE AND/OR OTHER APPLICABLE LOCAL CODES. THIS INCLUDES PROPER GROUNDING & BONDING OF THE SIGN. SIGN WILL BEAR UL LABEL(S).



7923 E. McKinney St., Denton, TX 76208

O 817.431.5700 F 817.431.5799

UL E226292 BBB TDLR 18933

| JOB DESCRIPTION     | ILLUMINATED CHANNEL LETTERS                    | DATE    | BY | REV      |  |
|---------------------|--|---------|----|----------|--|
| COMPANY OR JOB NAME | MB2_DELRAY ORTHODONTICS                        | 4.18.22 | AE | 5.19.22  | AE R1  |
| CUSTOMER CONTACT    |  |         |    | 6.6.22   | AE R2  |
| ADDRESS             | 10N SE 1ST AVE. STE B&C DELRAY BEACH, FL 33444 |         |    | 6.30.22  | AE R3  |
| PHONE               |  |         |    | 10.3.22  | AE R4  |
| EMAIL               |  |         |    | 12.07.22 | JR R5  |
| FILE NAME           | DELRAY ORTHODONTICS                            |         |    | 12.08.22 | JR R6  |
| SALESMAN            | ROGER CHUNG                                    |         |    | 12.13.22 | JR R7  |
|                     |  |         |    |          | REDUCE FRONT ELEVATION SIZE & PLACEMENT                |
|                     |  |         |    |          | ADD MEASUREMENTS TO WALL SIGN                          |
|                     |  |         |    |          | REMOVE INTERIOR WINDOW SIGNS & ADD WINDOW & DOOR VINYL |

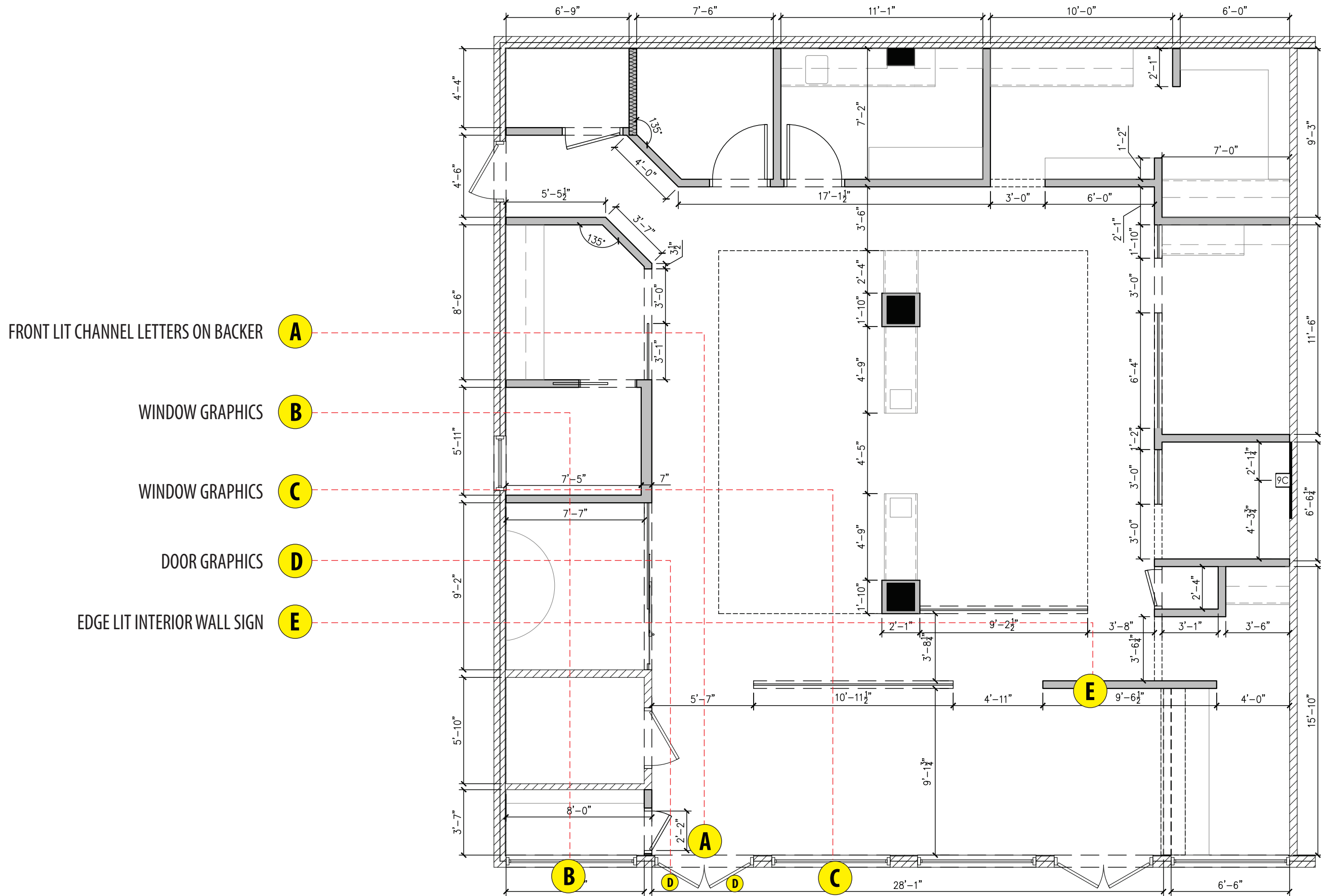

**SITE MAP**  
**SCALE: 3/16"=1'**



7923 E. McKinney St., Denton, TX 76208  
**0 817.431.5700 F 817.431.5799**  
**UL E226292 BBB TDLR 18933**

| JOB DESCRIPTION     | ILLUMINATED CHANNEL LETTERS                    | DATE     | BY | REV     |
|---------------------|--|----------|----|---------|
| COMPANY OR JOB NAME | MB2_DELRAY ORTHODONTICS                        | 4.18.22  | AE | 5.19.22 |
| CUSTOMER CONTACT    |  | 6.6.22   | AE | R1      |
| ADDRESS             | 10N SE 1ST AVE. STE B&C DELRAY BEACH, FL 33444 | 6.30.22  | AE | R2      |
| PHONE               |  | 10.3.22  | AE | R3      |
| EMAIL               |  | 12.07.22 | JR | R4      |
| FILE NAME           | DELRAY ORTHODONTICS                            | 12.08.22 | JR | R5      |
| SALESMAN            | ROGER CHUNG                                    | 12.13.22 | JR | R6      |
|                     |  |          |    | R7      |

REDUCE FRONT ELEVATION SIZE & PLACEMENT  
 ADD MEASUREMENTS TO WALL SIGN  
 REMOVE INTERIOR WINDOW SIGNS & ADD WINDOW & DOOR VINYL

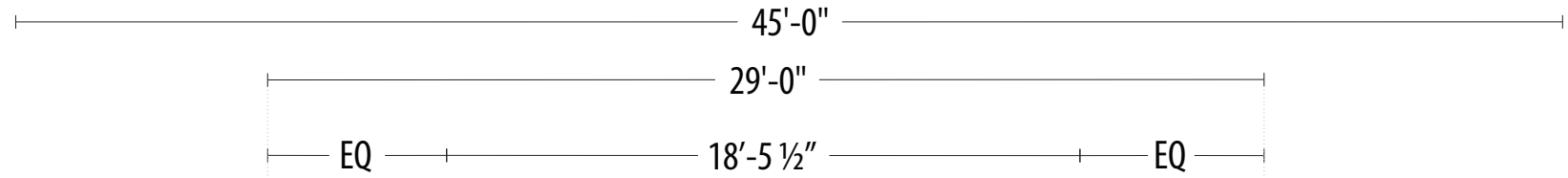

NIGHT VIEW



EXISTING

**A FRONT ELEVATION**

SCALE: 3/16" = 1'

BUILDING TO BE REPAINTED AND AWNINGS RECOVERED (BAY BLUE #2741)

49.22 SQ.FT



7923 E. McKinney St., Denton, TX 76208

O 817.431.5700 F 817.431.5799

UL E226292 BBB TDLR 18933

| JOB DESCRIPTION     | ILLUMINATED CHANNEL LETTERS                    | DATE     | BY | REV     |  |
|---------------------|--|----------|----|---------|--|
| COMPANY OR JOB NAME | MB2_DELRAY ORTHODONTICS                        | 4.18.22  | AE | 5.19.22 | AE R1  |
| CUSTOMER CONTACT    |  |          |    | 6.6.22  | AE R2  |
| ADDRESS             | 10N SE 1ST AVE. STE B&C DELRAY BEACH, FL 33444 | 6.30.22  | AE |         | R3   |
| PHONE               |  | 10.3.22  | AE |         | R4   |
| EMAIL               |  | 12.07.22 | JR |         | R5   |
| FILE NAME           | DELRAY ORTHODONTICS                            | 12.08.22 | JR |         | R6   |
| SALESMAN            | ROGER CHUNG                                    | 12.13.22 | JR |         | R7   |
|                     |  |          |    |         | REDUCE FRONT ELEVATION SIZE & PLACEMENT                |
|                     |  |          |    |         | ADD MEASUREMENTS TO WALL SIGN                          |
|                     |  |          |    |         | REMOVE INTERIOR WINDOW SIGNS & ADD WINDOW & DOOR VINYL |

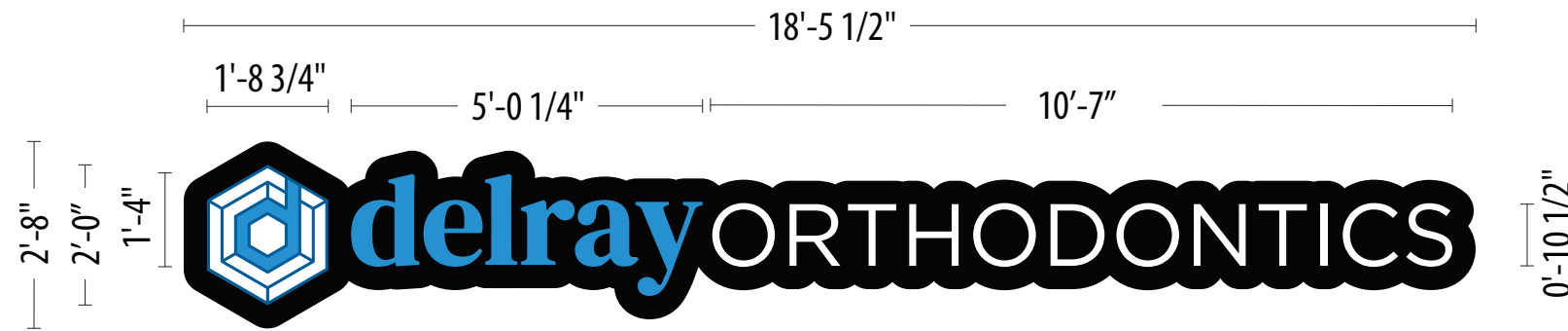

## ILLUMINATED CHANNEL LETTERS ON BACKER

SCALE: 3/8" = 1'

SCOPE OF WORK: MANUFACTURE & INSTAL ONE (1) SET OF NEW ILLUMINATED CHANNEL LETTERS ON BACKER W/ WIREWAY

49.22 SQ.FT

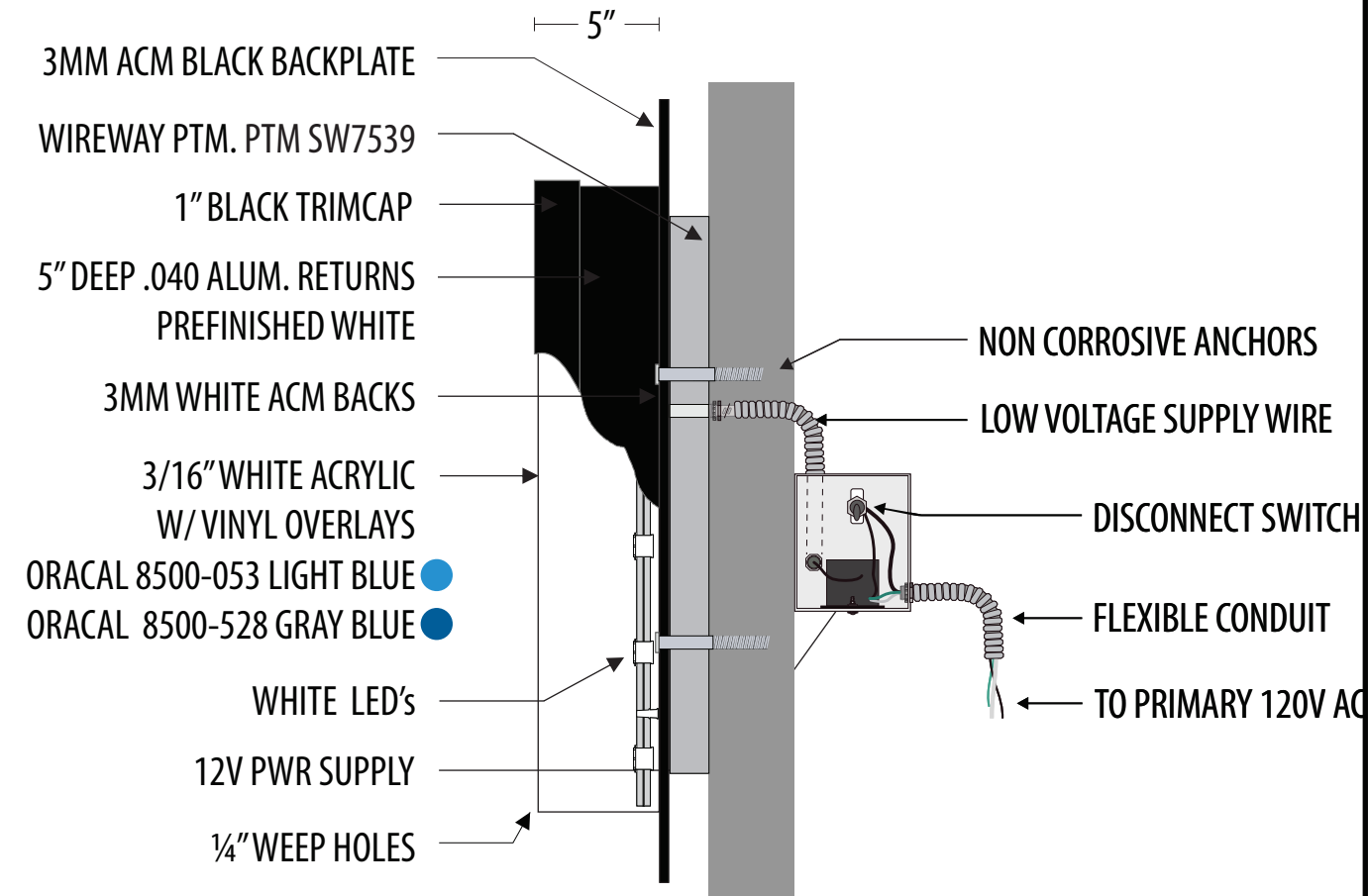

## FRONT LIT CHANNEL LETTERS ON BACKPLATE W/ WIREWAY

### ELECTRICAL NOTES

Sign Company DOES NOT provide primary electrical to sign. Power to the sign must be done by a licensed electrical contractor or licensed electrician.

- Each sign must have:**
1. A minimum of one dedicated 120V 20A circuit
  2. Junction box installed within 6 feet of sign
  3. Three wires: Line, Ground, Neutral



7923 E. McKinney St., Denton, TX 76208

0 817.431.5700 F 817.431.5799

UL E226292 BBB TDLR 18933

| JOB DESCRIPTION     | ILLUMINATED CHANNEL LETTERS                    | DATE     | BY | REV     |  |
|---------------------|--|----------|----|---------|--|
| COMPANY OR JOB NAME | MB2_DELRAY ORTHODONTICS                        | 4.18.22  | AE | 5.19.22 | AE R1  |
| CUSTOMER CONTACT    |  |          |    | 6.6.22  | AE R2  |
| ADDRESS             | 10N SE 1ST AVE. STE B&C DELRAY BEACH, FL 33444 | 6.30.22  | AE |         | R3   |
| PHONE               |  | 10.3.22  | AE |         | R4   |
| EMAIL               |  | 12.07.22 | JR |         | R5   |
| FILE NAME           | DELRAY ORTHODONTICS                            | 12.08.22 | JR |         | R6   |
| SALESMAN            | ROGER CHUNG                                    | 12.13.22 | JR |         | R7   |
|                     |  |          |    |         | REDUCE FRONT ELEVATION SIZE & PLACEMENT                |
|                     |  |          |    |         | ADD MEASUREMENTS TO WALL SIGN                          |
|                     |  |          |    |         | REMOVE INTERIOR WINDOW SIGNS & ADD WINDOW & DOOR VINYL |



EXISTING CONDITIONS

**B PROPOSED - WINDOW & DOOR VINYL**

SCALE: 1/2" = 1'

BUILDING TO BE REPAINTED AND AWNINGS RECOVERED (BAY BLUE #2741)

14.53 SQ.FT



7923 E. McKinney St., Denton, TX 76208

O 817.431.5700 F 817.431.5799

UL E226292 BBB TDLR 18933

| JOB DESCRIPTION     | ILLUMINATED CHANNEL LETTERS                    | DATE    | BY | REV      |  |
|---------------------|--|---------|----|----------|--|
| COMPANY OR JOB NAME | MB2_DELRAY ORTHODONTICS                        | 4.18.22 | AE | 5.19.22  | AE R1  |
| CUSTOMER CONTACT    |  |         |    | 6.6.22   | AE R2  |
| ADDRESS             | 10N SE 1ST AVE. STE B&C DELRAY BEACH, FL 33444 |         |    | 6.30.22  | AE R3  |
| PHONE               |  |         |    | 10.3.22  | AE R4  |
| EMAIL               |  |         |    | 12.07.22 | JR R5  |
| FILE NAME           | DELRAY ORTHODONTICS                            |         |    | 12.08.22 | JR R6  |
| SALESMAN            | ROGER CHUNG                                    |         |    | 12.13.22 | JR R7  |
|                     |  |         |    |          | REDUCE FRONT ELEVATION SIZE & PLACEMENT                |
|                     |  |         |    |          | ADD MEASUREMENTS TO WALL SIGN                          |
|                     |  |         |    |          | REMOVE INTERIOR WINDOW SIGNS & ADD WINDOW & DOOR VINYL |

1'-8 3/4"

1'-8 3/4"

6'-5 1/2"

0'-7 1/2"

1'-6"  
1'-9"



EXISTING CONDITIONS

C

### PROPOSED - WINDOW & DOOR VINYL

SCALE: 1/2" = 1'

BUILDING TO BE REPAINTED AND AWNINGS RECOVERED (BAY BLUE #2741)

14.53 SQ.FT



7923 E. McKinney St., Denton, TX 76208

**O 817.431.5700 F 817.431.5799**

**UL E226292 BBB TDLR 18933**

| JOB DESCRIPTION     | ILLUMINATED CHANNEL LETTERS                    | DATE     | BY | REV      |  |
|---------------------|--|----------|----|----------|--|
| COMPANY OR JOB NAME | MB2_DELRAY ORTHODONTICS                        | 4.18.22  | AE | 5.19.22  | AE R1  |
| CUSTOMER CONTACT    |  | 6.6.22   | AE | 6.6.22   | AE R2  |
| ADDRESS             | 10N SE 1ST AVE. STE B&C DELRAY BEACH, FL 33444 | 6.30.22  | AE | 6.30.22  | AE R3  |
| PHONE               |  | 10.3.22  | AE | 10.3.22  | AE R4  |
| EMAIL               |  | 12.07.22 | JR | 12.07.22 | JR R5  |
| FILE NAME           | DELRAY ORTHODONTICS                            | 12.08.22 | JR | 12.08.22 | JR R6  |
| SALESMAN            | ROGER CHUNG                                    | 12.13.22 | JR | 12.13.22 | JR R7  |
|                     |  |          |    |          | REDUCE FRONT ELEVATION SIZE & PLACEMENT                |
|                     |  |          |    |          | ADD MEASUREMENTS TO WALL SIGN                          |
|                     |  |          |    |          | REMOVE INTERIOR WINDOW SIGNS & ADD WINDOW & DOOR VINYL |

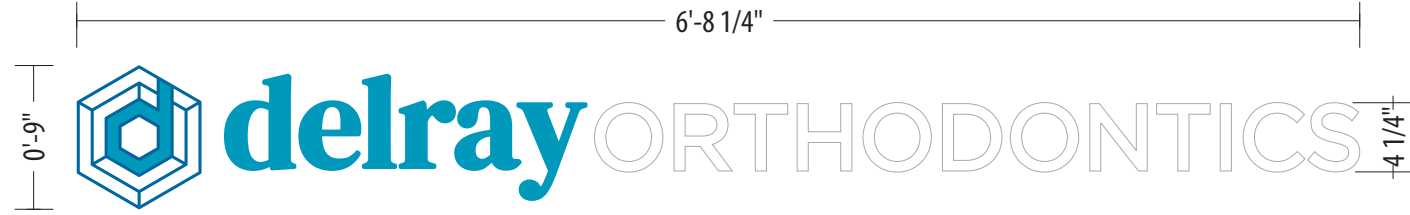

QTY:2 5 SQ. FT.



QTY:2 9.2 SQ. FT.



QTY:2

\*BLACK OUTLINE FOR VISUAL PURPOSE ONLY\*

**B C**

**WINDOW VINYL**

SCALE: 1" = 1'

SCOPE OF WORK:  
MANUFACTURE & INSTALL (4) FOUR RTA VINYL GRAPHICS FIRST SURFACE

- ORACAL 8500-053 LIGHT BLUE ●
- ORACAL 8500-528 GRAY BLUE ●
- ORACAL 751 BLACK ●

15.2 SQ.FT

**D**

**DOOR VINYL**

SCALE: 1 1/2" = 1'

SCOPE OF WORK:  
MANUFACTURE & INSTALL (2) TWO RTA DOOR VINYL GRAPHICS  
FIRST SURFACE

- ORACAL 8500-053 LIGHT BLUE ●
- ORACAL 8500-528 GRAY BLUE ●

1.08 SQ.FT (EA)



7923 E. McKinney St., Denton, TX 76208

0 817.431.5700 F 817.431.5799

UL E226292 BBB TDLR 18933

| JOB DESCRIPTION     | ILLUMINATED CHANNEL LETTERS                     | DATE    | BY | REV      |  |
|---------------------|---|---------|----|----------|--|
| COMPANY OR JOB NAME | MB2_DELRAY ORTHODONTICS                         | 4.18.22 | AE | 5.19.22  | AE R1  |
| CUSTOMER CONTACT    |   |         |    | 6.6.22   | AE R2  |
| ADDRESS             | 10N SE 1ST AVE., STE B&C DELRAY BEACH, FL 33444 |         |    | 6.30.22  | AE R3  |
| PHONE               |   |         |    | 10.3.22  | AE R4  |
| EMAIL               |   |         |    | 12.07.22 | JR R5  |
| FILE NAME           | DELRAY ORTHODONTICS                             |         |    | 12.08.22 | JR R6  |
| SALESMAN            | ROGER CHUNG                                     |         |    | 12.13.22 | JR R7  |
|                     |   |         |    |          | REDUCE FRONT ELEVATION SIZE & PLACEMENT                |
|                     |   |         |    |          | ADD MEASUREMENTS TO WALL SIGN                          |
|                     |   |         |    |          | REMOVE INTERIOR WINDOW SIGNS & ADD WINDOW & DOOR VINYL |