

ABBREVIATIONS/LEGEND	
NAVD-88	NORTH AMERICAN VERTICAL DATUM OF 1988
FLDEP	FLORIDA DEPARTMENT OF ENVIRONMENTAL PROTECTION
COE	CORPS OF ENGINEERS
PSM	PROFESSIONAL LAND SURVEYOR
PBCR	PALM BEACH COUNTY RECORDS
TYP	TYPICAL
APPROX	APPROXIMATE

HORIZONTAL SCALE: 1" = 10'  
0 5' 10' 20'  
INTENDED TO BE DISPLAYED AT THE ABOVE SCALE OR SMALLER TO BE PLOTTED LEDGER (11"x17")

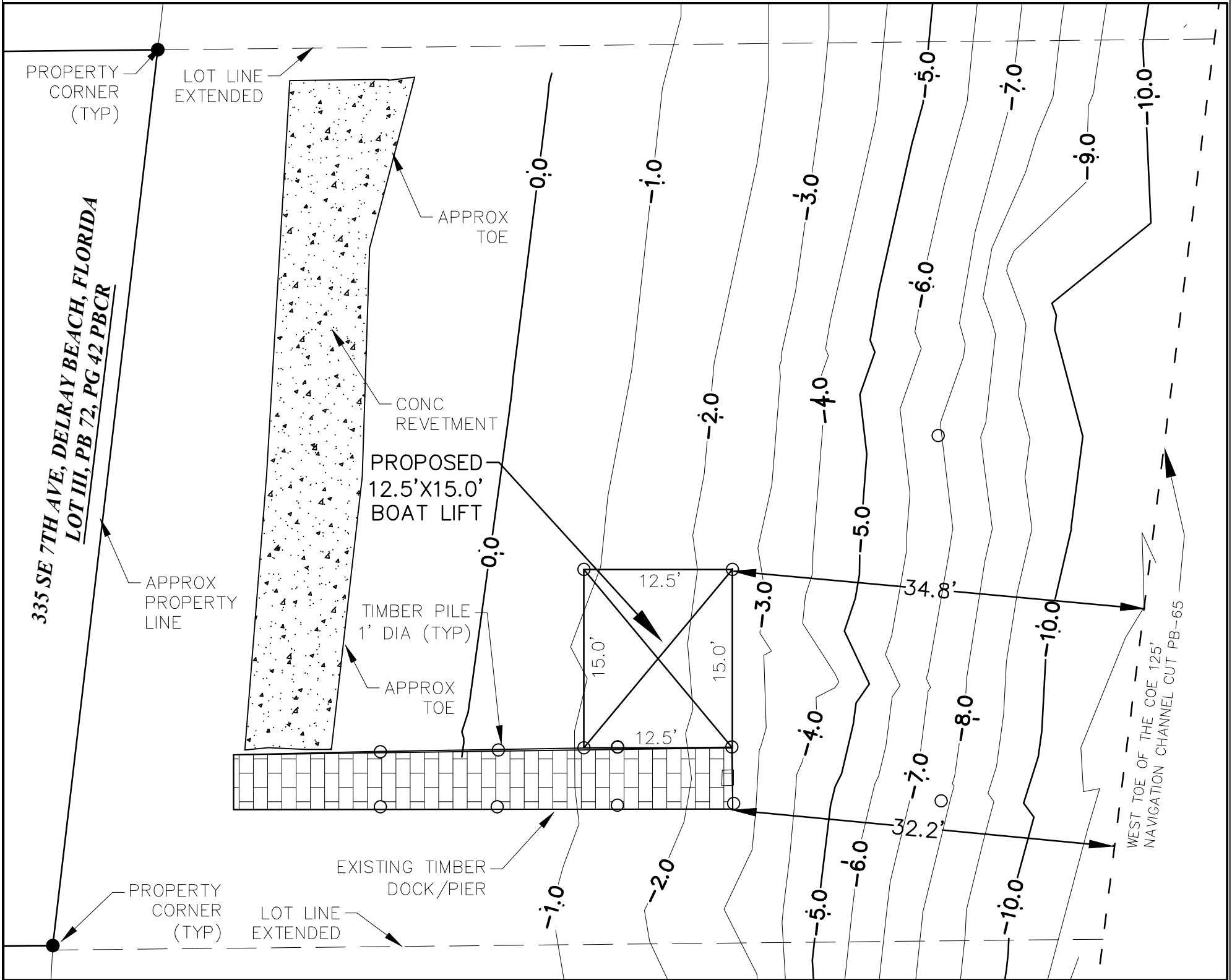
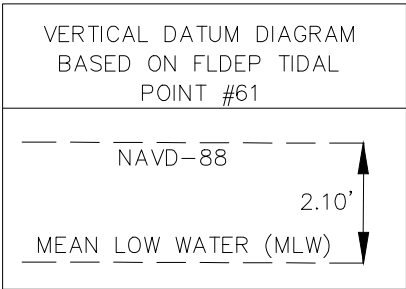
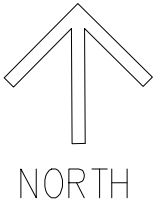

SURVEY NOTES:

- 1) LANDS SHOWN HEREON WERE NOT ABSTRACTED FOR OWNERSHIP, RIGHT OF WAYS, EASEMENTS OR ANY OTHER INSTRUMENTS OF RECORD OTHER THAN THOSE SHOWN ON THE REFERENCED PLAT.
- 2) THIS IS NOT A BOUNDARY SURVEY
- 3) ANY ELEVATIONS AND CONTOURS SHOWN HEREON ARE RELATIVE TO MEAN LOW WATER (MLW) AND BASED ON GPS OBSERVATIONS UTILIZING THE FLORIDA DEPARTMENT OF TRANSPORTATION'S PERMANENT REFERENCE SYSTEM.
- 4) ADDITIONS OR DELETIONS TO THIS SURVEY BY OTHER THAN THE SIGNING LICENSED SURVEYOR ARE PROHIBITED WITHOUT WRITTEN CONSENT.
- 5) THE LAND DESCRIPTION SHOWN HEREON WAS PROVIDED BY THE CLIENT.
- 6) UNDERGROUND FOUNDATIONS WERE NOT LOCATED.
- 7) THIS SURVEY OR COPIES THEREOF ARE NOT VALID WITHOUT THE SIGNATURE AND THE ORIGINAL RAISED SEAL OF UNDERSIGNED.
- 8) CONTOURS UNDER THE EXISTING TIMBER DOCK/PIER ARE INTERPOLATED AND CURRENT CONDITIONS COULD DIFFER.
- 9) UNLESS OTHERWISE NOTED CONTOURS ARE BELOW THE DATUM (MLW) UNLESS PRECEDED BY A PLUS (+) SIGN.

LEGAL DESCRIPTION:

LOT 5 IN BAL HARBOUR, ACCORDING TO THE PLAT THEREOF, AS RECORDED IN PLAT BOOK 40, PAGE 47, OF THE PUBLIC RECORDS OF BROWARD COUNTY, FLORIDA.

CERTIFICATION:

I HEREBY CERTIFY THAT THIS HYDROGRAPHIC SURVEY IS TRUE AND CORRECT TO THE BEST OF MY KNOWLEDGE AND BELIEF AS PREPARED UNDER MY DIRECTION ON FEBRUARY 11TH, 2022. I FURTHER CERTIFY THAT THIS BOUNDARY SURVEY MEETS THE FLORIDA MINIMUM TECHNICAL STANDARDS SET FORTH IN CHAPTER 5J-17 ADOPTED BY THE FLORIDA BOARD OF PROFESSIONAL SURVEYORS AND MAPPERS, PURSUANT TO FLORIDA STATUTES 472.027.

STAN D. COPELAND, PSM  
FLORIDA REGISTRATION NUMBER 6797  
FEBRUARY 12TH 2022

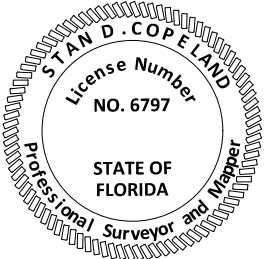

PREPARED BY:

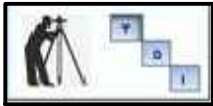

TECHNICAL DISCIPLINES, INC. (LB 8123)  
1533 SE 8TH TERRACE  
DEERFIELD BEACH, FLORIDA 33441  
954-850-2008

HYDROGRAPHIC SURVEY

A PORTION OF THE  
INTRACOASTAL WATERWAY  
SECTION 16, TOWNSHIP 46 SOUTH  
RANGE 43 EAST

DATE	2/12/22
DRAWN BY	SC/JC
F.B./ PG.	ELEC
SCALE	AS SHOWN
JOB NO.	TDI-1027