

LIGHTING FIXTURE SCHEDULE (SITE)										
LABEL	DESCRIPTION	MFG.	MODEL NUMBER	MOUNTING	LAMP QTY AND TYPE	DIMMING	VOLTS	TOTAL FIXTURE WATTS	NOTES (REFER TO GENERAL AND LAMP AND BALLAST NOTES BELOW)	
1P4D	LED FULL CUTOFF AREA LUMINAIRE, 10000 LUMENS, FORWARD DISTRIBUTION, ALUMINUM HOUSING, UL LISTED FOR WET LOCATION. 1-HEAD	GE / LSI(POLE)	FIXTURE: EALS 03 0 D4 AF 7 40 N D D1 DKB	POLE MOUNT, **SEE E-012 DETAIL 1 FOR POLE HEIGHT	LED	-	208 V	70 VA		
1P4DB	LED FULL CUTOFF AREA LUMINAIRE, 10000 LUMENS, FORWARD DISTRIBUTION, ALUMINUM HOUSING, UL LISTED FOR WET LOCATION. 1-HEAD WITH BACK SHIELD	GE	EALS 03 0 D4 AF 7 40 N D D1 DKBZ SHIELD: ELS-EAL-FBL-BLCK	POLE MOUNT, **SEE E-012 DETAIL 1 FOR POLE HEIGHT	LED	-	208 V	70 VA		
2P4F	LED FULL CUTOFF AREA LUMINAIRE, 15000 LUMENS, FORWARD DISTRIBUTION, ALUMINUM HOUSING, UL LISTED FOR WET LOCATION. 2-HEAD, 180° CONFIGURATION	GE	EALS 03 0 F4 AF 7 40 N D D1 DKBZ	POLE MOUNT, **SEE E-012 DETAIL 1 FOR POLE HEIGHT	LED	-	208 V	232 VA		
0	LED 12"x12" SQUARE LENSED RECESSED LUMINAIRE, TEMPERED GLASS LENS, TRIM FINISHED IN MATT WHITE COLOR. U.L. LISTED WET LOCATION	LSI	XSPS-S-LED-SS-NW-120-GWT-DFL	RECESSED	LED	-	120 V	31 VA		
DP	DRIVE-THRU CANOPY OPEN/CLOSE LED SIGN	DIRECTIONAL SYSTEMS	5887 (TCL718GR-100/120-27V/VAC)	SURFACE	LED	-	120 V	5 VA	REFER TO THE ARCHITECTURAL DRAWING FOR MOUNTING HEIGHT	
DPA	DRIVE-THRU CANOPY ATM LED SIGN	DIRECTIONAL SYSTEMS	TCL718G-125-120-27V/VAC	SURFACE	LED	-	120 V	20 VA	REFER TO THE ARCHITECTURAL DRAWING FOR MOUNTING HEIGHT	
H5	LED FULL CUTOFF POST TOP LIGHT POLE FIXTURE, TYPE 5 DISTRIBUTION.	GE / LSI(POLE)	FIXTURE: EPTC-02-0-03-A-40-1-A-DKB	POST TOP POLE MOUNT, **SEE E-012 DETAIL 3 FOR POLE HEIGHT	LED	-	208 V	27 VA		
WM4	WALL BRACKET LED LUMINAIRE, DIE CAST ALUMINUM HOUSING, TYPE 4 DISTRIBUTION, DARK BRONZE FINISH, FULL CUTOFF.	LSI	XWM 4 LED 3L 40 UE BRZ	WALL MOUNTED	LED	-	120 V	23 VA	SEE E-130 FOR CONNECTION	

1. MANUFACTURER CATALOG NUMBERS ARE SHOWN FOR GENERAL DESCRIPTIVE PURPOSES AND TO ESTABLISH STANDARD OF QUALITY ONLY. CONTACT CHRIS YOUNG (young@southernlightingsource.com) OR ADAM MAGGIO (amaggio@southernlightingsource.com) (770-242-4000) (531lghts@southernlightingsource.com) SOUTHERN LIGHTING SOURCE ON LIGHTING AND LIGHTING CONTROLS. GC/EC SHALL PROVIDE LUMINAIRES COMPLETE WITH ALL OPTIONS AND ACCESSORIES REQUIRED FOR A COMPLETE INSTALLATION. ALL PRODUCTS SHALL BE UL LISTED. POLE MOUNTED LIGHT FIXTURES SHALL MATCH EXISTING DEVELOPMENT AS SPECIFIED. NO EQUALS FOR POLE MOUNTED FIXTURES.
2. POLE MANUFACTURER SHALL COORDINATE WITH LUMINAIRE MANUFACTURER TO PROVIDE ADEQUATE STRENGTH TO SUPPORT THE FIXTURE. PROVIDE APPROPRIATE MOUNTING HARDWARE, ANCHOR BOLTS, BOLT/BASEPLATE COVERS AND GROUNDING LUG. MANUFACTURER SHALL FURNISH AN ANCHOR BOLT TEMPLATE TO ENSURE PROPER MOUNTING AND LUMINAIRE ORIENTATION FOR CORRECT LIGHT DISTRIBUTION. APPROVED EQUAL POLE MANUFACTURERS: DURAGUARD AND VALMONT.
3. REFER TO ELECTRICAL SPECIFICATIONS FOR ADDITIONAL REQUIREMENTS WHICH MAY NOT NECESSARILY BE REFLECTED IN CATALOG NUMBER AND/OR DESCRIPTION IN THIS SCHEDULE

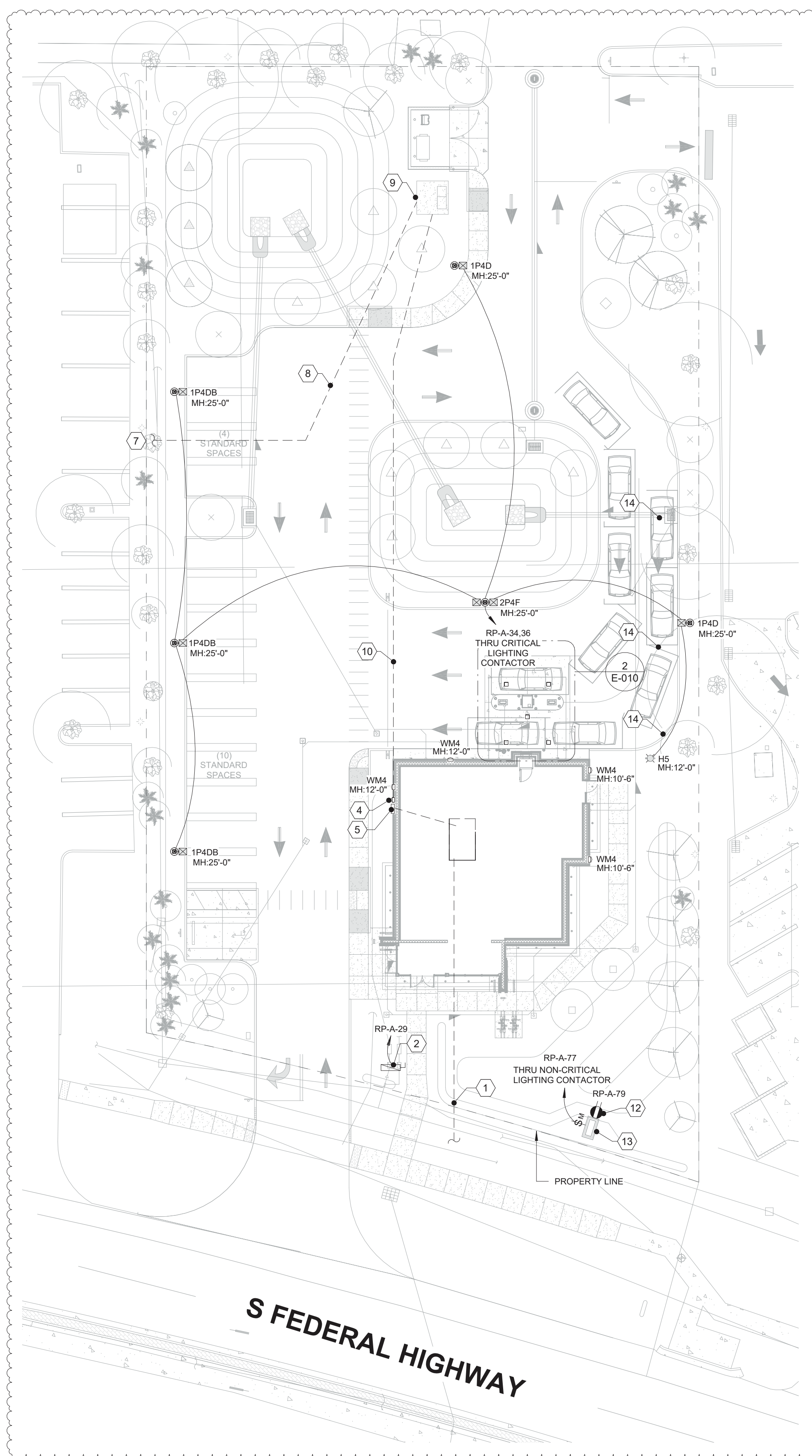

- 1 ROUTE (2"-4") TO MAIN TELEPHONE SERVICE ENTRANCE. ROUTE TO CLEAR STRUCTURAL FOOTING. CONDUITS SHALL BE STUBBED UP AND CAPPED 12" A.F.F. IN BUILDING. AS-BUILT DRAWINGS MUST SHOW CONDUIT LENGTH AND ROUTE.
- 2 IRRIGATION BACKFLOW. VERIFY LOCATION - DISCONNECT SHALL BE NEMA 3R
- 3 NOT USED.
- 4 ELECTRIC UTILITY METER. PROVIDE ELECTRIC UTILITY METER PER POWER COMPANY REQUIREMENTS. REFER TO ELECTRICAL RISER DIAGRAM FOR ADDITIONAL INFORMATION. EXACT LOCATION TO BE DETERMINED BY UTILITY COMPANY REPRESENTATIVE IN FIELD.
- 5 MANUAL TRANSFER SWITCH(MTS), PROPOSED ELECTRICAL SERVICE DISCONNECT MOUNTED ON BUILDING EXTERIOR. REFER TO ELECTRICAL RISER DIAGRAM FOR ADDITIONAL INFORMATION.
- 6 DRIVE-THRU ATM. PROVIDE CONDUIT AND WIRING FOR ATM. REFER TO ELECTRICAL FLOOR PLAN ON SHEET E-500 FOR ADDITIONAL INFORMATION.
- 7 STUB-OUT AND TERMINATE PER UTILITY COMPANY REQUIREMENTS. VERIFY LOCATION OF HIGH VOLTAGE SERVICE POINT PRIOR TO BIDDING AND INCLUDE ALL COST IN BID.
- 8 (2")-5" FOR HIGH VOLTAGE SERVICE FROM PROPERTY LINE TO TRANSFORMER SLABS - VERIFY LOCATION AND ROUTING. HIGH VOLTAGE CONDUIT SHALL BE 48" MIN. TERMINATE IN ACCORDANCE WITH UTILITY COMPANY REQUIREMENTS INCLUDING TRENCHING AND BACKFILL TO 90% COMPACTION
- 9 TRANSFORMER SLAB-BOX WITH TRAFFIC GUARDS PER UTILITY COMPANY REQUIREMENTS. VERIFY SIZE, LOCATION AND ORIENTATION WITH UTILITY COMPANY. CONTRACTOR WILL PROVIDE TRANSFORMER SLABS INSTALLED COMPLETE IN ACCORDANCE WITH UTILITY COMPANY REQUIREMENTS. PROVIDE ADEQUATE GUARD RAILING AROUND POWER TRANSFORMERS IN PARKING AREAS.
- 10 SECONDARY FROM TRANSFORMER TO MAIN DISCONNECT. VERIFY ROUTING WITH UTILITY COMPANY AND ROUTE TO CLEAR STRUCTURAL FOOTING. SEE RISER DIAGRAM. TERMINATE IN ACCORDANCE WITH PLANS AND SPECIFICATIONS.
- 11 DRIVE THROUGH LANE OPEN/CLOSE GANG SWITCHES. PROVIDE CONSTANT HOT & NEUTRAL. LCP SHALL NOT CONTROL OPEN/CLOSE/ATM SIGNS. SEE DETAIL 3 ON E-501. COORDINATE PLACEMENT WITH ARCHITECT PRIOR TO ROUGH-IN.
- 12 MAINTENANCE RECEPTACLE: PROVIDE 120V, 20A, GFCI WEATHER-RESISTANT DUPLEX RECEPTACLE IN WEATHERPROOF SURFACE MOUNTED BELL BOX WITH "EXTRA DUTY WHILE-IN-USE" METALLIC COVER.
MONUMENT SIGN POWER: COORDINATE EXACT LOCATION OF SIGNAGE STUB-UP WITH SIGN VENDOR AND MAKE FINAL ELECTRICAL CONNECTIONS. PROVIDE 120V, 20A, TOGGLE SWITCH IN METALLIC BELL BOX WITH METALLIC WEATHERPROOF COVER IF IN ACCORDANCE WITH UTILITY COMPANY WITH MONUMENT SIGN. COORDINATE EXACT LOCATION WITH CIVIL DRAWINGS.
- 14 TREE TRIMMING: VERIFY ALL LANDSCAPE WITH COMPLIANCE AREA (OR LANDSCAPE AFFECTING LIGHT FIXTURES WITHIN THE COMPLIANCE AREA) IS TRIMMED/PRUNED/THINNED OUT PER OWNER'S LANDSCAPE STANDARDS AND IF POSSIBLE, A MINIMUM OF 5 FT IS MAINTAINED FROM ALL TREES TO LIGHT FIXTURE. EXISTING TREE SHALL BE PRUNED, THINNED OUT AS NEEDED TO PREVENT SHADING EFFECTS WITHIN COMPLIANCE AREA ALLOWING OPTIMAL LIGHTING PERFORMANCE. COORDINATE WITH GENERAL CONTRACTOR FOR RESPONSIBILITIES AND SCHEDULING.

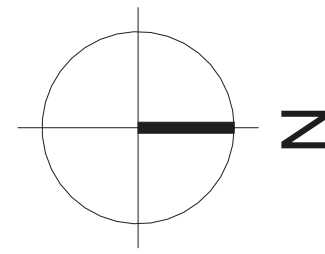

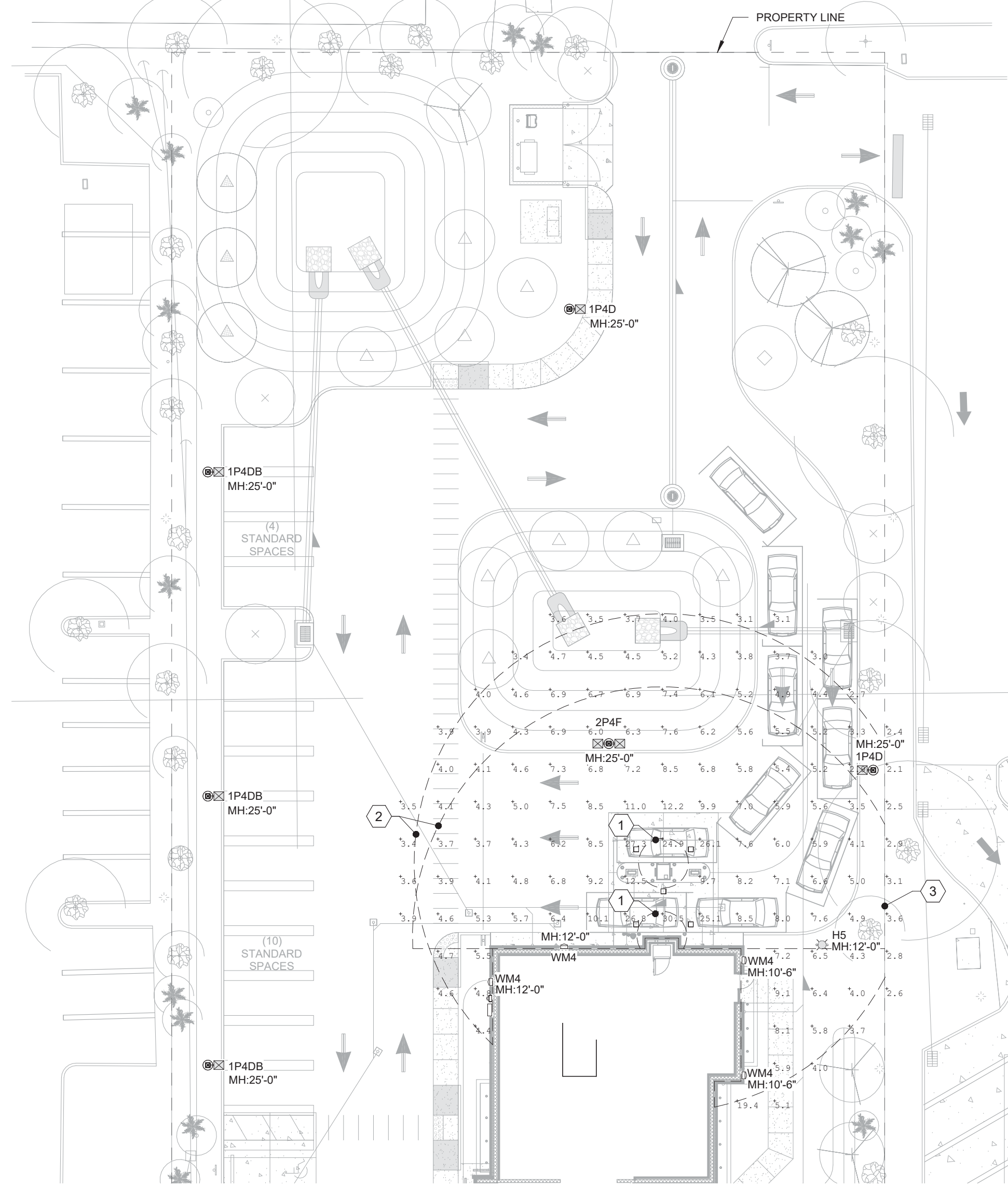

② ELECTRICAL PHOTOMETRIC SITE PLAN AT 3'-0"
1" = 20'-0"

CALCULATION SUMMARY AT 36" AFG							
LABEL	CALCTYPE	UNIT	AVG	MAX	MIN	AVG/MIN	MAX/MIN
DRIVE-UP ATM - 5FT COMPLIANCE	ILLUMINANCE	FC	27.81	34.10	15.70	1.77	2.17
DRIVE-UP ATM - 50FT COMPLIANCE	ILLUMINANCE	FC	8.19	58.60	2.20	3.72	26.64
NIGHT DEPOSITORY - 5FT COMPLIANCE	ILLUMINANCE	FC	25.51	32.30	12.90	1.98	2.50
NIGHT DEPOSITORY - 50FT COMPLIANCE	ILLUMINANCE	FC	8.75	37.10	2.60	3.37	14.27

Calculation Summary at Grade							
Label	Calctype	Unit	Avg	Max	Min	Avg/Min	Max/Min
Property Line Measured at 6ft Above Grade	ILLUMINANCE	FC	0.25	2.90	0.00	N.A.	N.A.
Commercial Parking Lots Area	ILLUMINANCE	FC	3.27	11.80	1.00	3.27	11.80
Canopies, Drive-Thru	ILLUMINANCE	FC	19.94	27.00	9.80	2.03	2.76

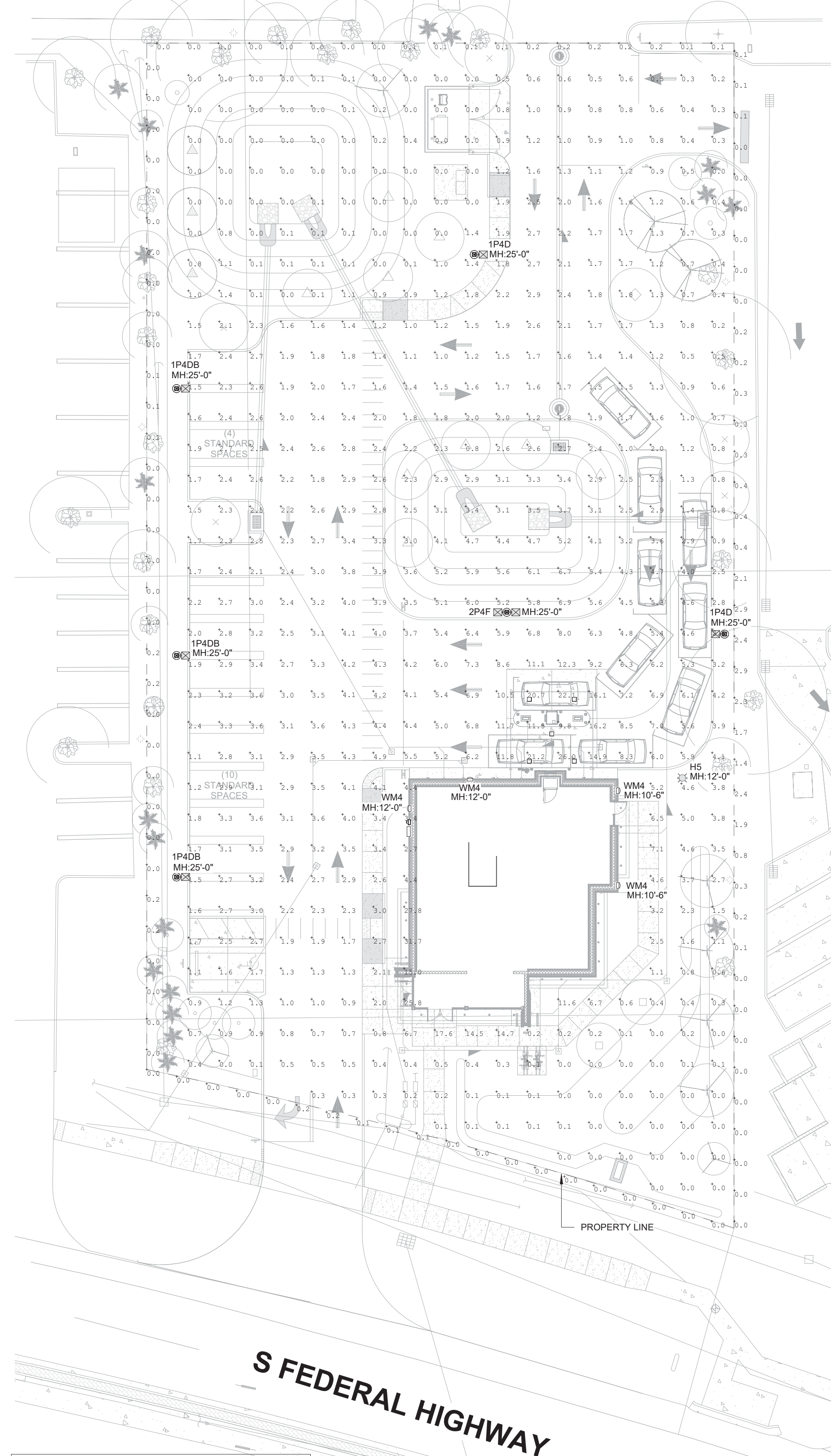

NOTE : ALL EXTERIOR LIGHTS ARE FULL CUTOFF

1 ELECTRICAL PHOTOMETRIC SITE PLAN AT GRADE
1" = 20'-0"

- SHEET NOTES:**

1. PHOTOMETRY CALCULATION: PHOTOMETRIC VALUES SHOWN HEREIN ARE INTENDED FOR DESIGN AND EVALUATION PURPOSES ONLY. THE CALCULATED POINT-BY-POINT VALUES SHOWN ON THIS SHEET ARE BASED ON A COMPUTER LIGHTING PROGRAM WITH APPROXIMATED PARAMETERS. AS A RESULT, PHOTOMETRIC VALUES MAY VARY FROM ACTUAL FIELD MEASUREMENTS.

LIGHTING STANDARDS:

MINIMUM STANDARD

REGULATED STATES: ALABAMA, CALIFORNIA, CONNECTICUT, DISTRICT OF COLUMBIA, FLORIDA, GEORGIA, ILLINOIS, KANSAS, KENTUCKY, LOUISIANA, MARYLAND, MASSACHUSETTS, MISSOURI, MONTANA, NEVADA, NEW HAMPSHIRE, NEW JERSEY, NEW YORK, OREGON, RHODE ISLAND, TEXAS, VIRGINIA, WASHINGTON, VIRGINIA**.

- BANKING CENTERS IN VIRGINIA MUST COMPLY WITH ALL HOME STATE LAWS AND IS CONSIDERED REGULATED IF THE BANK HEADQUARTERS ARE LOCATED IN A REGULATED STATE.
- A MINIMUM OF TEN (10) FOOT CANDLE POWER AT THE FACE OF THE ATM OR AFTER-HOUR DEPOSITORY EXTENDING OUTWARD FIVE (5) FEET IN ALL UNOBSTRUCTED DIRECTIONS.
- A MINIMUM OF TWO (2) FOOT CANDLE POWER EXTENDING OUTWARDS IN ALL UNOBSTRUCTED DIRECTIONS FIFTY (50) FEET FROM THE FACE OF THE ATM AND AFTER-HOUR DEPOSITORY.
- A MINIMUM OF TWO (2) FOOT CANDLE POWER IN DEFINED PARKING AREAS WITHIN SIXTY (60) FEET OF THE ATM AND AFTER-HOUR DEPOSITORY. IN THE EVENT THE ATM OR AFTER-HOUR DEPOSITORY IS LOCATED WITHIN TEN (10) FEET OF THE CORNER OF THE BUILDING AND IS GENERALLY ACCESSIBLE FROM THE CORNER OF THE BUILDING, THERE SHALL BE A MINIMUM OF TWO (2) FOOT CANDLE POWER ALONG THE FIRST FORTY (40) UNOBSTRUCTED FEET OF THE ADJACENT SIDE OF THE BUILDING.
- IF THE ATM OR AFTER-HOUR DEPOSITORY IS LOCATED INSIDE A DEFINED VESTIBULE DURING ANY HOURS OF DARKNESS, A MINIMUM OF 10 FOOT CANDLE POWER AT THE FACE OF THE ATM OR AFTER-HOUR DEPOSITORY EXTENDING OUTWARD FIVE (5) FEET IN ALL UNOBSTRUCTED DIRECTIONS. THERE WILL BE A MINIMUM OF TWO (2) FOOT CANDLE POWER AT THE INSIDE OF THE VESTIBULE ENTRY/EXIT DOOR. A MINIMUM OF TWO (2) FOOT CANDLE POWER EXTENDING OUTWARDS IN ALL UNOBSTRUCTED DIRECTIONS FIFTY (50) FEET FROM THE VESTIBULE ENTRY/EXIT DOOR. A MINIMUM OF TWO (2) FOOT CANDLE POWER IN DEFINED PARKING AREAS WITHIN SIXTY (60) FEET OF THE VESTIBULE ENTRY/EXIT DOOR. IN THE EVENT THE VESTIBULE ENTRY/EXIT DOOR IS LOCATED WITHIN TEN (10) FEET OF THE CORNER OF THE BUILDING AND IS GENERALLY ACCESSIBLE FROM THE ADJACENT SIDE, THERE SHALL BE A MINIMUM OF TWO (2) FOOT CANDLE POWER ALONG THE FIRST FORTY (40) UNOBSTRUCTED FEET OF THE ADJACENT SIDE OF THE BUILDING. IN URBAN SETTINGS FOR WHICH THERE IS NO DEFINED BANK PARKING AREA, THERE SHALL BE A MINIMUM OF TWO (2) FOOT CANDLE POWER ALONG THE FIRST FORTY (40) UNOBSTRUCTED FEET OF THE ADJACENT SIDE OF THE BUILDING. A MINIMUM 2 FOOT CANDLE POWER SHALL BE FOR THE FIRST 5 UNOBSTRUCTED FEET FROM THE DOOR. THE MINIMUM FOOT CANDLE READING WILL ALSO BE LIMITED TO BANK CONTROLLED PROPERTY LINES.
- A MINIMUM OF TWO (2) FOOT CANDLE POWER IN THE IMMEDIATE AREA OF THE DESIGNATED ASSOCIATE ENTRANCE/EXIT TO THE FACILITY. ALL LIGHTING MEASUREMENTS ARE TO BE TAKEN AT 36 INCHES ABOVE THE GROUND ON A HORIZONTAL PLANE, **UNLESS OTHERWISE SPECIFIED BY STATE LAW OR REGULATION (3/07).**
- THE MINIMUM STANDARD SHALL APPLY UNLESS A GREATER STANDARD IS REQUIRED BY AN APPLICABLE LAW FOR A PARTICULAR FACILITY LOCATION.

KEYED NOTES:

- ① ATM/AFTER-HOUR DEPOSITORY FIVE (5) FOOT COMPLIANCE AREA: A MINIMUM OF TEN (10) FOOT CANDLE POWER AT THE FACE OF THE ATM/AFTER-HOUR DEPOSITORY EXTENDING OUTWARD FIVE (5) FEET IN ALL UNOBSTRUCTED DIRECTIONS.
- ② ATM/AFTER-HOUR DEPOSITORY FIFTY FOOT COMPLIANCE AREA: A MINIMUM OF TWO (2) FOOT CANDLE POWER EXTENDING OUTWARD IN ALL UNOBSTRUCTED DIRECTIONS FIFTY (50) FEET FROM THE FACE OF THE ATM AND AFTER-HOUR DEPOSITORY.
- ③ BANK CONTROLLED PROPERTY LINES: THE MINIMUM FOOT CANDLE READING WILL BE LIMITED TO BANK CONTROLLED PROPERTY LINES.

bdg
architects

550 S. Caldwell Street
Suite 1800
Charlotte, NC 28202



FIFTH THIRD
DELRAY BEACH
1820 SOUTH FEDERAL HIGHWAY
DELRAY BEACH, FLORIDA 33483

THESE DRAWINGS, PLANS, ANY REPRODUCTION THEREOF, AND ANY CAD OR ELECTRONIC FILE OF THESE DRAWINGS AND PLANS HEREINAFTER "PLANTS" ARE THE SOLE AND EXCLUSIVE, PROPRIETARY PROPERTY OF BGC ARCHITECTS, AND MAY NOT BE REPRODUCED, COPIED, EITHER WHOLLY OR IN PART, OR OTHERWISE EXPRESS WRITTEN PERMISSION OF BGC ARCHITECTS. USE OF THESE PLANS FOR ANY PURPOSE OTHER THAN THAT AUTHORIZED BY BGC ARCHITECTS HEREIN AND THE SUITABILITY AND CONSTRUCTIBILITY OF THE PLANS, THE PLANS SHALL NOT BE SEALED OR MODIFIED FOR ANY PURPOSE WITHOUT THE EXPRESS WRITTEN APPROVAL OF BGC ARCHITECTS. ANY SUCH ALTERATION, REVISION, OR MODIFICATION, WITHOUT THE EXPRESS WRITTEN APPROVAL OF BGC ARCHITECTS, SHALL BE AT THE USER'S SOLE RISK, REGARDLESS OF HOW MINOR. WITHOUT THE EXPRESS WRITTEN APPROVAL OF BGC ARCHITECTS, THE USER SHALL NOT BE ENTITLED TO REPRODUCE, COPY, OR OTHERWISE EXPRESS WRITTEN APPROVAL OF BGC ARCHITECTS; OR ANY CHANGE IN THE SCOPE, DESIGN, OR INTENT OF THESE PLANS FOR ANY REASON, BY ANY PERSON OTHER THAN BGC ARCHITECTS. THE USER SHALL BE RESPONSIBLE FOR ANY VIOLATIONS OR OBLIGATIONS BGC ARCHITECTS MAY HAVE ON THE PROJECT, AND RESULT IN THE FULL AND COMPLETE RELEASE OF BGC ARCHITECTS FROM ANY LIABILITY, INCLUDING BUT NOT LIMITED TO, THE USER'S NEGLIGENCE, NEGLIGENCE OF ANY OTHER PARTY RELATED TO THE PLANS, ANY DISCREPANCIES OR CONFLICTS IN THE PLANS SHALL BE THE USER'S SOLE RESPONSIBILITY. THE USER SHALL BE RESPONSIBLE FOR CONTINUING WITH THE WORK, FAILURE TO RESOLVE DISCREPANCIES OR CONFLICTS TO BGC ARCHITECTS PRIOR TO PERFORMING WORK SHALL RESULT IN THE WAIVER OF ANY RIGHTS OR CLAIMS AGAINST BGC ARCHITECTS. THE USER'S NEGLIGENCE, NEGLIGENCE OF ANY OTHER PARTY, OR THE CONTRACTOR'S RESPONSIBILITY FOR THE COORDINATION. BGC ARCHITECTS SHALL NOT BE RESPONSIBLE FOR ANY VIOLATIONS OR OBLIGATIONS BY SUBCONTRACTORS OR OTHER TRADES WITH THE DESIGN DOCUMENTS.

SEAL	ANDREW MOH FL PE# 73077
------	----------------------------

This item has been electronically signed and sealed by Andrew Mohr, P.E. on the date and/or time stamp shown using a digital signature. Printed copies of this document are not considered signed and sealed and the signature must be verified by a 3rd Party Certificate Authority on

INFINITY
INFINITY ENGINEERING
GROUP, LLC

Infinity Engineering Group
1208 East Kennedy Boulevard,
Suite 230
Tampa, Florida 33602
Phone: 813.434.4770
E Cert of Auth# 27889

[illegible]

PROJECT INFORMATION BLOCK									
---------------------------	--	--	--	--	--	--	--	--	--

JOB #	240661/15-386.00
DATE:	10/01/2025
DRAWN BY:	KL
CHECKED BY:	AM

SHEET TITLE	
-------------	--

ELECTRICAL PHOTOMETRIC SITE PLAN

SHEET NUMBER

E-011

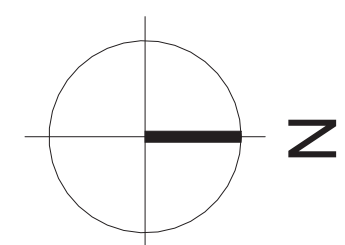

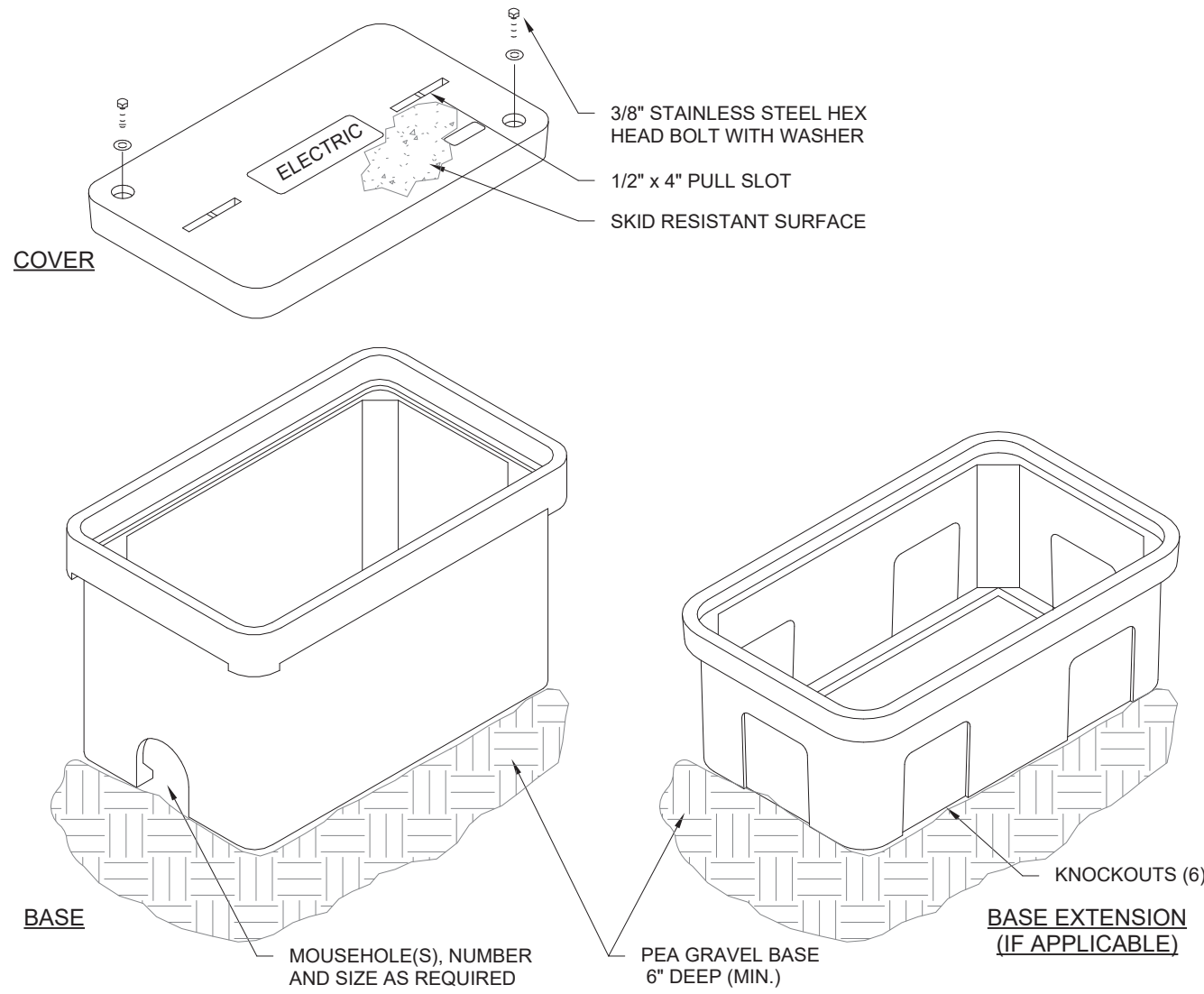

- NOTES:
1. PROVIDE STANDARD POLYMER CONCRETE HAND HOLE SIZED PER NEC. COVER COLOR SHALL MATCH EXISTING.
 2. PROVIDE 1" X 3/8" BELL PULL SLOT FOR EACH HAND HOLE.
 3. COVER, RING, BASE, AND BASE EXTENSION SHALL BE MADE OF SAME MATERIAL.
 4. PROVIDE IMPRINTED 'ELECTRIC' ON COVER.
 5. HAND HOLE SHALL BE INSTALLED IN LANDSCAPE AREAS NOT SUBJECT TO VEHICULAR TRAFFIC.
 6. HAND HOLE SHALL BE MIN. TIER 8 RATED.
 7. ALL TERMINATIONS SHALL BE MADE USING UNITAP TAP CONNECTORS OR COMPRESSION SPLICE KITS LISTED FOR WET LOCATIONS. TWIST ON WIRE CONNECTORS ARE NOT ACCEPTABLE.
 8. ALL DISTURBED SOIL SHALL BE WELL COMPACTED.
 9. EACH END OF PULL STRING SHALL BE LABELED TO INDICATE ORIGIN/DESTINATION OF CONDUIT.

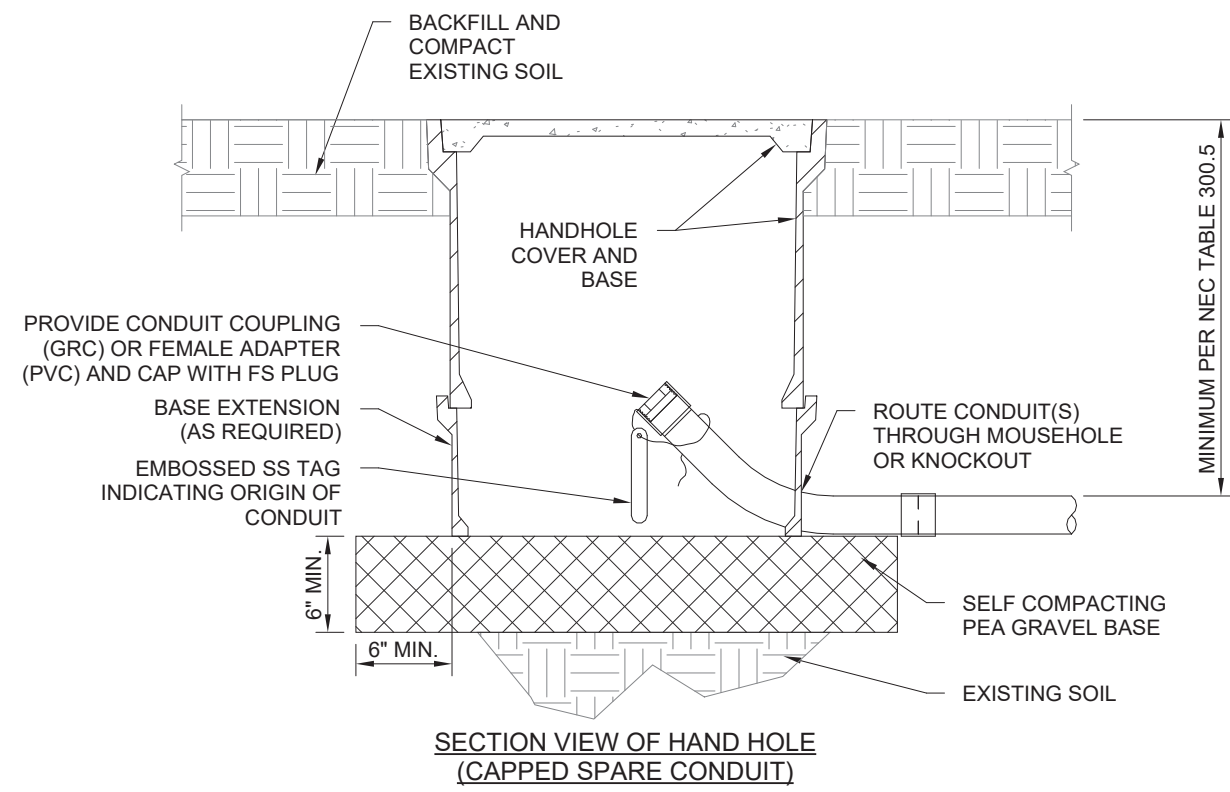
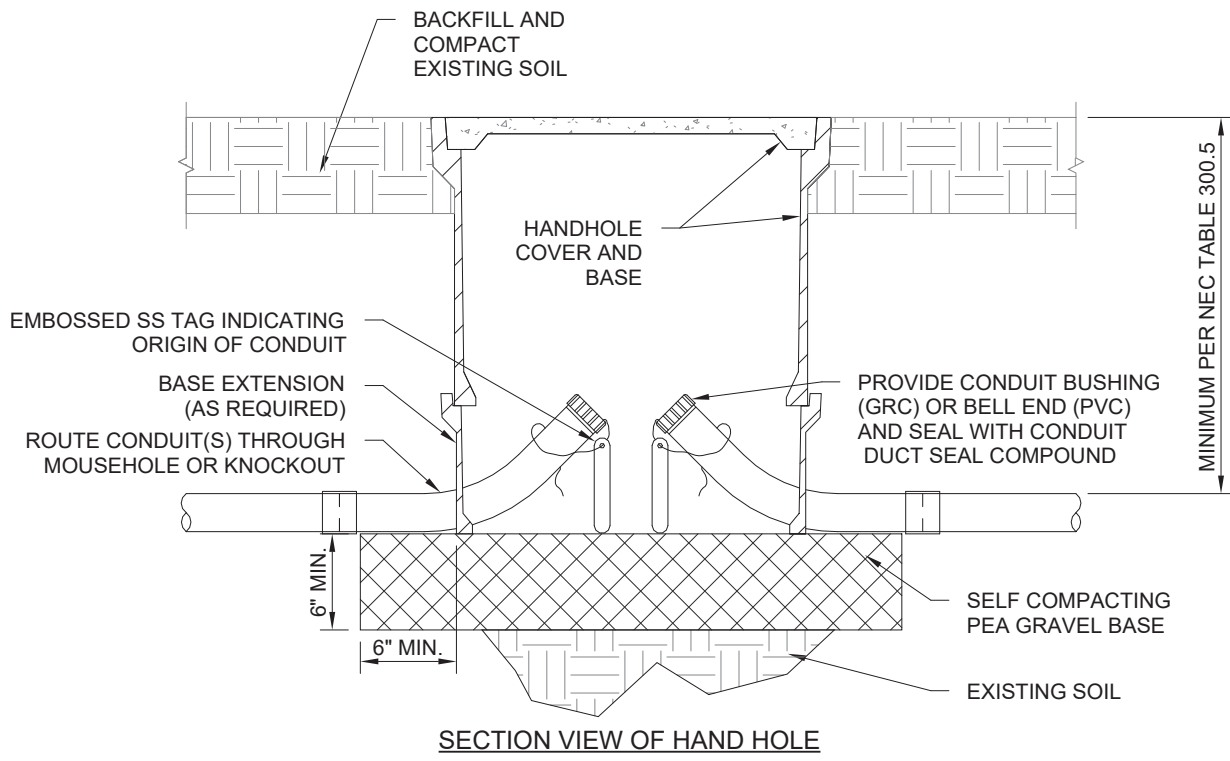

HAND HOLE INSTALLED IN LANDSCAPE AREA DETAIL

SCALE
N.T.S.

2

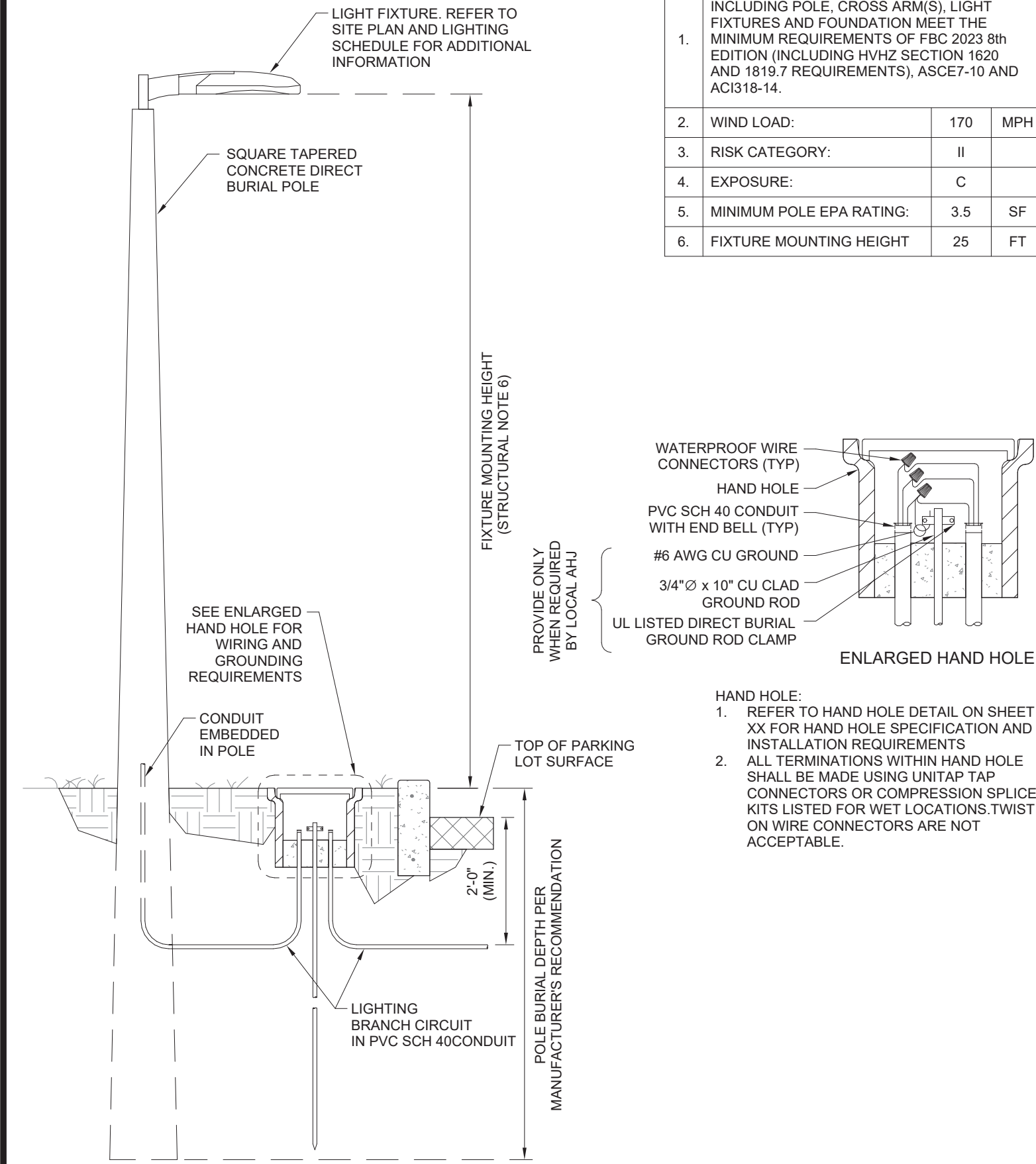

SITE POLE LIGHT DETAIL
DIRECT BURIAL - CONCRETE

SCALE
N.T.S.

1

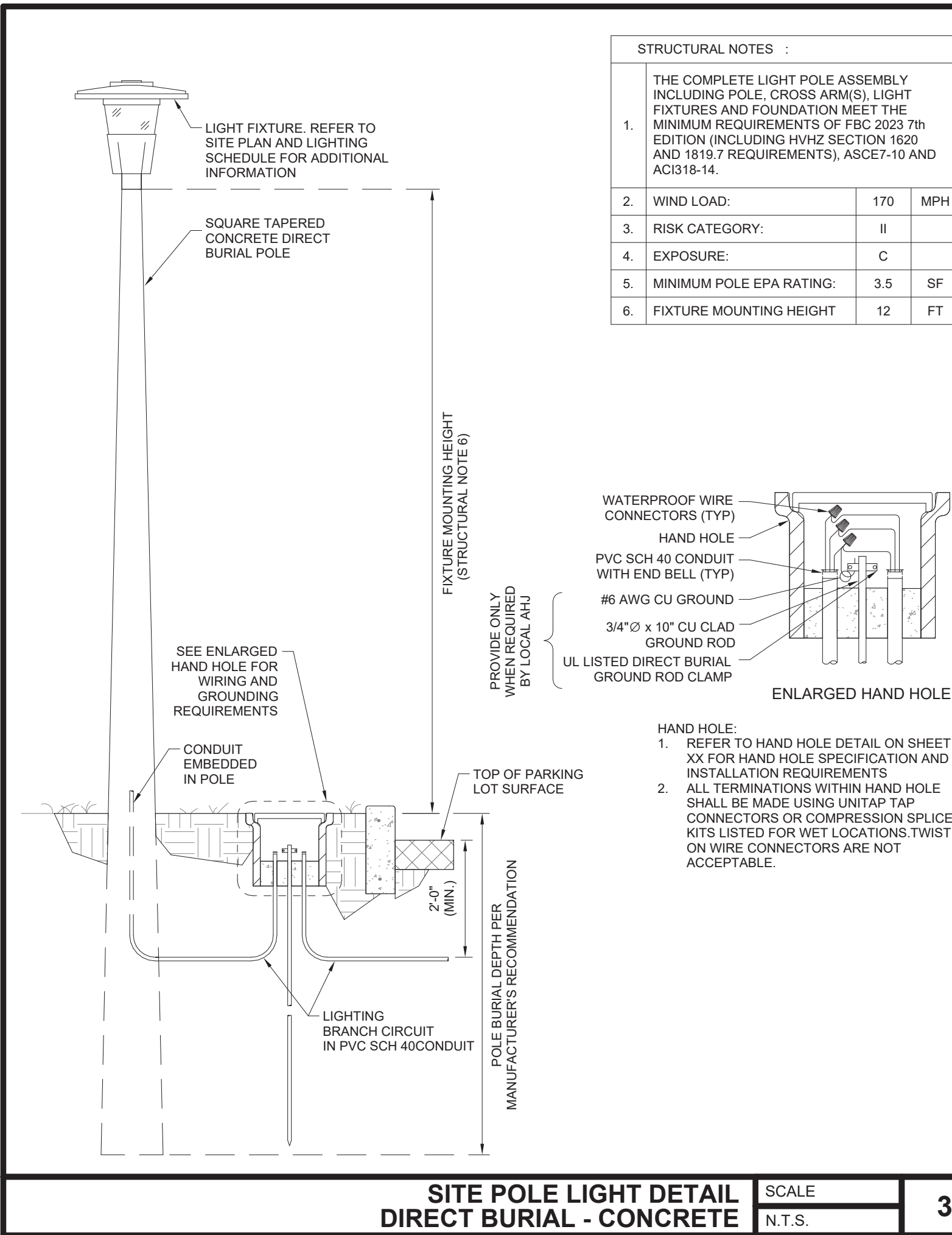

SITE POLE LIGHT DETAIL
DIRECT BURIAL - CONCRETE

SCALE
N.T.S.

3

The following lines are excerpts from the Florida Statutes and are shown on this drawing for informational purposes only:

FLORIDA STATUTES

2019 FLORIDA STATUTES
TITLE XXXVIII. BANKS AND BANKING
CHAPTER 655. FINANCIAL INSTITUTIONS GENERALLY

- 655.960 Definitions; ss. 655.960-655.965, --
As used in this section and ss. 655.961-655.965, unless the context otherwise requires:
1. "Access area" means any paved walkway or sidewalk which is within 50 feet of any automated teller machine. The term does not include any street or highway open to the use of the public, as defined in s. 316.003(83)(a) or (b), including any adjacent sidewalk, as defined in s. 316.003.
 2. "Access device" has the same meaning as set forth in Federal Reserve Board Regulation E, 12 C.F.R. part 205, promulgated pursuant to the Electronic Fund Transfer Act, 15 U.S.C. ss. 1601 et seq.
 3. "Automated teller machine" means any electronic information processing device located in this state which accepts or dispenses cash in connection with a credit, deposit, checking, or convenience account. The term does not include devices used solely to facilitate check guarantees or check authorizations or which are used in connection with the acceptance or dispensing of cash on a person-to-person basis, such as by a store cashier.
 4. "Candlefoot power" means the light intensity of candles on a horizontal plane at 36 inches above ground level and 5 feet in front of the area to be measured.
 5. "Control," with respect to an access area or defined parking area, means to have the present legal authority to determine how, when, and by whom such area is to be used, and how such area is to be maintained, lighted, and landscaped. If an operator leases an access area or defined parking area as lessee, such lessee shall not be considered to have control for the purposes of ss. 655.960-655.965.
 6. "Customer" means a natural person to whom an access device has been issued for personal, family, or household use.
 7. "Defined parking area" means that portion of any parking area open for customer parking which is contiguous to an access area with respect to an automated teller machine, is regularly, principally, and lawfully used for parking by users of the automated teller machine while conducting automated teller machine transactions during the hours of darkness, and is owned or leased by the operator of the automated teller machine or owned or controlled by the party leasing the automated teller machine site to the operator. The term does not include any parking area which is not open or regularly used for parking by users of the automated teller machine who are conducting automated teller machine transactions during the hours of darkness. A parking area is not open if it is physically closed to access or if conspicuous signs indicate that it is closed. If a multiple level parking area satisfies the conditions of this subsection and would therefore otherwise be a defined parking area, only the single parking level deemed by the operator of the automated teller machine to be the most directly accessible to the users of the automated teller machine shall be considered a parking area.
 8. "Financial institution office" means a main office or principal office, as defined in s. 655.005, and a branch or branch office as defined in s. 655.124.
 9. "Hours of darkness" means the period that commences 30 minutes after sunset and ends 30 minutes before sunrise.
 10. "Operator" means any financial institution, as defined in s. 655.005, other business entity, or any person who controls the use or operation by a customer or other member of the general public of an automated teller machine. An operator controls the use or operation of an automated teller machine for the purposes of ss. 655.960-655.965 if such person or entity has the present legal authority to determine when and by whom the automated teller machine may be used or operated and how it is to be maintained in compliance with the provisions of ss. 655.960-655.965. An operator does not include any person or entity which is not a financial institution, if the primary function of such person or entity is to provide data processing services for automated teller machine transactions or to provide for the exchange, transfer, or dissemination of electronic funds transfer data.
 11. Terms which are defined in the financial institution codes, unless the context otherwise requires, have the meanings ascribed to them therein for purposes of ss. 655.960-655.965.
- 655.962 Lighting; mirrors; landscaping. --
1. Each operator, or other person responsible for an automated teller machine pursuant to ss. 655.960-655.965, shall provide lighting during the hours of darkness with respect to an open and operating automated teller machine and any defined parking area, access area, and the exterior of an enclosed automated teller machine installation, as follows:
 - a. There shall be a minimum of 10 candlefoot power at the face of the automated teller machine and extending in an unobstructed direction outward 5 feet.
 - b. There shall be a minimum of 2 candlefoot power within 50 feet in all unobstructed directions from the face of the automated teller machine. If the automated teller machine is located within 10 feet of the corner of the building and the automated teller machine is generally accessible from the adjacent side, there shall be a minimum of 2 candlefoot power along the first 40 unobstructed feet of the adjacent side of the building.
 - c. The operator shall provide reflective mirrors or surfaces at each automated teller machine which provide the customer with a rear view while the customer is engaged in using the automated teller machine.
 2. The operator, or other person responsible pursuant to ss. 655.960-655.965 for an automated teller machine, shall ensure that the height of any landscaping, vegetation, or other physical obstructions in the area required to be lighted pursuant to subsection (1) for any open and operating automated teller machine shall not exceed 3 feet, except that trees trimmed to a height of 10 feet and whose diameters are less than 2 feet and manmade physical obstructions required by statute, law, code, ordinance, or other governmental regulation shall not be affected by this subsection.
- 655.964 Application.--
1. The provisions of ss. 655.961 and 655.962 do not apply to any automated teller machine which is:
 - a. Located inside of a building, unless it is a freestanding installation which exists for the sole purpose of providing an enclosure for the automated teller machine.
 - b. Located inside a building, except to the extent a transaction can be conducted from outside the building.
 - c. Located in any area, including any access area, building, enclosed space, or parking area which is not controlled by the operator.
 2. The provisions of ss. 655.960-655.965 shall not be construed to create any duty, responsibility, or obligation for any person or entity whose primary function is to provide for the exchange, transfer, or dissemination of electronic funds transfer data and is not otherwise a financial institution, as defined in s. 655.005, or an operator.
- 655.965 Preemption; prohibition.--
Except as expressly provided, the provisions of this section and ss. 655.960-655.964 supersede and preempt all rules, regulations, codes, or ordinances of any city, county, municipality, or other political subdivision of this state, and of any local agency regarding customer safety at automated teller machines located in this state.

bdg
architects

550 S. Caldwell Street
Suite 1800
Charlotte, NC 28202

P: 704.981.8951
Lic. #: AA - 00035990
www.bdgllp.com

FIFTH THIRD

**FIFTH THIRD
DELRAY BEACH**
1820 SOUTH FEDERAL HIGHWAY
DELRAY BEACH, FLORIDA 33483

THESE DRAWINGS AND PLANS, ANY REPRODUCTION THEREOF, AND ANY CAD OR ELECTRONIC FILE OF THESE DRAWINGS AND PLANS, HEREINAFTER "PLANS" ARE THE SOLE AND EXCLUSIVE, PROPRIETARY PROPERTY OF BDG ARCHITECTS, AND MAY NOT BE REPRODUCED, PUBLISHED, MODIFIED OR USED IN ANY MANNER WITHOUT THE EXPRESS WRITTEN PERMISSION OF BDG ARCHITECTS. USE OF THESE PLANS FOR CONSTRUCTION SHALL BE CONSIDERED ACCEPTANCE OF THE TERMS CONTAINED HEREIN AND THE LIABILITY AND CONDUCTIBILITY OF THE PLANS. THE PLANS SHALL NOT BE SCALED OR MODIFIED FOR ANY PURPOSE WITHOUT THE EXPRESS WRITTEN APPROVAL OF BDG ARCHITECTS. ANY CHANGES TO THESE PLANS, REGARDLESS OF HOW MINOR, WITHOUT THE EXPRESS WRITTEN APPROVAL OF BDG ARCHITECTS, ANY CONSTRUCTION EXECUTED FROM THESE PLANS WITHOUT THE EXPRESS WRITTEN APPROVAL OF BDG ARCHITECTS, OR ANY CHANGE IN THE SCOPE, DESIGN, OR INTENT OF THESE PLANS FOR ANY REASON, BY ANY PERSON OTHER THAN BDG ARCHITECTS SHALL AUTOMATICALLY VOID ANY DESIGN-RELATED OBLIGATIONS. BDG ARCHITECTS MAY HAVE ON THE PROJECT, AND RELATE TO THE FULL AND COMPLETE RELEASE OF BDG ARCHITECTS FROM ANY LIABILITY, CLAIMS, OR DAMAGES INCLUDING BREACHES AND CONSEQUENCES ARISING OUT OF OR RELATED TO THE PLANS, ANY DISCREPANCIES OR CONFLICTS IN THE PLANS SHALL BE REFERRED IMMEDIATELY TO BDG ARCHITECTS FOR CLARIFICATION PRIOR TO CONTINUING WITH THE WORK. FAILURE TO REFER DISCREPANCIES OR CONFLICTS TO BDG ARCHITECTS PRIOR TO PERFORMING WORK SHALL RESULT IN THE WAIVER OF ANY CLAIMS OR DAMAGES ASSOCIATED WITH THE DISCREPANCIES OR CONFLICTS. THE CONTRACTOR IS RESPONSIBLE FOR THE COORDINATION, SCHEDULING AND CONFORMANCE OF ITS WORK AND ALL WORK PERFORMED BY SUBCONTRACTORS OR OTHER TRADES WITH THE DESIGN DOCUMENTS.

SEAL **ANDREW MOHR**
FL PE# 73077

This item has been electronically signed and sealed by Andrew Mohr, P.E. on the date and/or time stamp shown using a digital signature. Printed copies of the document are not considered signed and sealed and the signature must be verified by a 3rd Party Certificate Authority on any electronic copy. FAC 61G15-23.004

INFINITY
INFINITY ENGINEERING GROUP
1208 East Kennedy Boulevard,
Suite 230
Tampa, Florida 33602
Phone: 813.434.4770
Fl. Cert. of Auth# 27889

ISSUE	BY	DATE	DESCRIPTION
	K.V.	05/15/25	PERMIT SET
1	K.V.	10/01/25	CRL 1

PROJECT INFORMATION BLOCK
JOB # 240661/15-386.00
DATE 10/01/2025
DRAWN BY: KL
CHECKED BY: AM

SHEET TITLE

**ELECTRICAL SITE
DETAILS**

SHEET NUMBER

E-012



Catalog #: _____ Project: _____
Prepared By: _____ Date: _____ Type: _____

XSPS LED Soffit Light



OVERVIEW	
Lumen Package	4000 - 8000
Wattage Range	43 - 59
Efficacy Range (LPW)	96 -104
Weight lbs (kg)	7.6 (3.5)

QUICK LINKS

Ordering Guide	Performance	Photometrics	Dimensions
----------------	-------------	--------------	------------

FEATURES & SPECIFICATIONS

Construction

- Housing is die-formed aluminum with diffused acrylic lens providing a water-resistant seal. Enclosure contains factory prewired driver and optical unit containing LEDs.
- Recess mount into an enclosed soffit with screws through the mounting frame. 8" clearance required for ease of installation.
- Finished with LSI's DuraGrip® polyester powder coat finishing process. The DuraGrip finish withstands extreme weather changes without cracking or peeling, and is guaranteed for five full years. Standard color is gloss white.
- Shipping weight: 7.6 lbs in carton.
- Suitable for wet locations.

Optical System

- Symmetric distribution with excellent uniformity and a BUG rating of B2-UO-G1. Diffuse lens is standard to minimizing visibility of LEDs.
- Select high-brightness LEDs.
- Available in 5000K, 4000K and 3000K
- Color temperatures per ANSI C78.377.
- Minimum CRI of 80.

Electrical

- High-performance factory programmable driver features over-voltage, under voltage, short-circuit and over temperature protection with integral surge protection that meets IEEE C62.41.2 and ANSI C82.77 -5 Location Category C Low standards.
- 0-10 volt dimming (10% - 100%) standard.
- 120-347VAC 50/60Hz
- Thermal protector standard on 5000-8000 lumen versions.
- L80 Calculated Life: >100K Hours (See Lumen Maintenance chart)
- Total harmonic distortion: <20%
- Operating temperature: -40°C to +40°C (-40°F to 104°F) for HO and VHO, -40°C to +45°C (-40°F to 113°F) for SS, -40°C to 35°C (-40°F to 95°F) for SHO.
- Power factor: >0.90
- Input power stays constant over life.
- High-efficacy LEDs with integrated circuit board mount to the housing to maximize heat dissipation and promote long life.
- Driver components are fully encased in potting material for moisture resistance. Driver complies with FCC standards.

Warranty

- LSI luminaires carry a 5-year limited warranty. Refer to <https://www.lsicorp.com/resources/terms-conditions-warranty/> for more information.

Listings

- Listed to UL 1598 and UL 8750
- Suitable For Damp Locations
- Meets Buy American Act requirements.
- DesignLights Consortium® (DLC) qualified product. Not all versions of this product may be DLC qualified. Please check the DLC Qualified Products List at www.designlights.org/QPL to confirm which versions are qualified.
- IDA compliant with 3000K or lower color temperature.



LSI Industries Inc. 10000 Alliance Rd. Cincinnati, OH 45242 • www.lsicorp.com
(800) 436-7800 • ©LSI Industries Inc. All Rights Reserved. Specifications subject to change without notice.

Page 1/4 Rev. 08/22/22
SPEC-2038-A.0320



Type: _____

XSPS LED Soffit Light

[Back to Quick Links](#)

TYPICAL ORDER EXAMPLE: **XSPS S LED SS CW 120 GWT DFL**

Prefix	Distribution	Light Source	Drive Current	Color Temperature	Input Voltage	Finish	Lens	Options
XSPS - LED Soffit	S - Symmetric	LED	SS - 4,000 Lumens HO - 5,000 Lumens VHO - 6,000 Lumens	CW - 5000K 80 CRI NW - 4000K 80 CRI WW - 3000K 80 CRI	120V-120V 208-208V 240-240V 277-277V 347-347V	GWT - Gloss White	DFL - Diffused Acrylic Lens	CMT - Channel Bar Mounting Kit BB - Emergency Battery Pack ¹

1 - Emergency Battery Pack only available on the SS - 4000 lumen version (120, 208, 240 & 277V versions).

PERFORMANCE

DELIVERED LUMENS									
Lumen Package	Distribution	Lens Type	CRI	Delivered Lumens	Efficacy	Bug Rating	Delivered Lumens	Efficacy	Bug Rating
SS	S	DFL	80	3816	123	B2-UO-G1	4022	129	B2-UO-G1
HO	S	DFL	80	4756	120	B2-UO-G1	5011	127	B2-UO-G1
VHO	S	DFL	80	5733	118	B2-UO-G1	6041	124	B2-UO-G1
SHD	S	DFL	80	7559	113	B3-UO-G1	7965	119	B3-UO-G1

LEDs are frequently updated therefore values are nominal.

Electrical Data (Amps)*							
Lumen Package	Wattage	120V	208V	240V	277V	347V	
SS	31	0.26	0.15	0.13	0.11	0.09	
HO	40	0.33	0.19	0.16	0.14	0.11	
VHO	49	0.41	0.23	0.2	0.18	0.14	
SHD	67	0.56	0.32	0.28	0.24	0.19	

*Electrical data at 25C (77F). Actual wattage may differ by +/-10%.

RECOMMENDED LUMEN MAINTENANCE						
Ambient Temp C	Initial ¹	25K hrs. ¹	50K hrs. ¹	75K hrs. ²	100K hrs. ²	
25 C	100%	95%	91%	86%	82%	

1 - In accordance with IESNA TM-21-11, Projected Values represent interpolated value based on time durations that are within six times the IESNA LM-80-08 total test duration for the device under testing.
2 - In accordance with IESNA TM-21-11, Calculated Values represent time durations that exceed six times the IESNA LM-80-08 total test duration for the device under testing.



LSI Industries Inc. 10000 Alliance Rd. Cincinnati, OH 45242 • www.lsicorp.com
(800) 436-7800 • ©LSI Industries Inc. All Rights Reserved. Specifications subject to change without notice.

Page 2/4 Rev. 08/22/22
SPEC-2038-A.0320



Catalog #: _____ Project: _____ Type: _____
Prepared By: _____ Date: _____

Mirada Medium Wall Sconce (XWM) Outdoor Wall Sconce



OVERVIEW	
Lumen Package	3,000 - 21,000
Wattage Range	23 - 175
Efficacy Range (LPW)	125 - 158
Weight lbs(kg)	27 (12.2)
Control Options	IMSBT, ALB, ALS, PCI

FEATURES & SPECIFICATIONS

Construction

- Rugged die-cast aluminum housing contains factory prewired driver and optical unit. Hinged die-cast aluminum wiring access door located underneath.
- Galvanized-steel universal wall mount bracket comes standard with hinging mechanism to easily access the junction box wire connections without removing the luminaire.
- Optional pole-mounting bracket (XPMa) permits mounting to standard poles.
- Fixtures are finished with LSI's DuraGrip® polyester powder coat finishing process. The DuraGrip finish withstands extreme weather changes without cracking or peeling. Other standard LSI finishes available. Consult factory.
- Max shipping weight: 30lbs in carton

Optical System

- State-of-the-Art one piece silicone optic provides industry leading optical control while also acting as an integrated gasket reducing system complexity and improving fixture reliability.
- Proprietary silicone refractor optics provide exceptional coverage and uniformity in Types 2, 3, 4, and FT distributions.
- Silicone optical material does not yellow or crack with age and provides a typical light transmittance of 95-95%.
- Zero uplight.
- Available in 5000K, 4000K and 3000K color temperatures per ANSI C78.377. Also Available in Phosphor Converted Amber with Peak intensity at 610nm.
- Minimum CRI of 70.

Electrical

- High-performance programmable driver features over-voltage, under-voltage, short-circuit and over temperature protection. Custom lumen and wattage packages available.

- 0-10V dimming (10% - 100%) standard.
- Standard Universal Voltage (120-277 Vac) Input 50/60 Hz or optional High Voltage (347-480 Vac).
- L80 Calculated Life: >100K Hours
- Total harmonic distortion (THD): <20%
- 3L to 12L operating temperature: -40°C to +50°C (-40°F to +122°F)
- 15L operating temperature: -40°C to +45°C (-40°F to +113°F).
- 18L operating temperature: -40°C to +40°C (-40°F to +104°F).
- 21L operating temperature: -40°C to +35°C (-40°F to +95°F).
- Power factor (PF): > 90
- Input power stays constant over life.
- Optional 10kV surge protection device meets per ANSI/IEEE C62.41.2
- High-efficacy LEDs mounted to metal-core circuit board to maximize heat dissipation
- Components are fully encased in potting material for moisture resistance. Driver complies with FCC standards. Driver and key electronic components can easily be accessed via hinged door.
- Optional integral emergency battery pack provides 90-minutes of constant power to the LED system, ensuring code compliance. A test switch/indicator button is installed on the housing for ease of maintenance. The fixture delivers 1500 lumens during emergency mode.

Controls

- Integral passive infrared Bluetooth™ motion sensor options. Fixtures operate independently and can be commissioned via an iOS or Android configuration app. Updates and modifications to the control strategy are easily implemented via an intuitive app.

- LSI's AirLink™ blue lighting control system is a simple feature rich wireless Bluetooth mesh network. The integrated fixture sensor module provides wireless control of grouped fixtures based on motion sensors, daylight or a fully customizable schedule.

- 2 fasteners secure the hinged door underneath the housing and provide quick & easy access to the electrical compartment for installing/servicing.
- Optional terminal block accepts up to 12 ga wire

Warranty

- LSI luminaires carry a 5-year limited warranty. Refer to <https://www.lsicorp.com/resources/terms-conditions-warranty/> for more information.

Listings

- Listed to UL 1598 and UL 8750.
- Meets Buy American Act requirements.
- IDA compliant; see local ordinance for qualification information.
- Suitable for wet Locations.
- IP65 rated luminaire per IEC 60598.
- 3G rated for ANSI C136.31 high vibration applications when pole mounted (using optional XPMa bracket) or wall mounted.
- IK08 rated luminaire per IEC 60626 mechanical impact code
- DesignLights Consortium® (DLC) Premium qualified product. Not all versions of this product may be DLC Premium qualified. Please check the DLC Qualified Products List at www.designlights.org/QPL to confirm which versions are qualified.

Mirada Medium Wall Sconce (XWM) Outdoor Wall Sconce

Have questions? Call us at (800) 436-7800

Type: _____

ORDERING GUIDE

[Back to Quick Links](#)

TYPICAL ORDER EXAMPLE: XWM 2 LED SS 30 UE BRZ ALSC				
Family	Distribution	Light Source	Lumen Package	Color Temperature
XWM - Mirada Medium Wall Sconce	2- Type 2	LED	3L - 3,000	30 - 300K
	3- Type 3		4L - 4,000	40 - 400K
	4L - 6,000		8L - 8,000	50 - 500K
	12L - 12,000		15L - 15,000	
	18L - 18,000		21L - 21,000	
			Custom Lumen Packages ¹	
Voltage	Finish	Controls	Options	
UE - Universal Voltage (120-277V) HV - High Voltage (347-480V)	BLK - Black BRZ - Dark Bronze CMS - Gun Metal Gray GP - Graphite MSV - Metallic Silver PSP - Platinum Plus SVC - Satin Verde Green WHF - White	Blank - None Wireless Controls ALSC - AirLink Synapse Control System ALSCS02 - AirLink Synapse Control System with 8-12" Motion Sensor ALSCS02 - AirLink Synapse Control System with 12-20" Motion Sensor ALSCS1 - AirLink Blue Wireless Motion & Photo Sensor Controller (8-24 MHz) ² ALSCS2 - AirLink Blue Wireless Motion & Photo Sensor Controller (25-48 MHz) ² Standalone Controls DIM - 0-10V Dimming leads extended to housing exterior INCSB1 - Integral Bluetooth™ Motion and Photo Sensor (8-24 MHz) ³ INCSB2 - Integral Bluetooth™ Motion and Photo Sensor (25-48 MHz) ³ Button Type Photocells PC120 - 120V PC108-277 - 208 - 277V PC347 - 347V	Blank - None RB - Battery Back-up (0°C) ⁴ CWB - Cold Weather Battery Backup (-20°C) ⁴ XPMa - Pole Mounting Bracket SP1 - 10kV Surge Protection TB - Terminal Block	

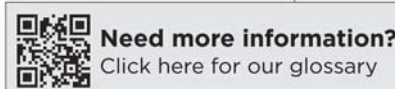

Need more information?
Click here for our glossary

Have additional questions?
Call us at (800) 436-7800

FUSING ACCESSORY ORDERING INFORMATION⁴

Part Number	Description
FX120⁵	FX120 - Single Fusing
FX277⁶	FX277 - Single Fusing
FX347⁷	FX347 - Single Fusing
DFK208⁸	DFK - Double Fusing
DFK240⁹	DFK - Double Fusing (240V)
DFK480⁹	DFK - Double Fusing (480V)

MOUNTING ACCESSORY ORDERING INFORMATION⁴

Part Number ⁴	Description
5560150LR	XWM Wet Location Surface Conduit/Wiring Box
751552	10" Linear Bird Spike Kit (2" Recommended per Luminaire)

1 - Custom lumen and wattage packages available consult factory. Values are within industry standard tolerances but not DIC listed.
2 - Only available in 6 Lumen Package. Consult factory for lead time and availability.
3 - IMBT and ALS control options are not available in 3, 4, & 8 Lumen packages when high voltage (HV) is specified.
4 - IMBT is field configurable via the lexikon app that can be downloaded from your smartphone (iOS) or store.

5 - Not available in UE.
6 - Accessories are shipped separately and field installed.
7 - Fusing must be installed in a rated box for pole or in the junction box.
8 - "0K" is field configurable via the lexikon app that can be downloaded from your smartphone. See Finish options for paint color selections.



LSI Industries Inc. 10000 Alliance Rd. Cincinnati, OH 45242 • (513) 372-3200 • www.lsicorp.com
©LSI Industries Inc. All Rights Reserved. Specifications and dimensions subject to industry standard tolerances. Specifications subject to change without notice.

Page 2/7 Rev. 08/03/23
SPEC-1024-C.0823



ECO 5" LED DOWNLIGHT

ED5AIC, ED5ANC, ED5NIC, ED5RM
ED5LAIC, ED5DLANC, ED5SLNIC, ED5LRIC
ED5SNNIC

SPEC-00273 NEW ECO, 5", V-8.0, UPDATED 05/19/2023



LED LIGHT ENGINE

RATED WATTAGE	29.5W, 24W, 15.3W
DELIVERED LUMENS	Up to 2657 lm
EFFICACY	Up to 104 LPW
CCT @ 90CRI	2700K, 3000K, 3500K, 4000K, Warm Dim
COLOR QUALITY	90+ CRI, 2-Step SDCM
LED LIFETIME	55,000 hours @ L90

DELIVERED LUMENS MATRIX

	10" Optic	30" Optic	50" Optic	80" Optic
ED5 (29.5W)	1030 lm	1081 lm	992 lm	723 lm
2700K (90CRI)	2275 lm	2403 lm	2139 lm	1624 lm
3000K (90CRI)	2458 lm	2597 lm	2311 lm	1755 lm
3500K (90CRI)	2516 lm	2657 lm	2366 lm	1796 lm
4000K (90CRI)	2590 lm	2735 lm	2435 lm	1849 lm

ED5 NIC, RIC (15.3W)	10" Optic	30" Optic	50" Optic	80" Optic
Warm Dim (98 CRI, RB-90)	1030 lm	1081 lm	992 lm	723 lm
ED5 AIC, ANC (24W)	10" Optic	30" Optic	50" Optic	80" Optic
Warm Dim (98 CRI, RB-90)	1472 lm	1545 lm	1418 lm	1033 lm

ED5L (15.3W)	10" Optic	30" Optic	50" Optic	80" Optic
2700K (90CRI)	1349 lm	1424 lm	1289 lm	963 lm
3000K (90CRI)	1457 lm	1539 lm	1370 lm	1040 lm
3500K (90CRI)	1491 lm	1575 lm	1402 lm	1065 lm
4000K (90CRI)	1535 lm	1621 lm	1443 lm	814 lm

ED5S (24W)	10" Optic	30" Optic	50" Optic	80" Optic
2700K (90CRI)	1953 lm	2063 lm	1836 lm	1394 lm
3000K (90CRI)	2110 lm	2229 lm	1984 lm	1507 lm
3500K (90CRI)	2160 lm	2282 lm	2031 lm	1542 lm
4000K (90CRI)	2223 lm	2348 lm	2090 lm	1587 lm
Warm Dim (98 CRI, RB-90)	1472 lm	1545 lm	1418 lm	1033 lm

1/14
14038 Nelson Ave. City of Industry, CA 91744 • Tel: 626.336.4511 • Fax: 626.330.4296 • www.csllighting.com
©2023 Creative Systems Lighting, A Division of Trey-CSL Lighting, Inc. All rights reserved. Subject to change without notice.
Patent: csllighting.com/patents



ECO 5" LED DOWNLIGHT

ED5AIC, ED5ANC, ED5NIC, ED5RM
ED5LAIC, ED5DLANC, ED5SLNIC, ED5LRIC
ED5SNNIC

SPEC-00273 NEW ECO, 5", V-8.0, UPDATED 05/19/2023

ORDER MATRIX

ED5

ECO 5" HOUSING + LIGHT ENGINE ORDER MATRIX (Example: ED5AIC-309050-30S)

HOUSING BASE			LED PERFORMANCE			DRIVER ASSEMBLY		
FAMILY APERTURE		INSTALLATION TYPE	CCT	CRI	OPTIC	WATTAGE	LED DIMMING DRIVER	
<input type="checkbox"/> EDS	ECO 5"	<input type="checkbox"/> AIC (Adjustable New Construction, IC, CCEA)	<input type="checkbox"/> -27 (2700K)	90 (90 CRI)	50 (50° Flood) Installed 10", 30", 80" optics available from the Additional Optics Accessories table below	-30 (29.5W)	\$ Universal Dimming Driver (1%-100% 0-10V, TRAC, ELV, 120V/277V)	
		<input type="checkbox"/> ANC (Adj New Construction)	<input type="checkbox"/> -30 (3000K)					
		<input type="checkbox"/> NC (New Construction)	<input type="checkbox"/> -35 (3500K)					
		<input type="checkbox"/> RM (Remodel)	<input type="checkbox"/> -40 (4000K)					
<input type="checkbox"/> EDS	ECO 5"	<input type="checkbox"/> AIC' (Adjustable New Construction, IC, CCEA) <input type="checkbox"/> ANC' (Adj New Construction) <input type="checkbox"/> NIC' (New Construction IC) <input type="checkbox"/> RIC' (Remodel IC)	<input type="checkbox"/> Warm Dim	<input type="checkbox"/> -WD ¹ (1800K-3000K)	98 (98 CRI)	50 (50° Flood) Installed 10", 30", 80" optics available from the Additional Optics Accessories table below	-16 ¹ (15.3W) NC or IC installation Typically -25 ¹ (24W) AIC or ANC installation Typically	\$ Universal Dimming Driver (1%-100% 0-10V, TRAC, ELV, 120V/277V)

