

LEGACY SIGNS OF TEXAS

CUSTOMER APPROVAL: Note: The colors depicted on this rendering may not match actual colors used on the finished display. Note: The proportion of signs shown on building and landscape area photos is an approximate representation.

PLEASE READ CAREFULLY: Before you OK this proof, please read your copy carefully and completely. Check for spelling errors and copy omissions. Any changes or alterations from the original instructions will be charged according to time and material.

FINAL PROOF APPROVAL: By signing this form I am approving the above described job and I hereby acknowledge that I have read and accept the proofing policy and Terms and Conditions of Legacy Signs of Texas. Please sign and return so that we may process your order.



delray

ORTHODONTICS

CLIENT SIGNATURE: _____

DATE: _____

7923 E. McKinney St., Denton, TX 76208
O 817.431.5700 F 817.431.5799

 UL E226292 TDLR - 18933

This drawing is the property of Legacy Signs & Electrical. All rights to its use for reproduction are reserved by Legacy Signs & Electrical

FINAL ELECTRICAL CONNECTION BY CUSTOMER

 THIS SIGN IS INTENDED TO BE INSTALLED IN ACCORDANCE WITH ARTICLE 600 OF THE NATIONAL ELECTRICAL CODE AND/OR OTHER APPLICABLE LOCAL CODES. THIS INCLUDES PROPER GROUNDING & BONDING OF THE SIGN. SIGN WILL BEAR UL LABEL(S).



7923 E. McKinney St., Denton, TX 76208

O 817.431.5700 F 817.431.5799

 UL E226292  TDLR 18933

JOB DESCRIPTION	ILLUMINATED CHANNEL LETTERS	DATE	BY	REV	
COMPANY OR JOB NAME	MB2_DELRAY ORTHODONTICS	02.15.23	JR	R9	CHANGE WIREWAY TO RACEWAY
CUSTOMER CONTACT		02.22.23	JR	R10	CHANGE DOOR VINYL TO 4QTY
ADDRESS	10N SE 1ST AVE. STE B&C DELRAY BEACH, FL 33444	11.22.24	CJR	R11	CHGD TO NON-ILLUM.
PHONE					
EMAIL					
FILE NAME	DELRAY ORTHODONTICS				
SALESMAN	ROGER CHUNG				

PAGE

1

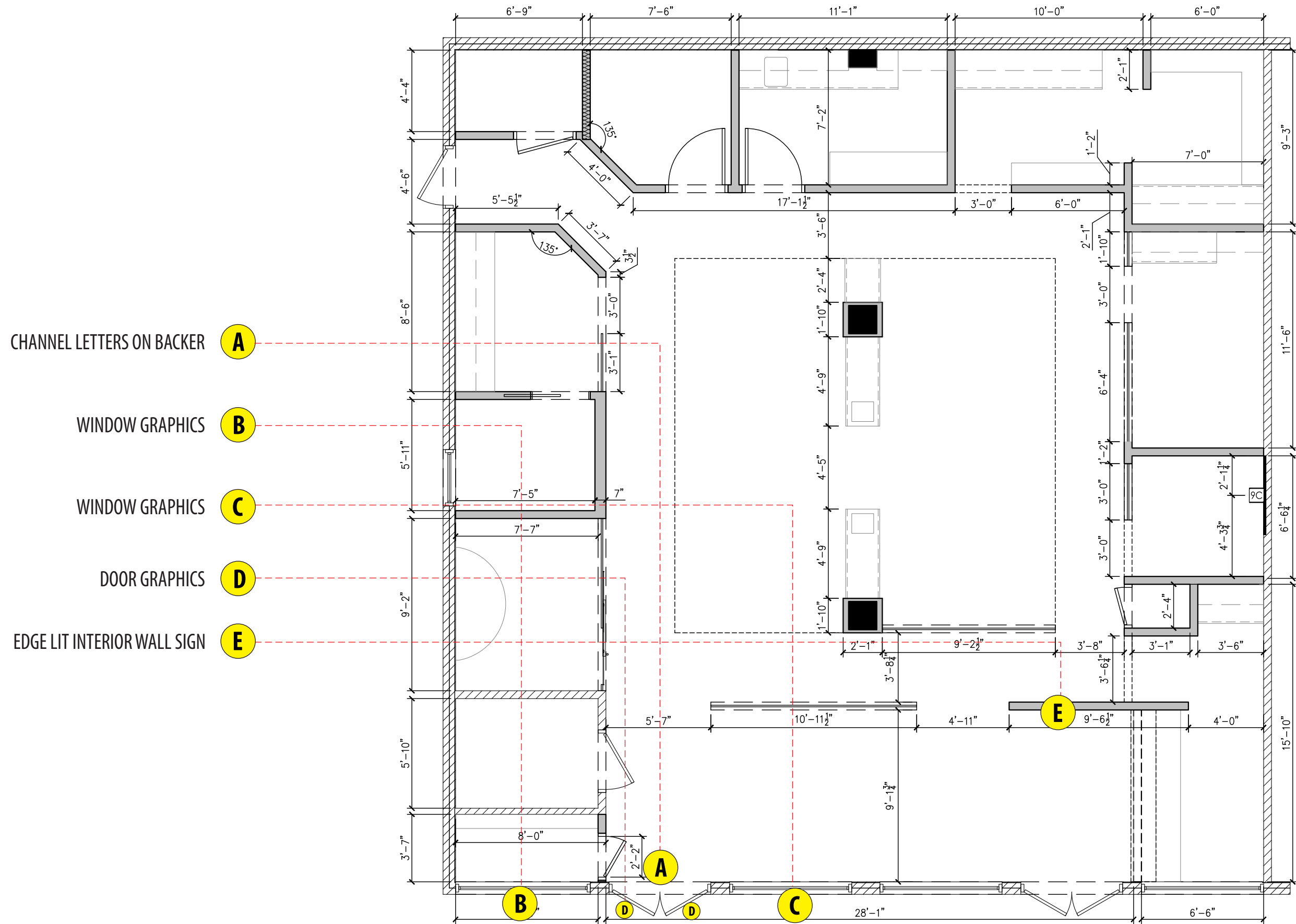

- CHANNEL LETTERS ON BACKER **A**
- WINDOW GRAPHICS **B**
- WINDOW GRAPHICS **C**
- DOOR GRAPHICS **D**
- EDGE LIT INTERIOR WALL SIGN **E**

SITE MAP
SCALE: 3/16"=1'



7923 E. McKinney St., Denton, TX 76208
 O 817.431.5700 F 817.431.5799
 UL E226292 BBB TDLR 18933

JOB DESCRIPTION	ILLUMINATED CHANNEL LETTERS	DATE	BY	REV	
COMPANY OR JOB NAME	MB2_DELRAY ORTHODONTICS	02.15.23	JR	R9	CHANGE WIREWAY TO RACEWAY
CUSTOMER CONTACT		02.22.23	JR	R10	CHANGE DOOR VINYL TO 4QTY
ADDRESS	10N SE 1ST AVE. STE B&C DELRAY BEACH, FL 33444	11.22.24	CJR	R11	CHGD TO NON-ILLUM.
PHONE					
EMAIL					
FILE NAME	DELRAY ORTHODONTICS				
SALESMAN	ROGER CHUNG				

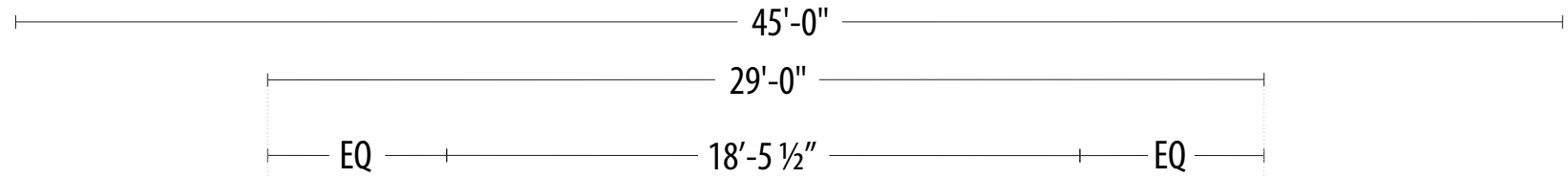

2'-8"
10'-8"



EXISTING

A FRONT ELEVATION

BUILDING TO BE REPAINTED AND AWNINGS RECOVERED (BAY BLUE #2741)

SCALE: 3/16" = 1'

49.22 SQ.FT



7923 E. McKinney St., Denton, TX 76208

0 817.431.5700 F 817.431.5799

UL E226292 BBB TDLR 18933

JOB DESCRIPTION	ILLUMINATED CHANNEL LETTERS	DATE	BY	REV	
COMPANY OR JOB NAME	MB2_DELRAY ORTHODONTICS	02.15.23	JR	R9	CHANGE WIREWAY TO RACEWAY
CUSTOMER CONTACT		02.22.23	JR	R10	CHANGE DOOR VINYL TO 4QTY
ADDRESS	10N SE 1ST AVE. STE B&C DELRAY BEACH, FL 33444	11.22.24	CJR	R11	CHGD TO NON-ILLUM.
PHONE					
EMAIL					
FILE NAME	DELRAY ORTHODONTICS				
SALESMAN	ROGER CHUNG				

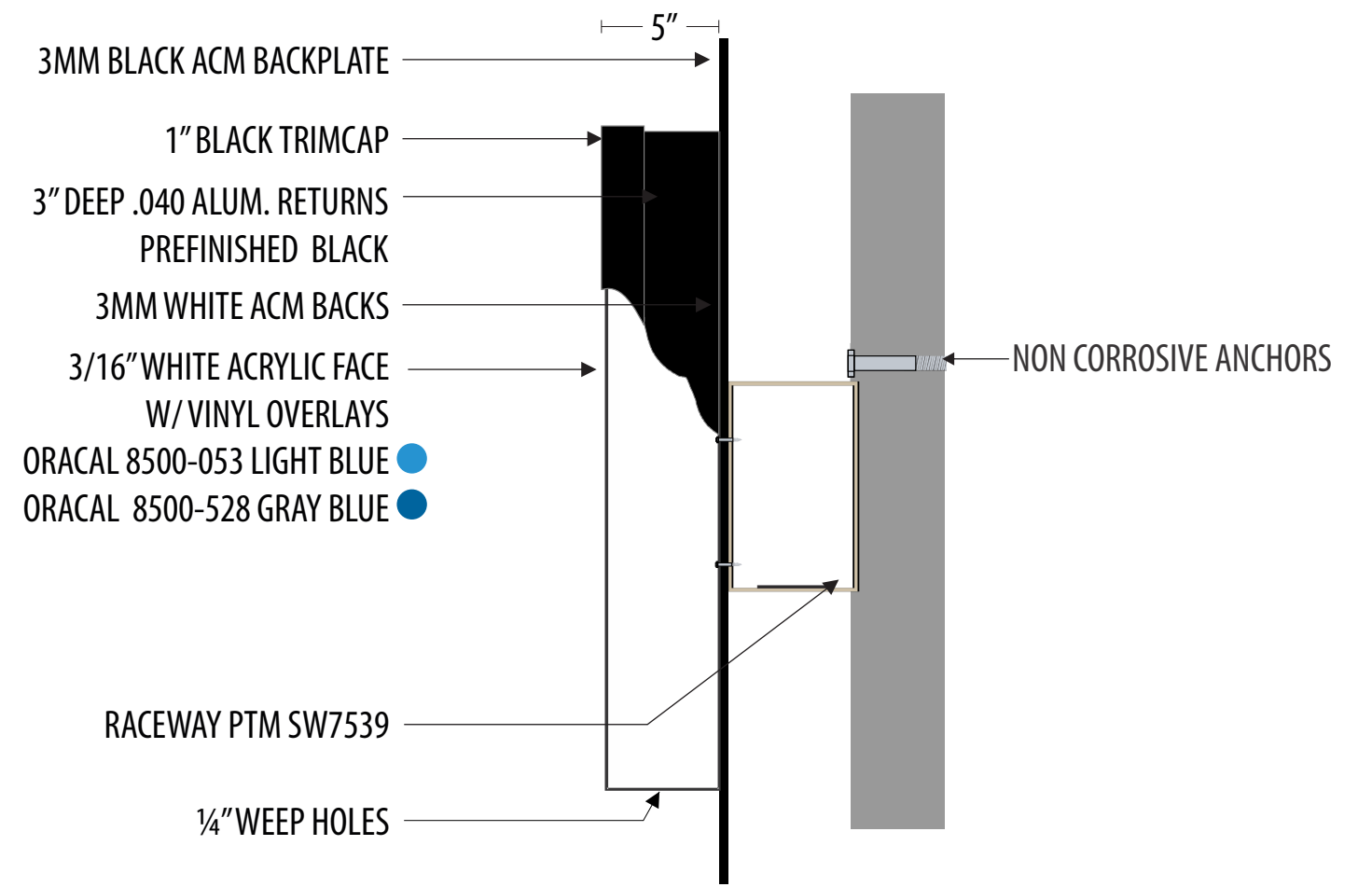
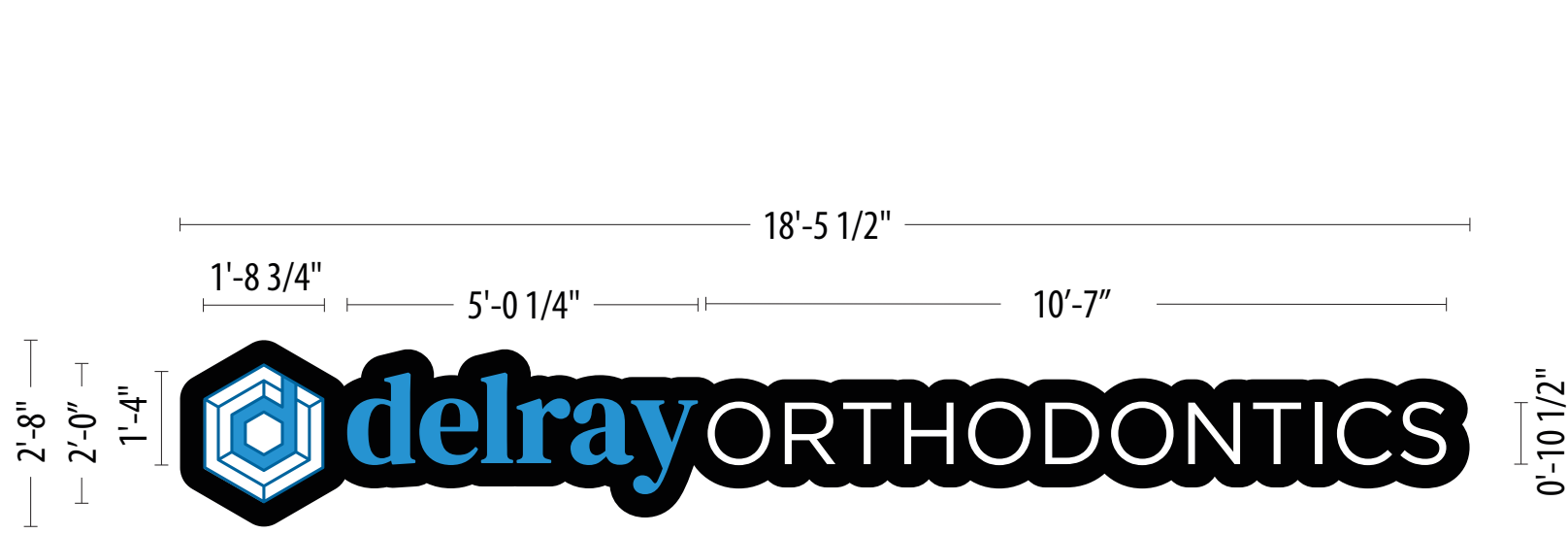

A **NON-ILLUM. CHANNEL LETTERS ON BACKER** SCALE: 3/8" = 1'

MANUFACTURE & INSTAL ONE (1) SET OF CHANNEL LETTERS ON BACKER W/ RACEWAY 49.22 SQ.FT

UL **NON-ILLUM. CHANNEL LETTERS W/ BACKPLATE ON A RACEWAY**

ELECTRICAL NOTES
 Sign Company DOES NOT provide primary electrical to sign. Power to the sign must be done by a licensed electrical contractor or licensed electrician.
Each sign must have:

1. A minimum of one dedicated 120V 20A circuit
2. Junction box installed within 6 feet of sign
3. Three wires: Line, Ground, Neutral



7923 E. McKinney St., Denton, TX 76208
0 817.431.5700 F 817.431.5799
 UL E226292 BBB TDLR 18933

JOB DESCRIPTION	ILLUMINATED CHANNEL LETTERS	DATE	BY	REV	
COMPANY OR JOB NAME	MB2_DELRAY ORTHODONTICS	02.15.23	JR	R9	CHANGE WIREWAY TO RACEWAY
CUSTOMER CONTACT		02.22.23	JR	R10	CHANGE DOOR VINYL TO 4QTY
ADDRESS	10N SE 1ST AVE. STE B&C DELRAY BEACH, FL 33444	11.22.24	CJR	R11	CHGD TO NON-ILLUM.
PHONE					
EMAIL					
FILE NAME	DELRAY ORTHODONTICS				
SALESMAN	ROGER CHUNG				

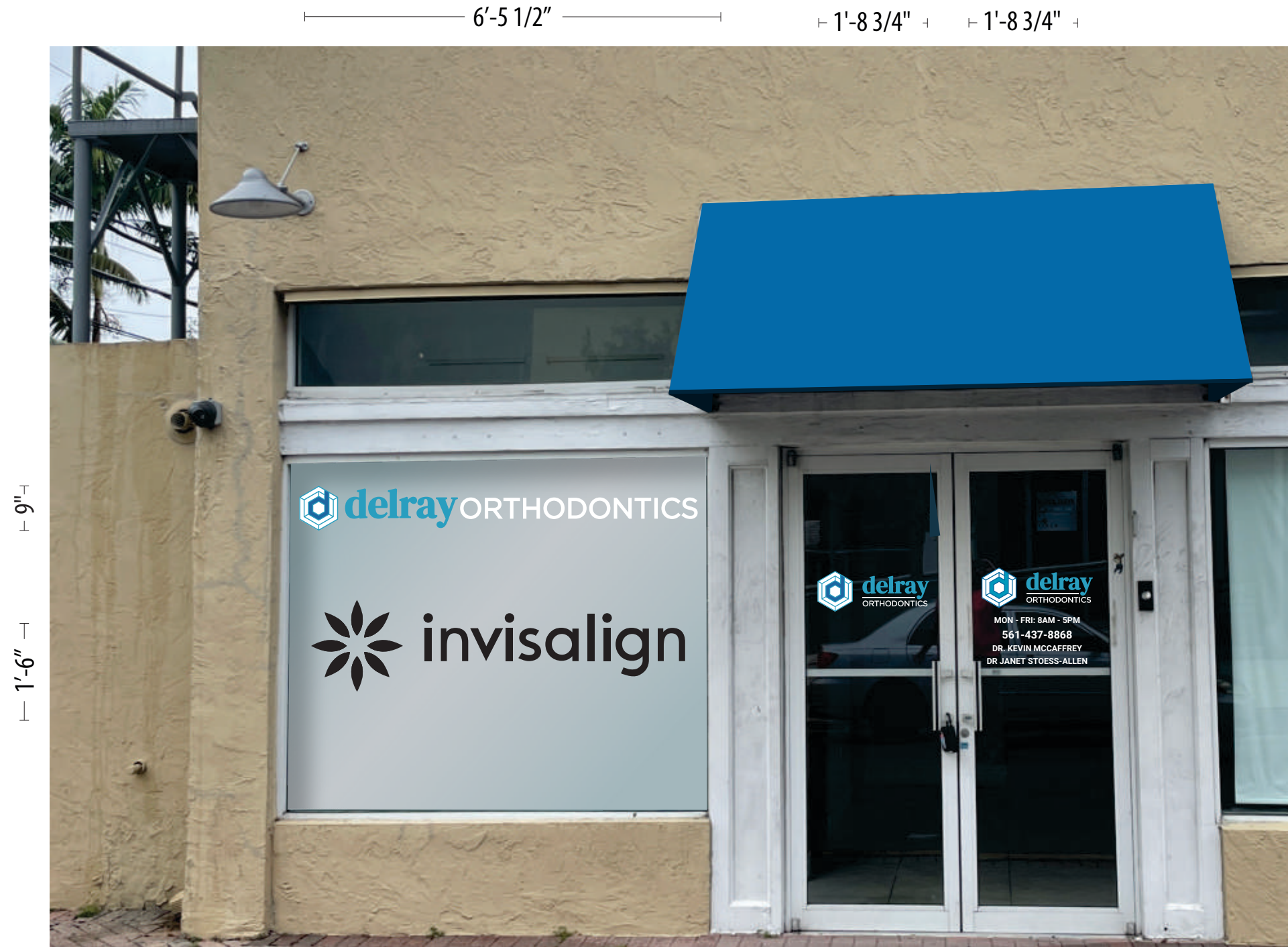

EXISTING CONDITIONS

B D **PROPOSED - WINDOW & DOOR VINYL** SCALE: 1/2" = 1'
 BUILDING TO BE REPAINTED AND AWNINGS RECOVERED (BAY BLUE #2741) 14.53 SQ.FT



7923 E. McKinney St., Denton, TX 76208
 O 817.431.5700 F 817.431.5799
 UL E226292 BBB TDLR 18933

JOB DESCRIPTION	ILLUMINATED CHANNEL LETTERS	DATE	BY	REV	
COMPANY OR JOB NAME	MB2_DELRAY ORTHODONTICS	02.15.23	JR	R9	CHANGE WIREWAY TO RACEWAY
CUSTOMER CONTACT		02.22.23	JR	R10	CHANGE DOOR VINYL TO 4QTY
ADDRESS	10N SE 1ST AVE. STE B&C DELRAY BEACH, FL 33444	11.22.24	CJR	R11	CHGD TO NON-ILLUM.
PHONE					
EMAIL					
FILE NAME	DELRAY ORTHODONTICS				
SALESMAN	ROGER CHUNG				

1'-8 3/4"

1'-8 3/4"

6'-5 1/2"



0'-7 1/2"

1'-6"
1'-9"



EXISTING CONDITIONS

C D

PROPOSED - WINDOW & DOOR VINYL

SCALE: 1/2" = 1'

BUILDING TO BE REPAINTED AND AWNINGS RECOVERED (BAY BLUE #2741)

14.53 SQ.FT



7923 E. McKinney St., Denton, TX 76208

O 817.431.5700 F 817.431.5799

UL E226292 BBB TDLR 18933

JOB DESCRIPTION	ILLUMINATED CHANNEL LETTERS	DATE	BY	REV	
COMPANY OR JOB NAME	MB2_DELRAY ORTHODONTICS	02.15.23	JR	R9	CHANGE WIREWAY TO RACEWAY
CUSTOMER CONTACT		02.22.23	JR	R10	CHANGE DOOR VINYL TO 4QTY
ADDRESS	10N SE 1ST AVE. STE B&C DELRAY BEACH, FL 33444	11.22.24	CJR	R11	CHGD TO NON-ILLUM.
PHONE					
EMAIL					
FILE NAME	DELRAY ORTHODONTICS				
SALESMAN	ROGER CHUNG				



QTY:2 **5 SQ. FT.**

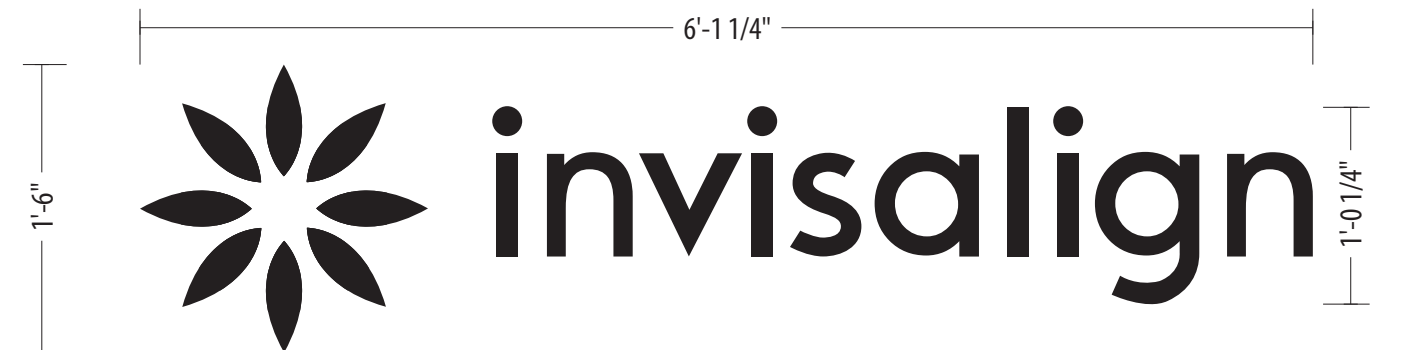

QTY:2 **9.2 SQ. FT.**

B C

WINDOW VINYL

SCALE: 1" = 1'

SCOPE OF WORK:
 MANUFACTURE & INSTALL (4) FOUR RTA VINYL GRAPHICS FIRST SURFACE
 ORACAL 8500-053 LIGHT BLUE ●
 ORACAL 8500-528 GRAY BLUE ●
 ORACAL 751 BLACK ●
 ORACAL 751- WHITE ○

15.2 SQ.FT



7923 E. McKinney St., Denton, TX 76208
 O 817.431.5700 F 817.431.5799
 UL E226292 BBB TDLR 18933

JOB DESCRIPTION	ILLUMINATED CHANNEL LETTERS	DATE	BY	REV	
COMPANY OR JOB NAME	MB2_DELRAY ORTHODONTICS	02.15.23	JR	R9	CHANGE WIREWAY TO RACEWAY
CUSTOMER CONTACT		02.22.23	JR	R10	CHANGE DOOR VINYL TO 4QTY
ADDRESS	10N SE 1ST AVE. STE B&C DELRAY BEACH, FL 33444	11.22.24	CJR	R11	CHGD TO NON-ILLUM.
PHONE					
EMAIL					
FILE NAME	DELRAY ORTHODONTICS				
SALESMAN	ROGER CHUNG				

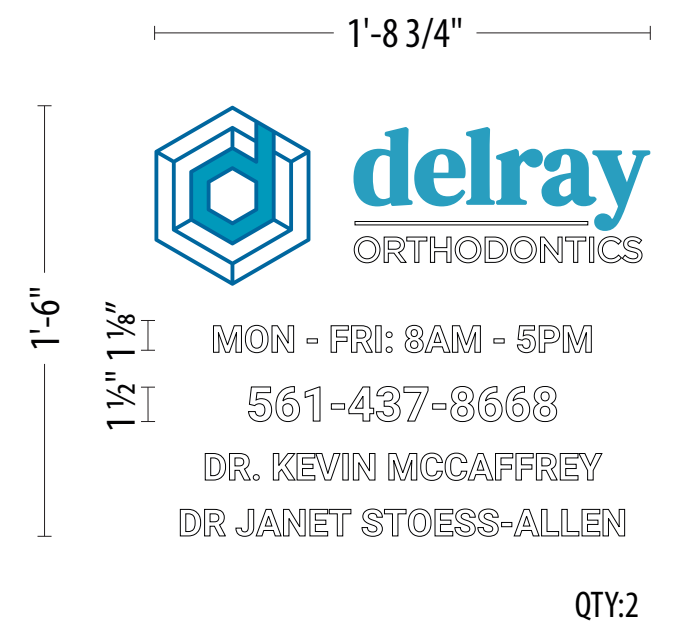
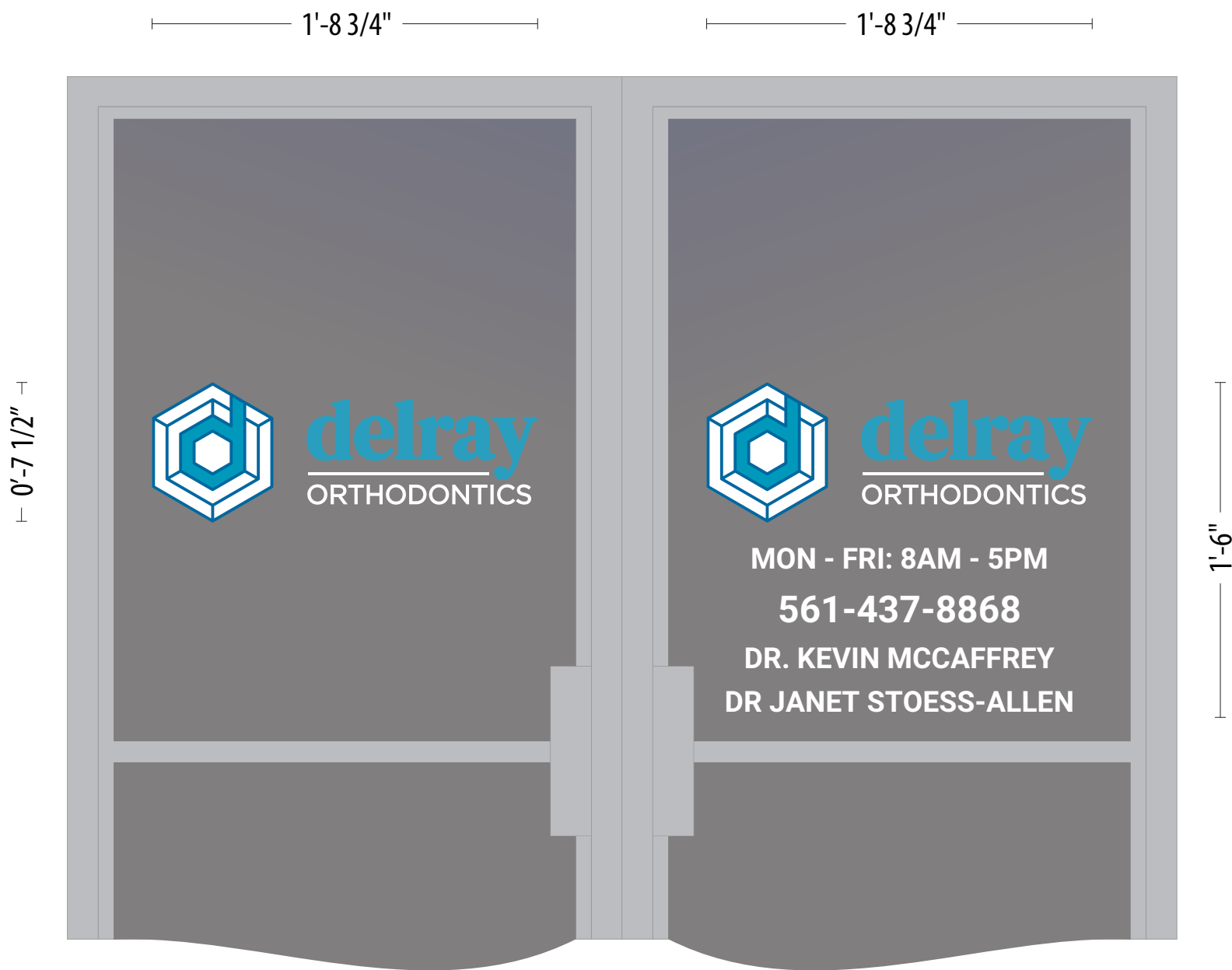

BLACK OUTLINE FOR VISUAL PURPOSE ONLY

D DOOR VINYL SCALE: 1 1/2" = 1'

SCOPE OF WORK:
MANUFACTURE & INSTALL (4) FOUR RTA DOOR VINYL GRAPHICS
FIRST SURFACE
ORACAL 751 - WHITE
ORACAL 8500-053 LIGHT BLUE ●
ORACAL 8500-528 GRAY BLUE ●

1.08 SQ.FT (EA)



7923 E. McKinney St., Denton, TX 76208
0 817.431.5700 F 817.431.5799
 UL E226292 BBB TDLR 18933

JOB DESCRIPTION	ILLUMINATED CHANNEL LETTERS	DATE	BY	REV	
COMPANY OR JOB NAME	MB2_DELRAY ORTHODONTICS	02.15.23	JR	R9	CHANGE WIREWAY TO RACEWAY
CUSTOMER CONTACT		02.22.23	JR	R10	CHANGE DOOR VINYL TO 4QTY
ADDRESS	10N SE 1ST AVE. STE B&C DELRAY BEACH, FL 33444	11.22.24	CJR	R11	CHGD TO NON-ILLUM.
PHONE					
EMAIL					
FILE NAME	DELRAY ORTHODONTICS				
SALESMAN	ROGER CHUNG				