

Commercial / Multi Family Landscape Tabulations	
A. TOTAL LOT AREA	K. TOTAL INTERIOR SHADE TREES REQUIRED
12,288 s.f.	2 (1/125)
B. STRUCTURES, PARKING WALKWAYS, DRIVES, ETC.	L. TOTAL INTERIOR SHADE TREES PROVIDED
9,112 s.f.	6 (palms)
C. TOTAL PERVIOUS LOT AREA	M. TOTAL L.F. SURROUNDING PARKING OR VEHICULAR USE AREA
3,176 s.f.	166 l.f.
D. AREA OF SHRUBS & GROUNDCOVERS REQUIRED	N. TOTAL NUMBER OF PERIMETER TREES REQUIRED
953 s.f. (30% of "C")	6 (M/30)
E. AREA OF SHRUBS & GROUNDCOVERS PROVIDED	O. TOTAL NUMBER OF PERIMETER TREES PROVIDED
1,107 s.f.	7
F. NATIVE VEGETATION REQUIRED	P. TOTAL NUMBER OF EX. TREES TO BE SAVED ON SITE
238 s.f. (25% of "D")	8
G. NATIVE VEGETATION PROVIDED	Q. TOTAL NUMBER OF NATIVE TREES REQUIRED
455 s.f.	4 (50% of total required trees) (K+N x 0.5)
H. TOTAL PAVED VEHICULAR USE AREA	R. TOTAL NUMBER OF NATIVE TREES PROVIDED
2,118 s.f.	9
I. TOTAL INTERIOR LANDSCAPE AREA REQUIRED	S. TOTAL NUMBER OF OF TREES ON PLAN PROVIDED
211 s.f. (10% of "H")	17 (8 existing trees and palms & 8 proposed trees)
J. TOTAL INTERIOR LANDSCAPE AREA PROVIDED	
388 s.f.	

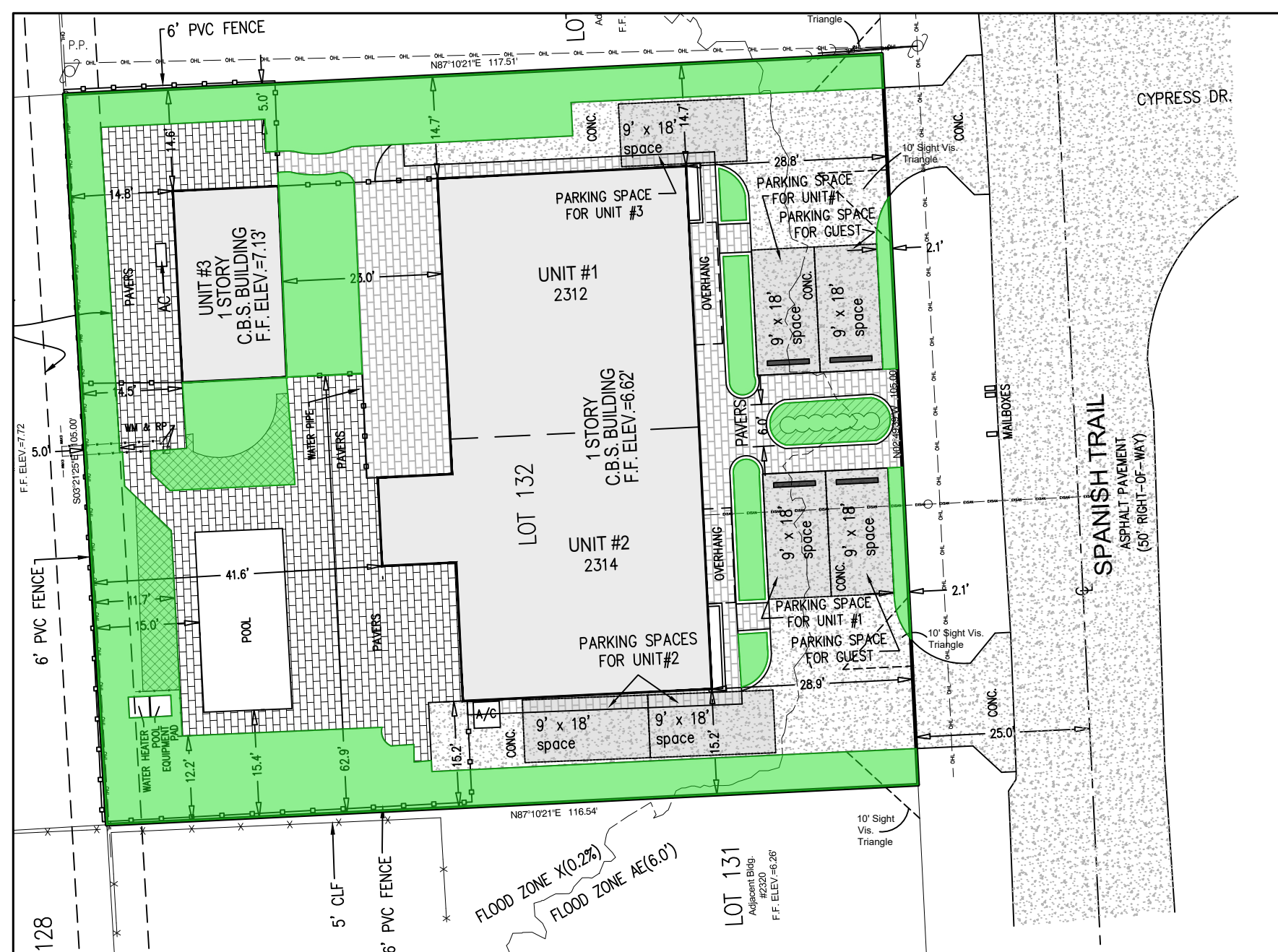

Site Area	12,288 sf	100%
Total Open Space (green shaded area on plan)	3,300 sf	26.8%

OPEN SPACE EXHIBIT

Scale 1" = 20'

- ## Standard Landscape Notes

1. All landscape and specifications shall meet or exceed the minimum requirements as provided by the City of Delray Beach Land Development Code.
2. All planting material shall meet or exceed Florida Grade #1 as specified in Grades and Standards for Nursery Plants, current edition.
3. All sizes shown for plant material on the plan are to be considered as minimums. All plant material must meet or exceed these minimum requirements for both height and spread. Any other requirements for specific shape or effect as noted on the plan will also be required for acceptance.
4. Landscape shall be placed to edge of abutting ROW, canals, lakes or other lands.
5. All mechanical equipment, air conditioning, irrigation pump stations and equipment, fpl transformers, pool pumps, etc. must be screened on three (3) sides by landscape shrubs. Note: the quantity of screening shrubs may be in addition to the required number of shrubs as provided in the code calculation table. All screening shrubs shall be planted for proper operation of equipment being screened and/or per the requirements of the utility as necessary.
6. Guying/staking practices shall not permit nails, screws, wires, etc. to penetrate outer surfaces of trees, palms or other planted material. Trees, palms and plant material will be rejected due to this practice.
7. Burlap material, wire cages, plastic/canvas straps, etc. must be cut and removed for the top one-half (1/2) depth of the root ball. Trees and shrubs grown in grow bags or grow bag type material must have such material removed entirely prior to planting the tree or shrub.
8. All plant material shall be free of pests, insects, disease, weeds, etc.
9. All plant material shall be planted at the proper depths, as originally grown and/or so the top of the root ball is flush or slightly above finished grade immediately after planting. All trees should provide trunk taper when properly planted at the correct planting depth.
10. All plant material shall be watered in at time of planting to eliminate air pockets in the root zone area.
11. Upon completion of work, the site shall be cleared of all debris, superfluous materials, and equipment caused by this permit.
12. All landscaped areas shall be provided with an underground fully automatic irrigation system using pop-up sprinklers. System shall provide 100% coverage with a 75% overlap (minimum) using rust-free water, except any preserved areas remaining in natural state. A rain sensor device or switch shall be installed that will override the irrigation system when adequate rainfall has occurred. Water shall not be directed and/or provided onto impervious surfaces and/or be designed or installed to throw water over an impervious surface such as a sidewalk, etc. Hours of operation for all irrigation systems shall be limited to 5:00 p.m. to 8:00 a.m. only or as may be further restricted by South Florida Water Management District or other jurisdictional agency.
13. All plant material and work shall be guaranteed for one-year from date of final job acceptance. During the one year guarantee, any plant material that dies or is in an unhealthy condition shall be replaced with the same plant type at least equal to the size and quality originally specified. The replacement material shall also be guaranteed for one year from the date of its installation. The guarantee will be null and void if plant material is damaged or killed by lightning, hurricane force winds, hail or freeze.
14. The landscape contractor is responsible for verifying there are no conflicts with above or below ground utilities prior to commencing landscape installation. Notify owner if conflicts exist.
15. Any trees to remain shall be pruned in such a way to promote proper horticultural and natural tree growth.
16. All trees and palms placed closer than 10' from underground utilities shall receive root barrier. See detail this sheet.
17. Ground covers shall be spaced as noted or to insure ground cover within 6 months of planting.
18. Place sod on smooth sod bed. Remove any rocks and other debris prior to sodding. Sod shall be placed so there are no gaps or voids between pieces. On slopes place sod at 90° to slope direction. Stake sod or otherwise ensure its establishment on slopes.
19. Mulch shall be eucalyptus or melaleuca mulch. All trees in sod areas are to have a 30" ring covered with a 3" layer of mulch. Cover all shrub beds with a 3" layer of mulch. Mulch shall not touch tree, palm or shrub trunks or stems.
20. All plant material shall be fertilized with a tablet form balanced fertilizer containing minor elements. Follow manufacturer's recommendations for rates. sod areas shall be fertilized with a granular form balanced fertilizer with minor elements following manufacturer's recommendations for rates.
21. Planting soil shall be a mix of 1/3 native soil, 1/3 clean sand & 1/3 peat as shown on the planting plan. If native soil is unacceptable, contact landscape architect.
22. Reinforced concrete curbing at least 6" in height shall be provided around all landscape islands and as a separator between all landscape areas that are adjacent to vehicular use areas unless such curbing will interfere with the drainage the drainage.
23. The landscape irrigation system shall utilize reclaimed water, when available and where allowed by Florida Statutes, from one master meter located at the property line. Coordinate location and service with the City of Delray Beach Public Utilities Department.