

1. ANY DAMAGE TO ANY ROADWAY
PAVEMENT LIKE UTILITY CUTS OR
EDGE REPAIR SHALL BE MILLED AND
RESURFACED FOR 50' EACH WAY
PAST THE LIMIT OF THE DAMAGE PER
CITY OF DELRAY BEACH STANDARD
DETAIL GU 1.0.
2. ANY TREES OR SHRUBS PLACED
WITHIN WATER, SEWER OR DRAINAGE
EASEMENTS SHALL CONFORM TO THE
CITY OF DELRAY BEACH STANDARD
DETAILS; LD 1.0 & LD 2.0.

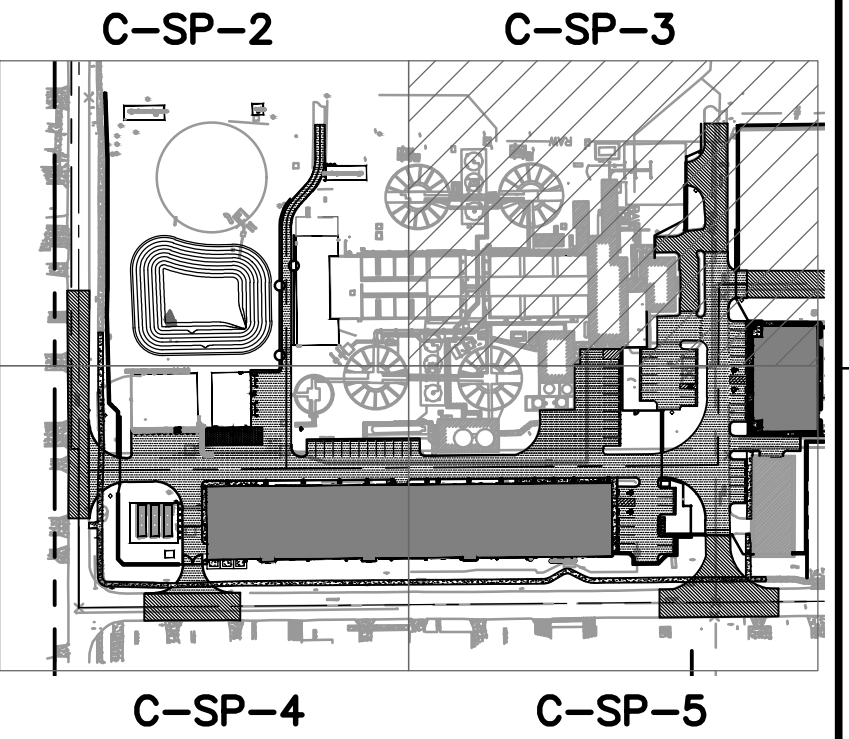

1"=200'-0"

PROPOSED ASPHALT
PAVEMENT
PROPOSED SIDEWALK
EXISTING SIDEWALK
HEAVY DUTY
CONCRETE PAVEMENT
MILL AND RE-PAVE EX
ASPHALT PAVEMENT
PERIMETER WALL
EXISTING BUILDING
PROPOSED BUILDING
ROOF OVERHANG

MATCH LINE

PROPERTY LINE

8-FT HEIGHT AL
PICKET STYLE FE

SIGHT TRIANGLE

PROPOSED
TREES

PROPOSED
PALMS

RELOCATED PALMS

TOB- TOP OF BANK ELEVATION
TOE- TOE OF EMBANKMENT
ELEVATION
FFE- FINISHED FLOOR ELEVATION
TOS- TOP OF SLAB ELEVATION

NOTES:

1. REFER TO CIVIL SHEET C-GN-1
FOR SYMBOLS AND LEGEND.
2. REFER TO GENERAL SHEET G-13
FOR SURVEY NOTES AND
SYMBOLS
3. REFER TO STRUCTURAL
DRAWINGS FOR ELEVATION OF
STRUCTURAL FOUNDATION AND
SLABS ON GRADE.
4. REFER TO ELECTRICAL DRAWINGS
FOR GATE MOTOR POWER
5. REFER TO OVERALL SITE LAYOUT
& PAVING PLAN (C-SP-1) FOR
LIMITS OF MILL & RE-PAVE IN
THIS AREA.

THIS ITEM HAS BEEN DIGITALLY SIGNED
BY DAVID A RAUCH ON THE DATE
ADJACENT TO THE SEAL.

PRINTED COPIES OF THIS DOCUMENT
ARE NOT CONSIDERED SIGNED AND
SEALED AND THE SIGNATURE MUST BE
VERIFIED ON ANY ELECTRONIC COPIES.

A circular professional engineer seal for David A. Rauch. The outer ring contains the text "DAVID A. RAUCH" at the top and "PROFESSIONAL ENGINEER" at the bottom, separated by two stars. The inner circle contains the text "LICENSE" at the top, "NO. 100785" in the center, a small star below the number, and "STATE OF FLORIDA" at the bottom.

DATE:
DAVID A RAUCH
PE NO. 100785

PROJECT NO. 159676-291242
FILE NAME: C-SP-3.DWG

SHEET NO.

C-SP-3

ISSUED FOR PERMITTING

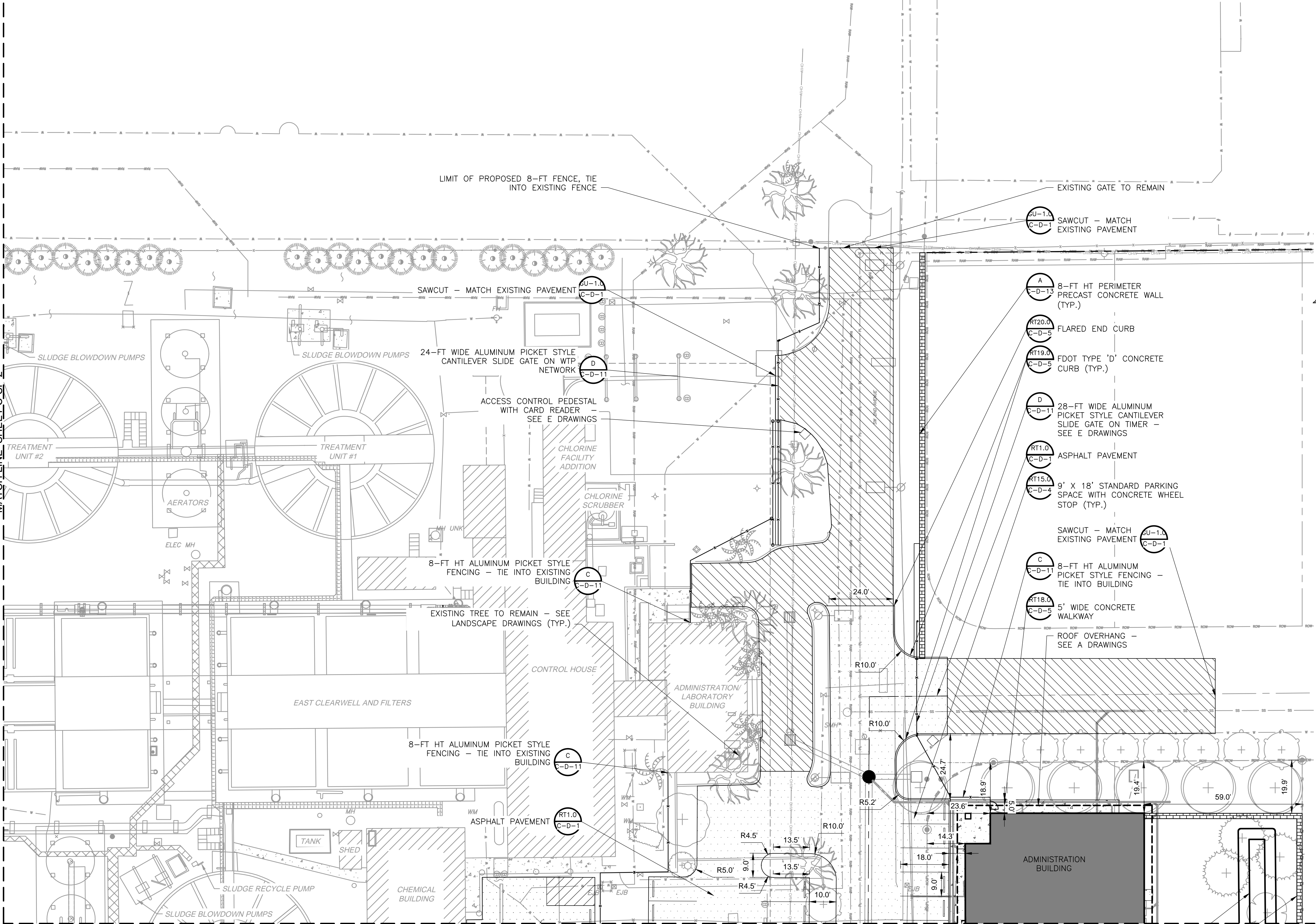

PLAN

$$1'' = 20' - 0''$$

6' WIDE CONCRETE
WALKWAY

8-FT HEIGHT PERIMETER PRECAST
CONCRETE WALL (TYP.)

DRY RETENTION SWALE

PERIMETER PRECAST
CONCRETE WALL (TYP.)

REV. NO.	DATE	DRWN	CHKD	REMARKS

DESIGNED BY: _____ J. HEIL
DRAWN BY: _____ Z. MILLER
SHEET CHK'D BY: _____ W. MASON
CROSS CHK'D BY: _____ M. DODSON
APPROVED BY: _____ D. RAUCH
DATE: _____ SEPTEMBER 2025

**CDM
Smith**
621 N.W. 53rd St., Suite 265
Boca Raton, FL 33487
Tel: (561) 571-3800



DELRAY BEACH, FLORIDA
DELRAY BEACH
MEMBRANE WATER TREATMENT PLANT

SITE LAYOUT & PAVING PLAN II

PROJECT NO. 159676-291242
FILE NAME: C-SP-3.DWG

SHEET NO.

C-SP-3

Figure 1

last saved by: MILLERZA Time: 8/22/2025 9:13:31 AM
 C:\Users\millerza\Documents\CDM Smith Inc\Deploy Membrane WTP\Project Files\Design\02 Civil\10 CADD\C-SP-3.dwg
 © 2025 CDM SMITH ALL RIGHTS RESERVED.

ISSUED FOR PERMITTING



DESIGNED BY: _____ J. HEIL
DRAWN BY: _____ Z. MILLER
SHEET CHK'D BY: _____ W. MASON
CROSS CHK'D BY: _____ M. DODSON
APPROVED BY: _____ D. RAUCH
DATE: _____ SEPTEMBER 2025

**CDM
Smith**
621 N.W. 53rd St., Suite 265
Boca Raton, FL 33487
Tel: (561) 571-3800

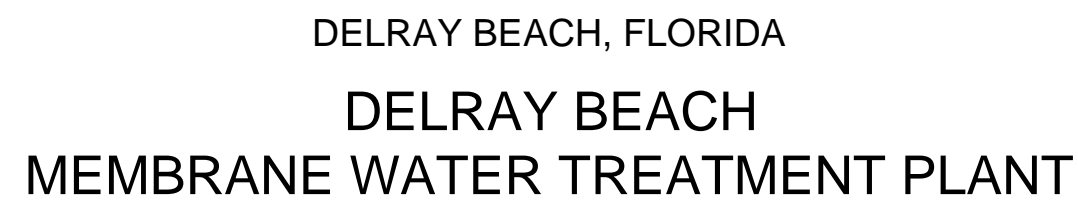

PROJECT NO. 159676-291242
FILE NAME: C-SP-5.DWG

C-SP-5

ISSUED FOR PERMITTING

KEY PLAN
1"=200'-0"

TOB- TOP OF BANK ELEVATION
TOE- TOE OF EMBANKMENT ELEVATION
FFE- FINISHED FLOOR ELEVATION
TOS- TOP OF SLAB ELEVATION

NOTES:

1. REFER TO CIVIL SHEET C-GN-1 FOR SYMBOLS AND LEGEND.
2. REFER TO GENERAL SHEET G-13 FOR SURVEY NOTES AND SYMBOLS
3. REFER TO STRUCTURAL DRAWINGS FOR ELEVATION OF STRUCTURAL FOUNDATION AND SLABS ON GRADE.
4. REFER TO ELECTRICAL DRAWINGS FOR GATE MOTOR POWER.
5. REFER TO OVERALL SITE LAYOUT & PAVING PLAN (C-SP-1) FOR LIMITS OF MILL & RE-PAVE IN THIS AREA.

THIS ITEM HAS BEEN DIGITALLY SIGNED
BY DAVID A RAUCH ON THE DATE
ADJACENT TO THE SEAL.

PRINTED COPIES OF THIS DOCUMENT
ARE NOT CONSIDERED SIGNED AND
SEALED AND THE SIGNATURE MUST BE
VERIFIED ON ANY ELECTRONIC COPIES.

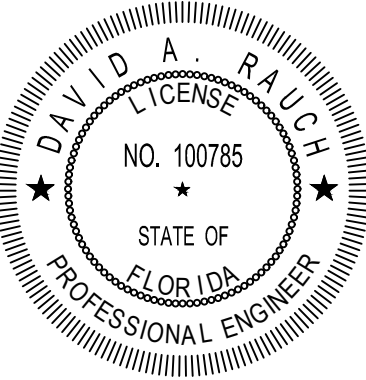

DATE:
DAVID A RAUCH
PE NO. 100785

FLOOD HAZARD DOCUMENTATION		
LOCATION NAME:	DELRAY BEACH WTP	
LOCATION COORDINATES:	NORTHING:	771035
	EASTING:	958438
PARAMETER	VALUE	NOTES
FEMA FLOOD MAP	12099C0979G	
FEMA BASE (100-YEAR) FLOOD ELEVATION	NOT APPLICABLE	SITE IS NOT WITHIN 100-YEAR FLOOD ZONE
FLOOD ZONE	ZONE X (UNSHADED)	AREA OF MINIMAL FLOOD HAZARD
IS PROJECT SITE HIGHER THAN THE 100-YEAR FLOOD ELEVATION	YES	
IS PROEJECT SITE HIGHER THAN THE 500-YEAR FLOODPLAIN	YES	
BASE FLOOD ELEVATION, BFE (FT, NAVD1988):	8	NEAREST 100-YR FLOOD ELEVATION TO THE PROEJECT SITE ON FIRM MAP (NAVD1988) IS FROM THE INTERCOASTAL WATERWAY EAST OF SE 4TH AVENUE
FLOOD DESIGN CLASS	4	ASCE 24-14 TABLE 1-1
CROWN OF ROAD ADJACENT TO STRUCTURE (FT, NAVD1988)	19.6	
PROPOSED STRUCTURE FINISHED FLOOR EL. (FT, NAVD88)	VARIES (21.25-22.0)	FFE ELEVATION IS APPROX. 1.65-FT ABOVE ROAD CROWN.
MINIMUM FINISHED FLOOR EL.		ASCE 24-14 TABLE 2-1
CRITERION	BFE + 2 FT	
REQUIRED VALUE (FT, NAVD1988)	10	
DESIGN VALUE (FT, NAVD1988)	21.5	
COMPLIES	YES	
MINIMUM EQUIPMENT EL.		ASCE 24-14 TABLE 7-1
CRITERION	BFE + 2 FT	
REQUIRED VALUE (FT, NAVD1988)	10	
DESIGN VALUE (FT, NAVD1988)	21.25	
COMPLIES	YES	
ASCE 24-14: AMERICAN SOCIETY OF CIVIL ENGINEERS STANDARD TITLED "FLOOD RESISTANT DESIGN AND CONSTRUCTION".		
NAVD: NORTH AMERICAN VERTICAL DATUM.		
BFE: BASE FLOOD ELEVATION		
WTP: WATER TREATMENT PLANT		

NON-CONFORMITIES CHART			
NO.	LDR REFERENCE CHAPTER/ SECTION	REQUIRED	PROVIDED
1	LDR SECTION 4.6.9(D)	PROVISIONS MUST BE MADE FOR STACKING AND TRANSITION OF INCOMING VEHICULAR TRAFFIC FROM A PUBLIC STREET INTO A PRIVATE PROPERTY TO MAINTAIN A CLEAR AND SAFE PATH FOR VEHICLES, BICYCLISTS, AND PEDESTRIANS. VEHICLES SHALL NOT QUEUE INTO OR OBSTRUCT THE PUBLIC RIGHT-OF-WAY, NOR PLANNED OR EXISTING PUBLIC INFRASTRUCTURE IN THE ULTIMATE RIGHT-OF-WAY, PER ALWAYS DELRAY TABLE MBL-1, STREET NETWORK CLASSIFICATION AND IMPROVEMENTS. (ORD. NO. 11-20, 3, 12-8-20)	N/A

ADMINISTRATIVE BUILDING		
POINT TABLE		
POINT NO.	NORTHING	EASTING
41	771033.24	958862.43
42	771033.24	958871.76
43	771044.57	958871.76
44	771044.58	958929.22
45	770935.19	958929.24
46	770935.11	958871.78
47	770946.45	958871.78
48	770946.44	958862.51

CONCRETE WALL			
POINT TABLE			
POINT NO.	NORTHING	EASTING	
109	770805.54	958783.23	
110	770807.65	958772.01	
111	770805.61	958772.81	
112	770798.49	958762.76	
113	770796.47	958763.80	
114	770798.32	958738.76	
115	770796.27	958736.77	
116	770804.36	958738.72	
117	770803.52	958736.72	
118	770809.39	958733.74	
119	770807.33	958732.91	
120	770809.39	958715.72	
121	770807.39	958715.71	

ACCESS ROAD		
POINT TABLE		
POINT NO.	NORTHING	EASTING
59	771254.20	958406.21
60	771218.49	958406.21
61	771191.58	958395.81
62	771175.96	958381.60
63	771149.05	958371.20
64	771001.69	958371.20
65	770996.69	958366.20
66	771254.23	958416.21
67	771218.49	958416.21
68	771184.86	958403.21
69	771150.12	958381.20
70	770921.00	958381.20

SITE ZONING, PROJECT DATA & CONTROL POINT TABLE

A circular professional engineer seal for David A. Rauch. The outer ring contains the name "DAVID A. RAUCH" at the top and "PROFESSIONAL ENGINEER" at the bottom, separated by two stars. The inner circle contains the word "LICENSE" at the top, the license number "NO. 100785" in the center, and "STATE OF FLORIDA" at the bottom, also separated by two stars.

DATE:
DAVID A RAUCH
PE NO. 100785

PROJECT NO. 159676-291242
FILE NAME: C-SP-6.DWG

C-SP-6

ISSUED FOR PERMITTING

