

GENERAL NOTES:

- Review and approval by the AHJ shall not relieve the applicant of the responsibility of compliance with this Code per NFPA 1.1.14.4.
- Depict all emergency lights/EXIT
- Additional Exit signs and Emergency Lights may be required by the Fire Inspector at the time of the fire final.
- All doors in the means of egress shall be Single Action Release and Shall Not Require the use of a key, tool, or special knowledge to open from egress side shall comply with NFPA 101:7.2.1.5.1 and NFPA 1.1.7.2.1.5.2.
- Fire extinguishers shall be mounted at 48" AFF and shall be currently dated and tagged by licensed Fire Extinguisher Company.
- The numerical address will be provided on ALL exterior doors as per City Ordinance 52.10 with 6 inch numbers, weatherproof, and contrasting colors.
- All doors in the mean of egress shall be Single Action Release and Shall Not Require the use of a key, tool, or special knowledge to open from egress side shall comply with NFPA 101:7.2.1.5.1 and NFPA 1.1.7.2.1.5.2.

GATE	
WIDTH	96"
INCH PER OCCUPANT	0.2
#ALLOWED	480

GATE	
WIDTH	96"
INCH PER OCCUPANT	0.2
#ALLOWED	480

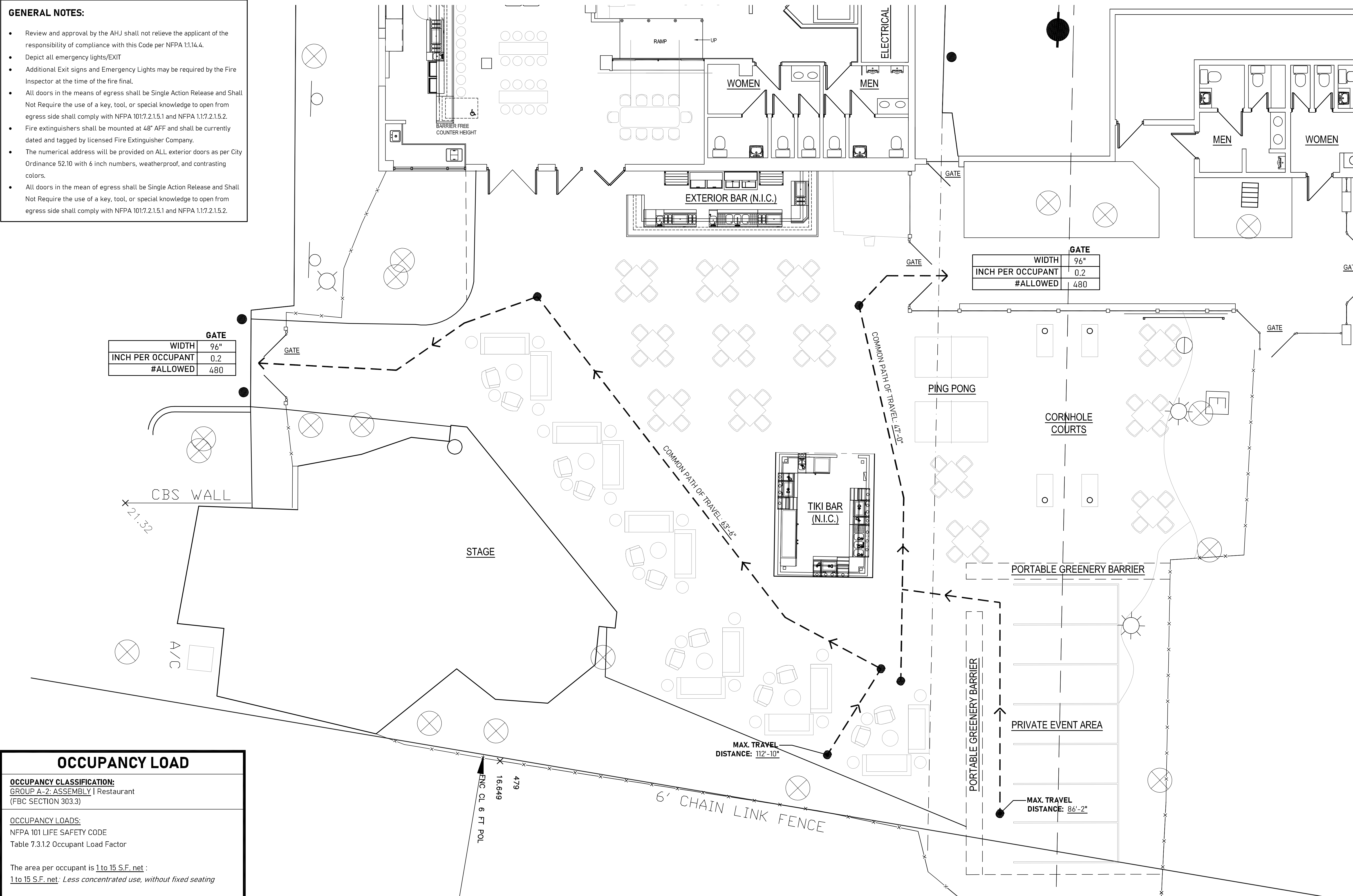

OCCUPANCY LOAD

OCCUPANCY CLASSIFICATION:
 GROUP A-2: ASSEMBLY | Restaurant
 (FBC SECTION 303.3)

OCCUPANCY LOADS:
 NFPA 101 LIFE SAFETY CODE
 Table 7.3.1.2 Occupant Load Factor

The area per occupant is 1 to 15 S.F. net :
 1 to 15 S.F. net: *Less concentrated use, without fixed seating*

CALCULATION
 FLOOR AREA: 7,158 S.F. / 15 S.F. net = 477.2 persons

***Total Square Footage:** 7,158 S.F.
***Total Occupants** = 477.2 persons

1 EXTERIOR LIFE SAFETY PLAN
 SCALE: 3/16" = 1'-0"

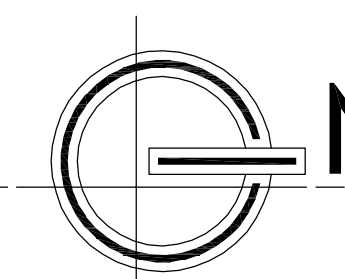

DESIGN PROFESSIONAL IN RESPONSIBLE CHARGE
 SUPRADEEP L. KANTHAN, AIA, NCARB
 631 POTTER ROAD,
 BOYNTON BEACH, FL 33435
 REGISTERED ARCHITECT
 FL. ARCH0711 PA. RA407852
 REGISTERED INTERIOR DESIGNER
 FL. ID4695
KANTHAN DESIGN CORPORATION
 631 POTTER ROAD,
 BOYNTON BEACH, FL 33435
 REGISTERED ARCHITECT BUSINESS
 FL. AA26032421 PA. AX01596
 REGISTERED INT. DESIGN BUSINESS
 FL. IB26201929
 www.kanthandesign.com

THROW SOCIAL
 55 SE 2nd Avenue,
 Delray Beach, FL 33444,
 Palm Beach County, Florida

REVISIONS

NO.	DESCRIPTION

THE USE OF THESE SPECIFICATIONS AND PLANS SHALL BE RESTRICTED TO THE ORIGINAL CLIENT AND SITE FOR WHICH THEY WERE PREPARED. ANY REPRODUCTION OR DISTRIBUTION IS EXPRESSLY LIMITED TO SUCH USE. ANY OTHER REPRODUCTION, REUSE, OR DISCLOSURE BY ANY METHOD, IN WHOLE OR IN PART, IS PROHIBITED. THESE DRAWINGS AND SPECIFICATIONS CONTAIN PROPRIETARY INFORMATION AND TITLE REMAINS WITH KANTHAN DESIGN CORPORATION.

P:\2021\kcorp\21040 THROW Social (Delray Beach)\21040 THROW Social 02.dwg, 7/19/2021 3:51:32 PM