

MICROLOOK BOLLARD



Type: C FIXTURE
Project: 314 NE 3RD AVE
SPECIFICATION SHEET Page 1 of 4

Collection of bollards for commercial and institutional applications. Exceptional European build quality with high corrosion resistant finish. Robust marine grade die-cast aluminum construction with stainless steel fasteners and factory sealed micro-prismatic glass diffuser.

Luminaire characteristic:
Power input: 4.5W (system wattage)
Lumens: 240lm (for 3000K, 80CRI)
Luminaire efficacy: 58lm/W

Source:
White LED (LM-80):
2700K: 80CRI,
3000K: 80CRI,
4000K: 80CRI
70% of initial lumens at 50,000 hours (L70)

Lumen maintenance:
70% of initial lumens at 50,000 hours (L70)

Optic: Accent light optic.

Material: Body: Die-cast aluminum
Diffuser: Tempered glass.

Mounting: Install with flange accessory or fasten to ground. Supplied with 3ft (1m) of the power cable.

Electrical: Integral high efficiency LED driver, rated at 50,000 hours, 120V/277V.

Dimming: 0-10V (120-277V), down to 15%.

Finish: White painted (RAL9003), aluminum gray or burnished bronze.

Weight: S7212: 3.3lbs (1.5kg)
S7213: 5.3lbs (2.4kg)

Warranty: 5 year limited warranty.

Ratings: IP65

Certification: cULus listed for wet location.

MICROLOOK BOLLARD

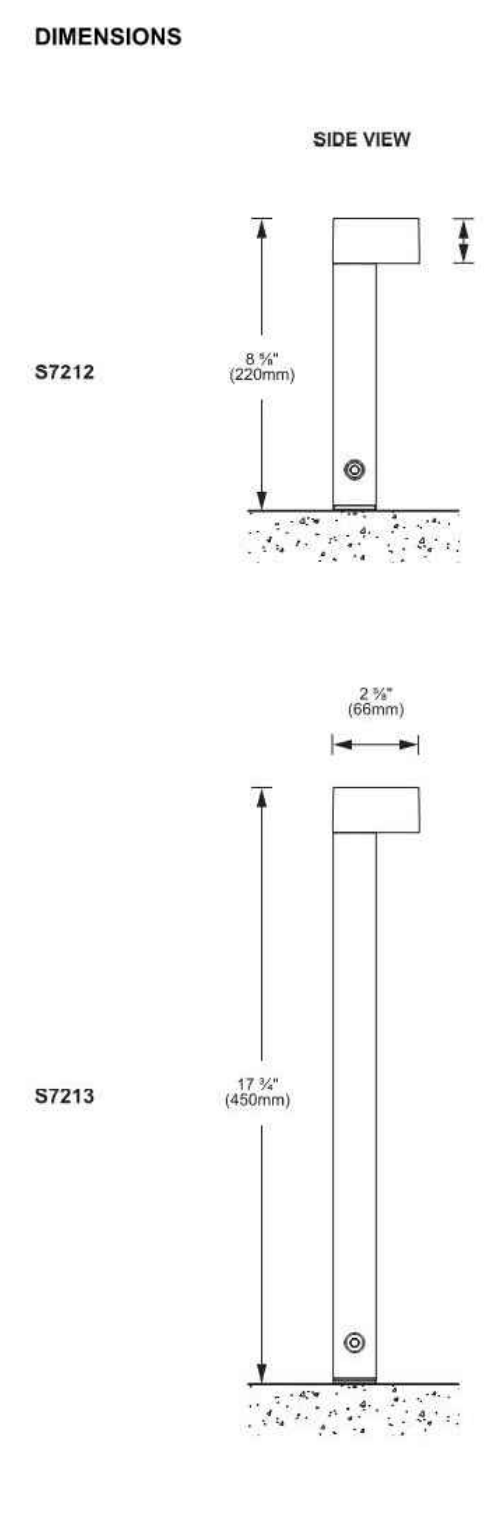

Type: C FIXTURE
Project: 314 NE 3RD AVE
SPECIFICATION SHEET Page 2 of 4

Due to continuous improvements, the information herein may be changed without notice.

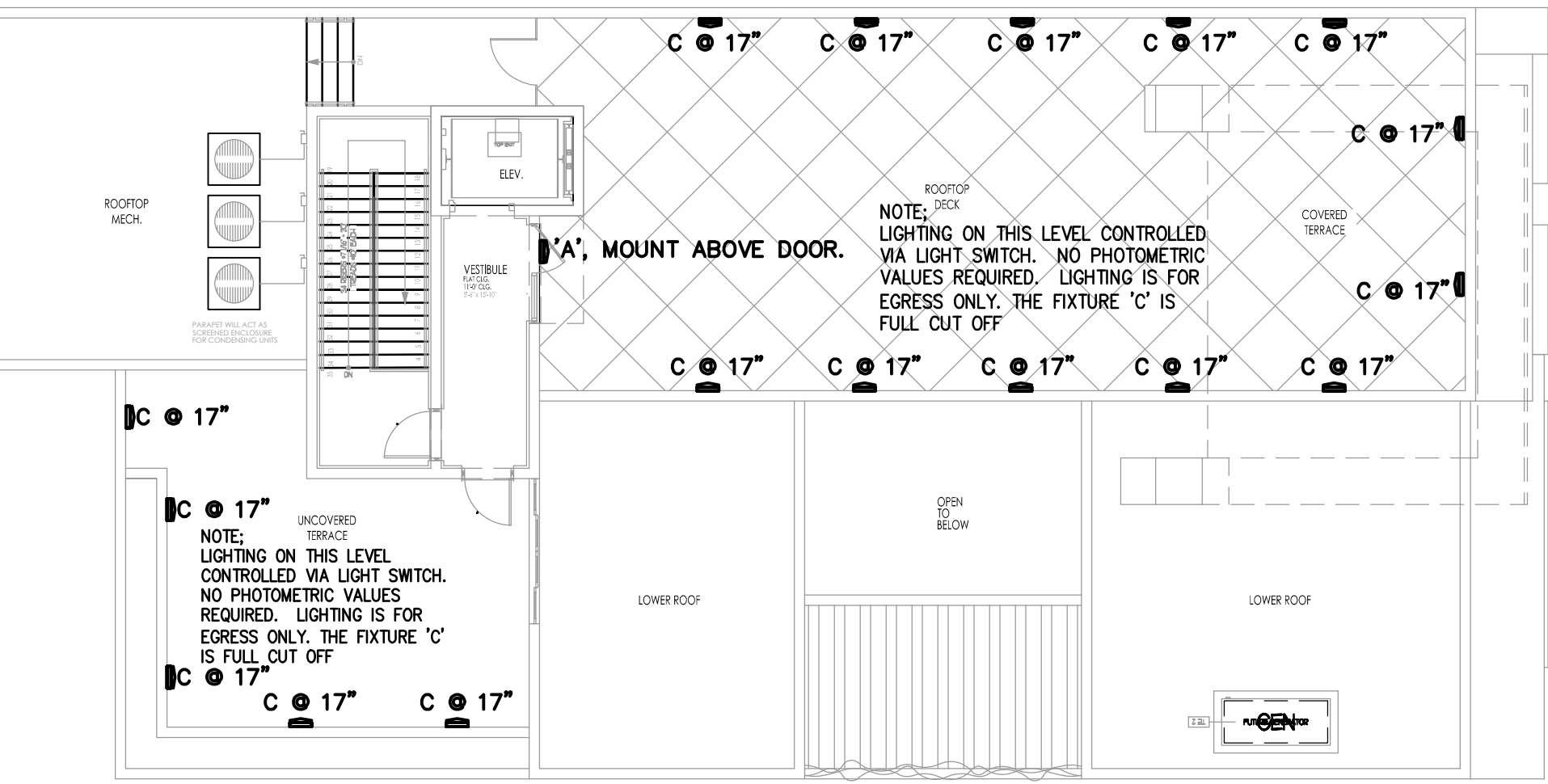

Statistics

Description	Symbol	Avg	Max	Min	Max/Min	Avg/Min
BACK ENTRY WALK	+	3.9 fc	5.2 fc	2.9 fc	1.8:1	1.3:1
FRONT ENTRY	+	3.0 fc	3.1 fc	2.9 fc	1.1:1	1.0:1
NORTH PROP. LINE	+	0.1 fc	1.0 fc	0.0 fc	N/A	N/A
PARKING LOT	+	2.1 fc	2.6 fc	1.6 fc	1.6:1	1.3:1
SOUTH PROPERTY LINE	+	0.0 fc	0.2 fc	0.0 fc	N/A	N/A
ALLY	+	0.6 fc	1.1 fc	0.1 fc	11.0:1	6.0:1

Schedule

Symbol	Label	Quantity	Manufacturer	Catalog Number	Description	Number Lamps	Lumens Per Lamp	Light Loss Factor	Wattage
⊖	A	3	SISTEMALUX	S7213	Look Applique 28 LED Osram Duris E5 24V White Warm 3000K	1	475	0.95	13.4
⊖	B	1	Lithonia Lighting	DSXO LED P1 40K T3S MVOLT HS	DSXO LED P1 40K T3S MVOLT with housingside shield	1	3912	0.95	38
⊖	C	17	SISTEMALUX	S7201W.14	17" Bollard	1		0.95	4.2
⊖	D	1	Kenall	MR13FFL-PP-MW-10L40K-DCC-DV	MR13FD	36	31	0.95	12.95

SISTEMALUX

Due to continuous improvements, the information herein may be changed without notice.

SISTEMALUX

Due to continuous improvements, the information herein may be changed without notice.

2 ROOF LIGHTING PLAN

MILLENNIUM EDGE™

MR13/MR17 SERIES - FLAT FACE LOW PROFILE

PRODUCT FEATURES:
• Surface mount - ceiling or wall.
• 17" (443mm) x 1.75" (44mm) x 1.75" (44mm) (MR17)
• Peace of Mind Guarantee™ against breakage available.
• Dust and water protected to IP64 standards.
• Full cut-off for "Dark Approved™" Dark Sky installations - Ceiling Mount only.
• ADA compliant.

SPECIFICATIONS:
BASEPLATE: Marine grade die-cast aluminum. Integral heat sinks. Boreplate flange inserts and wraps around lens base providing maximum moisture deflection and resistance to prying. Boreplate provided with four-point mounting holes, one airway hole and temporary junction box mounting brackets. Standard matte black, dark bronze or marine white powder coat. 5-step pre-treatment.
REFLECTOR: Full reflective cover - 92% reflectivity.
LENS: UV stabilized, high impact resistant, virgin injection molded polycarbonate. Close tolerance push/tuck-in place mating of injection molded lens and lens base. Lens and lens base secured with one concealed optical "lock" with center pin fastener.
HEIGHT: High impact resistant, injection molded marine black, dark bronze or marine white polycarbonate.
GASKETING: Die-cut, closed cell neoprene self adhesive gasket seals baseplate to mounting surface. Closed cell, "silicone" "T" ring gaskets positioned and friction secured in gasket channels of lens base. Baseplate and optional surface adapter.
HARDWARE: One stainless steel "nut" with center pin fastener.
ELECTRICAL: Available in 3000K, 4000K, and 5000K color temperatures, 80 CR, 120-277VAC, 50/60Hz electrical input with high power factor electronic, constant current driver (c>98 PF) Standard. 5-10 Joules with 1500V surge protection driver source of 200 µA.
PHOTOMETRICS: Photometry tested to the IESNA LM-79-09 standard by an IAC/ISO 9001:2015 accredited laboratory. For additional photometric data, please go to www.tecfla.com.
WARRANTY: One (1) year warranty against defects in materials and workmanship. Five (5) year warranty on LED lamps and driver for defects resulting in a failure based on depreciation of 30% or greater.
LISTINGS: Luminaire is certified to UL Standards by either Underwriters Laboratory or Intertek Testing Laboratory by Wet Location. Listing includes Emergency Battery Pack "L12" option. UL certified IP64 per IEC 60598. ESDA designated full cut-off, "Dark Approved™" Dark Sky Friendly Fixture - Ceiling Mount only.



D-Series Size 0 LED Area Luminaire

Introduction
The modern styling of the D-Series is striking yet unobtrusive - making a bold, progressive statement even as it blends seamlessly with its environment. The D-Series distills the benefits of the latest in LED technology into a high performance, high efficacy, long life luminaire. The outstanding photometric performance results in sites with excellent uniformity, greater pole spacing and lower power density. It is ideal for replacing up to 400W metal halide with typical energy savings of 70% and expected service life of over 100,000 hours.

MINI LOOK WALL



Specification Sheet Page 1 of 3
Project name: 314 NE 3RD AVE
Type: A



Wall mounted accent light luminaire with direct light distribution that provides ambient light on vertical surfaces. Suitable for exterior applications.

Luminaire characteristics:
Power input: 13.5W
Lumens: 475 lm (delivered for 3000K)
Luminaire efficacy: 35 lm/W (for 3000K)

Source: Source: White LED, LM-80 tested.
3000K: 80CRI,
4000K: 80CRI,
5000K: 80CRI

Lumen maintenance: >70% of initial lumens at 50,000 hours (L70) (LM-79 tested).

Options: Accent light.

Material: Body: Die-cast aluminum
Diffuser: Tempered glass.
Mounting plate: Aluminum.

Electrical: Universal high efficiency electronic power supply, rated at 50,000 hours, 120-277V. See page 3 for remote power supply options.

Mounting: See mounting options on page 2.

Finish: White, Aluminum gray, or Burnished bronze.

Weight: 2.2lbs (1kg)

Warranty: 5 year limited warranty.

Certification: cULus listed for wet location.

Ratings: IP65, IK08

MINI LOOK WALL

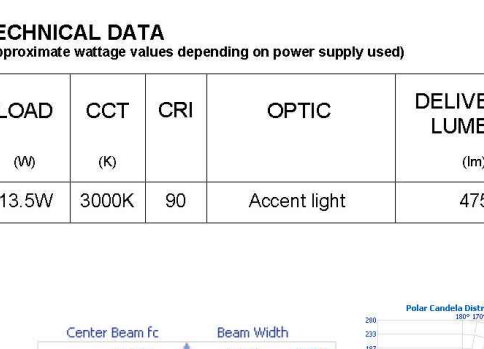

Specification Sheet Page 2 of 3
Project name: 314 NE 3RD AVE
Type: A

TECHNICAL DATA

(Approximate wattage values depending on power supply used)

LOAD	CCT	CRI	OPTIC	DELIVERED LUMENS	LUMINAIRE EFFICACY	CENTER BEAM CANDLE POWER	MODEL
13.5W	3000K	90	Accent light	475	35	275	S.7201W

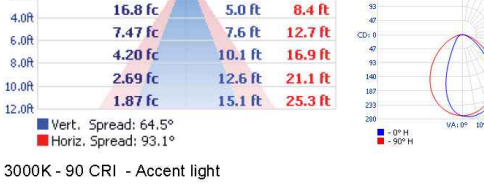

SURFACE MOUNTING OPTIONS

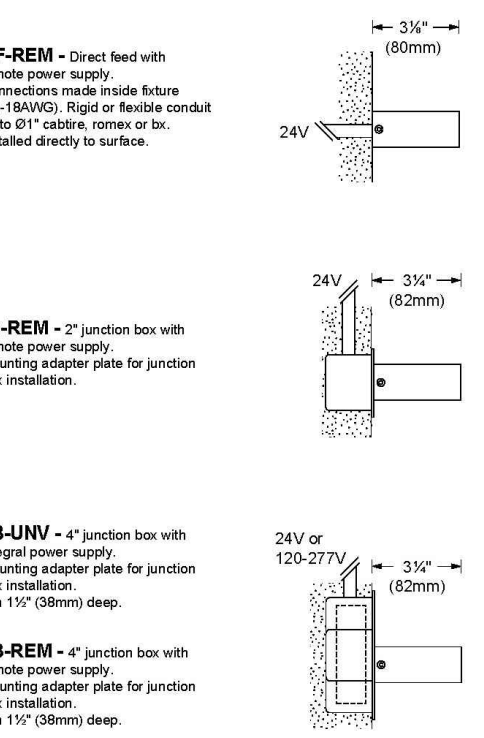

DF-REM - Direct feed with remote power supply. Connection made inside fixture (14-348VDC). Right or flexible conduit up to 8" (203mm) or the installed directly to surface.

J2-REM - Junction box with remote power supply. Mounting adapter plate for junction box installation.

JB-UNV - Junction box with integral power supply. Mounting adapter plate for junction box installation. Min 11" (280mm) deep.

JB-REM - Junction box with remote power supply. Mounting adapter plate for junction box installation. Min 11" (280mm) deep.

ORDERING INFORMATION (Ex: MR13FFL-PP-DK-20L50K-DV)

Model	Lens Type	Finish	Lamp Type	Voltage	Options	Accessories
MR13FFL	PP	MW	MW	120		

Model
MR13FFL 13" Dia.
MR17FFL 17" Dia.

Lens Type
PP Fluorescent Polycarbonate

Finish
MB Matte Black
MW Matte White
DB Dark Bronze

Lamp Type
MR13FFL 10 Watt 3000K LED
MR13FFL 10 Watt 4000K LED
MR13FFL 10 Watt 5000K LED
MR17FFL 20 Watt 3000K LED
MR17FFL 20 Watt 4000K LED
MR17FFL 20 Watt 5000K LED

Voltage
120 120 volts
277 277 volts
347 347 volts
DVA 120-277 volts

EXAMPLE: DSXO LED P6 40K T3M MVOLT SPA N1A2R2 P1RHN DDBXD

Series	LEDs	Color temperature	Distribution	Voltage	Mounting
DSXO LED	Forward optics	30K 3000K	T15 Type 1 (standard)	ESS Type 1 (start)	XXVMT 120V-277V
	P1 P5	40K 4000K	T25 Type 1 (start)	ESM Type 1 (medium)	XXVMT 277V-480V
	P2 P6	50K 5000K	T35 Type 1 (start)	ESW Type 1 (wide)	20P
	P3 P7		T50 Type 1 (start)	ESB Backlight (start)	20P
			T3M Type 1 (medium)	ECO Left (medium)	24P
	Retired optics		TM Type 1 (medium)	RCO Right corner (start)	27P
	P10 P10		T18M Forward (medium)	TRM Forward (medium)	24P
	P11 P11		T50 Type 1 (wide start)	TRM Forward (medium)	24P

Revision	Date	Description
1	01-12-24	SPRAB SUBMITTAL
2	03-14-24	SPRAB RE-SUBMITTAL
3	04-22-24	REV 1 TAC COMMENTS
4	06-17-24	REV 2 TAC COMMENTS

314 NE 3RD AVE
PHOTOMETRICS
DELRAY BEACH
FLORIDA

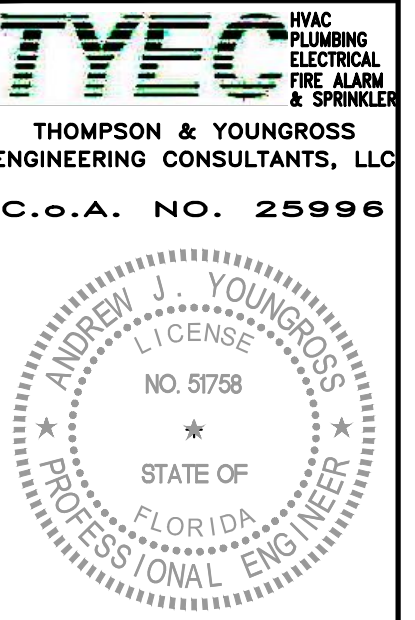

902 CLINT MOORE ROAD
SUITE 142
BOCA RATON, FLORIDA 33487
O: 561-274-0200
F: 561-274-0222
E: tec@tecfla.com
www.tecfla.com

THESE DRAWINGS ARE PREPARED PER ESTABLISHED INDUSTRY STANDARDS AND REPRESENT THE ENGINEERS DESIGN ONLY. THEY ARE NOT INTENDED TO PROVIDE EVERY DETAIL OR CONDITION FOR CONSTRUCTION. THE BUILDING OWNER AND OTHER CONTRACTORS ARE FULLY RESPONSIBLE FOR PROVIDING A COMPLETE AND OPERATIONAL BUILDING WHETHER INDICATED ON THE PLANS OR NOT.

Job Number 21157
Issued for:
50% Review
100% Review
Permit
12-10-21
Bid
Construction

Design By: AJY
Drawn By: AJY
Checked By: AJY
Scale: of
Sheet: of

PHOTOMETRIC SITE PLAN
ES-1.1