

# EXHIBIT A

## LEGEND

CB CATCH BASIN  
 DRNP DRAIN PIPE  
 EO ELECTRIC OUTLET  
 FND FOUND  
 LB LICENSED BUSINESS  
 LS LICENSED SURVEYOR  
 ORB OFFICIAL RECORD BOOK  
 PB PLAT BOOK  
 PCN PARCEL CONTROL NUMBER

PG PAGE  
 POB POINT OF BEGINNING  
 POC POINT OF COMMENCEMENT  
 PSM PROFESSIONAL SURVEYOR  
 & MAPPER  
 RNG RANGE  
 SEC SECTION  
 SQFT SQUARE FEET  
 TWP TOWNSHIP

—— BPWR(B) ——— BURIED POWER QUALITY LEVEL B  
 —— UNK(B) ——— UNKNOWN UTILITY QUALITY LEVEL B

### VICINITY MAP (NO TO SCALE)

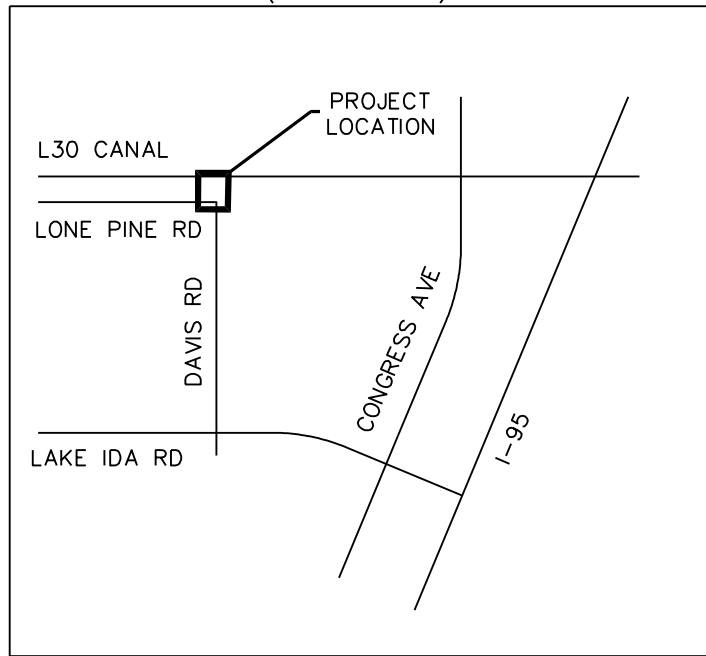

10/13/2022

DATE

Sheet 1 of 3

DESN BY: CM  
 DRWN BY: CM  
 RVWD BY: DR  
 FLD BK: \_\_\_\_\_  
 BK PG: \_\_\_\_\_  
 DATE: 8/30/21

CERTIFIED TO:  
 CHAD & MAY SHOEMAKER

LWDD RECORD RI-21-0060

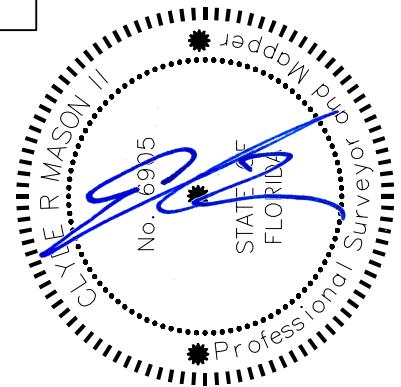

CLYDE R. MASON II PSM LS 6905

DAVIS ROAD ABANDONMENT

21-039

CHAD & MAY SHOEMAKER

DAVIS RD - NORTH TERMINUS DELRAY BEACH

PALM BEACH COUNTY, FLORIDA

LOCATED IN SEC 7, TWP 46S, RNG 43E



LB-8265

SUPPLYING SURVEY SOLUTIONS

5119 BEECHWOOD RD,

DELRAY BEACH, FL 33484

PH: 561-634-6701

www.ritzel-mason.com

# EXHIBIT A

## LAND DESCRIPTION:

THAT PART OF DAVIS ROAD RIGHT-OF-WAY AS RECORDED IN ORB 370 PAGE 591 AND ORB 370 PAGE 593 IN SECTION SEVEN (7), TOWNSHIP FORTY-SIX (46) SOUTH, RANGE FORTY-THREE (43) EAST, OF PALM BEACH COUNTY, FLORIDA, SPANNING FORTY (40) FEET EACH SIDE OF THE QUARTER (1/4) SECTION LINE; SAID RIGHT-OF-WAY BEING MORE PARTICULARLY DESCRIBED AS FOLLOWS:

COMMENCING AT THE NORTH QUARTER CORNER OF THE AFOREMENTIONED SECTION AS DESCRIBED IN THE PALM BEACH COUNTY SECTION CORNER HISTORY (MAY 2018) DOCUMENTS FILED WITH THE DEPARTMENT OF ENGINEERING AND PUBLIC WORKS; THENCE ALONG THE EAST LINE OF THE NORTHWEST QUARTER OF SAID SECTION SEVEN (7) S 01° 00' 40"E, A DISTANCE OF 112.53 FEET TO THE POINT OF BEGINNING; THENCE EASTERLY AND PARALLEL WITH THE NORTH LINE NE 1/4 OF SAID SECTION SEVEN (7) N 89° 03' 10"E, A DISTANCE OF 15.00 FEET TO A POINT; THENCE SOUTHERLY AND PARALLEL WITH THE EAST LINE OF THE NORTHWEST QUARTER OF SAID SECTION SEVEN (7) S 01° 00' 40"E, A DISTANCE OF 213.24 FEET; THENCE WESTERLY AND PARALLEL WITH THE NORTH LINE OF THE NORTHWEST QUARTER OF SAID SECTION SEVEN (7) S 89° 02' 49"W, A DISTANCE OF 55.00 FEET; THENCE NORTHERLY AND PARALLEL WITH THE EAST LINE OF THE NORTHWEST QUARTER OF SAID SECTION SEVEN (7) N 01° 00' 40"W, A DISTANCE OF 213.24 FEET; THENCE EASTERLY AND PARALLEL WITH THE NORTH LINE OF SAID SECTION SEVEN (7) N 89° 02' 49"E, A DISTANCE OF 40.00 FEET TO THE POINT OF BEGINNING.

SAID LANDS SITUATE IN THE CITY OF DELRAY BEACH, PALM BEACH COUNTY, FLORIDA AND CONTAINING 11,728.19 SQUARE FEET (0.2692 ACRES), MORE OR LESS.

## NOTES:

THIS IS NOT A BOUNDARY SURVEY.

ALL BEARINGS SHOWN HEREON ARE REFERENCED TO THE EAST LINE OF THE NORTHWEST QUARTER OF SECTION 7, TOWNSHIP 46 SOUTH, RANGE 43 EAST, HAVING A BEARING OF N 01° 00' 40" W, AS BEING COMPUTED FROM COORDINATES OBTAINED FROM THE PALM BEACH COUNTY, FLORIDA, ENGINEERING AND PUBLIC WORKS DEPARTMENT DOCUMENT ENTITLED SECTION CORNER HISTORY (MAY 2018).

ALL DISTANCES SHOWN HERE ON ARE IN U.S. SURVEY FEET.

ALL DIMENSIONS SHOWN HEREON ARE CALCULATED UNLESS OTHERWISE NOTED

NO ELEVATIONS ARE SHOWN HEREON.

UTILITY LINES SHOWN HAVE BEEN DESIGNATED BY RITZEL-MASON INC. UTILITIES WERE DESIGNATED BY ELECTRONIC METHODS. DESIGNATES CONFORM TO ASCE-38 STANDARDS FOR QUALITY LEVEL B.

REPRODUCTIONS, ADDITIONS, OR DELETIONS ARE NOT VALID WITHOUT ORIGINAL SIGNATURE & RAISED SEAL OF THE FLORIDA PROFESSIONAL SURVEYOR AND MAPPER.

I HEREBY CERTIFY THAT THIS SKETCH AND LEGAL DESCRIPTION WAS PREPARED UNDER MY DIRECTION AND THAT SAID SKETCH AND LEGAL DESCRIPTION IS IN COMPLIANCE WITH THE STANDARDS AND PRACTICE SET FORTH BY THE FLORIDA BOARD OF PROFESSIONAL SURVEYORS AND MAPPERS IN CHAPTER 5J-17.052, FLORIDA ADMINISTRATIVE CODE PURSUANT TO SECTION 472.027 FLORIDA STATUTES.

THIS SKETCH AND LEGAL DESCRIPTION WAS PERFORMED WITHOUT THE BENEFIT OF A TITLE OPINION OR ABSTRACT BY THIS SURVEYOR OR ANY FORM. THE CLIENT IS HEREBY ADVISED THAT SUCH MATTERS OF RECORD MAY BE RECORDED IN THE PUBLIC RECORDS IN WHICH THE SUBJECT PARCEL IS SITUATE.

DATE OF FIELD WORK: APRIL 29TH, 2021

Sheet 2 of 3

DESN BY: CM  
DRWN BY: CM  
RVWD BY: DR  
FLD BK:       
BK PG:       
DATE: 8/30/21

CERTIFIED TO:  
CHAD & MAY SHOEMAKER

LWDD RECORD RI-21-0060

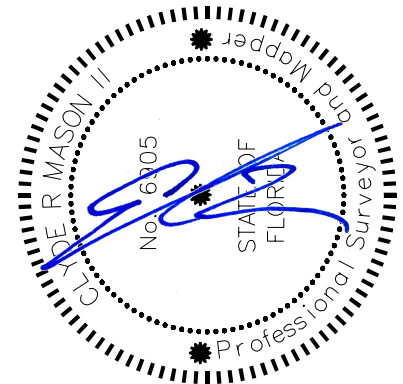

DATE  
CLYDE R. MASON II PSM LS 6905

DAVIS ROAD ABANDONMENT

21-039

CHAD & MAY SHOEMAKER

DAVIS RD - NORTH TERMINUS DELRAY BEACH

PALM BEACH COUNTY, FLORIDA

LOCATED IN SEC 7, TWP 46S, RNG 43E



**LB-8265**  
SUPPLYING SURVEY SOLUTIONS  
5119 BEECHWOOD RD,  
DELRAY BEACH, FL 33484  
PH: 561-634-6701  
www.ritzel-mason.com

# EXHIBIT A

SEC 6, TWP 46S , RNG 43E

SEC 7, TWP 46S , RNG 43E

N 89°02'49" E  
N = 782555.435  
E = 951188.508  
(NOT FOUND)

**L-30**  
**L.W.D.D. RIGHT-OF-WAY**  
**WIDTH VARIES**

FND BRASS DISK  
PALM BEACH COUNTY

S. R/W LINE

LWDD L-30 CANAL  
ORB 6495, PG. 761

N 89°02'49" E  
40.00'

3523 LONE PINE RD  
PCN  
12-43-46-07-00-000-3030

W LINE OF E. 40' OF NW 1/4  
OF SECTION 7

N 01°00'40" W  
213.24'

ORB 370, PG 593

EAST LINE OF THE NW QUARTER  
SECTION 7

S 01°00'40" E  
213.24'

ORB 370, PG 591

WEST LINE RAINBERRY LAKE  
PHASE IV-B P.B. 39, PG. 108

**RAINBERRY LAKE**  
**PHASE IV-B**  
**P.B. 39, PG. 108**

10/13/2022

S. LINE OF N. 325.77'  
OF NW 1/4, SECTION 7  
S 89°02'49" W  
55.00'

**LONE PINE ACRE ESTATES**  
**UNRECORDED PLAT**  
**30' EASEMENT**

**LONE PINE ROAD**  
**LONE PINE ACRE ESTATES**  
**UNRECORDED PLAT**  
**30' EASEMENT**

FND NAIL & DISK  
"DO NOT DISTURB"

**DAVIS ROAD**  
**80' RIGHT-OF-WAY**  
**ORB 370, PG 593**  
**ORB 370, PG 591**

FND NAIL  
IN BOX CUT

DRNP

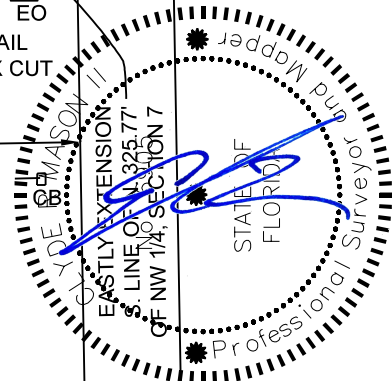

CLYDE R. MASON II PSM LS 6905 DATE

Sheet 3 of 3

DESN BY: CM  
DRWN BY: CM  
RVWD BY: DR  
FLD BK:       
BK PG:       
DATE: 8/30/21

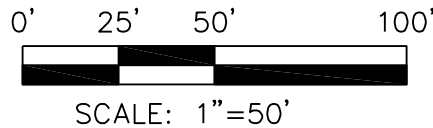

DAVIS ROAD ABANDONMENT

21-039

CHAD & MAY SHOEMAKER

DAVIS RD - NORTH TERMINUS DELRAY BEACH

PALM BEACH COUNTY, FLORIDA

LOCATED IN SEC 7, TWP 46S, RNG 43E



LB-8265

SUPPLYING SURVEY SOLUTIONS

5119 BEECHWOOD RD,

DELRAY BEACH, FL 33484

PH: 561-634-6701

www.ritzel-mason.com