



REP SERVICES, INC.

Experts at Play & Outdoor Spaces

Site Amenities ■ Playground Equipment ■ Safety Surfacing ■ Shade
Phone: 407.831.9658 Fax: 866.232.8532 E-mail: sales@repsservices.com

CGC1508223

Page 1 of 2

Please mail POs, contracts and checks to:

Rep Services, Inc.

165 W. Jessup Ave.

Longwood, FL 32750-4146

Proposed To: City of Delray Beach
Public Works
100 NW 1st Avenue
Delray Beach, FL 33444

Attn: Amanda Skeberis

Ship To: TBD at a later date

Attn:

Bill To: City of Delray Beach
Public Works
100 NW 1st Avenue
Delray Beach, FL 33444

Attn: Amanda Skeberis

Project No: 19556 **Project Name:** Beach Recycling

Proposal No: 19556.02 **Proposal Name:** Beach Recycling

Proposal Date: 12/5/2022 **Proposal Expires:** 12/30/2022

For Questions Contact: Christina Discher ☎ 407-853-3561 ✉ christina@repsservices.com

Consultant: Paul Bravo ☎ 561-448-0369 ✉ paul@repsservices.com

Project Contact: Amanda Skeberis

Project Location: 1 S Ocean Blvd
Delray Beach, FL 33444

Project County: Palm Beach

Opt/Rev: B/0 12/5/22 - CD

Vendor: Anova

Proj Drawings: ANO

586022

Class	Part No	Qty	Description	Unit Price	Ext Price
Receptacles	L1378BRT	20 EA	Rendezvous 32 Gallon Recycler, Bold Recycler Top	1,245.00	24,900.00
Product Subtotal:					\$24,900.00
Discount per the Clay County Contract #18/19-2				2.00%	(\$498.00)
Discounted Product Total:					\$24,402.00
Freight: Prepaid Ship Method: Best Way FOB: Destination Weight: 2,040 lbs Freight Charge					\$4,036.50
Anova Total:					\$28,438.50

General Terms of Sale and Proposal Summary

Net 30

Product: \$24,402.00

Freight: \$4,036.50

Proposal Total: \$28,438.50

Notes

The Clay County Contract #18/19-2 provides a 2% discount on Anova product. The maximum price for installation is 50% of the product price. (Installation does not include site prep, slabs, footings or engineering).

Basis of Proposal: W/O Installation

Our proposal is based upon your email dated 11/4/22.

Please note the vendor information itemized below.

Estimated product delivery schedule- Freight includes lift gate.

The lead time for your project is 10-12 weeks after RSI receipt of your signed order, finish selections, Credit Agreement and Deposit.

Anova Site Furnishings:

Color Selection: to be made at time of color submittal approval

Support Option: to be made at time of support submittal approval

NOTES: Please be aware of the following

- Some products require assembly.
- Shipments are via Semi Trailer

Time Limitations Holding Prices Firm:

Orders are shipped within our manufacturer's standard lead times. Requests for delayed shipping may result in additional costs due to increases in freight, material costs or other factors. To secure the prices on this proposal, the offer must be accepted prior to the expiration date noted.

If, during the performance of this contract, the price of a product increases 3% or more as documented by factory quotes, invoices or receipts to contractor (Rep Services, Inc.) from the date of the contract signing the price of shall be equitably adjusted by an amount reasonably necessary to cover such price increases. Where the delivery of a product is delayed, through no fault of contractor (RSI) as a result of the shortage or unavailability of a product, contractor (RSI) shall not be liable for any additional costs or damages associated with such delay(s).

The undersigned warrants that he/she is an authorized representative of the company noted and has the requisite authority to bind said company and/or principal. If any particular billing is not paid when due, all outstanding balances, regardless of prior terms, will become immediately due and owing upon demand. Interest on past due amounts will be assessed at 1 ½ % per month or the maximum interest rate permitted by applicable law, whichever is less. Should it become necessary for either party to this contract to institute legal action for enforcement of any provisions of this contract, the prevailing party shall be entitled to reimbursement for all court costs and reasonable attorney's fees incident to such legal action. The parties hereto agree that proper venue for any legal action in any way related to this contract shall be in Seminole County, FL.

Accepted By:

City of Delray Beach

Company Name	Authorized By	Printed Name	Date
As Its: _____ (Title)			



211 North Lindbergh Blvd.
St. Louis, MO 63141
800.231.1327 tel. | 314.754.0835 fax
specify@anovafurnishings.com
anovafurnishings.com

L1378BRT — Rendezvous 32 Gallon Recycler with Bold Recycler Top

32-gallon steel slat recycler with bold recycler top, plastic liner and rubber feet

Material

The 32-gallon recycler is 32.65" tall and is composed of 12-gauge slotted steel with a .75" gap vertical slotted pattern. The bold decal recycler top is made of 18-gauge spun steel with a 5.05" diameter center top opening and choice of "GLASS ONLY", "CANS ONLY", "PAPER ONLY", "PLASTIC ONLY" or "TRASH ONLY" decal with recycle logo or with no decal. Specify black or white lettering. Decals will be factory-applied and must be specified at the time of order. The top includes a 14" security strap and lifts off for easy trash removal.

The receptacle is designed to be portable for flexibility in placement or surface mounted using predrilled .38" diameter holes inside the base to prevent movement; optional corkscrew anchor also available. The rubber feet are adjustable to assist in leveling the receptacle. The reusable plastic liner is made of high-density polyethylene.

Finish

Steel slats are protected by the patented Fusion Advantage™ finish. The plastisol coating has an average thickness of .125" and is encapsulated with a richly tinted, high performance powder coating that won't rust, fade, peel, chip, crack, mold or mildew. The finish has been tested to the requirements of ASTM E1354 and determined to be in compliance with California Uniform Fire Code 1103.2.1.4.2.

Fade-resistant, powder coated steel top features a state-of-the-art primer proven to prevent rusting. Treated components exceed the industry standard by 34% in testing by independent sources.

Color

See website or sales representative for color choices.

Assembly

The receptacle ships fully assembled and ready for use. Using an optional corkscrew anchor may require some assembly.

Maintenance

The product is virtually maintenance-free and requires only periodic cleaning with a sponge and a solution of mild detergent and water to remove surface dirt. Do not clean with solvent or petroleum base products.

Warranty

20-year limited structural warranty with 7-year finish warranty from the date of purchase. See full details on multi-year warranties for components at www.anovafurnishings.com/warranty.aspx.



Replacement Parts

Black Plastic Liner F1017

Accessories

Corkscrew Anchor A1020

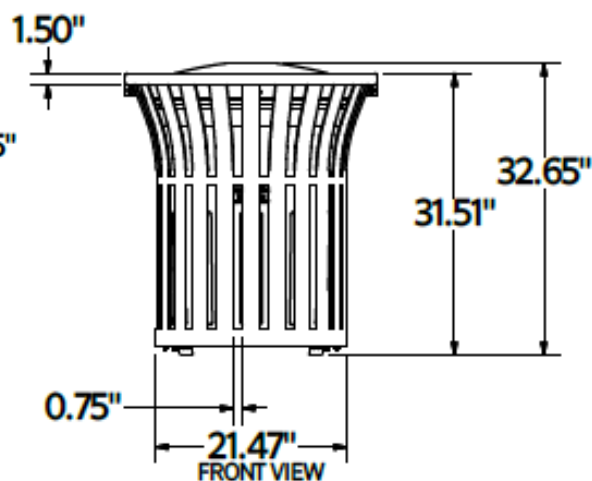
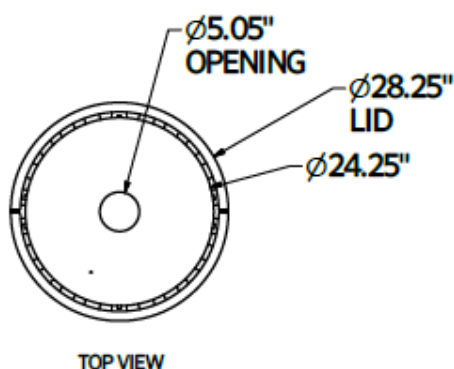
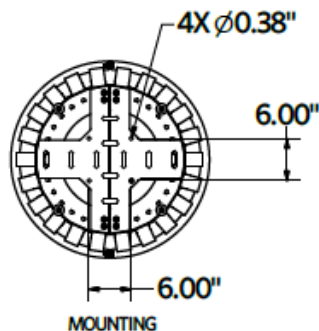

SHIPPING INFORMATION

Unit Weight	Unit Shipping Wt. UPS	Unit Shipping Wt. Truck (1+ Units)	Unit Ship Size w/Pallet	Max Units Per Pallet	Pallet Size/Wt. 48" x 32"	Total No. Pkgs.	Shipping Class
89 lbs.	N/A	102 lbs./unit	33 cu. ft.	3	50 lbs.	1	100