



MEMORANDUM AWARD RECOMMENDATION

TO: VICTOR MAJTENYI, DEPUTY DIRECTOR OF PUBLIC UTILITIES
FROM: THERESA WEBB, CHIEF PURCHASING OFFICER *TW*
SUBJECT: ITB 2017-026, MATERIALS FOR WATER MAIN IMPROVEMENT PROJECTS:
EL DORADO LANE AND SUNSHINE DRIVE
DATE: 02/14/2017

Per your request, the Purchasing Department issued ITB No. 2017-026 for Materials for Water Main Improvement Projects: El Dorado Lane and Sunshine Drive. After completing the due diligence review to confirm the bidders meet the minimum qualifications and submitted the required forms and documentation, a bid tabulation was completed. The lowest responsible, responsive bidder is Ferguson Enterprises, Inc. Attached is a copy of the tabulation and the bid from the company for your review. Please provide your feedback on this recommendation to award to Ferguson Enterprises, Inc. by 02/21/2017.

This item is scheduled for the March 28, 2017 Commission meeting, if your approval is received by the date requested. Otherwise, award will be delayed for a minimum of two weeks.

Funding Account Number:
(Account number and title)

☒ Recommendation approved. Proceed with Commission approval.

☐ Recommendation not approved.

Comments:

John Morgan
Department Head

2/21/2017
Date

Acquisition Approval

S:\EngCADD\Projects\2015-051\EL DORADO LANE LOCATION MAP.dwg Date of publication: Dec 11, 2014-11:16am Plotted by: bowra

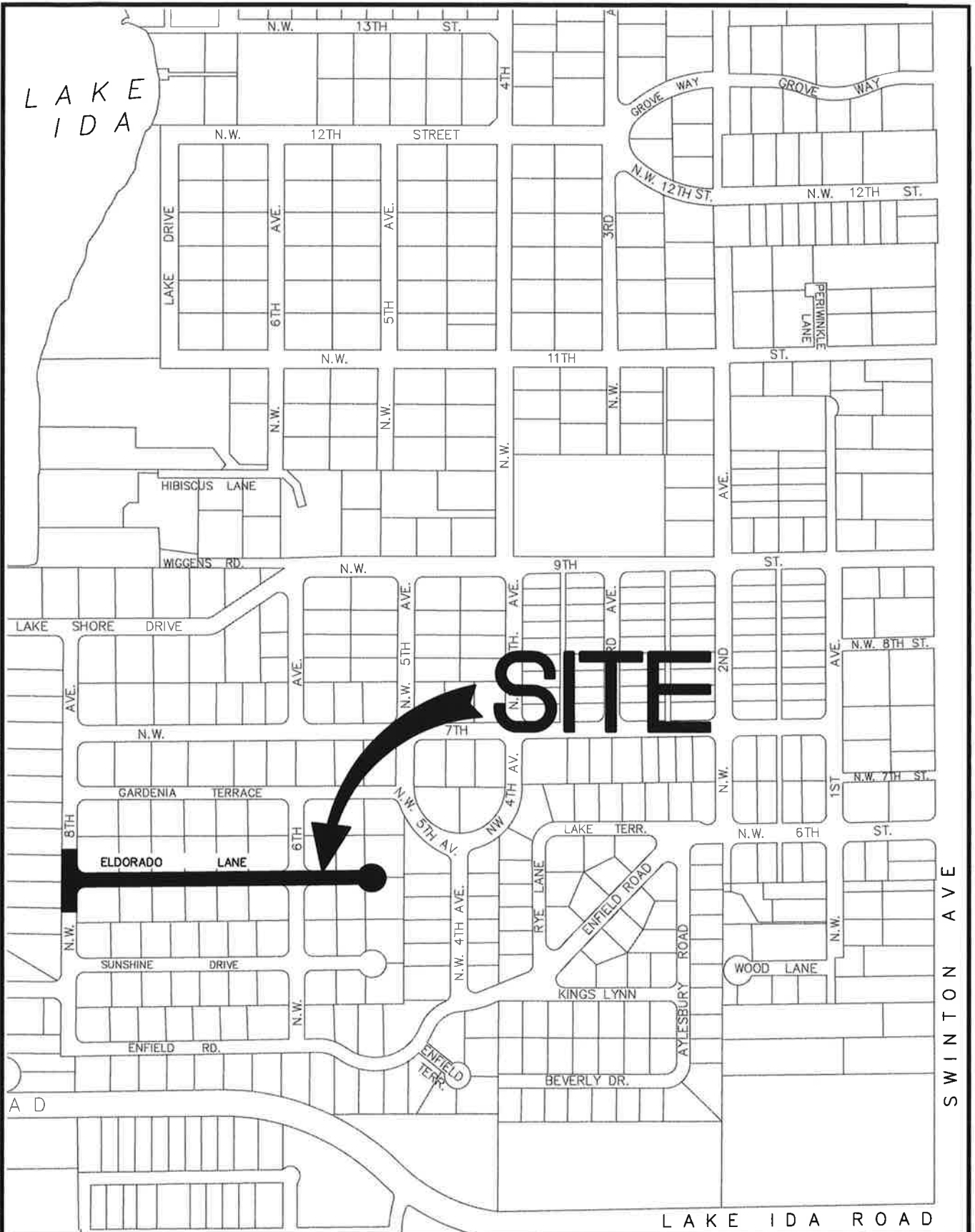

CITY of DELRAY BEACH
ENVIRONMENTAL SERVICES DEPARTMENT
434 SOUTH SWINTON AVENUE, DELRAY BEACH, FLORIDA 33444

**EL DORADO LANE WM UPGRADE
LOCATION MAP**
2015-051

DATE: 12/11/2014
EL DORADO LANE LOCATION MAP
1 OF 1

Tabulation Sheet - ITB 2017-026

Materials for Water Main Improvement Projects:
El Dorado Lane and Sunshine Drive

Item No.	Description	Estimated Qty.	Unit of Measure	Ferguson Enterprises, Inc.		Fortiline, Inc. DBA Fortiline Waterworks		HD Supply Waterworks, Ltd.	
				Unit Price	Extended Cost	Unit Price	Extended Cost	Unit Price	Extended Cost
1	8 inch C900 DR18 PVC GJ blue pipe	1700	Linear Feet	\$5.80	\$9,860.00	\$6.42	\$10,914.00	\$6.52	\$11,084.00
2	6 inch C900 DR18 PVC GJ blue pipe	340	Linear Feet	\$3.40	\$1,156.00	\$3.72	\$1,264.80	\$4.52	\$1,536.80
3	8 inch tapping tee / stainless steel / flange	2	Each	\$542.10	\$1,084.20	\$857.75	\$1,715.50	\$533.47	\$1,066.94
4	8 inch tapping valve	2	Each	\$821.30	\$1,642.60	\$773.80	\$1,547.60	\$825.33	\$1,650.66
5	8 inch gate valve MJ	3	Each	\$635.20	\$1,905.60	\$594.57	\$1,783.71	\$634.13	\$1,902.39
6	8 inch plug DI MJ	2	Each	\$33.60	\$67.20	\$32.00	\$64.00	\$41.56	\$83.12
7	8 x 2 inch DI MJ plug	2	Each	\$43.80	\$87.60	\$41.67	\$83.34	\$54.12	\$108.24
8	6 inch gate valve MJ	9	Each	\$398.80	\$3,589.20	\$373.31	\$3,359.79	\$398.13	\$3,583.17
9	6 inch tapping valve	2	Each	\$557.20	\$1,114.40	\$521.32	\$1,042.64	\$556.00	\$1,112.00
10	6 x 2 inch plug DI MJ	2	Each	\$32.60	\$65.20	\$31.00	\$62.00	\$40.27	\$80.54
11	6 inch plug DI MJ	1	Each	\$22.40	\$22.40	\$21.33	\$21.33	\$27.71	\$27.71
12	6 inch MJ swivel HYD tee	1	Each	\$70.70	\$70.70	\$67.33	\$67.33	\$87.45	\$87.45
13	6 inch MJ WYE	2	Each	\$84.00	\$168.00	\$80.00	\$160.00	\$103.90	\$207.80
14	6 inch tapping tee / stainless steel / flange	2	Each	\$412.00	\$824.00	\$638.81	\$1,277.62	\$405.46	\$810.92
15	8 inch MJ WYE	4	Each	\$122.50	\$490.00	\$116.67	\$466.68	\$151.52	\$606.08
16	8 x 6 inch MJ swivel HYD tee	5	Each	\$88.60	\$443.00	\$84.33	\$421.65	\$109.54	\$547.70
17	8 inch MJ sleeve long pattern	1	Each	\$62.70	\$62.70	\$59.67	\$59.67	\$77.50	\$77.50
18	8 x 6 MJ reducer	1	Each	\$35.70	\$35.70	\$34.00	\$34.00	\$44.16	\$44.16
19	Fire HYD 3.5 Feet bury line	6	Each	\$1,333.00	\$7,998.00	\$1,326.59	\$7,959.54	\$1,382.01	\$8,292.06
20	Valve box complete water / heavy duty / traffic bearing	16	Each	\$72.00	\$1,152.00	\$35.48	\$567.68	\$26.78	\$428.48
21	8 inch bell restraints / C900 PVC	31	Each	\$47.00	\$1,457.00	\$43.86	\$1,359.66	\$56.16	\$1,740.96
22	6 inch bell restraints / C900 PVC	7	Each	\$29.00	\$203.00	\$27.03	\$189.21	\$34.62	\$242.34
23	2 inch brass plug	7	Each	\$7.00	\$49.00	\$6.42	\$44.94	\$6.63	\$46.41
24	1 inch brass plug	7	Each	\$2.50	\$17.50	\$2.15	\$15.05	\$2.22	\$15.54
25	8 inch restraint glands C900 PVC	30	Each	\$28.60	\$858.00	\$25.70	\$771.00	\$30.09	\$902.70
26	8 inch MJ accessory kit less gland	35	Each	\$12.00	\$420.00	\$8.19	\$286.65	\$11.26	\$394.10
27	6 inch restraint glands C900 PVC	28	Each	\$17.70	\$495.60	\$17.38	\$486.64	\$20.34	\$569.52
28	6 inch MJ accessory kits less gland	37	Each	\$11.00	\$407.00	\$7.53	\$278.61	\$9.52	\$352.24
29	2 inch CTS SDR9 HDPE pipe blue 200#	200	Linear Feet	\$1.15	\$230.00	\$1.19	\$238.00	\$1.19	\$238.00
30	8 x 1 saddle / stainless steel / double strap / epoxy coated	13	Each	\$52.20	\$678.60	\$56.88	\$739.44	\$53.58	\$696.54
31	6 x 1 saddle / stainless steel / double strap / epoxy coated	8	Each	\$44.90	\$359.20	\$50.95	\$407.60	\$46.08	\$368.64
32	1 inch ball corp valve CC x PJ (CTS)	37	Each	\$42.00	\$1,554.00	\$46.15	\$1,707.55	\$46.67	\$1,726.79
33	1 inch curb stop (CTS) x meter swivel nut	37	Each	\$67.30	\$2,490.10	\$73.94	\$2,735.78	\$74.77	\$2,766.49
34	2 inch ball corp valve CC x PJ (CTS)	1	Each	\$155.70	\$155.70	\$171.09	\$171.09	\$172.97	\$172.97
35	1 inch ball corp valve CC x FIP	4	Each	\$35.40	\$141.60	\$38.88	\$155.52	\$39.30	\$157.20
36	2 inch pack joint coupling MIP x PEP	8	Each	\$46.80	\$374.40	\$78.88	\$631.04	\$51.98	\$415.84
37	2 inch pack joint (CTS) tee	1	Each	\$169.90	\$169.90	\$186.65	\$186.65	\$188.71	\$188.71
38	6 x 2 inch DI MJ plug bottom tap	1	Each	\$82.00	\$82.00	\$31.00	\$31.00	\$27.71	\$27.71
39	2 inch ball corp valve MIP x MIP	2	Each	\$147.30	\$294.60	\$161.87	\$323.74	\$163.67	\$327.34
40	2 inch curb stop MIP x FIP	2	Each	\$147.40	\$294.80	\$161.87	\$323.74	\$163.67	\$327.34
41	2 inch SCH 80 PVC coupling FIP x SLIP	14	Each	\$7.00	\$98.00	\$9.17	\$128.38	\$7.45	\$104.30
42	2 inch SCH 80 PVC adapter MIP x SLIP	14	Each	\$5.50	\$77.00	\$6.99	\$97.86	\$5.68	\$79.52
43	2 inch SCH 80 PVC 90 degree bend SLIP x SLIP	14	Each	\$2.00	\$28.00	\$2.53	\$35.42	\$2.06	\$28.84
44	Hydro guard HG-1	2	Each	\$2,495.00	\$4,990.00	\$2,194.50	\$4,389.00	\$1,866.67	\$3,733.34
45	8 inch poly PIG	1	Each	\$20.00	\$20.00	\$23.49	\$23.49	\$22.24	\$22.24

46	10 inch poly PIG	2	Each	\$32.00	\$64.00	\$33.73	\$67.46	\$32.12	\$64.24
47	1 inch CTS SDR9 HDPE pipe blue 200#	1400	Linear Feet	\$0.31	\$434.00	\$0.33	\$462.00	\$0.33	\$462.00
48	2 inch SCH 80 PVC bell x plain end	740	Linear Feet	\$1.40	\$1,036.00	\$1.37	\$1,013.80	\$1.92	\$1,420.80
49	Detectable blue tape "water underground"	2000	Linear Feet	\$0.03	\$60.00	\$16.88	\$33,760.00	\$0.01	\$20.00
50	Blue coated 10 gauge stranded tracer wire	2000	Linear Feet	\$0.19	\$380.00	\$0.25	\$500.00	\$0.18	\$360.00
51	Brass valve ID marker 8 inch gate valve	3	Each	\$13.00	\$39.00	\$11.76	\$35.28	\$11.11	\$33.33
52	Brass valve ID marker 8 inch tapping valve	2	Each	\$13.00	\$26.00	\$11.76	\$23.52	\$11.11	\$22.22
53	Brass valve ID marker 6 inch gate valve	9	Each	\$13.00	\$117.00	\$11.76	\$105.84	\$11.11	\$99.99
54	Brass valve ID marker 6 inch tapping valve	2	Each	\$13.00	\$26.00	\$11.76	\$23.52	\$11.11	\$22.22
55	1 inch stainless steel inserts	80	Each	\$1.25	\$100.00	\$1.26	\$100.80	\$1.10	\$88.00
56	2 inch stainless steel inserts	10	Each	\$1.75	\$17.50	\$1.73	\$17.30	\$1.52	\$15.20
57	8 x 1 Saddle double strap stainless steel epoxy coated	20	Each	\$52.20	\$1,044.00	\$50.95	\$1,019.00	\$53.57	\$1,071.40
58	8 x 2 inch DI MJ plug bottom tap	1	Each	\$100.00	\$100.00	\$41.67	\$41.67	\$41.56	\$41.56
59	8 x 2 saddle stainless steel double strap epoxy coated	1	Each	\$60.70	\$60.70	\$58.86	\$58.86	\$62.12	\$62.12
60	2 inch corporation CC x pack joint	1	Each	\$155.70	\$155.70	\$171.09	\$171.09	\$172.97	\$172.97
		Grand Total Cost (items 1 through 60)			\$51,443.40		\$86,030.08		\$52,939.39

S:\EngCADD\Projects\2015-052\SUNSHINE DRIVE LOCATION MAP.dwg Date of publication: Dec 09, 2014-4:57pm Plotted by: BOWRA

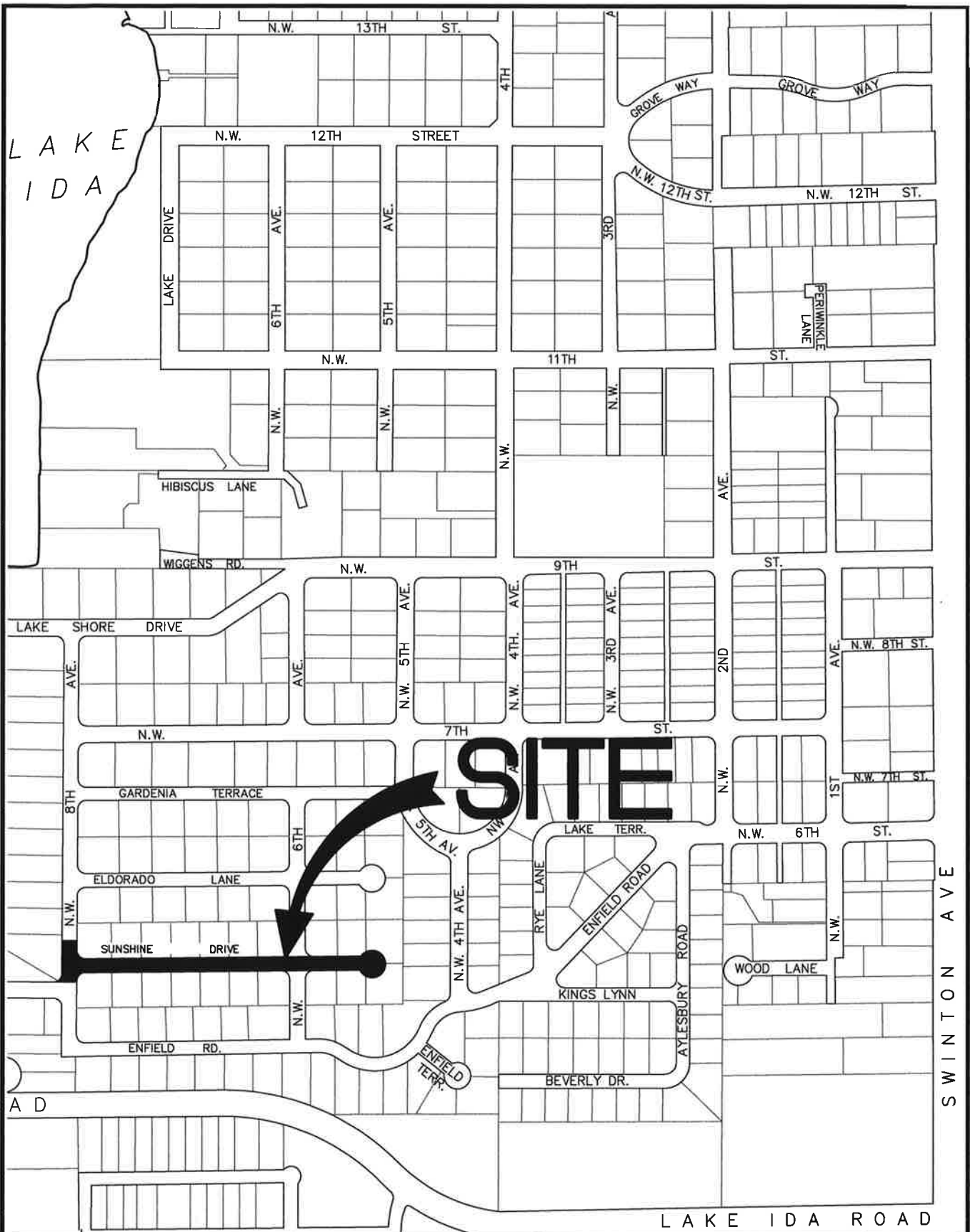

CITY of DELRAY BEACH
ENVIRONMENTAL SERVICES DEPARTMENT
434 SOUTH SWINTON AVENUE, DELRAY BEACH, FLORIDA 33444

**SUNSHINE DRIVE WM UPGRADE
LOCATION MAP**
2015-052

DATE: 12/09/2014
SUNSHINE DRIVE WM UPGRADE
1 OF 1