

RESOLUTION NO. 59-18

A RESOLUTION OF THE CITY COMMISSION OF THE CITY OF DELRAY BEACH, FLORIDA, CREATING PARKING METER ZONES AND TIME-LIMITED PARKING ZONES WITHIN THE CITY; PROVIDING MAXIMUM TIME LIMITS WITHIN EACH AREA; AND DIRECTING AND AUTHORIZING THE CITY MANAGER TO TAKE ALL NECESSARY ACTIONS TO EFFECTUATE SAME; PROVIDING AN EFFECTIVE DATE AND FOR OTHER PURPOSES.

WHEREAS, the City of Delray Beach has determined that parking meters are needed to control parking in certain areas within the City; and

WHEREAS, the City of Delray Beach has determined that Limited Time Parking Zones are needed to control parking in certain areas within the City; and

WHEREAS, the City deems it necessary and in the public interest to limit the amount of time a vehicle can park within certain areas of the City.

NOW, THEREFORE, BE IT RESOLVED BY THE CITY COMMISSION OF THE CITY OF DELRAY BEACH, FLORIDA that:

Section 1. The foregoing recitals are hereby affirmed and ratified.

Section 2. The City designates the following Parking Meter Zones and limits the maximum amount of time a vehicle may park continuously within one parking space.

(1) ***On Street Parking Meter Zones east of Intracoastal Waterway.***

- a.) East Atlantic Avenue from the Intracoastal Waterway to SR A1A. Parking meters shall be in effect from 9:00 a.m. to 9:00 p.m. to allow parking for a period not to exceed two hours.
- b.) SR A1A from Casuarina Road to Beach Drive. Parking meters shall be in effect from 9:00 a.m. to 9:00 p.m. to allow parking for a period not to exceed four hours.
- c.) Gleason Street from East Atlantic Avenue to Miramar Drive. Parking meters shall be in effect from 9:00 a.m. to 9:00 p.m. to allow parking for a period not to exceed two hours.
- d.) Venetian Drive from East Atlantic Avenue to Miramar Drive. Parking meters shall be in effect from 9:00 a.m. to 9:00 p.m. to allow parking for a period not to exceed two hours.

(2) ***On Street Parking Meter Zones west of Intracoastal Waterway.*** Parking meters shall be in effect from 9:00 a.m. to 9:00 p.m, Sunday through Thursday; from 9:00 a.m. on Friday to 2:00 a.m. on Saturday; and from 9:00 a.m. on Saturday to 2:00 a.m. on Sunday. At all other times, parking in the metered spaces shall be free of charge for a period not to exceed two hours.

- a.) East Atlantic Avenue, from Swinton Avenue to Intracoastal Waterway.
- b.) East side of N.E. 1st Avenue from Atlantic Avenue to N.E. 1st Street.
- c.) N.E. 4th Avenue from East Atlantic Avenue to N.E. 1st Street.
- d.) N.E. 2nd Avenue from Atlantic Avenue to N.E. 1st Street.
- e.) S.E. 1st Avenue from Atlantic Avenue to S.E. 1st Street.
- f.) S.E. 2nd Avenue from Atlantic Avenue to S.E. 1st Street.
- g.) S.E. 3rd Avenue from Atlantic Avenue to S.E. 1st Street.
- h.) S.E. 4th Avenue from Atlantic Avenue to S.E. 1st Street.
- i.) S.E. 5th Avenue from Atlantic Avenue to S.E. 1st Street.

(3) ***Surface Parking Lots Meter Zones .*** Parking meters shall be in effect at all times the parking lot is open:

- a.) The surface parking lot in Atlantic Dunes Park.
- b.) The surface parking lot in Anchor Park.
- c.) The surface parking lot in Sandoway Park.
- d.) Orange Grove parking lot located on SR A1A, north of Atlantic.
- e.) City parking lot located on Ingraham Avenue.

(4) ***Structured Parking Garage Meter Zones.*** Parking meters shall be in effect Monday through Saturday, from 4 p.m. to 12:00 a.m.

- a.) Old School Square Garage, located at 95 N.E. 1st Avenue.

- b.) Robert Federspiel Garage, located at 22 S.E. 1st Avenue.

Section 3. The City designates the following Time-Limited Parking Zones and limits the maximum amount of time a vehicle may park continuously within one parking space:

(1) ***Time-Limited Parking Zones: Two Hours***

- a) All parking spaces in the easterly portion of the Railroad Parking lot, as shown on Exhibit A.
- b) All parking spaces in the Village Parking Lot, as shown on Exhibit A.

(2) ***Time-Limited Parking Zones: Four Hours***

- a) All parking spaces in the City parking lot in Veteran's Park, as shown on Exhibit B.
- b) All parking spaces in the City parking lot on Banker's Row, as shown on Exhibit B.

(3) ***Time-Limited Parking Zones: Six hours***

- a) All non-metered parking spaces located on certain streets as shown in Exhibit C.

(4) ***Time- Limited Parking Zones: Nine Hours***

- a) All parking spaces in the westerly Railroad parking lot, as shown on Exhibit D.
- b) All parking spaces in the Gladiola parking lot, as shown on Exhibit D.

(5) ***Time- Limited Parking Zones: Fourteen Hours***

- a) All parking spaces in the Old School Square Garage, located at 95 N.E. 1st Avenue, except that overnight parking shall be prohibited.
- b) All parking spaces in the Robert Federspiel Garage, located at 22 SE 1st Avenue, except that overnight parking shall be prohibited.

Section 4. The City Manager is hereby directed and authorized to take all actions necessary and prudent in order to effectuate the purpose of this Resolution.

Section 5. This Resolution shall become effective immediately upon adoption.

PASSED AND ADOPTED by the City Commission of the City of Delray Beach this ____ day of _____ 2018.

ATTEST:

Shelly Petrolia, Mayor

City Clerk

Approved as to form and legal sufficiency.

R. Max Lohman, City Attorney



CITY OF DELRAY BEACH
UTILITIES DEPARTMENT
4364 SOUTH SWINTON AVENUE DELRAY BEACH, FL 33444

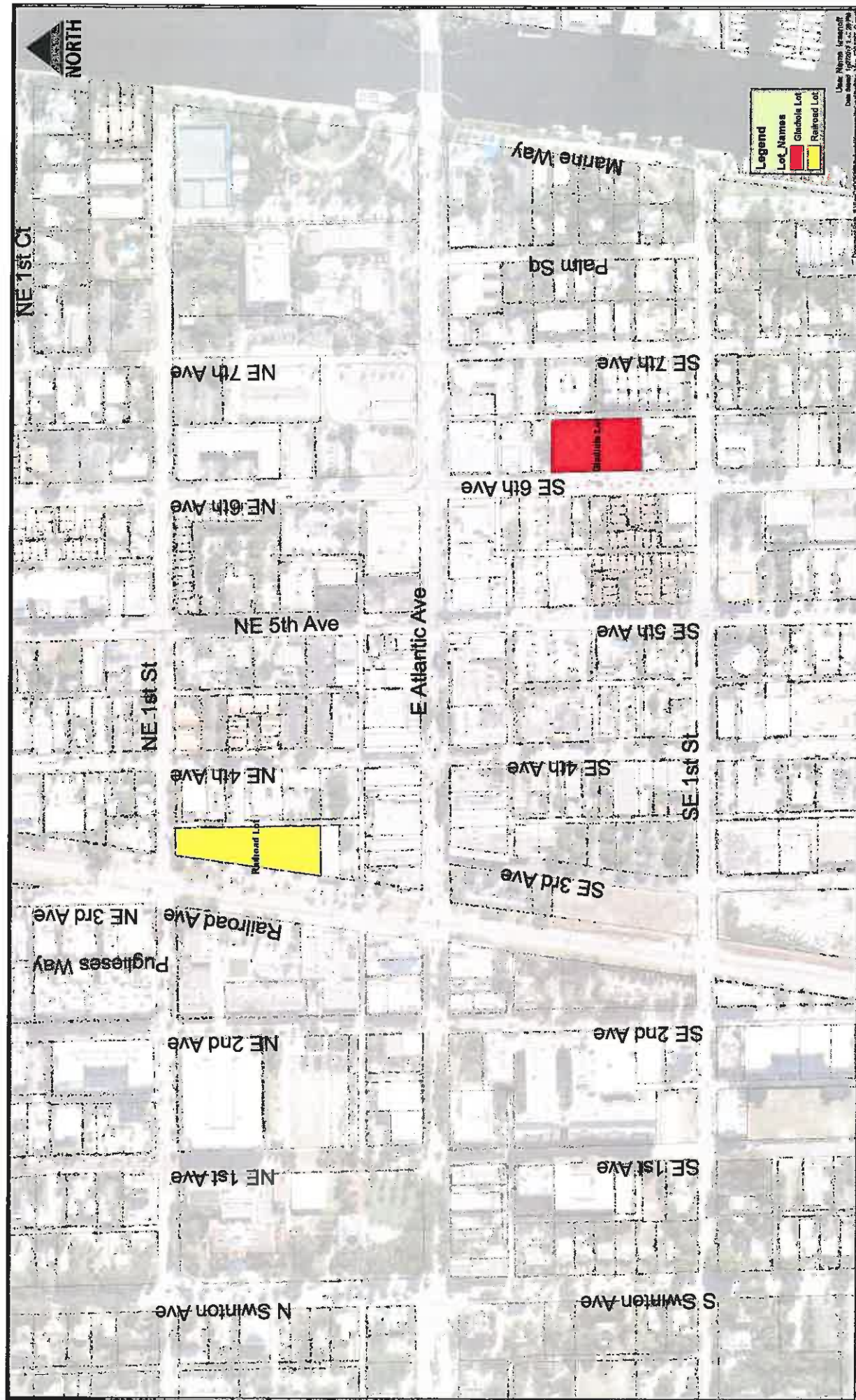

EXHIBIT D
TIME-LIMITED PARKING: 9 HOURS