

Drawing No.
LP-1
OF 8

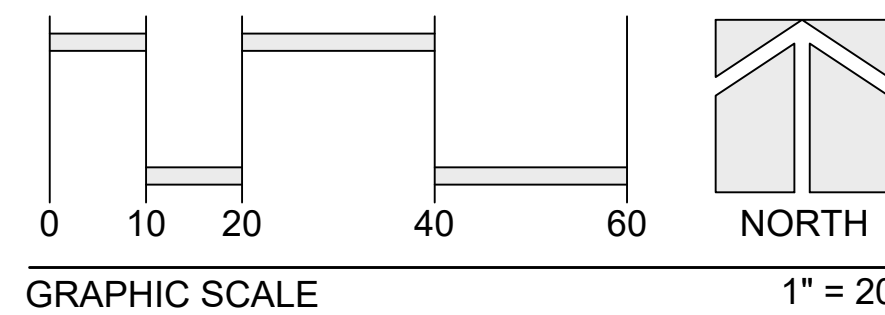

MATCHLINE SEE SHEET LP-3

MATCHLINE SEE SHEET LP-7

0 10 20 40 60

GRAPHIC SCALE

NORTH

1" = 20'

VETERANS' PARK

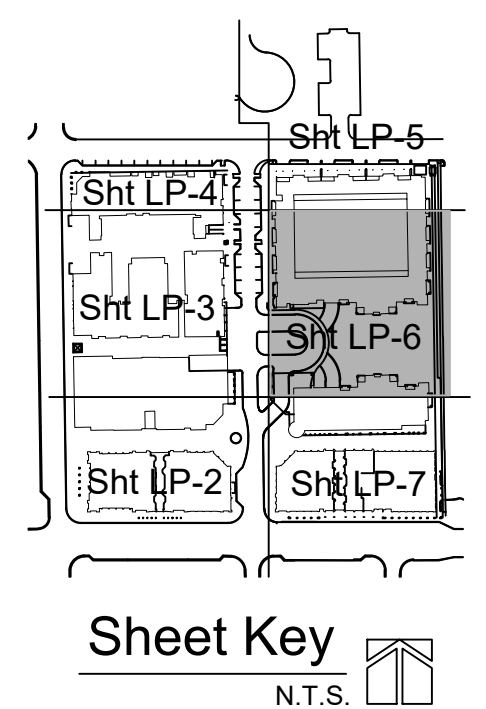

Landscape Plan
Atlantic Crossing
Delray Beach Florida

Covelli
Design
Associates Inc.

2295 NW Corporate Blvd., Suite 210
Boca Raton, Florida 33431
561-970-0330

LC 2600287
covellidesign.com

Urban Planning ♦ Landscape Architecture

te	06-25-13
ale	1"=20'
#	1046

Steven E. Tate, RLA
Landscape Architect #967
State of Florida
- for the firm -

Drawing No.
LP-6
OF 8

[illegible]

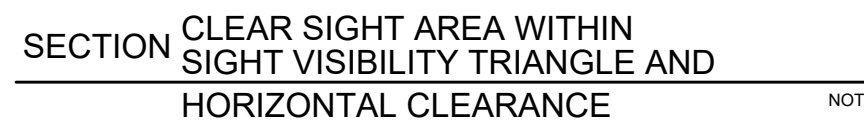
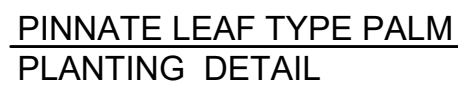

- LANDSCAPE SOIL REPLACEMENT AREAS NOT TO SCALE
WITHIN OR ADJACENT TO VEHICULAR USE AREAS

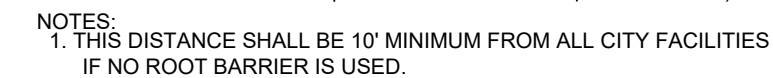

MANUFACTURER
Deep Root Partners, L.P.
530 Washington Street
San Francisco, CA 94111
www.deeproot.com
Tel: 800-458-7668 or 415-78-9700
Fax: 800-277-7668 or 415-781-019

NOT TO SCALE

- ## Standard Landscape Notes
- (See note regarding Structural Soil, LP-1)

1. All landscape and specifications shall meet or exceed the minimum requirements as provided by the City of Delray Beach Land Development Code.
2. All planting material shall meet or exceed Florida Grade #1 as specified in Grades and Standards for Nursery Plants, current edition.
3. All sizes shown for plant material on the plan are to be considered as minimums. All plant material must meet or exceed these minimum requirements for both height and spread. Any other requirements for specific shape or effect as noted on the plan will also be required for acceptance.
4. Landscape shall be placed to edge of abutting ROW, canals, lakes or other lands.
5. All mechanical equipment, air conditioning, irrigation pump stations and equipment, fpl transformers, pool pumps, etc. must be screened on three (3) sides by landscape shrubs. Note: the quantity of screening shrubs may be in addition to the required number of shrubs as provided in the code calculation table. All screening shrubs shall be planted for proper operation of equipment being screened and/or per the requirements of the utility as necessary.
6. Guying/staking practices shall not permit nails, screws, wires, etc. to penetrate outer surfaces of trees, palms or other planted material. Trees, palms and plant material will be rejected due to this practice.
7. Burlap material, wire cages, plastic/canvas straps, etc. must be cut and removed for the top one-half (1/2) depth of the root ball. Trees and shrubs grown in grow bags or grow bag type material must have such material removed entirely prior to planting the tree or shrub.
8. All plant material shall be free of pests, insects, disease, weeds, etc.
9. All plant material shall be planted at the proper depths, as originally grown and/or so the top of the root ball is flush or slightly above finished grade immediately after planting. All trees should provide trunk taper when properly planted at the correct planting depth.
10. All plant material shall be watered in at time of planting to eliminate air pockets in the root zone area.
11. Upon completion of work, the site shall be cleared of all debris, superfluous materials, and equipment caused by this permit.
12. All landscaped areas shall be provided with an underground fully automatic irrigation system using pop-up sprinklers. System shall provide 100% coverage with a 75% overlap (minimum) using rust-free water, except any preserved areas remaining in natural state. A rain sensor device or switch shall be installed that will override the irrigation system when adequate rainfall has occurred. Water shall not be directed and/or provided onto impervious surfaces and/or be designed or installed to throw water over an impervious surface such as a sidewalk, etc. Hours of operation for all irrigation systems shall be limited to 5:00 p.m. to 8:00 a.m. only or as may be further restricted by South Florida Water Management District or other jurisdictional agency.
13. All plant material and work shall be guaranteed for one-year from date of final job acceptance. During the one year guarantee, any plant material that dies or is in an unhealthy condition shall be replaced with the same plant type at least equal to the size and quality originally specified. The replacement material shall also be guaranteed for one year from the date of its installation. The guarantee will be null and void if plant material is damaged or killed by lightning, hurricane force winds, hail or freeze.
14. The landscape contractor is responsible for verifying there are not conflicts with above or below ground utilities prior to commencing landscape installation. Notify owner if conflicts exist.
15. Any trees to remain shall be pruned in such a way to promote proper horticultural and natural tree growth.
16. All trees and palms shall be placed a minimum of 10' from underground utilities. See detail this sheet.
17. Ground covers shall be spaced as noted or to insure ground cover within 6 months of planting.
18. Place sod on smooth sod bed. Remove any rocks and other debris prior to sodding. Sod shall be placed so there are no gaps or voids between pieces. on slopes place sod at 90° to slope direction. Stake sod or otherwise ensure its establishment on slopes.
19. Mulch shall be eucalyptus or melaleuca mulch. All trees in sod areas are to have a 30" ring covered with a 3" layer of mulch. Cover all shrub beds with a 3" layer of mulch. Mulch shall not touch tree, palm or shrub trunks or stems.
20. All plant material shall be fertilized with a tablet form balanced fertilizer containing minor elements. Follow manufacturer's recommendations for rates. sod areas shall be fertilized with a granular form balanced fertilizer with minor elements following manufacturer's recommendations for rates.
21. Planting soil shall be a mix of 1/3 native soil, 1/3 clean sand & 1/3 peat. If native soil is unacceptable, contact landscape architect.
22. Reinforced concrete curbing at least 6" in height shall be provided around all landscape islands and as a separator between all landscape areas that are adjacent to vehicular use areas unless such curbing will interfere with the drainage the drainage.
23. The landscape irrigation system shall utilize reclaimed water ,when available, from one master meter located at the property line. Coordinate location and service with the City of Delray Beach Public Utilities Department.

ALWAYS CALL TWO FULL BUSINESS DAYS BEFORE YOU DIG

CALL
811

sunshine.811.com

2295 NW Corporate Blvd. Suite 213
Boca Raton, Florida 33431
561-910-0330

LC 26000287
covellidesign.com

**Covelli
Design
Associates Inc.** ♦ Urban Planning ♦

Landscape Details & Notes

Atlantic Crossing

Delray Beach Flo

Date	06-25-13
Scale	As Noted
PN#	1046

PREPARED BY

Steven E. Tate, RLA
Landscape Architect #967
State of Florida
- for the firm -

DATE _____

Drawing No.

LP-8
OF 8