



Development Services Department

BOARD ACTION REPORT – APPEALABLE ITEM

Project Name: 123 E. Atlantic Avenue
Project Location: 123 E. Atlantic Avenue
Request: Color Change
PCN: 12-43-46-16-01-076-0161
Board: Site Plan Review and Appearance Board
Meeting Date: March 13, 2019

Board Action:

Approved (6-0 Linda Purdo absent)

Project Description:

The subject property is located on East Atlantic Avenue between NE 1st Ave and NE 2nd Ave in the Central Business District (CBD).

The application consists of a color change to an existing awning from brown and beige to charcoal grey and the building from beige to grey screen.

Board Comments:

N/A

Public Comments:

N/A

Associated Actions:

N/A

Next Action: The SPRAB action is final unless appealed by the City Commission.



SITE PLAN REVIEW AND APPEARANCE BOARD STAFF REPORT

DEVELOPMENT SERVICES DEPARTMENT

100 NW 1ST AVENUE, DELRAY BEACH, FLORIDA 33444

PLANNING & ZONING DIVISION: (561) 243-7040 • BUILDING DIVISION: (561) 243-7200

SITE PLAN REVIEW AND APPEARANCE BOARD

Meeting: March 13, 2019

File No.: (2019-122)

Application Type: Color Change

General Data:

Applicant: Don Day

Location: 123 E. Atlantic Avenue

PCN: 12-43-46-16-01-076-0161

FLUM: CC (Central Core)

Zoning: CBD (Central Business District)

Adjacent Zoning:

- CBD (North)
- CBD (West)
- (CBD) (South)
- CBD (East)

Existing Land Use: Retail

Item before the Board:

The item before the board is a color change to an existing awning from brown and beige to charcoal grey.



Project Planner:

Jennifer Buce, Assistant Planner;

buce@mydelraybeach.com,

561-243-7138

Review Dates:

March 13, 2019

Attachments:

1. Color renderings

LOT 12
BLOCK 76

THE EAST 23.16' OF LOT 16, BLOCK 76

CITY OF DELRAY BEACH (FORMERLY TOWN OF LINTION)

According To The Plat Recorded In Plat Book 1, Page 3 Recorded In The Public
Record Of Palm Beach County, Florida. Said Land Situate, Lying, And Being In
Palm Beach County, Florida.

SCALE: 1" = 20'

LOT 15
BLOCK 76

LOT 17
BLOCK 76

NOTES:

- 1) BEARINGS SHOWN HEREON ARE RELATIVE TO PLAT AND ARE ASSUMED.
- 2) NO ABSTRACT OR TITLE SEARCH WAS PERFORMED TO DISCOVER THE EXISTENCE OF ANY EASEMENTS OR RESTRICTIONS OF RECORD.
- 3) ELEVATIONS SHOWN HEREON ARE BASED ON NATIONAL GEODETIC VERTICAL DATUM OF 1929 UNLESS OTHERWISE NOTED.
- 4) NO BELOW GROUND IMPROVEMENTS, FOOTERS, FOUNDATIONS OR UTILITIES HAVE BEEN LOCATED OR SHOWN ON THIS SURVEY.

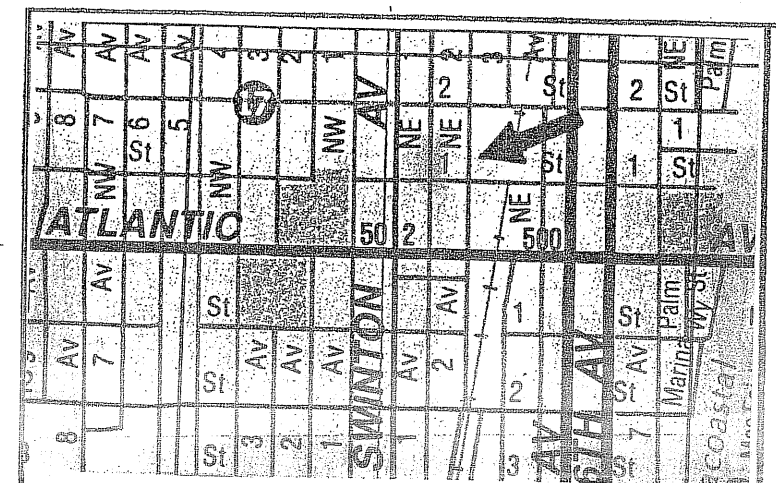

NORTH
NOT TO SCALE
NORTH
VICINITY
MAP

O.R.B. = official record book	TRAN. = transformer pad	P.B. = plat book	P = plat	P.G. = page
C.B.S. = concrete block structure	F.P.&L. = Florida power and light	TYP. = typical	M = power pole	I.R. = iron rod
P.C.C. = point of compound curve	CM = concrete monument	R/V = right-of-way	M = MEASURED	R = radius
P.C.P. = permanent control point	P.R.C. = point of reverse	Δ = central angle	I.P. = IRON PIPE	D = deed
P.B.C. = point of commencement	P.I. = point of intersection	⊙ = bearing basis line	R.P. = radius point	O/S = offset
P.B. = point of beginning	P.T. = point of tangency	ASPH = asphalt	L = ARC LENGTH	CONC. = concrete
D/E = drainage easement	* = not field measured	M.H. = manhole	CL = centerline	ESMT. = easement
C.M.P. = corrugated metal pipe	W.P.F. = wood privacy fence	U/E = utility easement	ALUM. = aluminum	CALC. = calculated
R.L.S. = registered land surveyor	CHATT = chattahoochee	CLF = chain link fence	P.C. = point of curvature	
L.B. = licensed business	ELEV = elevation	P.R.M. = permanent reference monument		



801 S.E. 6th Ave., Suite 101
Delray Beach, FL 33483

Phone 561-243-4824
Fax 243-4869

AUTHORIZATION NUMBER LB6504

I HEREBY CERTIFY THAT THE SKETCH OF BOUNDARY SURVEY SHOWN HEREON MEETS THE STANDARDS OF PRACTICE SET FORTH IN CHAPTER SJ-17-050-052, FLORIDA ADMINISTRATIVE CODE PURSUANT TO SECTION 472.027, FLORIDA STATUTES.

HARRY A. BURGESS, PLS 5089

CERTIFIED TO:

WILLIAM BURKE

FLOOD ZONE: "X"

MAP NO.: 125102 0004 D

MAP DATE: 1-5-89

DATE: 9-13-17

JOB NO.: 8-17-052

REVISED:

NOT VALID
UNLESS SEALED
WITH EMBOSSED
SURVEYOR'S SEAL

For: The Real Poke
123 E. Atlantic Ave.
Delray Bch.

FOUND NAIL + DISK
L.B. 359

N 89° 40' 34" W 23.16'

123 E. ATLANTIC AVENUE

96.00'
(PLAT & MEAS.)

FOUND NAIL
(UNNUMBERED)
AT BLOCK CORNER

FOUND NAIL + DISK
(UNNUMBERED)

S 89° 40' 34" E 23.16'

16' ALLEY

FOUND 1/2" I.R. + CAP
(COULD NOT READ)

LOT 16
BLOCK 76

ASPHALT
SHED

D.O. FENCE

BRICK

AWNING

TWO STORY
BUILDING

COVERED

0.3' ENCROACHMENT

FOUND NAIL + DISK
L.B. 6504

Existing Fabric Patio Awning

24.84'

N 89° 40' 34" W 23.16'

BRICK

30.00'

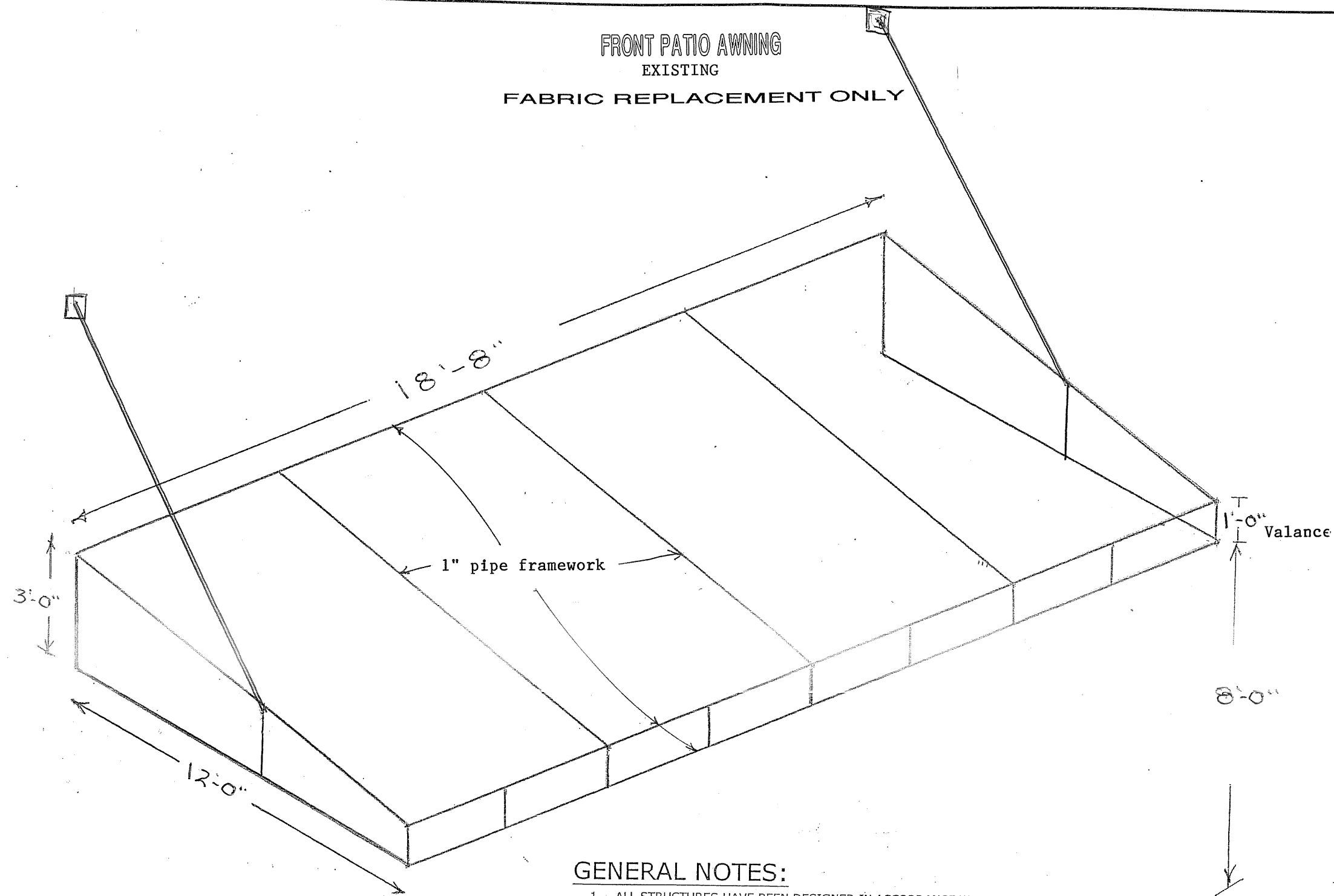

GENERAL NOTES:

1. ALL STRUCTURES HAVE BEEN DESIGNED IN ACCORDANCE WITH THE FLORIDA BUILDING CODE SIXTH EDITION (2017) AND ASCE 7-10 (MRH=15', EXP='C', $V_{ult}^*=115$ MPH (3 SEC GUST), RISK CATEGORY 1, 1.5:12 MIN. SLOPE, PITCHED/GABLE ROOF, MWFRS ROOF OVER OPEN STRUCTURE, OBSTRUCTED OR UNOBSTRUCTED WIND FLOW). MAXIMUM DESIGN PRESSURE OF 25 PSF.
[* V_{asd} MAY BE CALCULATED WITH THE FOLLOWING CONVERSION: $V_{asd}=V_{ult}^*\sqrt{0.6}$]
2. ALL PIPE SHALL BE ASA SCHEDULE 40 OR GATORSHIELD 14 GAGE GALVANIZED UNLESS NOTED OTHERWISE.
3. ALL WELDS SHALL COMPLY WITH A.W.S. CODE, CURRENT EDITION. ALL WELDS SHALL BE FULL LENGTH WITH 3/16" FILLET (U.N.O.), COVERED WITH ALUM PAINT.
4. FABRIC COVERING SHALL BE REMOVED WHEN SUSTAINED WINDS REACH 75mph (90mph 3-SECOND GUST). FABRIC COVERING SHALL BE EXTERIOR, NON-METALLIC, NON-CORROSIVE, & WATER RESISTANT. FABRIC SELECTION IS BEYOND THE SCOPE OF THIS CERTIFICATION.
5. FRAMES WITHOUT COVERING HAVE BEEN DESIGNED BY RATIONAL ANALYSIS TO WITHSTAND $V_{ult}=170$ mph (3-SECOND GUST) WINDS IN EXPOSURES 'C' AND 'D'.
6. THE AWNING OWNER SHALL BE NOTIFIED OF THESE CONDITIONS BY THE PERMIT HOLDER. NO WARRANTY, EXPRESSED OR IMPLIED, IS CONTAINED HEREIN.
7. THE EXISTING HOST STRUCTURE MUST BE CAPABLE OF SUPPORTING THE LOADED SYSTEM AS VERIFIED BY THE PERMIT HOLDER. NO WARRANTY, EITHER EXPRESSED OR IMPLIED, IS CONTAINED HERFIN.

FOR: The Real Poke
123 E. Atlantic Ave.
Delray Beach Fla.

DELRAY AWNING, INC.
The Canvas Craftsman
80 N. CONGRESS AVENUE
DELRAY BEACH, FL 33445
(561) 276-5381

REVISIONS

DESCRIPTION	DATE

NO SCALE

DRAWN BY: FLB

CHECKED BY: FLB

PRINT DATE:

JOB #:

SHEET:

