



947 Clint Moore Road
Boca Raton, Florida 33487

SURVEYING & MAPPING
Certificate of Authorization No. LB7264

Tel: (561) 241-9988
Fax: (561) 241-5182

SKETCH AND DESCRIPTION - 2' ALLEY RIGHT-OF-WAY

229 SW 14th AVENUE, DELRAY BEACH

LEGAL DESCRIPTION

THE EAST 2.00 FEET OF LOT 8 BLOCK 4, "PRIEST'S ADDITION TO ATLANTIC PARK GARDENS", ACCORDING TO THE PLAT THEREOF, AS RECORDED IN PLAT BOOK 23 AT PAGE 70 OF THE PUBLIC RECORDS OF PALM BEACH COUNTY, FLORIDA.

SAID LANDS SITUATE IN THE CITY OF DELRAY BEACH, FLORIDA, AND CONTAIN 100 SQUARE FEET, MORE OR LESS.

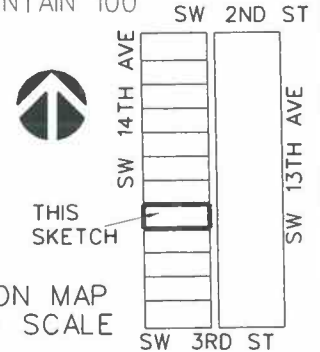

NOTES

1. REPRODUCTIONS OF THIS SKETCH ARE NOT VALID WITHOUT THE SIGNATURE AND THE ORIGINAL RAISED SEAL OF A FLORIDA LICENSED SURVEYOR AND MAPPER.
2. NO SEARCH OF THE PUBLIC RECORDS WAS PERFORMED OR REFERENCED IN THE PREPARATION OF THIS SKETCH.
3. BEARINGS ARE BASED ON A GRID BEARING OF NORTH 00°58'45" WEST ALONG THE EAST LINE OF SW 14TH AVENUE.
4. THE ADDRESS IS 229 AND 231 SW 14TH AVENUE, DELRAY BEACH, FL 33444

ABBREVIATIONS

CONC.	CONCRETE
COR.	CORNER
I.R.	IRON ROD
I.R.C.	IRON ROD AND CAP
L.B.	LICENSED BUSINESS
L.S.	LICENSED SURVEYOR
MON.	MONUMENT
O.R.B.	OFFICIAL RECORDS BOOK
P.O.B.	POINT OF BEGINNING
P.O.C.	POINT OF COMMENCEMENT
P.B.	PLAT BOOK
P.B.C.R.	PALM BEACH COUNTY RECORDS
PG.	PAGE
P.S.M.	PROFESSIONAL SURVEYOR & MAPPER
R/W	RIGHT-OF-WAY
U.E.	UTILITY EASEMENT

CERTIFICATION

I HEREBY CERTIFY THAT THE SKETCH AND DESCRIPTION SHOWN HEREON COMPLIES WITH STANDARDS OF PRACTICE AS CONTAINED IN CHAPTER 5J-17.051, FLORIDA ADMINISTRATIVE CODE, PURSUANT TO SECTION 472.027, FLORIDA STATUTES, AND THAT SAID SKETCH AND LEGAL DESCRIPTION IS TRUE AND CORRECT TO THE BEST OF MY KNOWLEDGE AND BELIEF AS PREPARED UNDER MY DIRECTION.

JEFF E. MODAPP
SURVEYOR AND MAPPER
FLORIDA LICENSE NO. LS5111

Project Name:	229 SW 14 AVE	DATE:	05/01/2019
JOB NO.	19136	DWG BY:	JSH
		CK'D By:	AJR
			SHEET 1 OF 2

