

1 PLANTING PLAN - COURTYARD
LP-2 SCALE: 1/4" = 1'- 0"

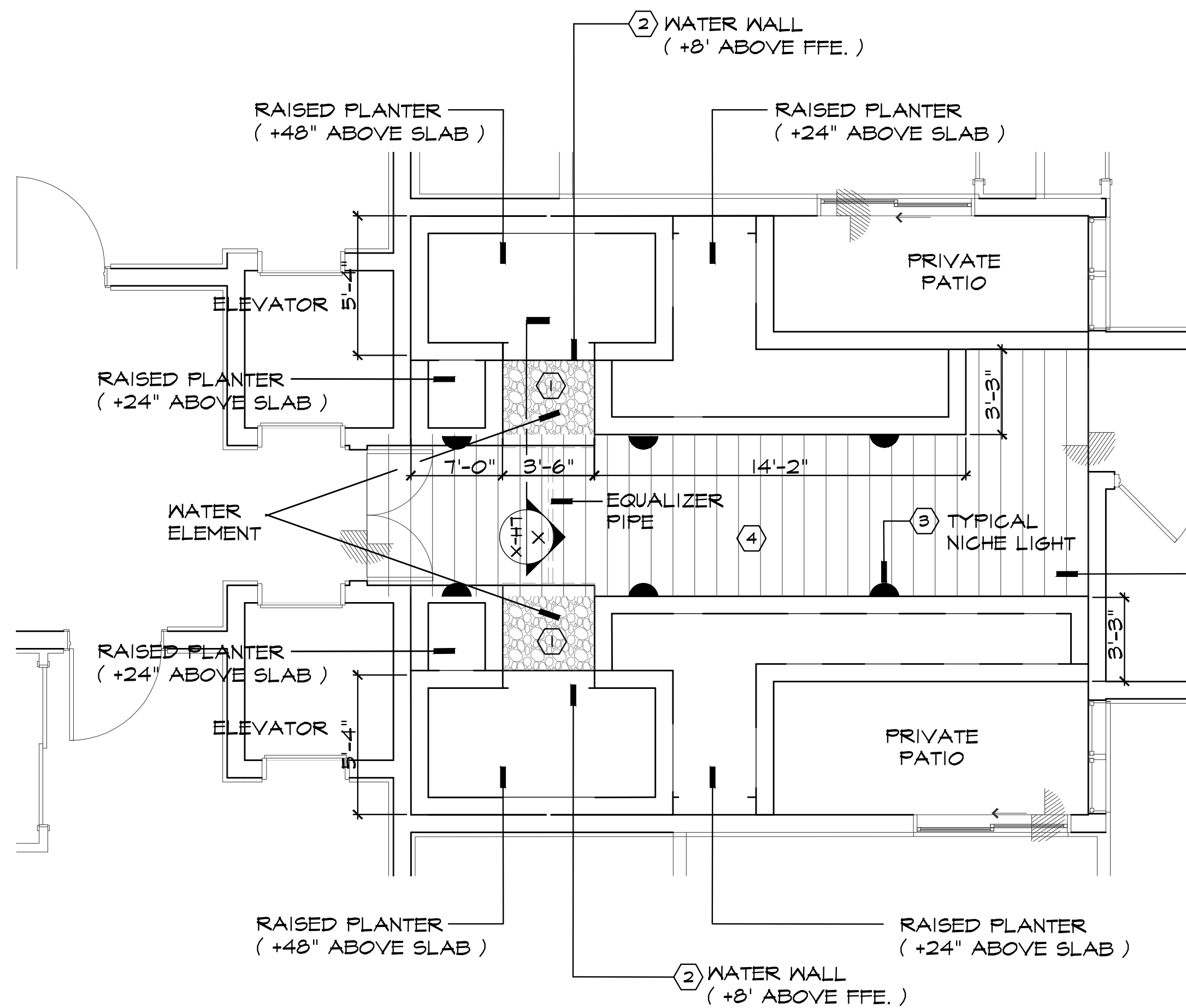

2 LAYOUT PLAN - COURTYARD
LP-2 SCALE: 1/4" = 1'- 0"

WATER ELEMENT SCHEDULE

- 1 BASIN: 24" DEPTH WITH BLACK MEXICAN BEACH PEBBLES AT THE BOTTOM
FINISH: FUNIDA GEM LAGOON
- 2 WALL FINISH: CERAMIC MATRIX CRECENT V-TILE #CB28M
COLOR: SULTRA BLACK
- 3 LIGHTING - UNDER WALL (6) UPRIGHT ON WATER WALL
- 4 COURTYARD FLOORING BELGARD PORCELAIN PAVER DAYLIGHT NN OI RD
SIZE: 12" X 48"

NOTE: ALL PLANTERS TO HAVE (2) PHASE DRAIN, ELECTRIC AND IRRIGATION.

PLANT LIST / COST ESTIMATE

TREES AND PALMS									
KEY	QTY. TOTAL	BOTANICAL/COMMON NAME	HEIGHT	SPREAD	CLEAR TRK.	SPA.	REMARKS	UNIT COST	TOTAL COST
PM	2	Ptychosperma macarthurii Macarthur palm	20-24' o.a.	10-12'			Multi-trunks, 7-9 minimum Full heads	\$400.00	\$800
SHRUBS AND GROUNDCOVERS									
KEY	QTY. TOTAL	BOTANICAL/COMMON NAME	HEIGHT	SPREAD	CLEAR TRK.	SPA.	REMARKS	UNIT COST	TOTAL COST
ASP	8	Asparagus densiflorus 'Myers' Foxtail Fern	24"	24"		2' o.c.	Full clump	\$30.00	\$240
ALP	8	Alpinia z. 'Variegata' Variegated Shell Ginger	30"	30"		2' o.c.	Full clump 7 Gallon cont.	\$10.00	\$80
BEG	4	Begonia odorata 'Alba' White Angelwing	18"	18"		2' o.c.	Full cont.	\$15.00	\$60
CHA	7	Chamaedorea seifrizii Reed Palm	5'-6'	2-3'			Multi-stem	\$75.00	\$525
PHX	18	Philodendron 'Xanadu' Dwarf Philodendron	16"	16"		2' o.c.	Full clump	\$10.00	\$180
PHC	12	Philodendron 'Red Congo' Red Congo Philodendron	18"	18"		2' o.c.	Full clump	\$45.00	\$540
RHE	2	Rhaphis excelsa Lady Palm	5'-6'	24-30"			Full clump	\$75.00	\$150
SED	80	Sedum acre 'Gold Moss' Goldmoss stonecrop	6"			6"	Full cont.	\$9.00	\$720
TOTAL COST:								\$2,575.00	

^ Indicates plant material native to Florida

Planting soil - 1/2 cu. yd. per tree and 4" depth at all hedges and mass planting beds.

Sand - Palms to be planted in clean sand; 1/2 cu. yd. per palm.

Mulch - 3" depth of shredded mulch or pine straw at all hedges and mass planting beds.

GENERAL NOTES

- ^ Indicates plant material native to Florida
- All sod to be Empire Zoysia sod.
- All plant materials shall conform to the standards for Florida No. 1 or better as given in "Grades and Standards for Nursery Plants", Latest Edition, State of Florida Department of Agriculture, Tallahassee, or thereto.
- All trees shall be properly guyed and staked at the time of planting to ensure proper establishment.
- The planting soil for all planting areas shall be composed of a minimum of 30% muck or horticulturally acceptable organic material. The minimum soil depth shall be four inches in all hedges and mass planting beds and 1/2 cu. yd. per tree. Palms to be planted in clean sand.
- Three inches minimum of shredded mulch or pine straw shall be installed around each tree and palm and throughout mass planting beds.
- Irrigation system to provide 100% coverage to landscaped areas with 100% overlap. Irrigation to be an automatic system with a rain gauge/moisture sensor shut-off.
- In case of discrepancies, planting plan takes precedence over plant list.
- Landscape contractor is responsible for his own quantity take-offs.

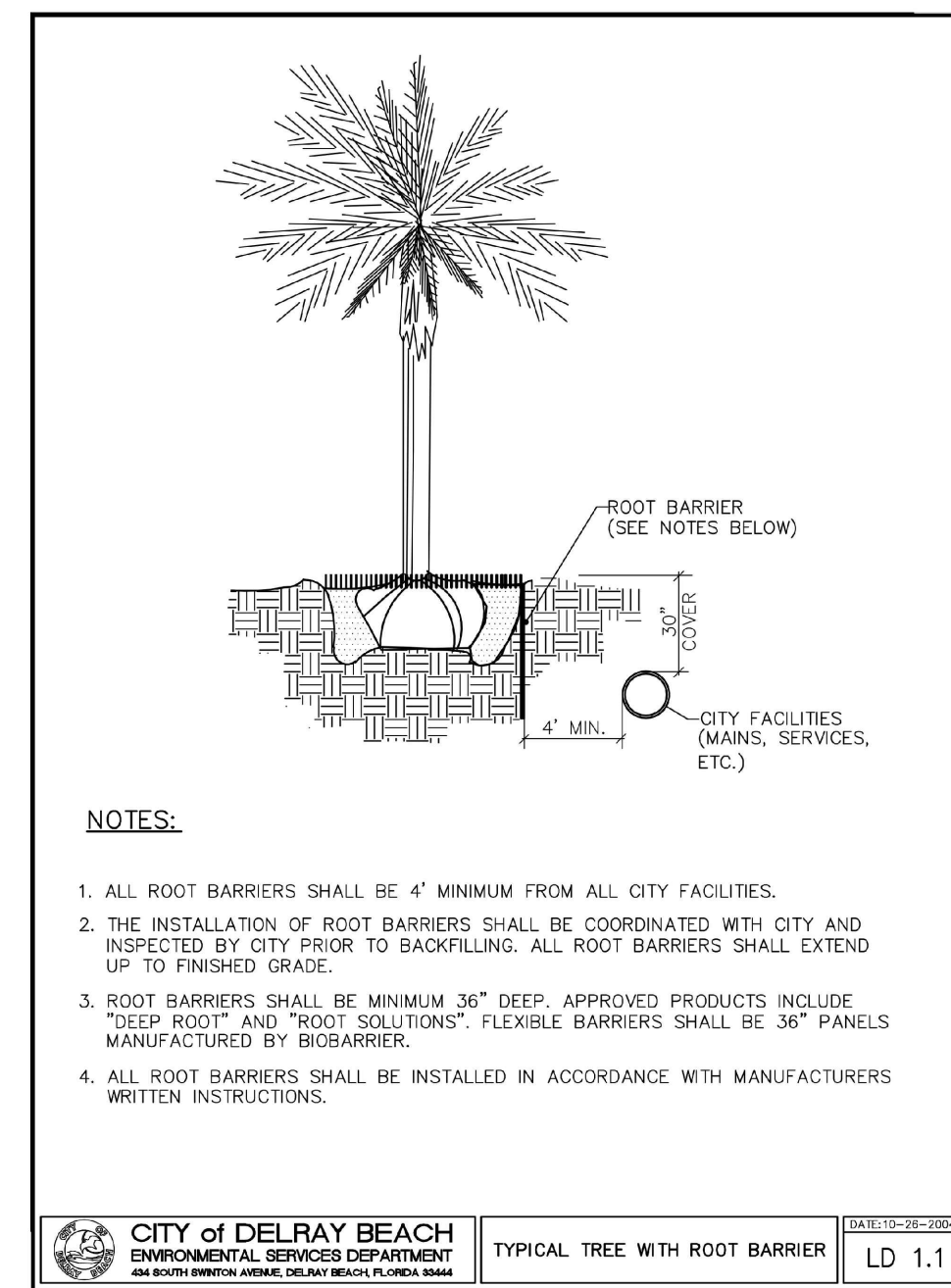

"ANY TREES OR SHRUBS PLACED WITHIN WATER, SEWER OR DRAINAGE EASEMENTS SHALL CONFORM TO THE CITY OF DELRAY BEACH STANDARD DETAILS LD 1.1 AND LD 1.2"

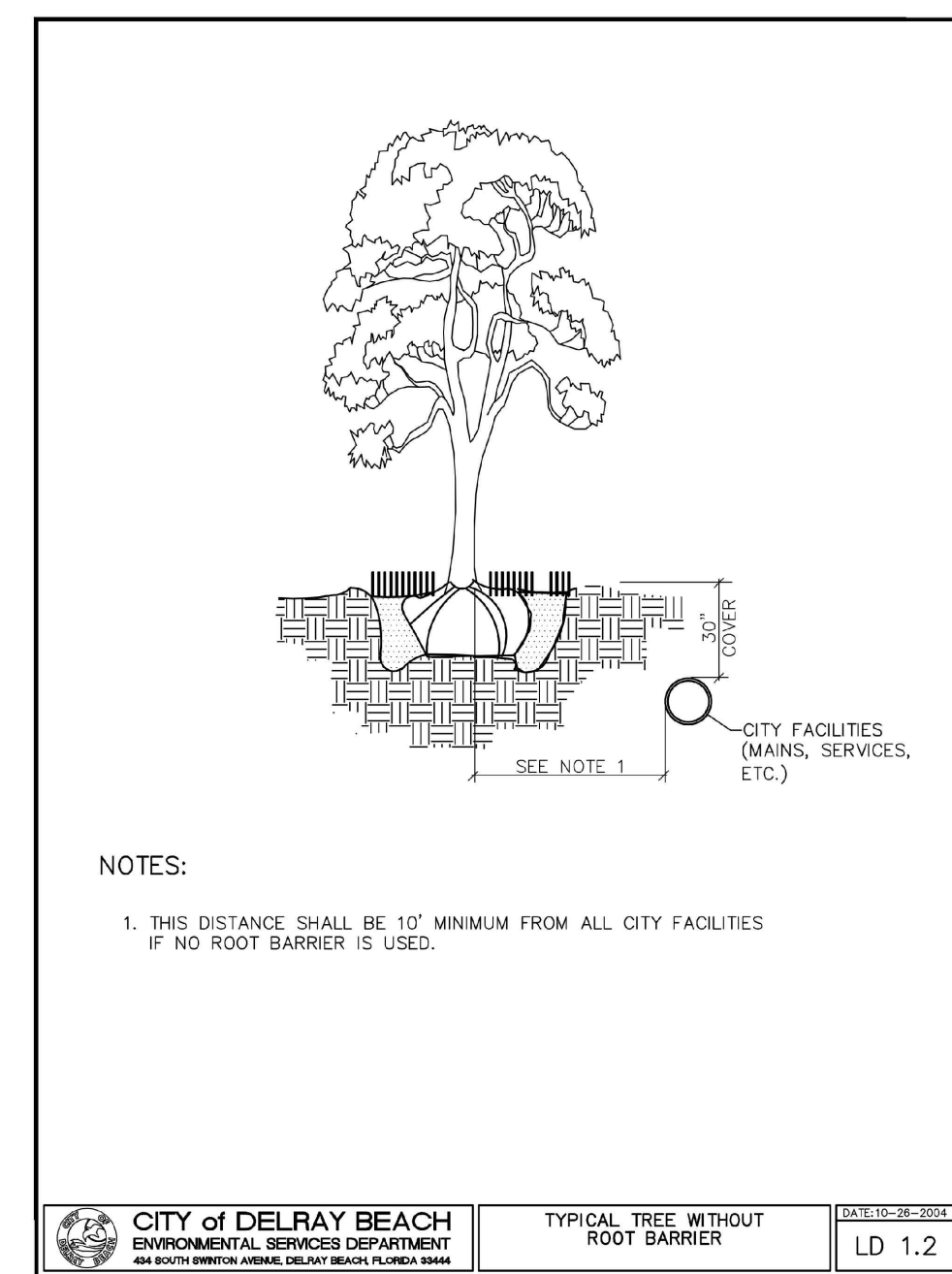

"EXISTING NATIVE SOIL WITHIN ALL LANDSCAPE ISLANDS, INTERIOR LANDSCAPE STRIPS AND PERIMETER LANDSCAPE STRIPS, ADJACENT TO VEHICULAR USE AREAS, SHALL BE EXCAVATED DOWN TO A DEPTH OF THIRTY (30) INCHES BELOW EXISTING GRADE, EXCEPT FOR A 12" BUFFER FROM THE INSIDE OF THE CURB OR PAVEMENT. A SUITABLE PLANTING SOIL MIXTURE OF FIFTY/FIFTY (50/50), SIXTY/FORTY (60/40) (SAND/TOPSOIL) OR AS OTHERWISE INDICATED BY THE REGISTERED LANDSCAPE ARCHITECT, SHALL EITHER BE BACKFILLED IN PLACE OF THE NATIVE SOIL OR EFFICIENTLY MIXED WITH THE NATIVE SOIL TO CREATE AN OPTIMUM ENVIRONMENT FOR SUCCESSFUL ROOT DEVELOPMENT. IF NATIVE SOIL IS TO BE MIXED, IT SHALL FIRST BE SCREENED TO REMOVE ROCKS AND DEBRIS LARGER THAN ONE-HALF (1/2) INCH IN DIAMETER PRIOR TO MIXING. ALL PROPERTIES UNDER THIS SECTION SHALL BE REQUIRED TO HAVE AN OPEN BED INSPECTION PRIOR TO BACKFILLING TO INSURE THE THIRTY (30) INCH DEPTH HAS BEEN MET."

"ALL PROHIBITED PLANT SPECIES SHALL BE ERADICATED FROM THE DEVELOPMENT SITE AND REESTABLISHMENT OF PROHIBITED SPECIES SHALL NOT BE PERMITTED."

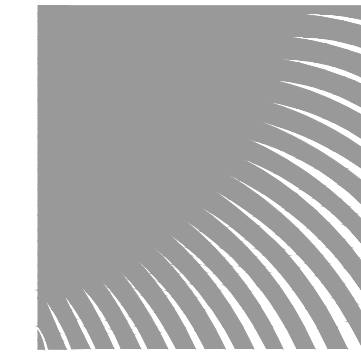

DSBOCA
design studio boca

landscape architects
and planners

LC - 0000396
2300 Corporate Blvd. NW, Suite 214

Boca Raton, Florida 33431
Ph: 561.955.8623

Fax: 561.362.4749

email: landscapedesign@dsboca.com

1625 OCEAN
1625 S. OCEAN BLVD. DELRAY BEACH, FLORIDA
COURTYARD PLANTING PLAN

REVISIONS:
04-01-2021 Building comments /
Court yard Design
06-25-21 GMP

MAY 17, 2021
DATE

G.C.
DRAWN BY:

M.J.
APPROVED BY:

This drawing is the property of
Design Studio Boca, and is an
instrument of service not to be
reproduced in whole or in part
without the express written
permission of same.

LP-2

BID SET