

| SEATING BREAKDOWN:  |                      | INDOOR TOTAL = 93          | SEATING TOTAL = 100   |
|---|----------------------|----------------------------|---|
| DINING:<br>BOOTH SEATS:<br>TABLE SEATS:<br>BANQUET SEATS: | = 50<br>= 26<br>= 16 | BAR:<br>BAR SEATS:<br>= 25 | OUTDOOR DINING:<br>TABLE SEATS:<br>TABLE SEATS:<br>TABLE SEATS: |
|   |                      |                            | 10 x 4 = 40<br>2 x 6 = 12<br>6 x 8 = 48                         |
| DINING ROOM TOTAL   | = 68                 | BAR TOTAL = 25             | OUTDOOR TOTAL = 100   |

OCCUPANCY LOADS

OCCUPANCY CLASSIFICATION:

\*RESTAURANT (GROUP A-2: ASSEMBLY): 201 PERSONS

KITCHEN & COOK AREA (100 S.F. / PP)

715.8 S.F. / 100 = 8 PERSONS

DINING AREA

(SEE SEATING BREAKDOWN) = 193 PERSONS

\*BUSINESS (GROUP B: BUSINESS): 4 PERSONS

RESTROOMS (100 S.F. / PP)

360.8 S.F. / 100 = 4 PERSONS

\*\*TOTAL EGRESS / OCCUPANCY: 205 PERSONS

BUILDING USE AND OCCUPANCY:

GROUP A-2: ASSEMBLY // (FBC SECTION 303.3)

Restaurants, cafeterias and similar dining facilities

(including associated commercial kitchens)

GROUP B: BUSINESS // (FBC SECTION 304.1)

Food processing establishments and commercial kitchens

not associated with restaurants, cafeterias and similar

dining facilities not more than 2,500 square feet (232 m2) in

area.

FURNITURE & DECORATIONS FLAME RESISTANCE PER NFPA

FURNITURE & DECORATIONS FLAME RESISTANCE PER NFPA 103.1

Window blinds are flame resistant per NFPA 701.

FURNITURE & DECORATIONS FLAME RESISTANCE PER NFPA 103.2

Space is protected by approved automatic sprinkler system requirements for

upholstered furniture in compliance with Class 1 per NFPA 260 are not applicable &

compliance with char length limitations per NFPA 261 are applicable.

FURNITURE & DECORATIONS FLAME RESISTANCE PER NFPA 103.3

Upholstered furniture shall have limited heat release per ASTM IE 1537.

FURNITURE & DECORATIONS FLAME RESISTANCE PER NFPA 103.5

No explosive or highly flammable furnishings or decorations shall be used.

FURNITURE & DECORATIONS FLAME RESISTANCE PER NFPA 103.6

Fire retardants coatings shall be maintained to retain effectiveness of treatment under

service conditions encountered in actual use.

FURNITURE & DECORATIONS FLAME RESISTANCE PER NFPA 103.7

Furnishings or contents with foam or plastic materials unprotected from ignition shall

have less than 100kw heat release. No such materials are specified.

REQUIRED FLORIDA ACCESSIBLTY CODE

HANDICAPPED SEATING POSITIONS

UP TO 100 SEATS: 4 HANDICAPPED SEATS REQUIRED

FOR EACH 100 (OR FRACTION OF 100)

SEATS OVER THE FIRST 100 SEATS: 2 HANDICAPPED SEAT REQUIRED

TOTAL REQUIRED: 6 H/C SEATS

TOTAL PROVIDED: 6 H/C SEATS

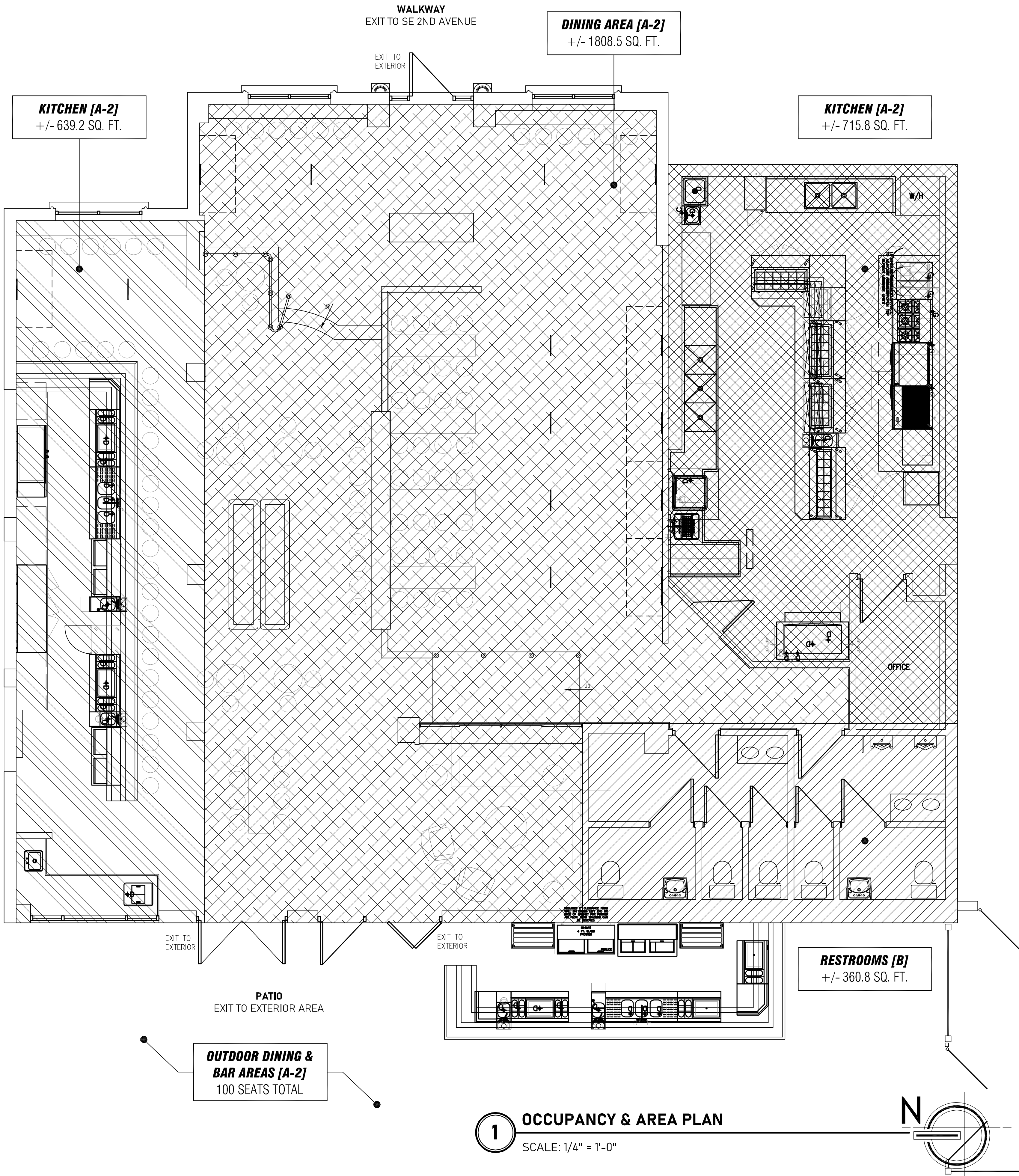

1 OCCUPANCY & AREA PLAN

SCALE: 1/4" = 1'-0"

K

KANTHAN DESIGN Corporation

Your Vision is Our Business!

SEAL

DESIGN PROFESSIONAL IN RESPONSIBLE CHARGE

SUPRADHEEP L. KANTHAN, AIA, NCARB

631 POTTER ROAD,

BOYNTON BEACH, FL 33435

REGISTERED ARCHITECT

FL. A195071 | PA. RA407852

REGISTERED INTERIOR DESIGNER

FL. 104695

KANTHAN DESIGN CORPORATION

631 POTTER ROAD,

BOYNTON BEACH, FL 33435

REGISTERED ARCHITECT BUSINESS

FL. AA26003242 | PA. AX011596

REGISTERED INT. DESIGN BUSINESS

FL. 1B26001929

www.kanthandesign.com

THROW SOCIAL

55 SE 2nd Avenue,

Delray Beach, FL 33444,

Palm Beach County, Florida

REVISIONS

|  |  |  |  |  |  |
|--|--|--|--|--|--|
|  |  |  |  |  |  |
|  |  |  |  |  |  |
|  |  |  |  |  |  |
|  |  |  |  |  |  |
|  |  |  |  |  |  |
|  |  |  |  |  |  |

THE USE OF THESE SPECIFICATIONS AND PLANS SHALL BE RESTRICTED TO THE ORIGINAL CLIENT AND SITE FOR WHICH THEY WERE PREPARED. ANY REPRODUCTION OR DISTRIBUTION IS EXPRESSLY LIMITED TO SUCH USE. ANY OTHER REPRODUCTION, REUSE, OR DISCLOSURE BY ANY METHOD, IN WHOLE OR IN PART, IS PROHIBITED. THESE DRAWINGS AND SPECIFICATIONS CONTAIN PROPRIETARY INFORMATION AND TITLE REMAINS WITH KANTHAN DESIGN CORPORATION.

PROJECT NUMBER 21040

A105

SHEET

© 2021 KANTHAN DESIGN CORPORATION. ALL RIGHTS RESERVED. THIS DOCUMENT, OR ANY PART THEREOF, MAY NOT BE REPRODUCED IN ANY MANNER WHATSOEVER WITHOUT WRITTEN PERMISSION BY KANTHAN DESIGN CORPORATION.