

Rick Gonzalez, AIA
President
FL License AR0014172
120 South Olive Ave. Ste. 210,
West Palm Beach, FL 33401
P (561) 659-2383
www.regarchitects.com

ISLAND COVE
RENTAL DEVELOPMENT
DELRAY BEACH, FL 33064

NO.	DATE	DESCRIPTION
-----	------	-------------

DATE	09/01/2021
MODELED	CM
CHECKED	CM/REG
PROJECT #	21003
© REG 2021	

OWNERSHIP AND USE OF THESE DOCUMENTS & SPECIFICATIONS AS INSTRUMENTS OF SERVICE ARE AND SHALL REMAIN THE PROPERTY OF THE ARCHITECT WHETHER THE PROJECT THEY ARE MADE FOR IS EXECUTED OR NOT. THEY SHALL NOT BE USED BY THE OWNER OR OTHERS ON OTHER PROJECTS OR FOR ADDITIONS TO THIS PROJECT BY OTHERS EXCEPT BY AGREEMENT IN WRITING AND WITH APPROPRIATE COMPENSATION TO THE ARCHITECT.

ARCHITECTURAL SITE PLAN

SITE PLAN APPROVAL

A-1.00

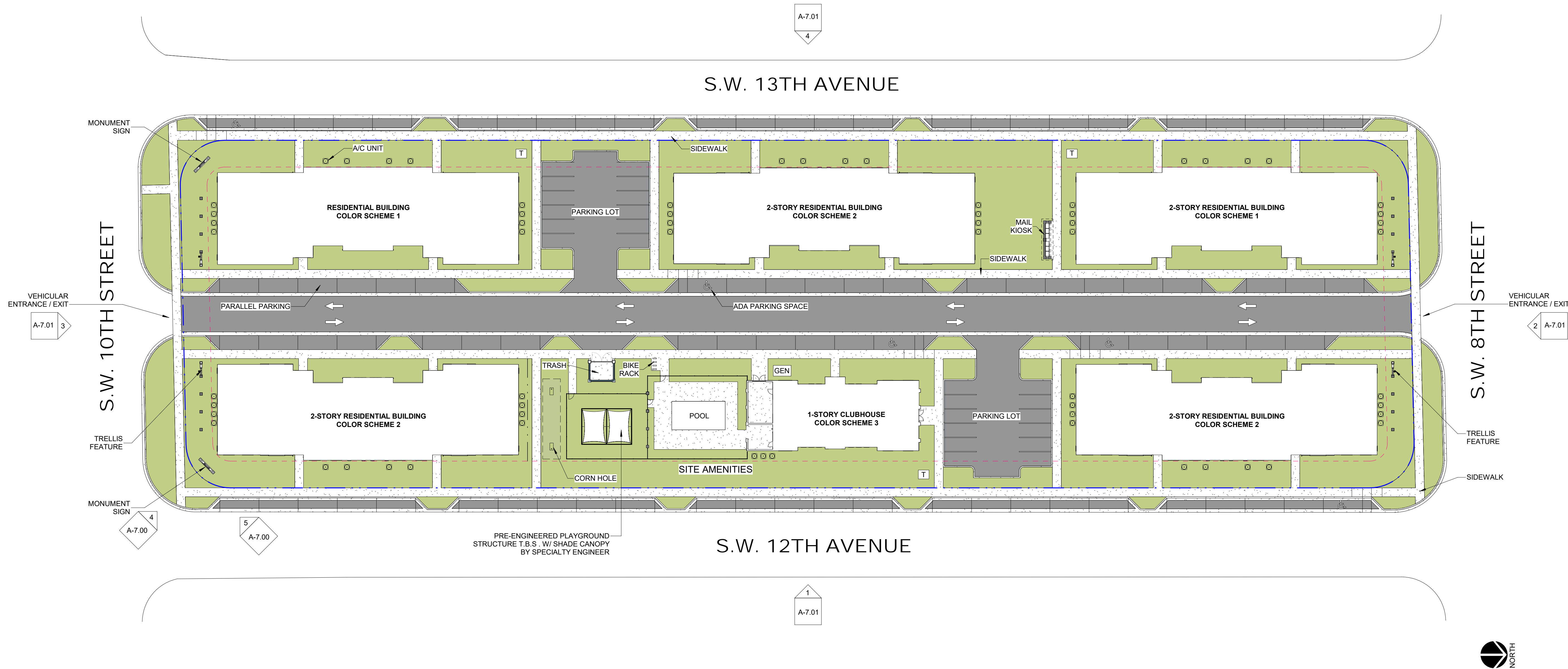

1 | ARCHITECTURAL SITE PLAN

A-1.00

SCALE: 1" = 30'-0"

ISLAND COVE - PARKING COUNT (FOR REFERENCE ONLY - SEE CIVIL SHEET C-400)	
TOTAL PARKING SPACES PROVIDED (4 ADA SPACES INCLUDED IN TOTAL)	122

ISLAND COVE - UNIT INFORMATION (FOR REFERENCE ONLY - SEE CIVIL SHEET C-400)		
UNIT	SF	# OF UNITS
2 BEDROOM	1079	40*
3 BEDROOM	1286	20**
TOTAL # OF UNITS		60***

NOTES:
*1 ADA UNIT INCLUDED IN TOTAL
**1 ADA AND 1 ADA / HEARING IMPAIRED UNIT INCLUDED IN TOTAL
***5 RESIDENTIAL BUILDINGS TOTAL - 12 UNITS / BUILDING

ARCHITECTURALSITE PLAN IS FOR REFERENCE ONLY.
REFER TO CIVIL DRAWINGS FOR ALL INFORMATION
PERTAINING TO THE SITE PLAN.